

LUMINAIRE SCHEDULE			SERVICE NO. 3946		
PLAN NUMBER	ID NUMBER	SERVICE - CIRCUIT	TYPE - WATTS	MASTARM	MTG HEIGHT
1	3946-1-SL2-1 (EX.)	9W/8 - 1	EX.	EX.	EX.
4	3946-1-SL2-4 (EX.)	9W/8 - 2	EX.	EX.	EX.
5	3946-1-SL2-5 (EX.)	9W/8 - 2	EX.	EX.	EX.
6	3946-1-SL2-6 (EX.)	9W/8 - 2	EX.	EX.	EX.
7	3946-1-SL2-7	9W/8 - 2	II - 60	8 FT	30 FT
8	3946-1-SL2-8	9W/8 - 2	II - 60	8 FT	30 FT

WIRING SCHEDULE				
△ X	RUN NO.	CONDUIT	WIRE	COMMENTS
	1	2" PVC	2-#8 (ILLUM)	SHALL BE ALUMINUM

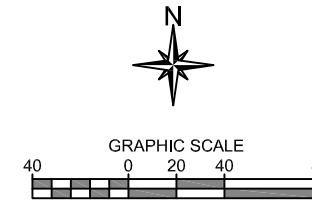

**CONSTRUCTION NOTES**

- ① INSTALL LIGHT STANDARD FOUNDATION, POLE, DAVIT ARM, AND LUMINAIRE IN APPROXIMATE LOCATION SHOWN (2 LOCATIONS THIS SHEET) AND IN ACCORDANCE WITH MANUFACTURER RECOMMENDATIONS, SPECIAL PROVISIONS, AND THE DETAILS ON SHEETS 60 AND 61.
- ② INSTALL TYPE 1 JUNCTION BOX (REFER TO STANDARD PLAN J-40.10 AND THE DETAILS ON SHEETS 65 AND 66) AT APPROXIMATE LOCATION SHOWN (3 BOXES THIS SHEET). SEE NOTES.
- ③ INSTALL CONDUIT INTO EXISTING JUNCTION BOX. SPLICE NEW CONDUCTORS TO EXISTING ILLUMINATION CONDUCTORS.
- ⑤ MAINTAIN AND PROTECT EXISTING ILLUMINATION SYSTEM.
- ⑦ EXISTING SERVICE CABINET TO BE USED FOR PROPOSED LIGHT STANDARDS FOR 8 AVE S - 9 AVE S TO S 334 ST.
- ⑬ EXISTING ILLUMINATION SYSTEM ON THE EAST SIDE OF 9TH AVE S IS NOT A PART OF THE PROJECT. SHOWN FOR REFERENCE ONLY.

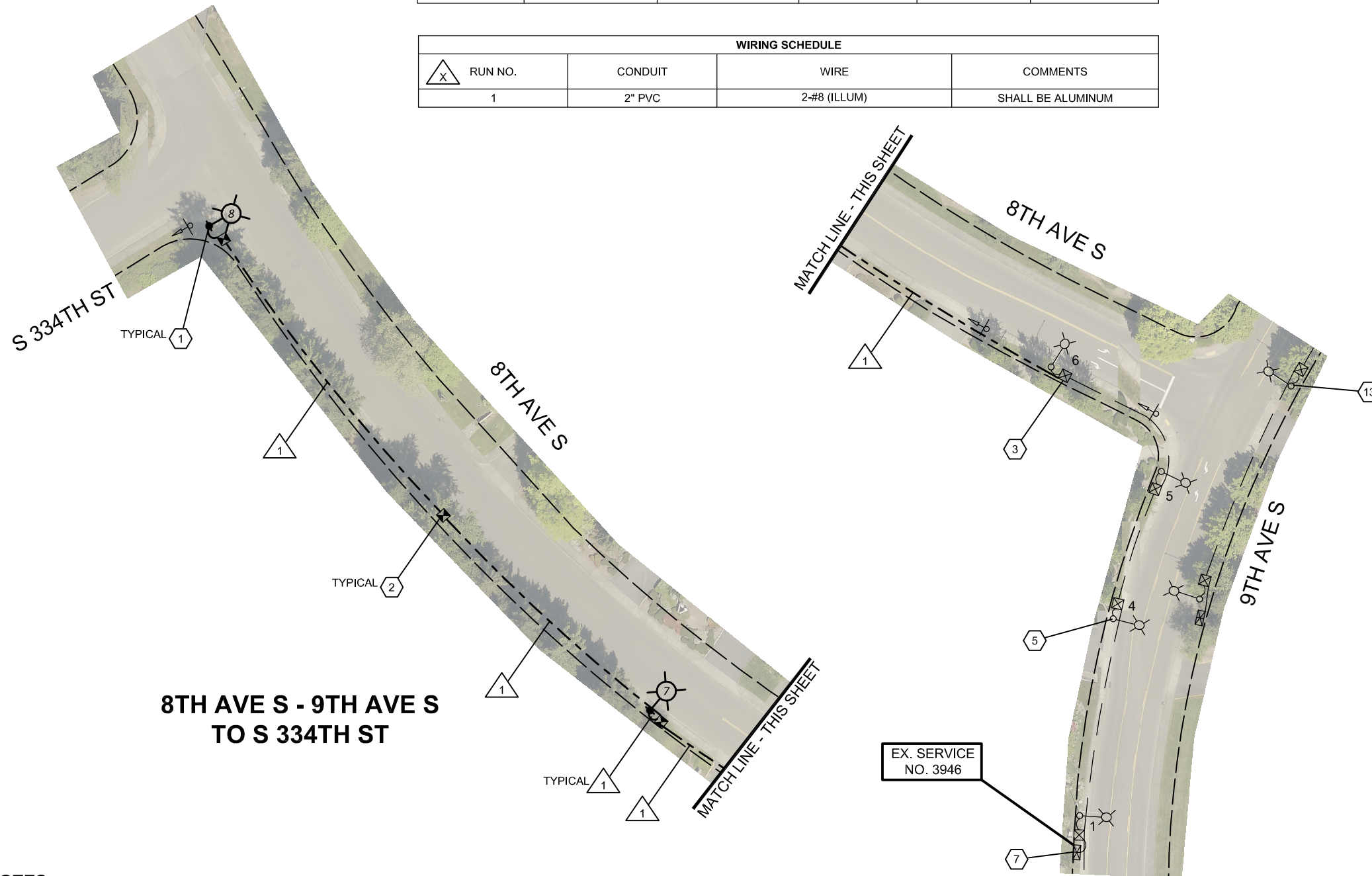

**GENERAL NOTES**

- 1. MAINTAIN AND PROTECT EXISTING FEATURES (TREES/ SHRUBS/ VEGETATION, DITCHES, DRIVEWAYS, ETC.) WITHIN PROJECT SITE UNLESS OTHERWISE NOTED.
- 2. UTILITIES ARE NOT SHOWN. IT IS THE CONTRACTOR'S RESPONSIBILITY TO AVOID AND PROTECT EXISTING UTILITIES AND RESOLVE CONFLICTS.
- 3. ALL LIGHT STANDARDS AND JUNCTION BOXES SHALL BE INSTALLED WITHIN A CONCRETE PAD IN ACCORDANCE WITH THE DETAIL ON SHEET 63.
- 4. ALL JUNCTION BOXES SHALL INCLUDE THE SYSTEM IDENTIFICATION LETTERS "LT".
- 5. LIGHT STANDARDS SHALL BE PLACED SUCH THAT THERE IS A MINIMUM OF 6 FT FROM CENTER OF STANDARD TO EDGE LINE OR FACE OF CURB. THE CONTRACTOR SHALL NOT PLACE LIGHT STANDARDS IN FORMAL OR INFORMAL WALKING PATHS. THE CONTRACTOR SHALL NOT IMPEDE SIGHT DISTANCE, SIGN VISIBILITY, OR USPS ACCESS WITH LIGHT STANDARD PLACEMENT.
- 6. THE LOCATIONS SHOWN OF POLES, JUNCTION BOXES, AND SERVICE CABINETS ARE APPROXIMATE AND SHOWN OVERSIZE. FIELD ADJUSTMENT MAY BE NECESSARY. SEE NOTES. ALL CONSTRUCTION AND ACTIVITIES SHALL BE LOCATED WITHIN CITY OF FEDERAL WAY PROPERTY. RIGHT-OF-WAY LINES SHOWN ARE APPROXIMATE.

**NOTES**

- 1. JUNCTION BOXES FOR 8TH AVE S ARE INTENDED TO HAVE SPACING OF APPROXIMATELY 190 FEET FOR INSTALLATION OF ADDITIONAL LIGHT STANDARDS IN THE FUTURE. THE CONTRACTOR SHALL BEAR THIS IN MIND WHEN PLACING THE JUNCTION BOXES AND ATTEMPT TO ADHERE TO THE SPACING AND PLAN LOCATIONS AS MUCH AS IS PRACTICABLE. THE CONTRACTING AGENCY UNDERSTANDS THAT FIELD CONDITIONS MAY PRECLUDE THIS. ANY JUNCTION BOX SPACING GREATER THAN 250 FEET WILL NEED TO BE COORDINATED AND APPROVED BY THE ENGINEER, PRIOR TO INSTALLATION. IF FEWER JUNCTION BOXES ARE INSTALLED THAN SHOWN IN THE PLANS, THOSE BOXES SHALL BE DELIVERED TO THE KING COUNTY SIGNAL SHOP AT THE CONTRACTOR'S EXPENSE.

LEGEND	
----	APPROXIMATE RIGHT-OF-WAY
---	CONDUIT AND WIRING
- - -	EX. CONDUIT AND WIRING
△	WIRE NOTE
○	CONSTRUCTION NOTE
⊙	LIGHT STANDARD AND LUMINAIRE
⊗	EX. CITY-OWNED LIGHT STANDARD AND LUMINAIRE
⊠	TYPE 1 JUNCTION BOX
⊠	EX. TYPE 1 JUNCTION BOX
⊠	EX. SERVICE CABINET
⊠	EX. SIGN AND POST TO BE MAINTAINED

100% DESIGN

**CITY OF Federal Way**  
Centered on Opportunity  
33325 8th Avenue South  
Federal Way, WA 98003-6325  
(253) 835-2700  
www.cityoffederalway.com

**811**  
Know what's below.  
Call 811 before you dig.

DRAFTED: D. MCINTOSH  
DESIGNED: K. DAVIS, P.E.  
REVIEWED: R. PEREZ, P.E.  
APPROVED: R. PEREZ, P.E.



DRAWING VERSION / REVISION LOG		
NO.	DATE	REVISION

**STREET LIGHT INFILL**  
**ILLUMINATION SYSTEM - GROUP D**  
**8 AVE S - 9 AVE S TO S 334 ST**

CITY PROJECT #:  
**26775**  
SHT. 46  
OF 76

K:\ENGINEERING DIVISION\PROJECTS\ACTIVE\26775 - Streetlight Infill\03 PE\ACAD\09-8.dwg 12/12/2023 3:21 PM

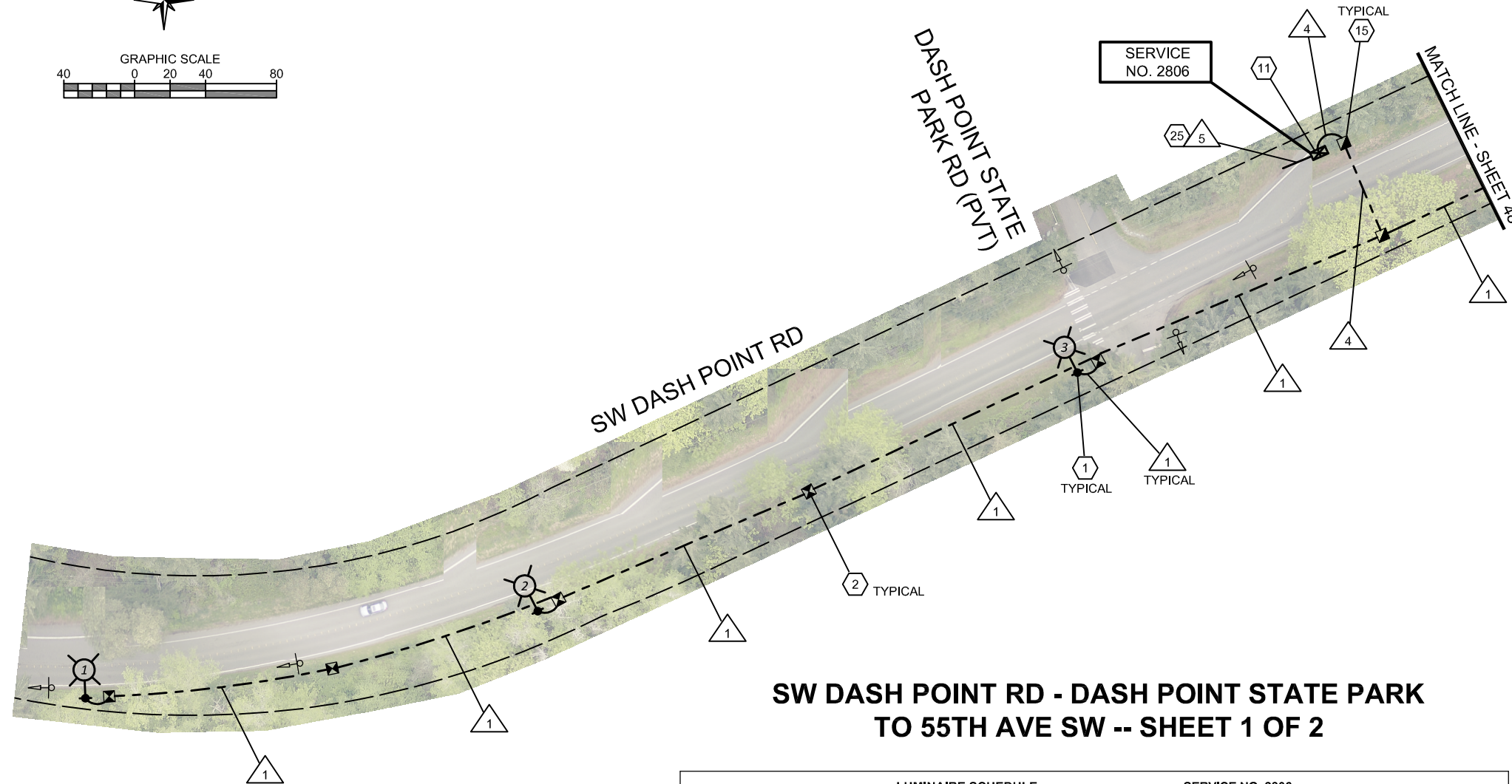
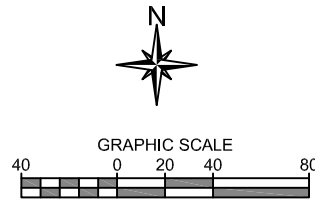

**SW DASH POINT RD - DASH POINT STATE PARK TO 55TH AVE SW -- SHEET 1 OF 2**

LUMINAIRE SCHEDULE			SERVICE NO. 2806		
PLAN NUMBER	ID NUMBER	SERVICE - CIRCUIT	TYPE - WATTS	MASTARM	MTG HEIGHT
1	2806-1-SL1-1	509/DPSP - 1	II - 90	12 FT	35 FT
2	2806-1-SL1-2	509/DPSP - 1	II - 90	12 FT	35 FT
3	2806-1-SL1-3	509/DPSP - 1	II - 90	12 FT	35 FT

WIRING SCHEDULE				
X RUN NO.	CONDUIT	WIRE	COMMENTS	
1	2" PVC	2-#8 (ILLUM)	SHALL BE ALUMINUM	
4	2" PVC	4-#8 (ILLUM)	SHALL BE ALUMINUM	
	2" PVC	SPARE	WITH GROUND AND PULL TAPE	
5	PER PSE (2" MINIMUM)	PER PSE (3-#6 MINIMUM)	PER PSE	

**CONSTRUCTION NOTES**

- 1 INSTALL LIGHT STANDARD FOUNDATION, POLE, DAVIT ARM, AND LUMINAIRE IN APPROXIMATE LOCATION SHOWN (3 LOCATIONS THIS SHEET) AND IN ACCORDANCE WITH MANUFACTURER RECOMMENDATIONS, SPECIAL PROVISIONS, AND THE DETAILS ON SHEETS 60 AND 61.
- 2 INSTALL TYPE 1 JUNCTION BOX (REFER TO STANDARD PLAN J-40.10 AND THE DETAILS ON SHEETS 65 AND 66) AT APPROXIMATE LOCATION SHOWN (5 BOXES THIS SHEET). SEE NOTES.
- 11 INSTALL FOUNDATION AND SERVICE CABINET IN APPROXIMATE LOCATION SHOWN (DOORS FACING SW DASH POINT RD) AND IN ACCORDANCE WITH THE DETAILS ON SHEETS 67 AND 68.
- 15 INSTALL TYPE 2 JUNCTION BOX (REFER TO STANDARD PLAN J-40.10 AND THE DETAILS ON SHEETS 65 AND 66) AT APPROXIMATE LOCATION SHOWN (2 BOXES THIS SHEET). SEE NOTES.
- 25 COORDINATE WITH SERVING UTILITY FOR ELECTRICAL CONNECTION POINT. RUN SERVICE CONDUCTOR IN ACCORDANCE WITH POWER UTILITY AND CITY OF FEDERAL WAY PERMIT REQUIREMENTS. CONTRACTOR SHALL SUPPLY ANY CONDUIT AND FITTINGS, JUNCTION BOXES, AND HARDWARE REQUIRED BY THE SERVING UTILITY FOR SERVICE.

**GENERAL NOTES**

- 1. MAINTAIN AND PROTECT EXISTING FEATURES (TREES/ SHRUBS/ VEGETATION, DITCHES, DRIVEWAYS, ETC.) WITHIN PROJECT SITE UNLESS OTHERWISE NOTED.
- 2. UTILITIES ARE NOT SHOWN. IT IS THE CONTRACTOR'S RESPONSIBILITY TO AVOID AND PROTECT EXISTING UTILITIES AND RESOLVE CONFLICTS.
- 3. ALL LIGHT STANDARDS AND JUNCTION BOXES SHALL BE INSTALLED WITHIN A CONCRETE PAD IN ACCORDANCE WITH THE DETAIL ON SHEET 63.
- 4. ALL JUNCTION BOXES SHALL INCLUDE THE SYSTEM IDENTIFICATION LETTERS "LT".
- 5. LIGHT STANDARDS SHALL BE PLACED SUCH THAT THERE IS A MINIMUM OF 6 FT FROM CENTER OF STANDARD TO EDGE LINE OR FACE OF CURB. THE CONTRACTOR SHALL NOT PLACE LIGHT STANDARDS IN FORMAL OR INFORMAL WALKING PATHS. THE CONTRACTOR SHALL NOT IMPEDE SIGHT DISTANCE, SIGN VISIBILITY, OR USPS ACCESS WITH LIGHT STANDARD PLACEMENT.
- 6. THE LOCATIONS SHOWN OF POLES, JUNCTION BOXES, AND SERVICE CABINETS ARE APPROXIMATE AND SHOWN OVERSIZE. FIELD ADJUSTMENT MAY BE NECESSARY. SEE NOTES. ALL CONSTRUCTION AND ACTIVITIES SHALL BE LOCATED WITHIN CITY OF FEDERAL WAY PROPERTY. RIGHT-OF-WAY LINES SHOWN ARE APPROXIMATE.

**LEGEND**

- APPROXIMATE RIGHT-OF-WAY
- CONDUIT AND WIRING
- △ WIRE NOTE
- CONSTRUCTION NOTE
- ⊕ LIGHT STANDARD AND LUMINAIRE
- ⊠ TYPE 1 JUNCTION BOX
- ⊡ TYPE 2 JUNCTION BOX
- ⊞ SERVICE CABINET
- ⊕ EX. SIGN AND POST TO BE MAINTAINED

**NOTES**

- 1. JUNCTION BOXES FOR SW DASH POINT RD ARE INTENDED TO HAVE SPACING OF APPROXIMATELY 175 FEET FOR INSTALLATION OF ADDITIONAL LIGHT STANDARDS IN THE FUTURE. THE CONTRACTOR SHALL BEAR THIS IN MIND WHEN PLACING THE JUNCTION BOXES AND ATTEMPT TO ADHERE TO THE SPACING AND PLAN LOCATIONS AS MUCH AS IS PRACTICABLE. THE CONTRACTING AGENCY UNDERSTANDS THAT FIELD CONDITIONS MAY PRECLUDE THIS. ANY JUNCTION BOX SPACING GREATER THAN 250 FEET WILL NEED TO BE COORDINATED AND APPROVED BY THE ENGINEER, PRIOR TO INSTALLATION. IF FEWER JUNCTION BOXES ARE INSTALLED THAN SHOWN IN THE PLANS, THOSE BOXES SHALL BE DELIVERED TO THE KING COUNTY SIGNAL SHOP AT THE CONTRACTOR'S EXPENSE.

100% DESIGN



DRAFTED: D. MCINTOSH  
 DESIGNED: K. DAVIS, P.E.  
 REVIEWED: R. PEREZ, P.E.  
 APPROVED: R. PEREZ, P.E.



DRAWING VERSION / REVISION LOG		
NO.	DATE	REVISION

**STREET LIGHT INFILL**

**ILLUMINATION SYSTEM - GROUP E**

**SW DASH POINT RD - DASH POINT STATE PARK TO 55 AVE SW**

CITY PROJECT #: 26775  
 SHT. 47  
 OF 76

K:\ENGINEERING DIVISION\PROJECTS\ACTIVE\26775 - Streetlight Infill\03 PE\ACAD\SR 509-CITY LINE.dwg 12/12/2023 2:54 PM



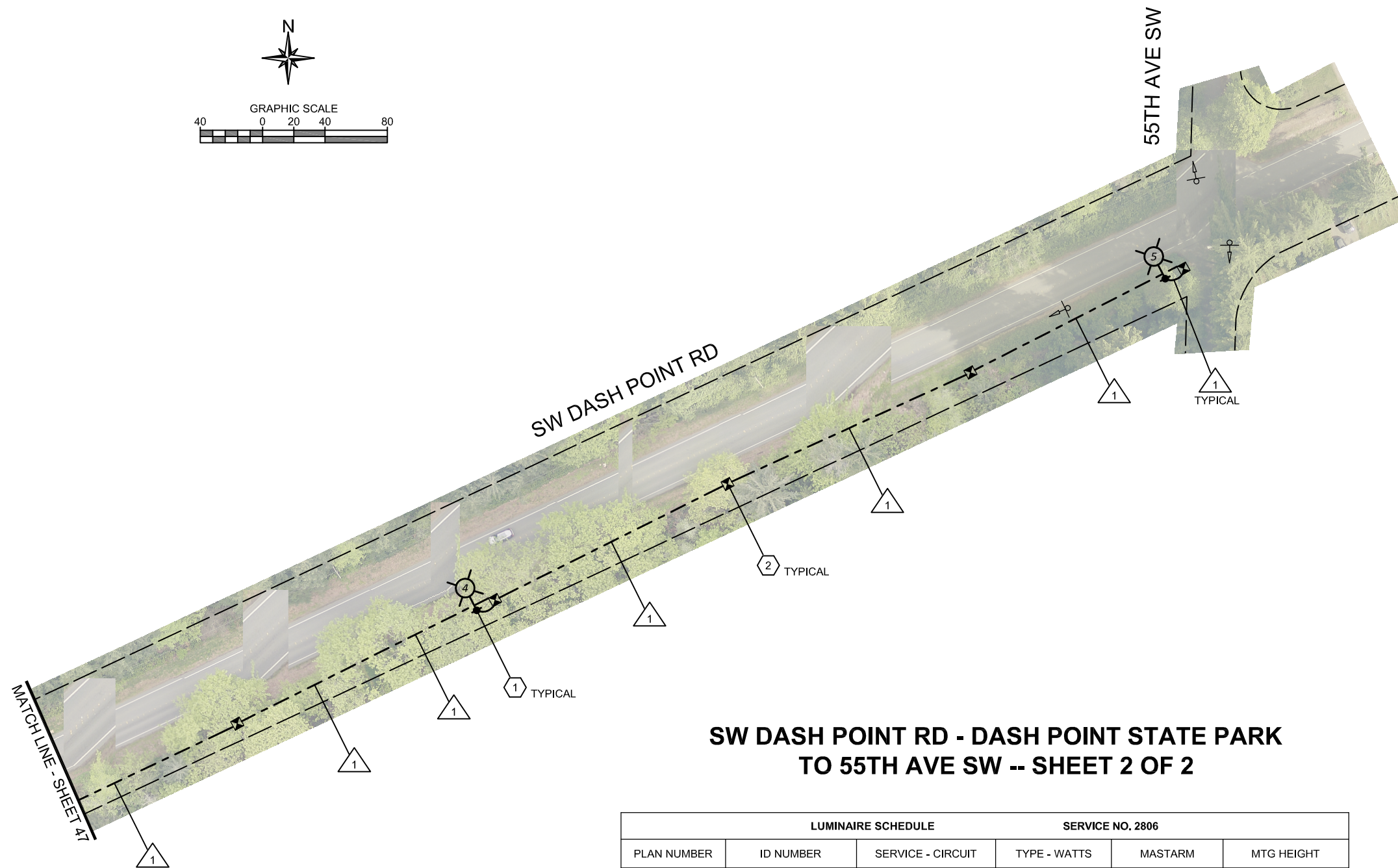
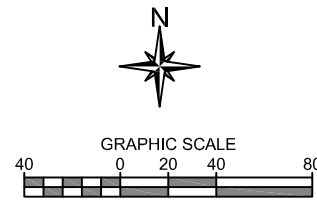

**CONSTRUCTION NOTES**

- ① INSTALL LIGHT STANDARD FOUNDATION, POLE, DAVIT ARM, AND LUMINAIRE IN APPROXIMATE LOCATION SHOWN (2 LOCATIONS THIS SHEET) AND IN ACCORDANCE WITH MANUFACTURER RECOMMENDATIONS, SPECIAL PROVISIONS, AND THE DETAILS ON SHEETS 60 AND 61.
- ② INSTALL TYPE 1 JUNCTION BOX (REFER TO STANDARD PLAN J-40.10 AND THE DETAILS ON SHEETS 65 AND 66) AT APPROXIMATE LOCATION SHOWN (5 BOXES THIS SHEET). SEE NOTES.

**GENERAL NOTES**

- 1. MAINTAIN AND PROTECT EXISTING FEATURES (TREES/ SHRUBS/ VEGETATION, DITCHES, DRIVEWAYS, ETC.) WITHIN PROJECT SITE UNLESS OTHERWISE NOTED.
- 2. UTILITIES ARE NOT SHOWN. IT IS THE CONTRACTOR'S RESPONSIBILITY TO AVOID AND PROTECT EXISTING UTILITIES AND RESOLVE CONFLICTS.
- 3. ALL LIGHT STANDARDS AND JUNCTION BOXES SHALL BE INSTALLED WITHIN A CONCRETE PAD IN ACCORDANCE WITH THE DETAIL ON SHEET 63.
- 4. ALL JUNCTION BOXES SHALL INCLUDE THE SYSTEM IDENTIFICATION LETTERS "LT".
- 5. LIGHT STANDARDS SHALL BE PLACED SUCH THAT THERE IS A MINIMUM OF 6 FT FROM CENTER OF STANDARD TO EDGE LINE OR FACE OF CURB. THE CONTRACTOR SHALL NOT PLACE LIGHT STANDARDS IN FORMAL OR INFORMAL WALKING PATHS. THE CONTRACTOR SHALL NOT IMPEDE SIGHT DISTANCE, SIGN VISIBILITY, OR USPS ACCESS WITH LIGHT STANDARD PLACEMENT.
- 6. THE LOCATIONS SHOWN OF POLES, JUNCTION BOXES, AND SERVICE CABINETS ARE APPROXIMATE AND SHOWN OVERSIZE. FIELD ADJUSTMENT MAY BE NECESSARY. SEE NOTES. ALL CONSTRUCTION AND ACTIVITIES SHALL BE LOCATED WITHIN CITY OF FEDERAL WAY PROPERTY. RIGHT-OF-WAY LINES SHOWN ARE APPROXIMATE.

**SW DASH POINT RD - DASH POINT STATE PARK TO 55TH AVE SW -- SHEET 2 OF 2**

LUMINAIRE SCHEDULE			SERVICE NO. 2806		
PLAN NUMBER	ID NUMBER	SERVICE - CIRCUIT	TYPE - WATTS	MASTARM	MTG HEIGHT
4	2806-1-SL2-4	509/DPSP - 2	II - 90	12 FT	35 FT
5	2806-1-SL2-5	509/DPSP - 2	II - 90	12 FT	35 FT

WIRING SCHEDULE				
X	RUN NO.	CONDUIT	WIRE	COMMENTS
	1	2" PVC	2-#8 (ILLUM)	SHALL BE ALUMINUM

**LEGEND**

---	APPROXIMATE RIGHT-OF-WAY	⊠	TYPE 1 JUNCTION BOX
---	CONDUIT AND WIRING	⊕	EX. SIGN AND POST TO BE MAINTAINED
△	WIRE NOTE		
⬡	CONSTRUCTION NOTE		
⊕	LIGHT STANDARD AND LUMINAIRE		

**NOTES**

- 1. JUNCTION BOXES FOR SW DASH POINT RD ARE INTENDED TO HAVE SPACING OF APPROXIMATELY 175 FEET FOR INSTALLATION OF ADDITIONAL LIGHT STANDARDS IN THE FUTURE. THE CONTRACTOR SHALL BEAR THIS IN MIND WHEN PLACING THE JUNCTION BOXES AND ATTEMPT TO ADHERE TO THE SPACING AND PLAN LOCATIONS AS MUCH AS IS PRACTICABLE. THE CONTRACTING AGENCY UNDERSTANDS THAT FIELD CONDITIONS MAY PRECLUDE THIS. ANY JUNCTION BOX SPACING GREATER THAN 250 FEET WILL NEED TO BE COORDINATED AND APPROVED BY THE ENGINEER, PRIOR TO INSTALLATION. IF FEWER JUNCTION BOXES ARE INSTALLED THAN SHOWN IN THE PLANS, THOSE BOXES SHALL BE DELIVERED TO THE KING COUNTY SIGNAL SHOP AT THE CONTRACTOR'S EXPENSE.

100% DESIGN

**CITY OF Federal Way**  
Centered on Opportunity  
33325 8th Avenue South  
Federal Way, WA 98003-6325  
(253) 835-2700  
www.cityoffederalway.com

**811**  
Know what's below.  
Call 811 before you dig.

DRAFTED: D. MCINTOSH  
DESIGNED: K. DAVIS, P.E.  
REVIEWED: R. PEREZ, P.E.  
APPROVED: R. PEREZ, P.E.



**DRAWING VERSION / REVISION LOG**

NO.	DATE	REVISION

**STREET LIGHT INFILL**

**ILLUMINATION SYSTEM - GROUP E**

**SW DASH POINT RD - DASH POINT STATE PARK TO 55 AVE SW**

CITY PROJECT #: 26775  
SHT. 48  
OF 76

K:\ENGINEERING DIVISION\PROJECTS\ACTIVE\26775 - Streetlight Infill\03 PE\ACAD\SR 509-CITY LINE.dwg 12/12/2023 2:56 PM

**16TH AVE SW - SW DASH POINT RD  
TO SW 304TH ST -- SHEET 1 OF 3**

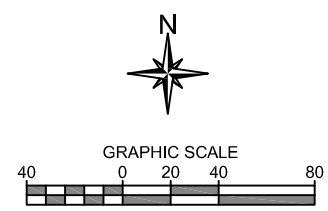
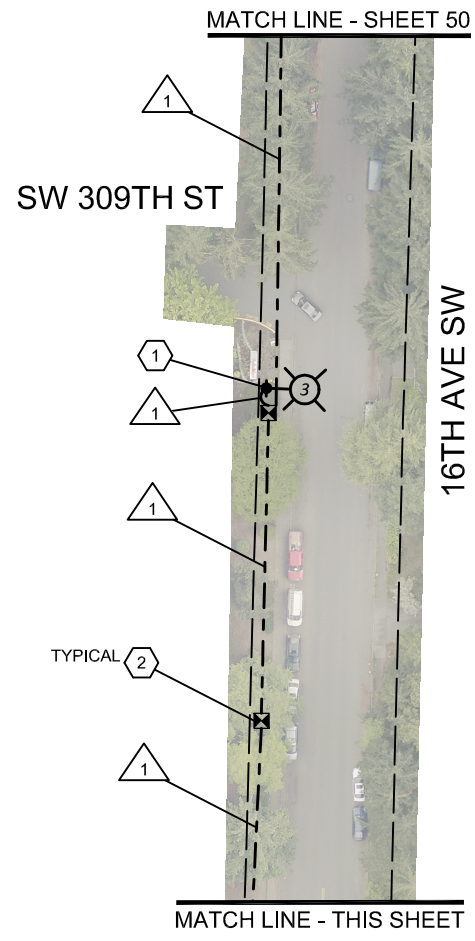
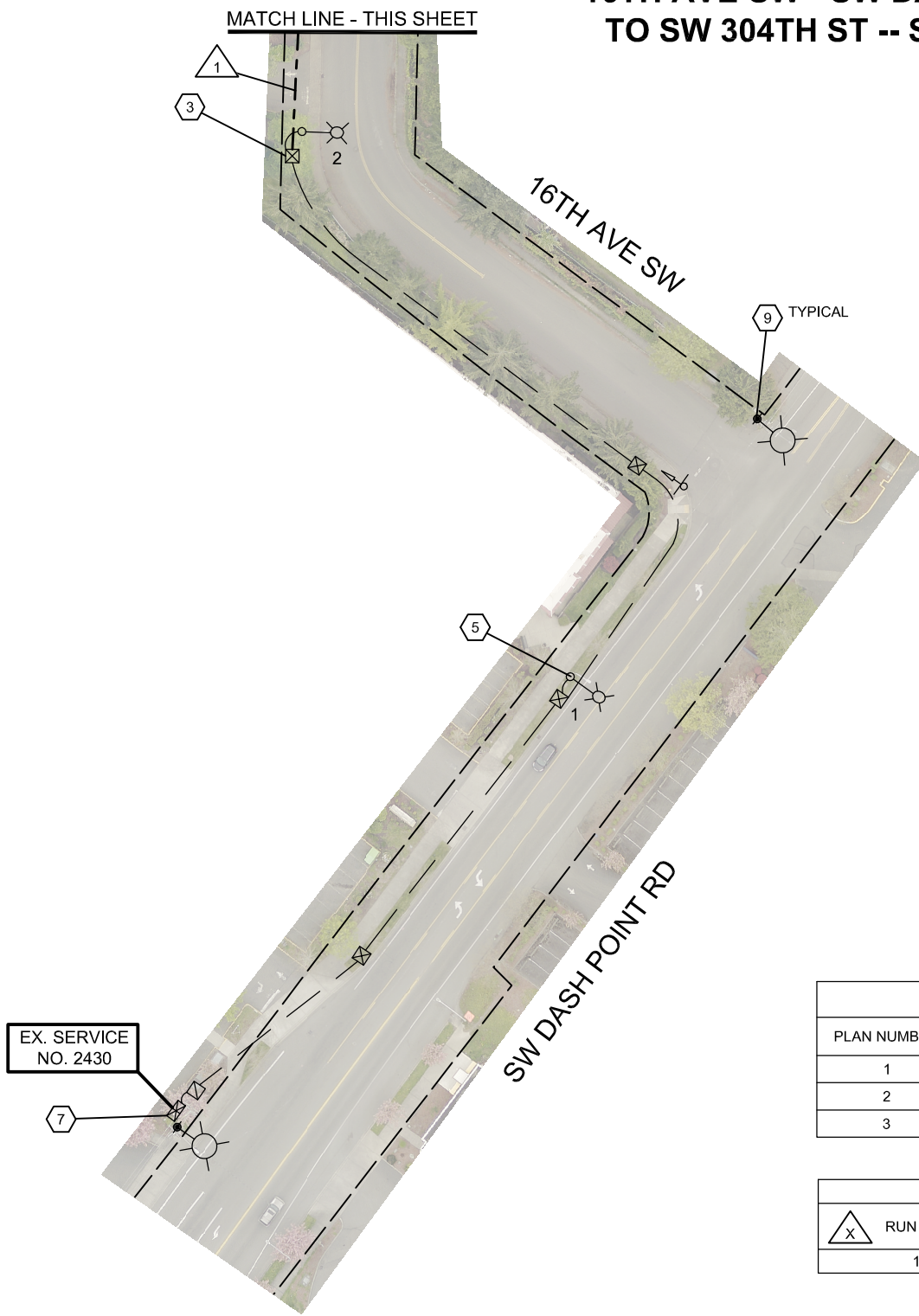

**CONSTRUCTION NOTES**

- 1. INSTALL LIGHT STANDARD FOUNDATION, POLE, DAVIT ARM, AND LUMINAIRE IN APPROXIMATE LOCATION SHOWN (1 LOCATION THIS SHEET) AND IN ACCORDANCE WITH MANUFACTURER RECOMMENDATIONS, SPECIAL PROVISIONS, AND THE DETAILS ON SHEETS 60 AND 61.
- 2. INSTALL TYPE 1 JUNCTION BOX (REFER TO STANDARD PLAN J-40.10 AND THE DETAILS ON SHEETS 65 AND 66) AT APPROXIMATE LOCATION SHOWN (2 BOXES THIS SHEET). SEE NOTES.
- 3. INSTALL CONDUIT INTO EXISTING JUNCTION BOX. SPLICE NEW CONDUCTORS TO EXISTING ILLUMINATION CONDUCTORS.
- 5. MAINTAIN AND PROTECT EXISTING ILLUMINATION SYSTEM.
- 7. EXISTING SERVICE CABINET TO BE USED FOR PROPOSED LIGHT STANDARDS FOR 16 AVE SW - SW DASH POINT RD TO SW 304 ST.
- 9. EXISTING PSE LUMINAIRE MOUNTED ON PSE POLE (2 LOCATIONS THIS SHEET).

**GENERAL NOTES**

- 1. MAINTAIN AND PROTECT EXISTING FEATURES (TREES/ SHRUBS/ VEGETATION, DITCHES, DRIVEWAYS, ETC.) WITHIN PROJECT SITE UNLESS OTHERWISE NOTED.
- 2. UTILITIES ARE NOT SHOWN. IT IS THE CONTRACTOR'S RESPONSIBILITY TO AVOID AND PROTECT EXISTING UTILITIES AND RESOLVE CONFLICTS.
- 3. ALL LIGHT STANDARDS AND JUNCTION BOXES SHALL BE INSTALLED WITHIN A CONCRETE PAD IN ACCORDANCE WITH THE DETAIL ON SHEET 63.
- 4. ALL JUNCTION BOXES SHALL INCLUDE THE SYSTEM IDENTIFICATION LETTERS "LT".
- 5. LIGHT STANDARDS SHALL BE PLACED SUCH THAT THERE IS A MINIMUM OF 6 FT FROM CENTER OF STANDARD TO EDGE LINE OR FACE OF CURB. THE CONTRACTOR SHALL NOT PLACE LIGHT STANDARDS IN FORMAL OR INFORMAL WALKING PATHS. THE CONTRACTOR SHALL NOT IMPEDE SIGHT DISTANCE, SIGN VISIBILITY, OR USPS ACCESS WITH LIGHT STANDARD PLACEMENT.
- 6. THE LOCATIONS SHOWN OF POLES, JUNCTION BOXES, AND SERVICE CABINETS ARE APPROXIMATE AND SHOWN OVERSIZE. FIELD ADJUSTMENT MAY BE NECESSARY. SEE NOTES. ALL CONSTRUCTION AND ACTIVITIES SHALL BE LOCATED WITHIN CITY OF FEDERAL WAY PROPERTY. RIGHT-OF-WAY LINES SHOWN ARE APPROXIMATE.

LUMINAIRE SCHEDULE			SERVICE NO. 2430		
PLAN NUMBER	ID NUMBER	SERVICE - CIRCUIT	TYPE - WATTS	MASTARM	MTG HEIGHT
1	2430-1-SL1-1 (EX.)	509/311 - 1	EX.	EX.	EX.
2	2430-1-SL1-2 (EX.)	509/311 - 1	EX.	EX.	EX.
3	2430-1-SL1-3	509/311 - 1	II - 60	8 FT	30 FT

WIRING SCHEDULE			
△ X RUN NO.	CONDUIT	WIRE	COMMENTS
1	2" PVC	2-#8 (ILLUM)	SHALL BE ALUMINUM

**NOTES**

- 1. JUNCTION BOXES FOR 16TH AVE SW ARE INTENDED TO HAVE SPACING OF APPROXIMATELY 190 FEET FOR INSTALLATION OF ADDITIONAL LIGHT STANDARDS IN THE FUTURE. THE CONTRACTOR SHALL BEAR THIS IN MIND WHEN PLACING THE JUNCTION BOXES AND ATTEMPT TO ADHERE TO THE SPACING AND PLAN LOCATIONS AS MUCH AS IS PRACTICABLE. THE CONTRACTING AGENCY UNDERSTANDS THAT FIELD CONDITIONS MAY PRECLUDE THIS. ANY JUNCTION BOX SPACING GREATER THAN 250 FEET WILL NEED TO BE COORDINATED AND APPROVED BY THE ENGINEER, PRIOR TO INSTALLATION. IF FEWER JUNCTION BOXES ARE INSTALLED THAN SHOWN IN THE PLANS, THOSE BOXES SHALL BE DELIVERED TO THE KING COUNTY SIGNAL SHOP AT THE CONTRACTOR'S EXPENSE.

**LEGEND**

- APPROXIMATE RIGHT-OF-WAY
- CONDUIT AND WIRING
- - - EX. CONDUIT AND WIRING
- △ WIRE NOTE
- CONSTRUCTION NOTE
- ⊕ LIGHT STANDARD AND LUMINAIRE
- ⊕ EX. CITY-OWNED LIGHT STANDARD AND LUMINAIRE
- ⊕ EX. PSE LUMINAIRE AND POLE
- ⊠ TYPE 1 JUNCTION BOX
- ⊠ EX. TYPE 1 JUNCTION BOX
- ⊠ EX. TYPE 2 JUNCTION BOX
- ⊠ EX. SERVICE CABINET
- ⊕ EX. SIGN AND POST TO BE MAINTAINED

100% DESIGN

**CITY OF Federal Way**  
Centered on Opportunity  
33325 8th Avenue South  
Federal Way, WA 98003-6325  
(253) 835-2700  
www.cityoffederalway.com

**811**  
Know what's below.  
Call 811 before you dig.

DRAFTED: D. MCINTOSH  
DESIGNED: K. DAVIS, P.E.  
REVIEWED: R. PEREZ, P.E.  
APPROVED: R. PEREZ, P.E.



DRAWING VERSION / REVISION LOG		
NO.	DATE	REVISION

**STREET LIGHT INFILL**  
**ILLUMINATION SYSTEM - GROUP F**  
**16 AVE SW - SW DASH POINT RD TO SW 304 ST**

CITY PROJECT #:  
**26775**  
SHT. **49**  
OF **76**

K:\ENGINEERING DIVISION\PROJECTS\ACTIVE\26775 - Streetlight Infill\03 PE\ACAD\16-SR-509.dwg 12/12/2023 2:58 PM



**CONSTRUCTION NOTES**

- ① INSTALL LIGHT STANDARD FOUNDATION, POLE, DAVIT ARM, AND LUMINAIRE IN APPROXIMATE LOCATION SHOWN (2 LOCATIONS THIS SHEET) AND IN ACCORDANCE WITH MANUFACTURER RECOMMENDATIONS, SPECIAL PROVISIONS, AND THE DETAILS ON SHEETS 60 AND 61.
- ② INSTALL TYPE 1 JUNCTION BOX (REFER TO STANDARD PLAN J-40.10 AND THE DETAILS ON SHEETS 65 AND 66) AT APPROXIMATE LOCATION SHOWN (4 BOXES THIS SHEET). SEE NOTES.

**GENERAL NOTES**

- 1. MAINTAIN AND PROTECT EXISTING FEATURES (TREES/ SHRUBS/ VEGETATION, DITCHES, DRIVEWAYS, ETC.) WITHIN PROJECT SITE UNLESS OTHERWISE NOTED.
- 2. UTILITIES ARE NOT SHOWN. IT IS THE CONTRACTOR'S RESPONSIBILITY TO AVOID AND PROTECT EXISTING UTILITIES AND RESOLVE CONFLICTS.
- 3. ALL LIGHT STANDARDS AND JUNCTION BOXES SHALL BE INSTALLED WITHIN A CONCRETE PAD IN ACCORDANCE WITH THE DETAIL ON SHEET 63.
- 4. ALL JUNCTION BOXES SHALL INCLUDE THE SYSTEM IDENTIFICATION LETTERS "LT".
- 5. LIGHT STANDARDS SHALL BE PLACED SUCH THAT THERE IS A MINIMUM OF 6 FT FROM CENTER OF STANDARD TO EDGE LINE OR FACE OF CURB. THE CONTRACTOR SHALL NOT PLACE LIGHT STANDARDS IN FORMAL OR INFORMAL WALKING PATHS. THE CONTRACTOR SHALL NOT IMPEDE SIGHT DISTANCE, SIGN VISIBILITY, OR USPS ACCESS WITH LIGHT STANDARD PLACEMENT.
- 6. THE LOCATIONS SHOWN OF POLES, JUNCTION BOXES, AND SERVICE CABINETS ARE APPROXIMATE AND SHOWN OVERSIZE. FIELD ADJUSTMENT MAY BE NECESSARY. SEE NOTES. ALL CONSTRUCTION AND ACTIVITIES SHALL BE LOCATED WITHIN CITY OF FEDERAL WAY PROPERTY. RIGHT-OF-WAY LINES SHOWN ARE APPROXIMATE.

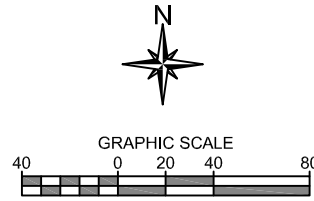
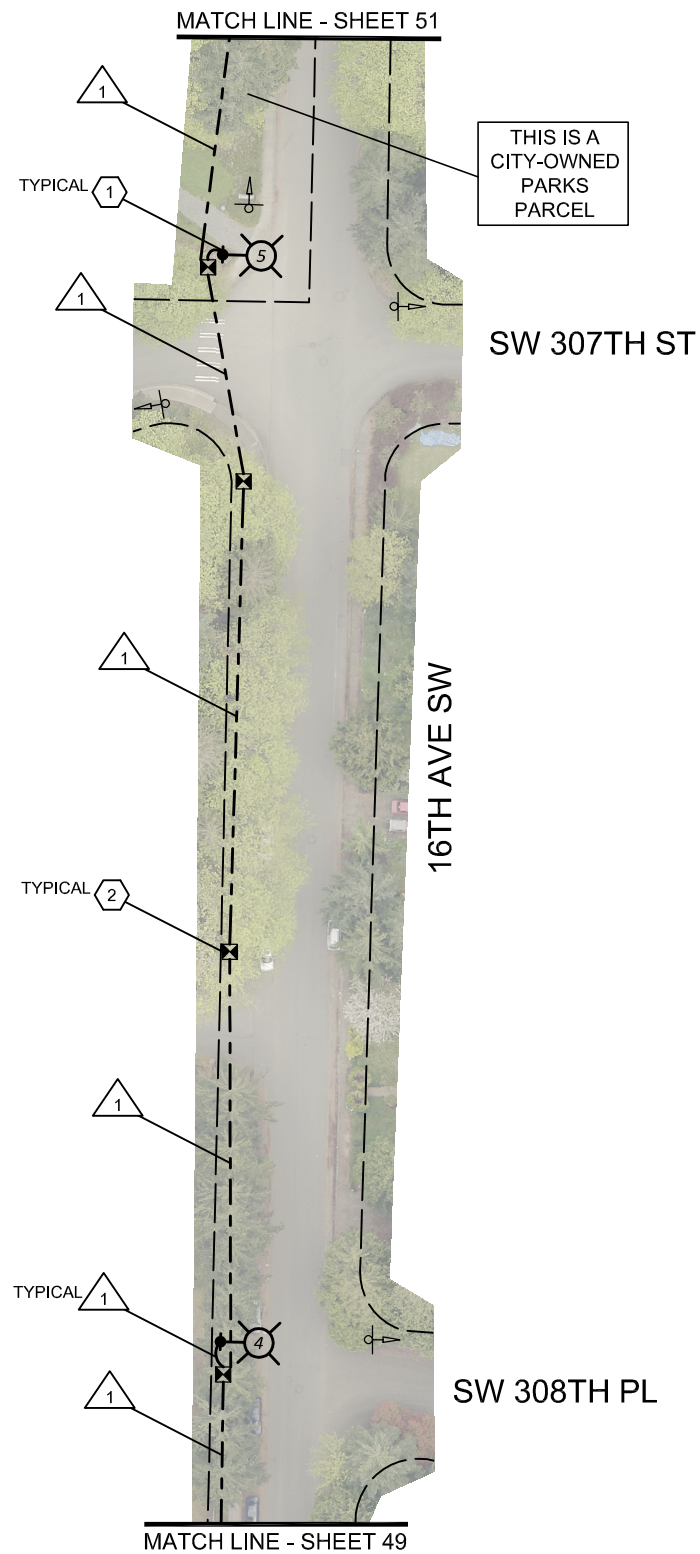

**16TH AVE SW - SW DASH POINT RD TO SW 304TH ST -- SHEET 2 OF 3**

LUMINAIRE SCHEDULE			SERVICE NO. 2430		
PLAN NUMBER	ID NUMBER	SERVICE - CIRCUIT	TYPE - WATTS	MASTARM	MTG HEIGHT
4	2430-1-SL1-4	509/311 - 1	II - 60	8 FT	30 FT
5	2430-1-SL1-5	509/311 - 1	II - 60	8 FT	30 FT

WIRING SCHEDULE				
△ X	RUN NO.	CONDUIT	WIRE	COMMENTS
	1	2" PVC	2-#8 (ILLUM)	SHALL BE ALUMINUM

**NOTES**

- 1. JUNCTION BOXES FOR 16TH AVE SW ARE INTENDED TO HAVE SPACING OF APPROXIMATELY 190 FEET FOR INSTALLATION OF ADDITIONAL LIGHT STANDARDS IN THE FUTURE. THE CONTRACTOR SHALL BEAR THIS IN MIND WHEN PLACING THE JUNCTION BOXES AND ATTEMPT TO ADHERE TO THE SPACING AND PLAN LOCATIONS AS MUCH AS IS PRACTICABLE. THE CONTRACTING AGENCY UNDERSTANDS THAT FIELD CONDITIONS MAY PRECLUDE THIS. ANY JUNCTION BOX SPACING GREATER THAN 250 FEET WILL NEED TO BE COORDINATED AND APPROVED BY THE ENGINEER, PRIOR TO INSTALLATION. IF FEWER JUNCTION BOXES ARE INSTALLED THAN SHOWN IN THE PLANS, THOSE BOXES SHALL BE DELIVERED TO THE KING COUNTY SIGNAL SHOP AT THE CONTRACTOR'S EXPENSE.

**LEGEND**

- APPROXIMATE RIGHT-OF-WAY
- CONDUIT AND WIRING
- △ WIRE NOTE
- CONSTRUCTION NOTE
- ⊙ LIGHT STANDARD AND LUMINAIRE
- ⊠ TYPE 1 JUNCTION BOX
- ⊕ EX. SIGN AND POST TO BE MAINTAINED

100% DESIGN



DRAFTED: D. MCINTOSH  
 DESIGNED: K. DAVIS, P.E.  
 REVIEWED: R. PEREZ, P.E.  
 APPROVED: R. PEREZ, P.E.



DRAWING VERSION / REVISION LOG		
NO.	DATE	REVISION

**STREET LIGHT INFILL**

**ILLUMINATION SYSTEM - GROUP F**

**16 AVE SW - SW DASH POINT RD TO SW 304 ST**

CITY PROJECT #: 26775  
 SHT. 50  
 OF 76

**CONSTRUCTION NOTES**

- ① INSTALL LIGHT STANDARD FOUNDATION, POLE, DAVIT ARM, AND LUMINAIRE IN APPROXIMATE LOCATION SHOWN (3 LOCATIONS THIS SHEET) AND IN ACCORDANCE WITH MANUFACTURER RECOMMENDATIONS, SPECIAL PROVISIONS, AND THE DETAILS ON SHEETS 60 AND 61.
- ② INSTALL TYPE 1 JUNCTION BOX (REFER TO STANDARD PLAN J-40.10 AND THE DETAILS ON SHEETS 65 AND 66) AT APPROXIMATE LOCATION SHOWN (6 BOXES THIS SHEET). SEE NOTES.
- ⑭ MAINTAIN AND PROTECT EXISTING SCHOOL SPEED SIGN AND ASSOCIATED INFRASTRUCTURE.

**GENERAL NOTES**

- 1. MAINTAIN AND PROTECT EXISTING FEATURES (TREES/ SHRUBS/ VEGETATION, DITCHES, DRIVEWAYS, ETC.) WITHIN PROJECT SITE UNLESS OTHERWISE NOTED.
- 2. UTILITIES ARE NOT SHOWN. IT IS THE CONTRACTOR'S RESPONSIBILITY TO AVOID AND PROTECT EXISTING UTILITIES AND RESOLVE CONFLICTS.
- 3. ALL LIGHT STANDARDS AND JUNCTION BOXES SHALL BE INSTALLED WITHIN A CONCRETE PAD IN ACCORDANCE WITH THE DETAIL ON SHEET 63.
- 4. ALL JUNCTION BOXES SHALL INCLUDE THE SYSTEM IDENTIFICATION LETTERS "LT".
- 5. LIGHT STANDARDS SHALL BE PLACED SUCH THAT THERE IS A MINIMUM OF 6 FT FROM CENTER OF STANDARD TO EDGE LINE OR FACE OF CURB. THE CONTRACTOR SHALL NOT PLACE LIGHT STANDARDS IN FORMAL OR INFORMAL WALKING PATHS. THE CONTRACTOR SHALL NOT IMPEDE SIGHT DISTANCE, SIGN VISIBILITY, OR USPS ACCESS WITH LIGHT STANDARD PLACEMENT.
- 6. THE LOCATIONS SHOWN OF POLES, JUNCTION BOXES, AND SERVICE CABINETS ARE APPROXIMATE AND SHOWN OVERSIZE. FIELD ADJUSTMENT MAY BE NECESSARY. SEE NOTES. ALL CONSTRUCTION AND ACTIVITIES SHALL BE LOCATED WITHIN CITY OF FEDERAL WAY PROPERTY. RIGHT-OF-WAY LINES SHOWN ARE APPROXIMATE.

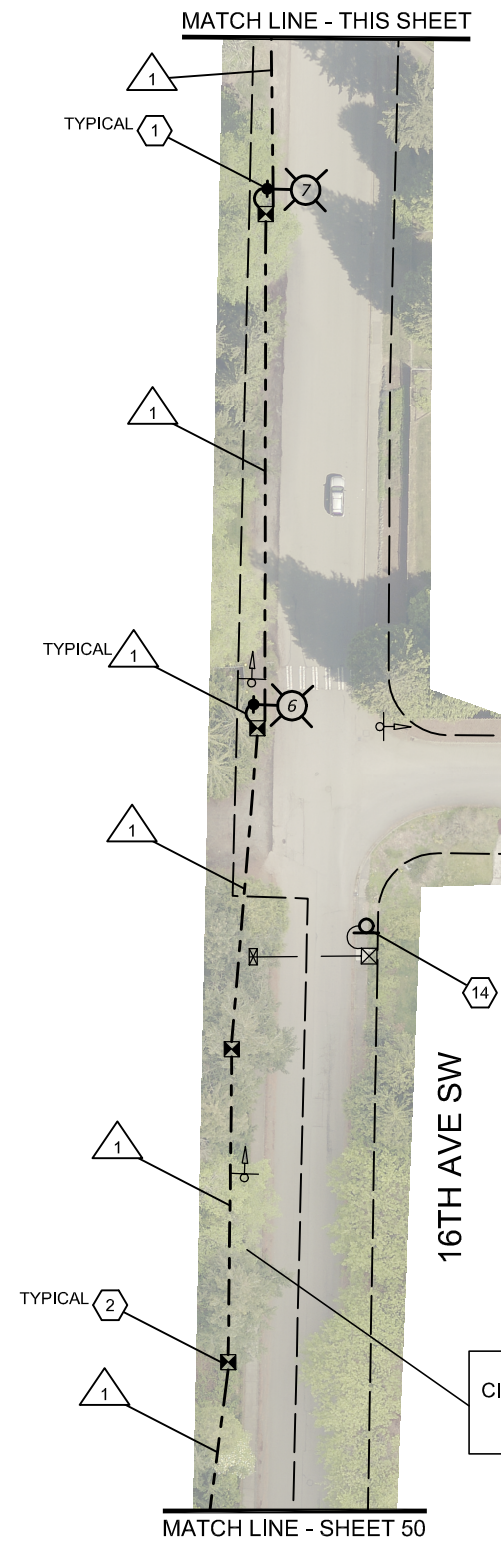
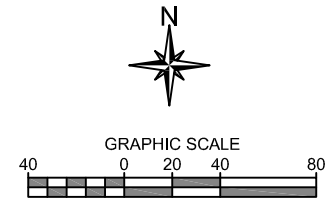

**16TH AVE SW - SW DASH POINT RD TO SW 304TH ST -- SHEET 3 OF 3**

SW 304TH ST

SW 306TH ST

16TH AVE SW

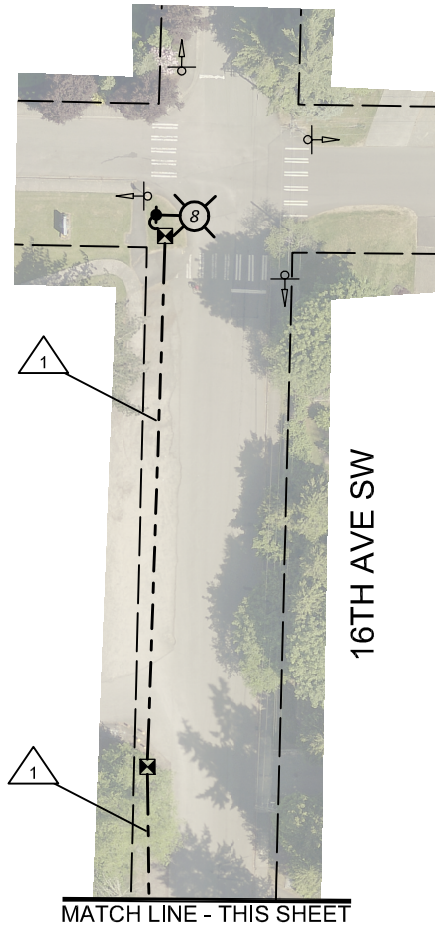

LUMINAIRE SCHEDULE			SERVICE NO. 2430		
PLAN NUMBER	ID NUMBER	SERVICE - CIRCUIT	TYPE - WATTS	MASTARM	MTG HEIGHT
6	2430-1-SL1-6	509/311 - 1	II - 60	8 FT	30 FT
7	2430-1-SL1-7	509/311 - 1	II - 60	8 FT	30 FT
8	2430-1-SL1-8	509/311 - 1	II - 60	8 FT	30 FT

WIRING SCHEDULE			
△ RUN NO.	CONDUIT	WIRE	COMMENTS
1	2" PVC	2-#8 (ILLUM)	SHALL BE ALUMINUM

**NOTES**

- 1. JUNCTION BOXES FOR 16TH AVE SW ARE INTENDED TO HAVE SPACING OF APPROXIMATELY 190 FEET FOR INSTALLATION OF ADDITIONAL LIGHT STANDARDS IN THE FUTURE. THE CONTRACTOR SHALL BEAR THIS IN MIND WHEN PLACING THE JUNCTION BOXES AND ATTEMPT TO ADHERE TO THE SPACING AND PLAN LOCATIONS AS MUCH AS IS PRACTICABLE. THE CONTRACTING AGENCY UNDERSTANDS THAT FIELD CONDITIONS MAY PRECLUDE THIS. ANY JUNCTION BOX SPACING GREATER THAN 250 FEET WILL NEED TO BE COORDINATED AND APPROVED BY THE ENGINEER, PRIOR TO INSTALLATION. IF FEWER JUNCTION BOXES ARE INSTALLED THAN SHOWN IN THE PLANS, THOSE BOXES SHALL BE DELIVERED TO THE KING COUNTY SIGNAL SHOP AT THE CONTRACTOR'S EXPENSE.

**LEGEND**

- APPROXIMATE RIGHT-OF-WAY
- - - CONDUIT AND WIRING
- - - EXISTING UNDERGROUND CONDUIT
- △ WIRE NOTE
- ① CONSTRUCTION NOTE
- ⊕ LIGHT STANDARD AND LUMINAIRE
- ⊗ EX. METER BASE
- ⊠ TYPE 1 JUNCTION BOX
- ⊡ EX. TYPE 1 JUNCTION BOX
- ⊕ EX. SIGN AND POST TO BE MAINTAINED
- ⊗ EX. SCHOOL SPEED SIGN OR FLASHING BEACONS

100% DESIGN

DRAFTED: D. MCINTOSH  
 DESIGNED: K. DAVIS, P.E.  
 REVIEWED: R. PEREZ, P.E.  
 APPROVED: R. PEREZ, P.E.

DRAWING VERSION / REVISION LOG		
NO.	DATE	REVISION

**STREET LIGHT INFILL**

**ILLUMINATION SYSTEM - GROUP F**

**16 AVE SW - SW DASH POINT RD TO SW 304 ST**

CITY PROJECT #: 26775  
 SHT. 51  
 OF 76

K:\ENGINEERING DIVISION\PROJECTS\ACTIVE\26775 - Streetlight Infill\03 PE\ACAD\16-SR 509.dwg 12/12/2023 2:59 PM



LUMINAIRE SCHEDULE			SERVICE NO. 3542		
PLAN NUMBER	ID NUMBER	SERVICE - CIRCUIT	TYPE - WATTS	MASTARM	MTG HEIGHT
1	3542-1-SL1-1	328 PL - 1	II - 60	8 FT	30 FT
2	3542-1-SL1-2	328 PL - 1	II - 60	8 FT	30 FT
3	3542-1-SL2-3	328 PL - 2	II - 60	8 FT	30 FT
4	3542-1-SL2-4	328 PL - 2	II - 60	8 FT	30 FT
5	3542-1-SL2-5	328 PL - 2	II - 60	8 FT	30 FT
6	3542-1-SL2-6	328 PL - 2	II - 60	8 FT	30 FT

WIRING SCHEDULE			
△ X RUN NO.	CONDUIT	WIRE	COMMENTS
1	2" PVC	2-#8 (ILLUM)	SHALL BE ALUMINUM
4	2" PVC	4-#8 (ILLUM)	SHALL BE ALUMINUM
	2" PVC	SPARE	WITH GROUND AND PULL TAPE
5	PER PSE (2" MINIMUM)	PER PSE (3-#6 MINIMUM)	PER PSE

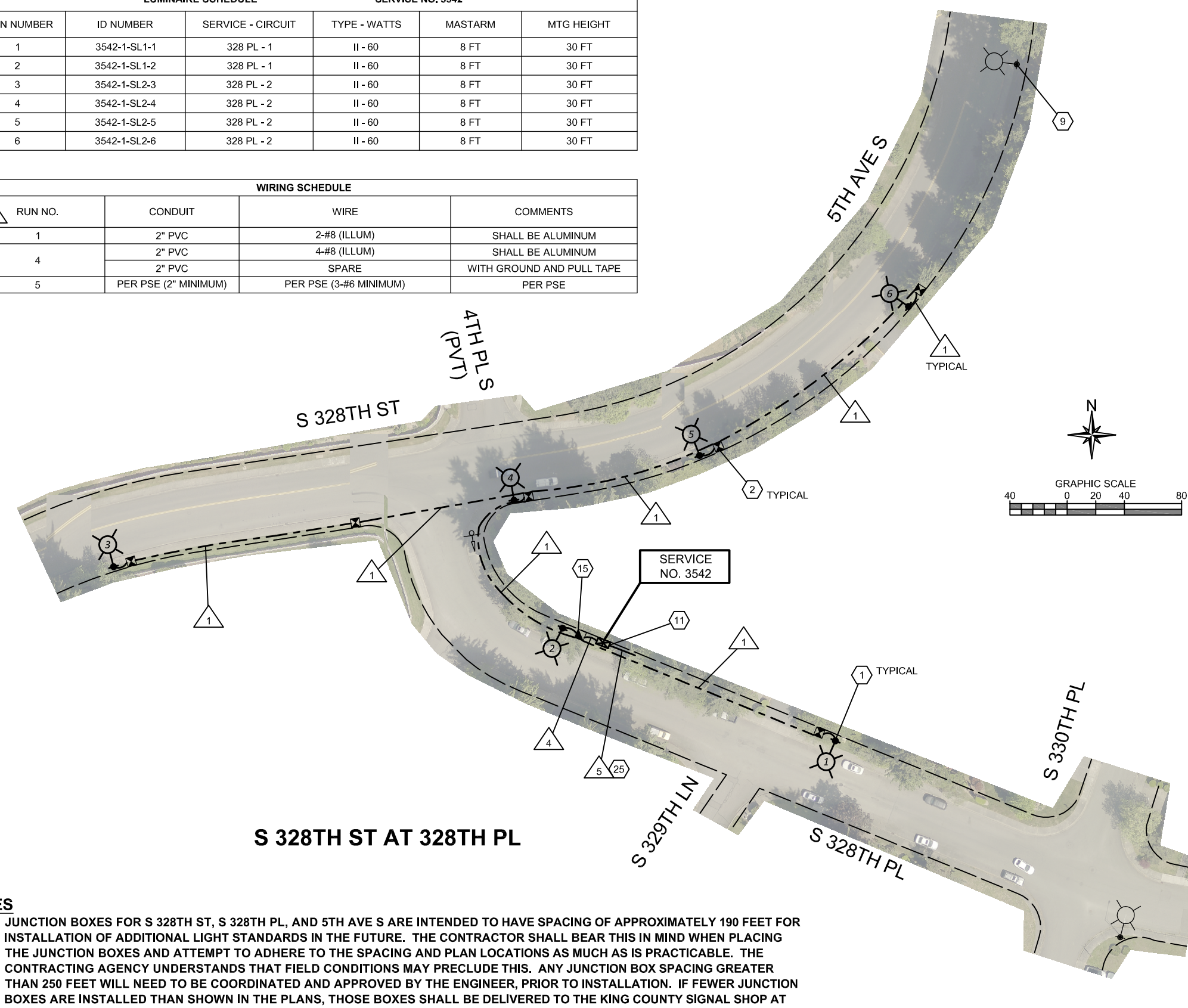

**CONSTRUCTION NOTES**

- ① INSTALL LIGHT STANDARD FOUNDATION, POLE, DAVIT ARM, AND LUMINAIRE IN APPROXIMATE LOCATION SHOWN (6 LOCATIONS THIS SHEET) AND IN ACCORDANCE WITH MANUFACTURER RECOMMENDATIONS, SPECIAL PROVISIONS, AND THE DETAILS ON SHEETS 60 AND 61.
- ② INSTALL TYPE 1 JUNCTION BOX (REFER TO STANDARD PLAN J-40.10 AND THE DETAILS ON SHEETS 65 AND 66) AT APPROXIMATE LOCATION SHOWN (6 BOXES THIS SHEET). SEE NOTES.
- ⑨ EXISTING PSE LUMINAIRE MOUNTED ON PSE POLE (1 LOCATION THIS SHEET).
- ⑪ INSTALL FOUNDATION AND SERVICE CABINET IN APPROXIMATE LOCATION SHOWN (DOORS FACING S 328TH PL) AND IN ACCORDANCE WITH THE DETAILS ON SHEETS 67 AND 68.
- ⑮ INSTALL TYPE 2 JUNCTION BOX (REFER TO STANDARD PLAN J-40.10 AND THE DETAILS ON SHEETS 65 AND 66) AT APPROXIMATE LOCATION SHOWN (1 BOX THIS SHEET). SEE NOTES.
- ⑳ COORDINATE WITH SERVING UTILITY FOR ELECTRICAL CONNECTION POINT. RUN SERVICE CONDUCTOR IN ACCORDANCE WITH POWER UTILITY AND CITY OF FEDERAL WAY PERMIT REQUIREMENTS. CONTRACTOR SHALL SUPPLY ANY CONDUIT AND FITTINGS, JUNCTION BOXES, AND HARDWARE REQUIRED BY THE SERVING UTILITY FOR SERVICE.

**GENERAL NOTES**

- 1. MAINTAIN AND PROTECT EXISTING FEATURES (TREES/ SHRUBS/ VEGETATION, DITCHES, DRIVEWAYS, ETC.) WITHIN PROJECT SITE UNLESS OTHERWISE NOTED.
- 2. UTILITIES ARE NOT SHOWN. IT IS THE CONTRACTOR'S RESPONSIBILITY TO AVOID AND PROTECT EXISTING UTILITIES AND RESOLVE CONFLICTS.
- 3. ALL LIGHT STANDARDS AND JUNCTION BOXES SHALL BE INSTALLED WITHIN A CONCRETE PAD IN ACCORDANCE WITH THE DETAIL ON SHEET 63.
- 4. ALL JUNCTION BOXES SHALL INCLUDE THE SYSTEM IDENTIFICATION LETTERS "LT".
- 5. LIGHT STANDARDS SHALL BE PLACED SUCH THAT THERE IS A MINIMUM OF 6 FT FROM CENTER OF STANDARD TO EDGE LINE OR FACE OF CURB. THE CONTRACTOR SHALL NOT PLACE LIGHT STANDARDS IN FORMAL OR INFORMAL WALKING PATHS. THE CONTRACTOR SHALL NOT IMPEDE SIGHT DISTANCE, SIGN VISIBILITY, OR USPS ACCESS WITH LIGHT STANDARD PLACEMENT.
- 6. THE LOCATIONS SHOWN OF POLES, JUNCTION BOXES, AND SERVICE CABINETS ARE APPROXIMATE AND SHOWN OVERSIZE. FIELD ADJUSTMENT MAY BE NECESSARY. SEE NOTES. ALL CONSTRUCTION AND ACTIVITIES SHALL BE LOCATED WITHIN CITY OF FEDERAL WAY PROPERTY. RIGHT-OF-WAY LINES SHOWN ARE APPROXIMATE.

**LEGEND**

- APPROXIMATE RIGHT-OF-WAY
- CONDUIT AND WIRING
- △ WIRE NOTE
- CONSTRUCTION NOTE
- ⊕ LIGHT STANDARD AND LUMINAIRE
- ⊕ EX. PSE LUMINAIRE AND POLE
- ⊠ TYPE 1 JUNCTION BOX
- ⊠ TYPE 2 JUNCTION BOX
- ⊠ SERVICE CABINET
- ⊕ EX. SIGN AND POST TO BE MAINTAINED

**NOTES**

- 1. JUNCTION BOXES FOR S 328TH ST, S 328TH PL, AND 5TH AVE S ARE INTENDED TO HAVE SPACING OF APPROXIMATELY 190 FEET FOR INSTALLATION OF ADDITIONAL LIGHT STANDARDS IN THE FUTURE. THE CONTRACTOR SHALL BEAR THIS IN MIND WHEN PLACING THE JUNCTION BOXES AND ATTEMPT TO ADHERE TO THE SPACING AND PLAN LOCATIONS AS MUCH AS IS PRACTICABLE. THE CONTRACTING AGENCY UNDERSTANDS THAT FIELD CONDITIONS MAY PRECLUDE THIS. ANY JUNCTION BOX SPACING GREATER THAN 250 FEET WILL NEED TO BE COORDINATED AND APPROVED BY THE ENGINEER, PRIOR TO INSTALLATION. IF FEWER JUNCTION BOXES ARE INSTALLED THAN SHOWN IN THE PLANS, THOSE BOXES SHALL BE DELIVERED TO THE KING COUNTY SIGNAL SHOP AT THE CONTRACTOR'S EXPENSE.

100% DESIGN

**CITY OF Federal Way**  
Centered on Opportunity  
33325 8th Avenue South  
Federal Way, WA 98003-6325  
(253) 835-2700  
www.cityoffederalway.com

**811**  
Know what's below.  
Call 811 before you dig.

DRAFTED: D. MCINTOSH  
DESIGNED: K. DAVIS, P.E.  
REVIEWED: R. PEREZ, P.E.  
APPROVED: R. PEREZ, P.E.

**RICHARD A. PEREZ**  
STATE OF WASHINGTON  
REGISTERED PROFESSIONAL ENGINEER  
12/12/2023

DRAWING VERSION / REVISION LOG		
NO.	DATE	REVISION

**STREET LIGHT INFILL**  
**ILLUMINATION SYSTEM - GROUP G**  
**S 328 ST AT 328 PL**

CITY PROJECT #: 26775  
SHT. 52  
OF 76

**CONSTRUCTION NOTES**

- ① INSTALL LIGHT STANDARD FOUNDATION, POLE, DAVIT ARM, AND LUMINAIRE IN APPROXIMATE LOCATION SHOWN (3 LOCATIONS THIS SHEET) AND IN ACCORDANCE WITH MANUFACTURER RECOMMENDATIONS, SPECIAL PROVISIONS, AND THE DETAILS ON SHEETS 60 AND 61.
- ② INSTALL TYPE 1 JUNCTION BOX (REFER TO STANDARD PLAN J-40.10 AND THE DETAILS ON SHEETS 65 AND 66) AT APPROXIMATE LOCATION SHOWN (3 BOXES THIS SHEET). SEE NOTES.
- ⑨ EXISTING PSE LUMINAIRE MOUNTED ON PSE POLE (2 LOCATIONS THIS SHEET).
- ⑪ INSTALL FOUNDATION AND SERVICE CABINET IN APPROXIMATE LOCATION SHOWN (DOORS FACING S 308TH ST) AND IN ACCORDANCE WITH THE DETAILS ON SHEETS 67 AND 68.
- ⑮ INSTALL TYPE 2 JUNCTION BOX (REFER TO STANDARD PLAN J-40.10 AND THE DETAILS ON SHEETS 65 AND 66 IN THE PLANS) AT APPROXIMATE LOCATION SHOWN (2 BOXES THIS SHEET). SEE NOTES.
- ⑳ COORDINATE WITH SERVING UTILITY FOR ELECTRICAL CONNECTION POINT. RUN SERVICE CONDUCTOR IN ACCORDANCE WITH POWER UTILITY AND CITY OF FEDERAL WAY PERMIT REQUIREMENTS. CONTRACTOR SHALL SUPPLY ANY CONDUIT AND FITTINGS, JUNCTION BOXES, AND HARDWARE REQUIRED BY THE SERVING UTILITY FOR SERVICE.

**GENERAL NOTES**

- 1. MAINTAIN AND PROTECT EXISTING FEATURES (TREES/ SHRUBS/ VEGETATION, DITCHES, DRIVEWAYS, ETC.) WITHIN PROJECT SITE UNLESS OTHERWISE NOTED.
- 2. UTILITIES ARE NOT SHOWN. IT IS THE CONTRACTOR'S RESPONSIBILITY TO AVOID AND PROTECT EXISTING UTILITIES AND RESOLVE CONFLICTS.
- 3. ALL LIGHT STANDARDS AND JUNCTION BOXES SHALL BE INSTALLED WITHIN A CONCRETE PAD IN ACCORDANCE WITH THE DETAIL ON SHEET 63.
- 4. ALL JUNCTION BOXES SHALL INCLUDE THE SYSTEM IDENTIFICATION LETTERS "LT".
- 5. LIGHT STANDARDS SHALL BE PLACED SUCH THAT THERE IS A MINIMUM OF 6 FT FROM CENTER OF STANDARD TO EDGE LINE OR FACE OF CURB. THE CONTRACTOR SHALL NOT PLACE LIGHT STANDARDS IN FORMAL OR INFORMAL WALKING PATHS. THE CONTRACTOR SHALL NOT IMPEDE SIGHT DISTANCE, SIGN VISIBILITY, OR USPS ACCESS WITH LIGHT STANDARD PLACEMENT.
- 6. THE LOCATIONS SHOWN OF POLES, JUNCTION BOXES, AND SERVICE CABINETS ARE APPROXIMATE AND SHOWN OVERSIZE. FIELD ADJUSTMENT MAY BE NECESSARY. SEE NOTES. ALL CONSTRUCTION AND ACTIVITIES SHALL BE LOCATED WITHIN CITY OF FEDERAL WAY PROPERTY. RIGHT-OF-WAY LINES SHOWN ARE APPROXIMATE.

**LEGEND**

- APPROXIMATE RIGHT-OF-WAY
- - - CONDUIT AND WIRING
- △ WIRE NOTE
- ⬡ CONSTRUCTION NOTE
- ⊕ LIGHT STANDARD AND LUMINAIRE
- ⊕ EX. PSE LUMINAIRE AND POLE
- ⬡ TYPE 1 JUNCTION BOX
- ⬢ TYPE 2 JUNCTION BOX
- ⬢ SERVICE CABINET
- ⊕ EX. SIGN AND POST TO BE MAINTAINED

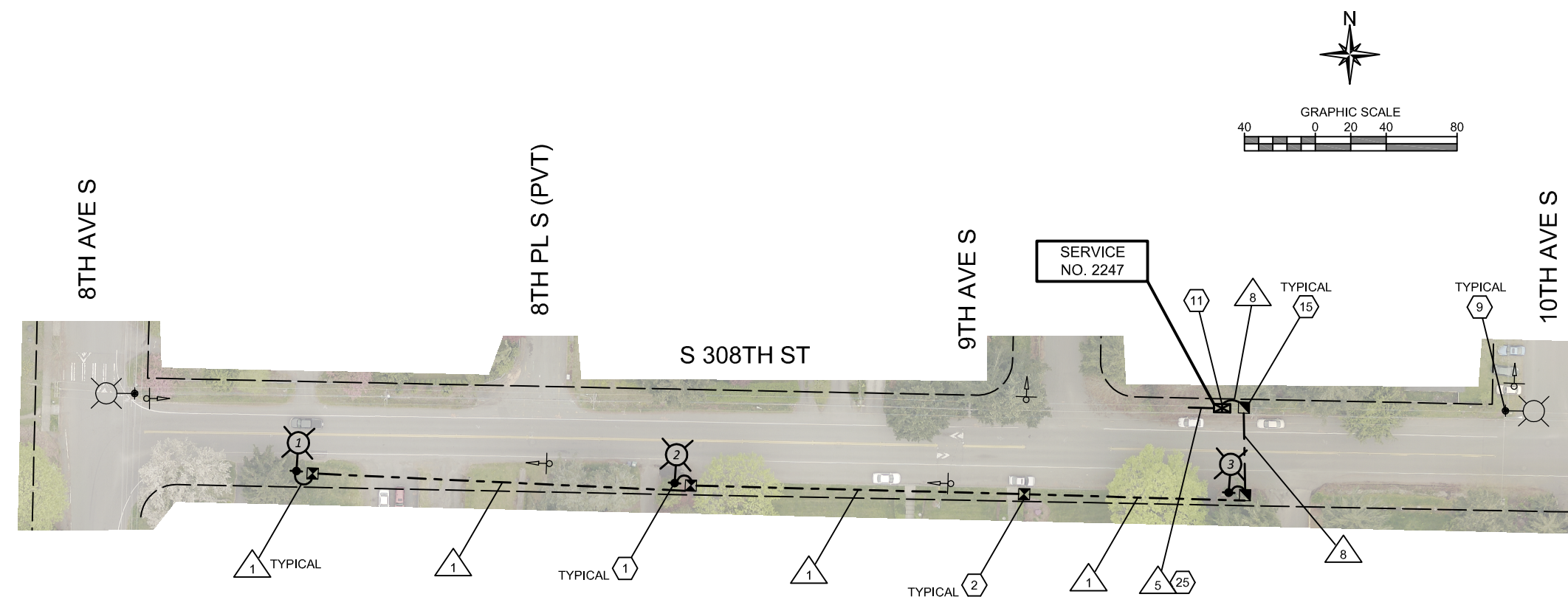

**S 308TH ST - 8TH AVE S TO 10TH AVE S**

LUMINAIRE SCHEDULE			SERVICE NO. 2247		
PLAN NUMBER	ID NUMBER	SERVICE - CIRCUIT	TYPE - WATTS	MASTARM	MTG HEIGHT
1	2247-1-SL1-1	9/308 - 1	II - 60	8 FT	30 FT
2	2247-1-SL1-2	9/308 - 1	II - 60	8 FT	30 FT
3	2247-1-SL1-3	9/308 - 1	II - 60	8 FT	30 FT

WIRING SCHEDULE			
△ X RUN NO.	CONDUIT	WIRE	COMMENTS
1	2" PVC	2-#8 (ILLUM)	SHALL BE ALUMINUM
5	PER PSE (2" MINIMUM)	PER PSE (3-#6 MINIMUM)	PER PSE
8	2" PVC	2-#8 (ILLUM)	SHALL BE ALUMINUM
	2" PVC	SPARE	WITH GROUND AND PULL TAPE

**NOTES**

- 1. JUNCTION BOXES FOR S 308TH ST ARE INTENDED TO HAVE SPACING OF APPROXIMATELY 190 FEET FOR INSTALLATION OF ADDITIONAL LIGHT STANDARDS IN THE FUTURE. THE CONTRACTOR SHALL BEAR THIS IN MIND WHEN PLACING THE JUNCTION BOXES AND ATTEMPT TO ADHERE TO THE SPACING AND PLAN LOCATIONS AS MUCH AS IS PRACTICABLE. THE CONTRACTING AGENCY UNDERSTANDS THAT FIELD CONDITIONS MAY PRECLUDE THIS. ANY JUNCTION BOX SPACING GREATER THAN 250 FEET WILL NEED TO BE COORDINATED AND APPROVED BY THE ENGINEER, PRIOR TO INSTALLATION. IF FEWER JUNCTION BOXES ARE INSTALLED THAN SHOWN IN THE PLANS, THOSE BOXES SHALL BE DELIVERED TO THE KING COUNTY SIGNAL SHOP AT THE CONTRACTOR'S EXPENSE.

100% DESIGN

**CITY OF Federal Way**  
Centered on Opportunity  
33325 8th Avenue South  
Federal Way, WA 98003-6325  
(253) 835-2700  
www.cityoffederalway.com

**811**  
Know what's below.  
Call 811 before you dig.

DRAFTED: D. MCINTOSH  
DESIGNED: K. DAVIS, P.E.  
REVIEWED: R. PEREZ, P.E.  
APPROVED: R. PEREZ, P.E.



DRAWING VERSION / REVISION LOG		
NO.	DATE	REVISION

**STREET LIGHT INFILL**  
**ILLUMINATION SYSTEM - GROUP G**  
**S 308 ST - 8 AVE S TO 10 AVE S**

CITY PROJECT #:  
**26775**  
SHT. **53**  
OF **76**

K:\ENGINEERING DIVISION\PROJECTS\ACTIVE\26775 - Streetlight Infill\03 PE\ACAD\0308-4.dwg 12/12/2023 3:00 PM



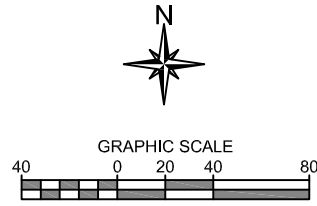

**21ST AVE SW - SW 307TH ST  
TO SW 305TH ST**

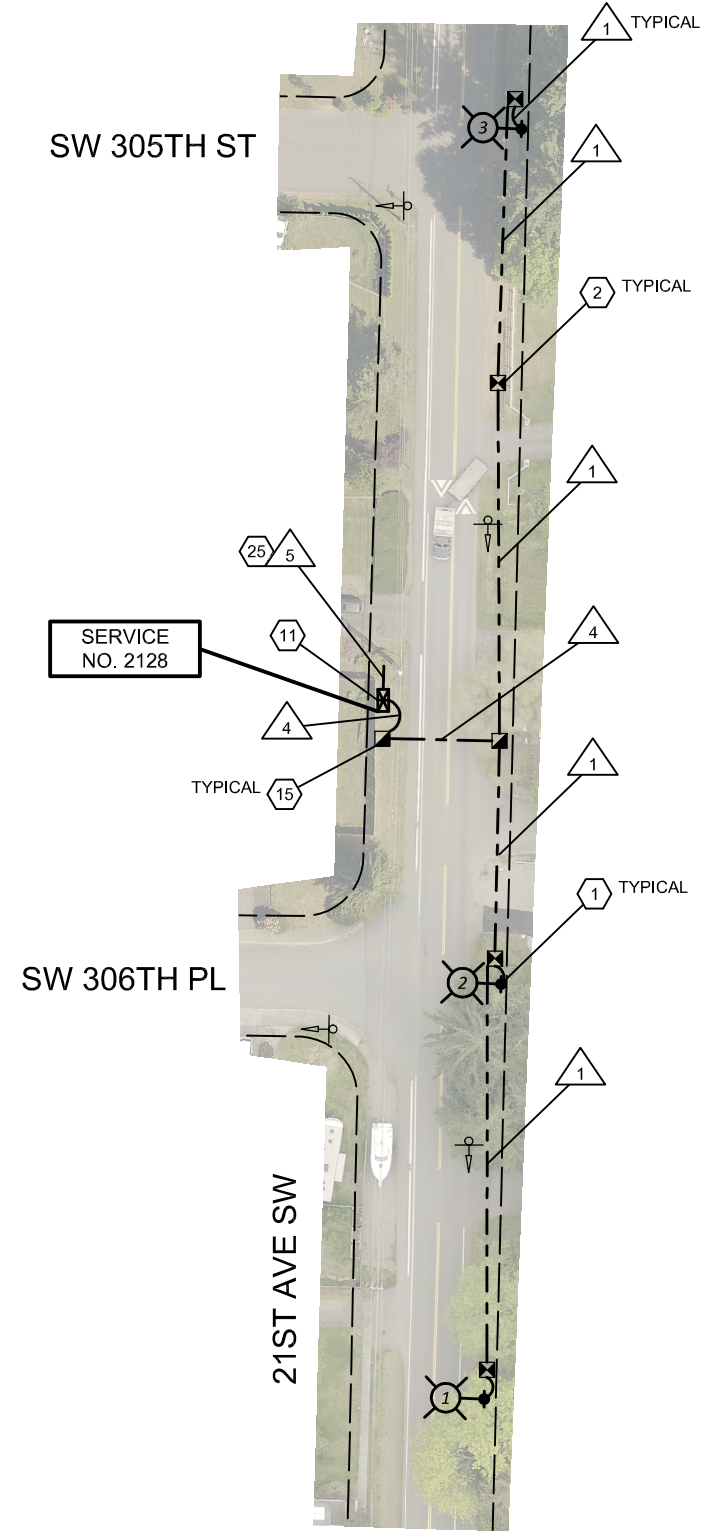

**CONSTRUCTION NOTES**

- ① INSTALL LIGHT STANDARD FOUNDATION, POLE, DAVIT ARM, AND LUMINAIRE IN APPROXIMATE LOCATION SHOWN (3 LOCATIONS THIS SHEET) AND IN ACCORDANCE WITH MANUFACTURER RECOMMENDATIONS, SPECIAL PROVISIONS, AND THE DETAILS ON SHEETS 60 AND 61.
- ② INSTALL TYPE 1 JUNCTION BOX (REFER TO STANDARD PLAN J-40.10 AND THE DETAILS ON SHEETS 65 AND 66) AT APPROXIMATE LOCATION SHOWN (4 BOXES THIS SHEET). SEE NOTES.
- ⑪ INSTALL FOUNDATION AND SERVICE CABINET IN APPROXIMATE LOCATION SHOWN (DOORS FACING 21ST AVE SW) AND IN ACCORDANCE WITH THE DETAILS ON SHEETS 67 AND 68.
- ⑮ INSTALL TYPE 2 JUNCTION BOX (REFER TO STANDARD PLAN J-40.10 AND THE DETAILS ON SHEETS 65 AND 66) AT APPROXIMATE LOCATION SHOWN (2 BOXES THIS SHEET). SEE NOTES.
- ⑳ COORDINATE WITH SERVING UTILITY FOR ELECTRICAL CONNECTION POINT. RUN SERVICE CONDUCTOR IN ACCORDANCE WITH POWER UTILITY AND CITY OF FEDERAL WAY PERMIT REQUIREMENTS. CONTRACTOR SHALL SUPPLY ANY CONDUIT AND FITTINGS, JUNCTION BOXES, AND HARDWARE REQUIRED BY THE SERVING UTILITY FOR SERVICE.

**GENERAL NOTES**

- 1. MAINTAIN AND PROTECT EXISTING FEATURES (TREES/ SHRUBS/ VEGETATION, DITCHES, DRIVEWAYS, ETC.) WITHIN PROJECT SITE UNLESS OTHERWISE NOTED.
- 2. UTILITIES ARE NOT SHOWN. IT IS THE CONTRACTOR'S RESPONSIBILITY TO AVOID AND PROTECT EXISTING UTILITIES AND RESOLVE CONFLICTS.
- 3. ALL LIGHT STANDARDS AND JUNCTION BOXES SHALL BE INSTALLED WITHIN A CONCRETE PAD IN ACCORDANCE WITH THE DETAIL ON SHEET 63.
- 4. ALL JUNCTION BOXES SHALL INCLUDE THE SYSTEM IDENTIFICATION LETTERS "LT".
- 5. LIGHT STANDARDS SHALL BE PLACED SUCH THAT THERE IS A MINIMUM OF 6 FT FROM CENTER OF STANDARD TO EDGE LINE OR FACE OF CURB. THE CONTRACTOR SHALL NOT PLACE LIGHT STANDARDS IN FORMAL OR INFORMAL WALKING PATHS. THE CONTRACTOR SHALL NOT IMPEDE SIGHT DISTANCE, SIGN VISIBILITY, OR USPS ACCESS WITH LIGHT STANDARD PLACEMENT.
- 6. THE LOCATIONS SHOWN OF POLES, JUNCTION BOXES, AND SERVICE CABINETS ARE APPROXIMATE AND SHOWN OVERSIZE. FIELD ADJUSTMENT MAY BE NECESSARY. SEE NOTES. ALL CONSTRUCTION AND ACTIVITIES SHALL BE LOCATED WITHIN CITY OF FEDERAL WAY PROPERTY. RIGHT-OF-WAY LINES SHOWN ARE APPROXIMATE.

LUMINAIRE SCHEDULE			SERVICE NO. 2128		
PLAN NUMBER	ID NUMBER	SERVICE - CIRCUIT	TYPE - WATTS	MASTARM	MTG HEIGHT
1	2128-1-SL1-1	21/306 - 1	II - 60	8 FT	30 FT
2	2128-1-SL1-2	21/306 - 1	II - 60	8 FT	30 FT
3	2128-1-SL1-3	21/306 - 1	II - 60	8 FT	30 FT

WIRING SCHEDULE				
△ RUN NO.	CONDUIT	WIRE	COMMENTS	
1	2" PVC	2-#8 (ILLUM)	SHALL BE ALUMINUM	
4	2" PVC	4-#8 (ILLUM)	SHALL BE ALUMINUM	
	2" PVC	SPARE	WITH GROUND AND PULL TAPE	
5	PER PSE (2" MINIMUM)	PER PSE (3-#6 MINIMUM)	PER PSE	

**NOTES**

- 1. JUNCTION BOXES FOR 21ST AVE SW ARE INTENDED TO HAVE SPACING OF APPROXIMATELY 190 FEET FOR INSTALLATION OF ADDITIONAL LIGHT STANDARDS IN THE FUTURE. THE CONTRACTOR SHALL BEAR THIS IN MIND WHEN PLACING THE JUNCTION BOXES AND ATTEMPT TO ADHERE TO THE SPACING AND PLAN LOCATIONS AS MUCH AS IS PRACTICABLE. THE CONTRACTING AGENCY UNDERSTANDS THAT FIELD CONDITIONS MAY PRECLUDE THIS. ANY JUNCTION BOX SPACING GREATER THAN 250 FEET WILL NEED TO BE COORDINATED AND APPROVED BY THE ENGINEER, PRIOR TO INSTALLATION. IF FEWER JUNCTION BOXES ARE INSTALLED THAN SHOWN IN THE PLANS, THOSE BOXES SHALL BE DELIVERED TO THE KING COUNTY SIGNAL SHOP AT THE CONTRACTOR'S EXPENSE.

**LEGEND**

---	APPROXIMATE RIGHT-OF-WAY	⊠	TYPE 1 JUNCTION BOX
---	CONDUIT AND WIRING	⊠	TYPE 2 JUNCTION BOX
△	WIRE NOTE	⊠	SERVICE CABINET
⊠	CONSTRUCTION NOTE	⊠	EX. SIGN AND POST TO BE MAINTAINED
⊠	LIGHT STANDARD AND LUMINAIRE		

100% DESIGN

DRAFTED: D. MCINTOSH  
DESIGNED: K. DAVIS, P.E.  
REVIEWED: R. PEREZ, P.E.  
APPROVED: R. PEREZ, P.E.

DRAWING VERSION / REVISION LOG		
NO.	DATE	REVISION

**STREET LIGHT INFILL**

**ILLUMINATION SYSTEM - GROUP H**

**21 AVE SW - SW 307 ST TO SW 305 ST**

CITY PROJECT #:	26775
SHT. OF	54 OF 76

# SW 301ST ST - SW DASH POINT RD TO 1ST AVE S

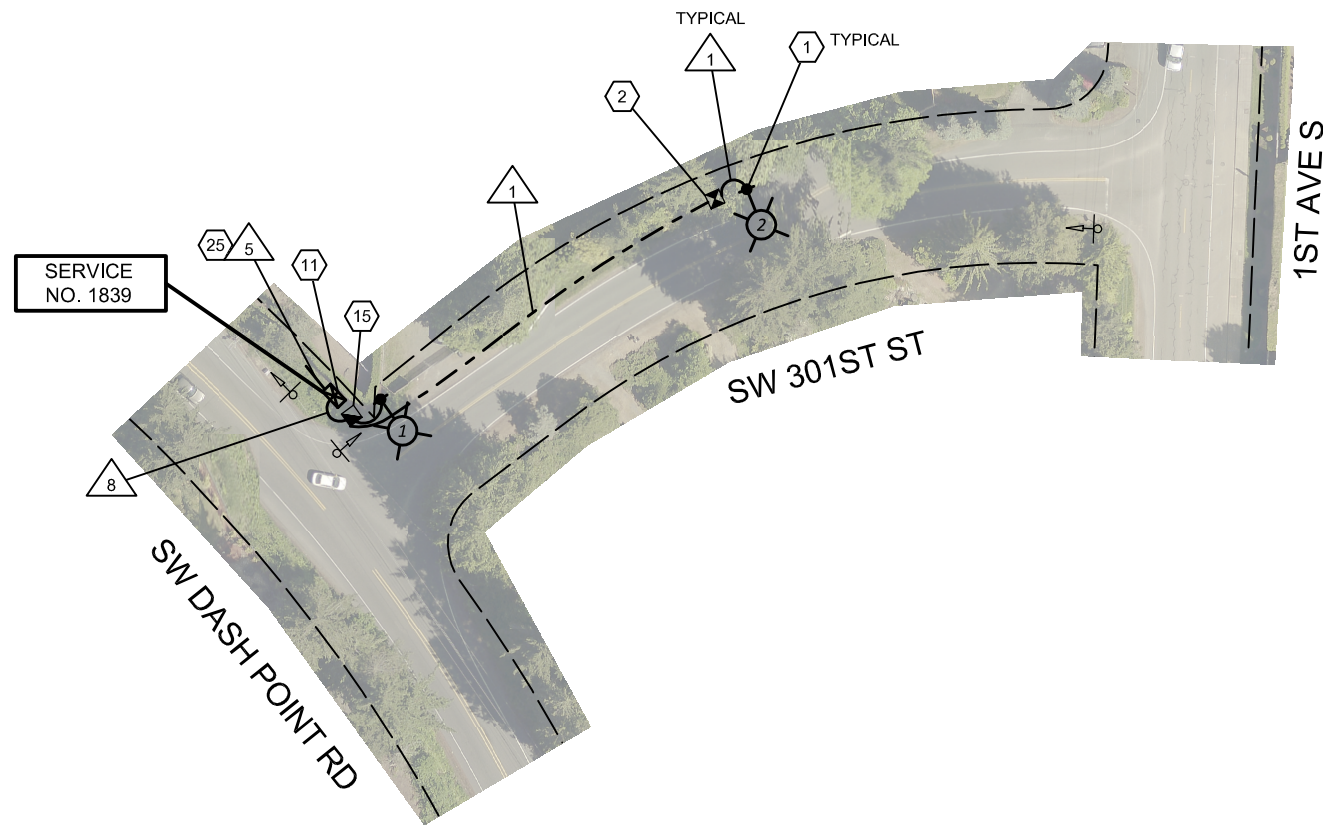

## CONSTRUCTION NOTES

- 1 INSTALL LIGHT STANDARD FOUNDATION, POLE, DAVIT ARM, AND LUMINAIRE IN APPROXIMATE LOCATION SHOWN (2 LOCATIONS THIS SHEET) AND IN ACCORDANCE WITH MANUFACTURER RECOMMENDATIONS, SPECIAL PROVISIONS, AND THE DETAILS ON SHEETS 60 AND 61.
- 2 INSTALL TYPE 1 JUNCTION BOX (REFER TO STANDARD PLAN J-40.10 AND THE DETAILS ON SHEETS 65 AND 66) AT APPROXIMATE LOCATION SHOWN (1 BOX THIS SHEET). SEE NOTES.
- 11 INSTALL FOUNDATION AND SERVICE CABINET IN APPROXIMATE LOCATION SHOWN (DOORS FACING SW DASH POINT RD) AND IN ACCORDANCE WITH THE DETAILS ON SHEETS 67 AND 68.
- 15 INSTALL TYPE 2 JUNCTION BOX (REFER TO STANDARD PLAN J-40.10 AND THE DETAILS ON SHEETS 65 AND 66) AT APPROXIMATE LOCATION SHOWN (1 BOX THIS SHEET). SEE NOTES.
- 25 COORDINATE WITH SERVING UTILITY FOR ELECTRICAL CONNECTION POINT. RUN SERVICE CONDUCTOR IN ACCORDANCE WITH POWER UTILITY AND CITY OF FEDERAL WAY PERMIT REQUIREMENTS. CONTRACTOR SHALL SUPPLY ANY CONDUIT AND FITTINGS, JUNCTION BOXES, AND HARDWARE REQUIRED BY THE SERVING UTILITY FOR SERVICE.

## GENERAL NOTES

1. MAINTAIN AND PROTECT EXISTING FEATURES (TREES/ SHRUBS/ VEGETATION, DITCHES, DRIVEWAYS, ETC.) WITHIN PROJECT SITE UNLESS OTHERWISE NOTED.
2. UTILITIES ARE NOT SHOWN. IT IS THE CONTRACTOR'S RESPONSIBILITY TO AVOID AND PROTECT EXISTING UTILITIES AND RESOLVE CONFLICTS.
3. ALL LIGHT STANDARDS AND JUNCTION BOXES SHALL BE INSTALLED WITHIN A CONCRETE PAD IN ACCORDANCE WITH THE DETAIL ON SHEET 63.
4. ALL JUNCTION BOXES SHALL INCLUDE THE SYSTEM IDENTIFICATION LETTERS "LT".
5. LIGHT STANDARDS SHALL BE PLACED SUCH THAT THERE IS A MINIMUM OF 6 FT FROM CENTER OF STANDARD TO EDGE LINE OR FACE OF CURB. THE CONTRACTOR SHALL NOT PLACE LIGHT STANDARDS IN FORMAL OR INFORMAL WALKING PATHS. THE CONTRACTOR SHALL NOT IMPEDE SIGHT DISTANCE, SIGN VISIBILITY, OR USPS ACCESS WITH LIGHT STANDARD PLACEMENT.
6. THE LOCATIONS SHOWN OF POLES, JUNCTION BOXES, AND SERVICE CABINETS ARE APPROXIMATE AND SHOWN OVERSIZE. FIELD ADJUSTMENT MAY BE NECESSARY. SEE NOTES. ALL CONSTRUCTION AND ACTIVITIES SHALL BE LOCATED WITHIN CITY OF FEDERAL WAY PROPERTY. RIGHT-OF-WAY LINES SHOWN ARE APPROXIMATE.

LUMINAIRE SCHEDULE			SERVICE NO. 1839		
PLAN NUMBER	ID NUMBER	SERVICE - CIRCUIT	TYPE - WATTS	MASTARM	MTG HEIGHT
1	1839-1-SL1-1	509/301 - 1	II - 60	8 FT	30 FT
2	1839-1-SL1-2	509/301 - 1	II - 60	8 FT	30 FT

WIRING SCHEDULE				
△ X	RUN NO.	CONDUIT	WIRE	COMMENTS
	1	2" PVC	2-#8 (ILLUM)	SHALL BE ALUMINUM
	5	PER PSE (2" MINIMUM)	PER PSE (3-#6 MINIMUM)	PER PSE
	8	2" PVC	2-#8 (ILLUM)	SHALL BE ALUMINUM
		2" PVC	SPARE	WITH GROUND AND PULL TAPE

## NOTES

1. JUNCTION BOXES FOR SW 301ST ST ARE INTENDED TO HAVE SPACING OF APPROXIMATELY 190 FEET FOR INSTALLATION OF ADDITIONAL LIGHT STANDARDS IN THE FUTURE. THE CONTRACTOR SHALL BEAR THIS IN MIND WHEN PLACING THE JUNCTION BOXES AND ATTEMPT TO ADHERE TO THE SPACING AND PLAN LOCATIONS AS MUCH AS IS PRACTICABLE. THE CONTRACTING AGENCY UNDERSTANDS THAT FIELD CONDITIONS MAY PRECLUDE THIS. ANY JUNCTION BOX SPACING GREATER THAN 250 FEET WILL NEED TO BE COORDINATED AND APPROVED BY THE ENGINEER, PRIOR TO INSTALLATION. IF FEWER JUNCTION BOXES ARE INSTALLED THAN SHOWN IN THE PLANS, THOSE BOXES SHALL BE DELIVERED TO THE KING COUNTY SIGNAL SHOP AT THE CONTRACTOR'S EXPENSE.

## LEGEND

- APPROXIMATE RIGHT-OF-WAY
- CONDUIT AND WIRING
- △ WIRE NOTE
- CONSTRUCTION NOTE
- ⊕ LIGHT STANDARD AND LUMINAIRE
- ⊠ TYPE 1 JUNCTION BOX
- ⊡ TYPE 2 JUNCTION BOX
- ⊞ SERVICE CABINET
- ⊕ EX. SIGN AND POST TO BE MAINTAINED

100% DESIGN



DRAFTED: D. MCINTOSH  
DESIGNED: K. DAVIS, P.E.  
REVIEWED: R. PEREZ, P.E.  
APPROVED: R. PEREZ, P.E.



DRAWING VERSION / REVISION LOG		
NO.	DATE	REVISION

**STREET LIGHT INFILL**  
**ILLUMINATION SYSTEM - GROUP I**  
**SW 301 ST - SW DASH POINT RD TO 1 AVE S**

CITY PROJECT #:  
**26775**  
SHT. **55**  
OF **76**



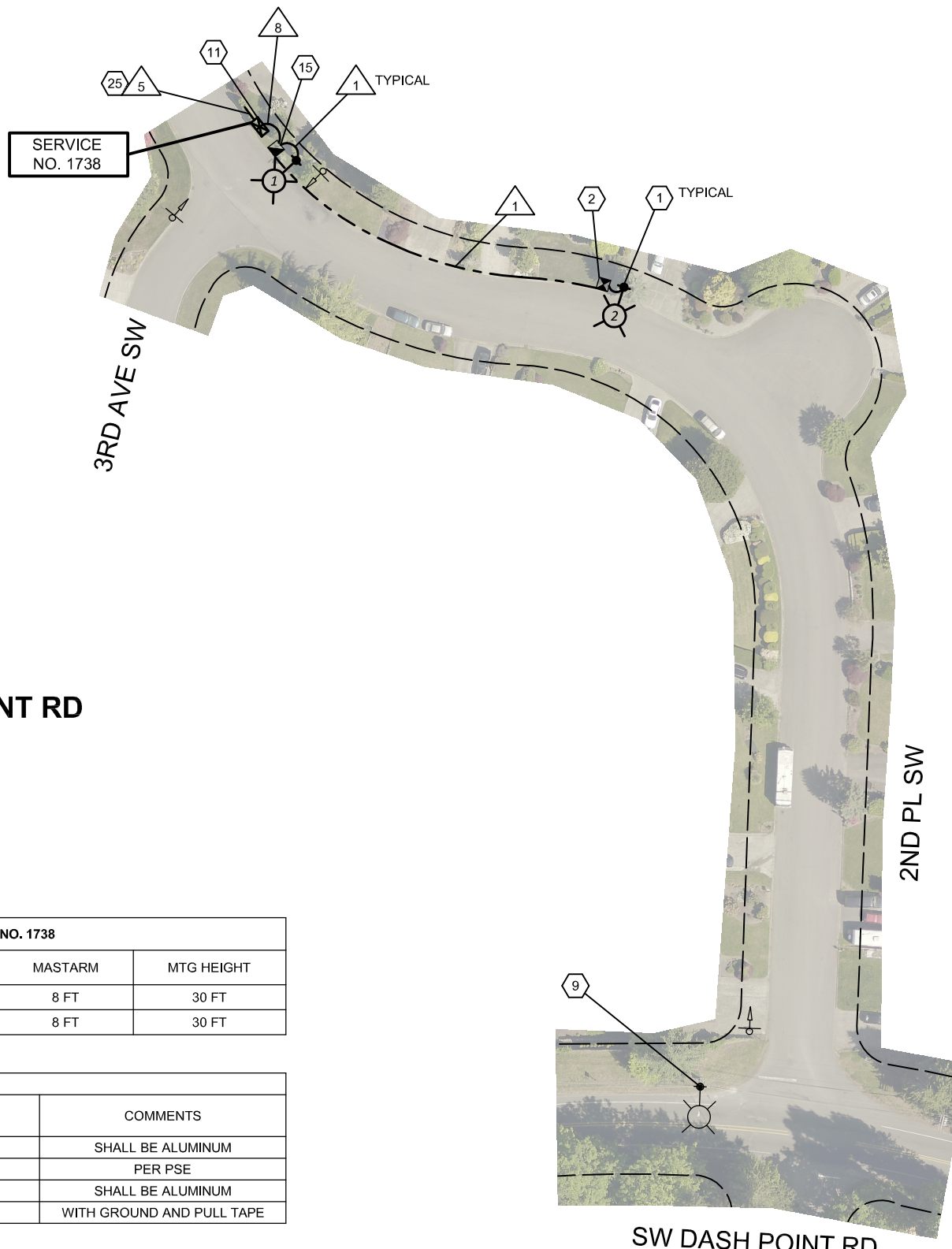
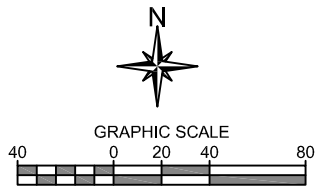

### 2ND PL SW - SW DASH POINT RD TO 3RD AVE SW

LUMINAIRE SCHEDULE			SERVICE NO. 1738		
PLAN NUMBER	ID NUMBER	SERVICE - CIRCUIT	TYPE - WATTS	MASTARM	MTG HEIGHT
1	1738-1-SL1-1	2 PL/3 - 1	II - 60	8 FT	30 FT
2	1738-1-SL1-2	2 PL/3 - 1	II - 60	8 FT	30 FT

WIRING SCHEDULE			
X RUN NO.	CONDUIT	WIRE	COMMENTS
1	2" PVC	2-#8 (ILLUM)	SHALL BE ALUMINUM
5	PER PSE (2" MINIMUM)	PER PSE (3-#6 MINIMUM)	PER PSE
8	2" PVC	2-#8 (ILLUM)	SHALL BE ALUMINUM
	2" PVC	SPARE	WITH GROUND AND PULL TAPE

#### NOTES

- JUNCTION BOXES FOR 2ND PL SW ARE INTENDED TO HAVE SPACING OF APPROXIMATELY 190 FEET FOR INSTALLATION OF ADDITIONAL LIGHT STANDARDS IN THE FUTURE. THE CONTRACTOR SHALL BEAR THIS IN MIND WHEN PLACING THE JUNCTION BOXES AND ATTEMPT TO ADHERE TO THE SPACING AND PLAN LOCATIONS AS MUCH AS IS PRACTICABLE. THE CONTRACTING AGENCY UNDERSTANDS THAT FIELD CONDITIONS MAY PRECLUDE THIS. ANY JUNCTION BOX SPACING GREATER THAN 250 FEET WILL NEED TO BE COORDINATED AND APPROVED BY THE ENGINEER, PRIOR TO INSTALLATION. IF FEWER JUNCTION BOXES ARE INSTALLED THAN SHOWN IN THE PLANS, THOSE BOXES SHALL BE DELIVERED TO THE KING COUNTY SIGNAL SHOP AT THE CONTRACTOR'S EXPENSE.

#### CONSTRUCTION NOTES

- INSTALL LIGHT STANDARD FOUNDATION, POLE, DAVIT ARM, AND LUMINAIRE IN APPROXIMATE LOCATION SHOWN (2 LOCATIONS THIS SHEET) AND IN ACCORDANCE WITH MANUFACTURER RECOMMENDATIONS, SPECIAL PROVISIONS, AND THE DETAILS ON SHEETS 60 AND 61.
- INSTALL TYPE 1 JUNCTION BOX (REFER TO STANDARD PLAN J-40.10 AND THE DETAILS ON SHEETS 65 AND 66) AT APPROXIMATE LOCATION SHOWN (1 BOX THIS SHEET). SEE NOTES.
- EXISTING PSE LUMINAIRE MOUNTED ON PSE POLE (1 LOCATION THIS SHEET).
- INSTALL FOUNDATION AND SERVICE CABINET IN APPROXIMATE LOCATION SHOWN (DOORS FACING 2ND PL SW) AND IN ACCORDANCE WITH THE DETAILS ON SHEETS 67 AND 68.
- INSTALL TYPE 2 JUNCTION BOX (REFER TO STANDARD PLAN J-40.10 AND THE DETAILS ON SHEETS 65 AND 66) AT APPROXIMATE LOCATION SHOWN (1 BOX THIS SHEET). SEE NOTES.
- COORDINATE WITH SERVING UTILITY FOR ELECTRICAL CONNECTION POINT. RUN SERVICE CONDUCTOR IN ACCORDANCE WITH POWER UTILITY AND CITY OF FEDERAL WAY PERMIT REQUIREMENTS. CONTRACTOR SHALL SUPPLY ANY CONDUIT AND FITTINGS, JUNCTION BOXES, AND HARDWARE REQUIRED BY THE SERVING UTILITY FOR SERVICE.

#### GENERAL NOTES

- MAINTAIN AND PROTECT EXISTING FEATURES (TREES/ SHRUBS/ VEGETATION, DITCHES, DRIVEWAYS, ETC.) WITHIN PROJECT SITE UNLESS OTHERWISE NOTED.
- UTILITIES ARE NOT SHOWN. IT IS THE CONTRACTOR'S RESPONSIBILITY TO AVOID AND PROTECT EXISTING UTILITIES AND RESOLVE CONFLICTS.
- ALL LIGHT STANDARDS AND JUNCTION BOXES SHALL BE INSTALLED WITHIN A CONCRETE PAD IN ACCORDANCE WITH THE DETAIL ON SHEET 63.
- ALL JUNCTION BOXES SHALL INCLUDE THE SYSTEM IDENTIFICATION LETTERS "LT".
- LIGHT STANDARDS SHALL BE PLACED SUCH THAT THERE IS A MINIMUM OF 6 FT FROM CENTER OF STANDARD TO EDGE LINE OR FACE OF CURB. THE CONTRACTOR SHALL NOT PLACE LIGHT STANDARDS IN FORMAL OR INFORMAL WALKING PATHS. THE CONTRACTOR SHALL NOT IMPEDE SIGHT DISTANCE, SIGN VISIBILITY, OR USPS ACCESS WITH LIGHT STANDARD PLACEMENT.
- THE LOCATIONS SHOWN OF POLES, JUNCTION BOXES, AND SERVICE CABINETS ARE APPROXIMATE AND SHOWN OVERSIZE. FIELD ADJUSTMENT MAY BE NECESSARY. SEE NOTES. ALL CONSTRUCTION AND ACTIVITIES SHALL BE LOCATED WITHIN CITY OF FEDERAL WAY PROPERTY. RIGHT-OF-WAY LINES SHOWN ARE APPROXIMATE.

#### LEGEND

- APPROXIMATE RIGHT-OF-WAY
- CONDUIT AND WIRING
- △ WIRE NOTE
- CONSTRUCTION NOTE
- ⊕ LIGHT STANDARD AND LUMINAIRE
- ⊕ EX. PSE LUMINAIRE AND POLE
- ⊠ TYPE 1 JUNCTION BOX
- ⊠ TYPE 2 JUNCTION BOX
- ⊠ SERVICE CABINET
- ⊕ EX. SIGN AND POST TO BE MAINTAINED

100% DESIGN



DRAFTED: D. MCINTOSH  
DESIGNED: K. DAVIS, P.E.  
REVIEWED: R. PEREZ, P.E.  
APPROVED: R. PEREZ, P.E.



DRAWING VERSION / REVISION LOG		
NO.	DATE	REVISION

<h2>STREET LIGHT INFILL</h2> <h3>ILLUMINATION SYSTEM - GROUP I</h3> <h4>2 PL SW - SW DASH POINT RD TO 3 AVE SW</h4>	<p>CITY PROJECT #: <b>26775</b></p> <p>SHT. <b>56</b></p> <p>OF <b>76</b></p>
---	---

## SW 299TH PL - 8TH AVE SW TO 5TH AVE SW

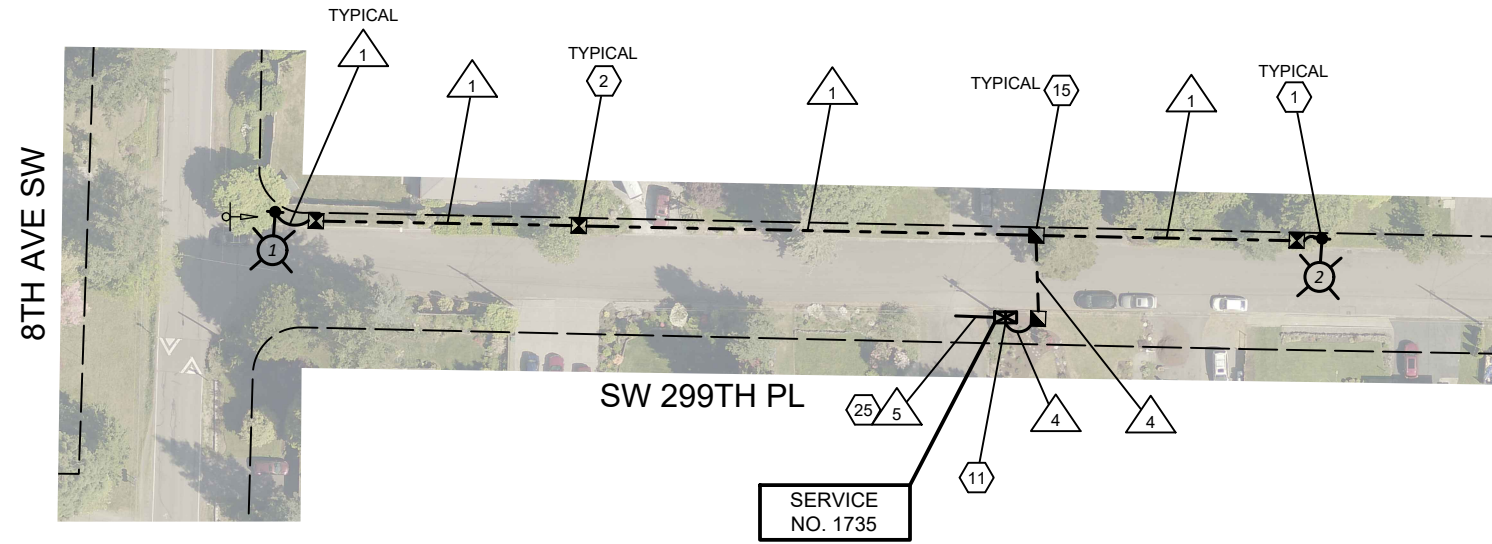
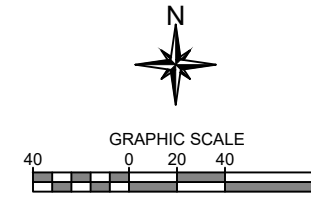

### CONSTRUCTION NOTES

- ① INSTALL LIGHT STANDARD FOUNDATION, POLE, DAVIT ARM, AND LUMINAIRE IN APPROXIMATE LOCATION SHOWN (2 LOCATIONS THIS SHEET) AND IN ACCORDANCE WITH MANUFACTURER RECOMMENDATIONS, SPECIAL PROVISIONS, AND THE DETAILS ON SHEETS 60 AND 61.
- ② INSTALL TYPE 1 JUNCTION BOX (REFER TO STANDARD PLAN J-40.10 AND THE DETAILS ON SHEETS 65 AND 66) AT APPROXIMATE LOCATION SHOWN (3 BOXES THIS SHEET). SEE NOTES.
- ⑪ INSTALL FOUNDATION AND SERVICE CABINET IN APPROXIMATE LOCATION SHOWN (DOORS FACING SW 299TH PL) AND IN ACCORDANCE WITH THE DETAILS ON SHEETS 67 AND 68.
- ⑮ INSTALL TYPE 2 JUNCTION BOX (REFER TO STANDARD PLAN J-40.10 AND THE DETAILS ON SHEETS 65 AND 66) AT APPROXIMATE LOCATION SHOWN (2 BOXES THIS SHEET). SEE NOTES.
- ⑳ COORDINATE WITH SERVING UTILITY FOR ELECTRICAL CONNECTION POINT. RUN SERVICE CONDUCTOR IN ACCORDANCE WITH POWER UTILITY AND CITY OF FEDERAL WAY PERMIT REQUIREMENTS. CONTRACTOR SHALL SUPPLY ANY CONDUIT AND FITTINGS, JUNCTION BOXES, AND HARDWARE REQUIRED BY THE SERVING UTILITY FOR SERVICE.

### GENERAL NOTES

1. MAINTAIN AND PROTECT EXISTING FEATURES (TREES/ SHRUBS/ VEGETATION, DITCHES, DRIVEWAYS, ETC.) WITHIN PROJECT SITE UNLESS OTHERWISE NOTED.
2. UTILITIES ARE NOT SHOWN. IT IS THE CONTRACTOR'S RESPONSIBILITY TO AVOID AND PROTECT EXISTING UTILITIES AND RESOLVE CONFLICTS.
3. ALL LIGHT STANDARDS AND JUNCTION BOXES SHALL BE INSTALLED WITHIN A CONCRETE PAD IN ACCORDANCE WITH THE DETAIL ON SHEET 63.
4. ALL JUNCTION BOXES SHALL INCLUDE THE SYSTEM IDENTIFICATION LETTERS "LT".
5. LIGHT STANDARDS SHALL BE PLACED SUCH THAT THERE IS A MINIMUM OF 6 FT FROM CENTER OF STANDARD TO EDGE LINE OR FACE OF CURB. THE CONTRACTOR SHALL NOT PLACE LIGHT STANDARDS IN FORMAL OR INFORMAL WALKING PATHS. THE CONTRACTOR SHALL NOT IMPEDE SIGHT DISTANCE, SIGN VISIBILITY, OR USPS ACCESS WITH LIGHT STANDARD PLACEMENT.
6. THE LOCATIONS SHOWN OF POLES, JUNCTION BOXES, AND SERVICE CABINETS ARE APPROXIMATE AND SHOWN OVERSIZE. FIELD ADJUSTMENT MAY BE NECESSARY. SEE NOTES. ALL CONSTRUCTION AND ACTIVITIES SHALL BE LOCATED WITHIN CITY OF FEDERAL WAY PROPERTY. RIGHT-OF-WAY LINES SHOWN ARE APPROXIMATE.

LUMINAIRE SCHEDULE			SERVICE NO. 1735		
PLAN NUMBER	ID NUMBER	SERVICE - CIRCUIT	TYPE - WATTS	MASTARM	MTG HEIGHT
1	1735-1-SL1-1	8/299 - 1	II - 50	8 FT	30 FT
2	1735-1-SL2-2	8/299 - 2	II - 50	8 FT	30 FT

WIRING SCHEDULE				
△ X RUN NO.	CONDUIT	WIRE	COMMENTS	
1	2" PVC	2-#8 (ILLUM)	SHALL BE ALUMINUM	
4	2" PVC	4-#8 (ILLUM)	SHALL BE ALUMINUM	
5	2" PVC	SPARE	WITH GROUND AND PULL TAPE	
5	PER PSE (2" MINIMUM)	PER PSE (3-#6 MINIMUM)	PER PSE	

### NOTES

1. JUNCTION BOXES FOR SW 299TH PL ARE INTENDED TO HAVE SPACING OF APPROXIMATELY 195 FEET FOR INSTALLATION OF ADDITIONAL LIGHT STANDARDS IN THE FUTURE. THE CONTRACTOR SHALL BEAR THIS IN MIND WHEN PLACING THE JUNCTION BOXES AND ATTEMPT TO ADHERE TO THE SPACING AND PLAN LOCATIONS AS MUCH AS IS PRACTICABLE. THE CONTRACTING AGENCY UNDERSTANDS THAT FIELD CONDITIONS MAY PRECLUDE THIS. ANY JUNCTION BOX SPACING GREATER THAN 250 FEET WILL NEED TO BE COORDINATED AND APPROVED BY THE ENGINEER, PRIOR TO INSTALLATION. IF FEWER JUNCTION BOXES ARE INSTALLED THAN SHOWN IN THE PLANS, THOSE BOXES SHALL BE DELIVERED TO THE KING COUNTY SIGNAL SHOP AT THE CONTRACTOR'S EXPENSE.

### LEGEND

- - - - APPROXIMATE RIGHT-OF-WAY
- ⊠ TYPE 1 JUNCTION BOX
- - - - CONDUIT AND WIRING
- ⊠ TYPE 2 JUNCTION BOX
- △ WIRE NOTE
- ⊠ SERVICE CABINET
- ⬡ CONSTRUCTION NOTE
- ⊠ EX. SIGN AND POST TO BE MAINTAINED
- ⊠ LIGHT STANDARD AND LUMINAIRE
- ⊠ EX. PSE LUMINAIRE AND POLE

100% DESIGN

33325 8th Avenue South  
Federal Way, WA 98003-6325

(253) 835-2700  
www.cityoffederalway.com

DRAFTED: D. MCINTOSH  
DESIGNED: K. DAVIS, P.E.  
REVIEWED: R. PEREZ, P.E.  
APPROVED: R. PEREZ, P.E.



DRAWING VERSION / REVISION LOG		
NO.	DATE	REVISION

## STREET LIGHT INFILL

### ILLUMINATION SYSTEM - GROUP J

#### SW 299 PL - 8 AVE SW TO 5 AVE SW

CITY PROJECT #:  
**26775**

SHT. **57**  
OF **76**

K:\ENGINEERING DIVISION\PROJECTS\ACTIVE\26775 - Streetlight Infill\03.PE\ACAD\26775-1.dwg 12/12/2023 3:41 PM



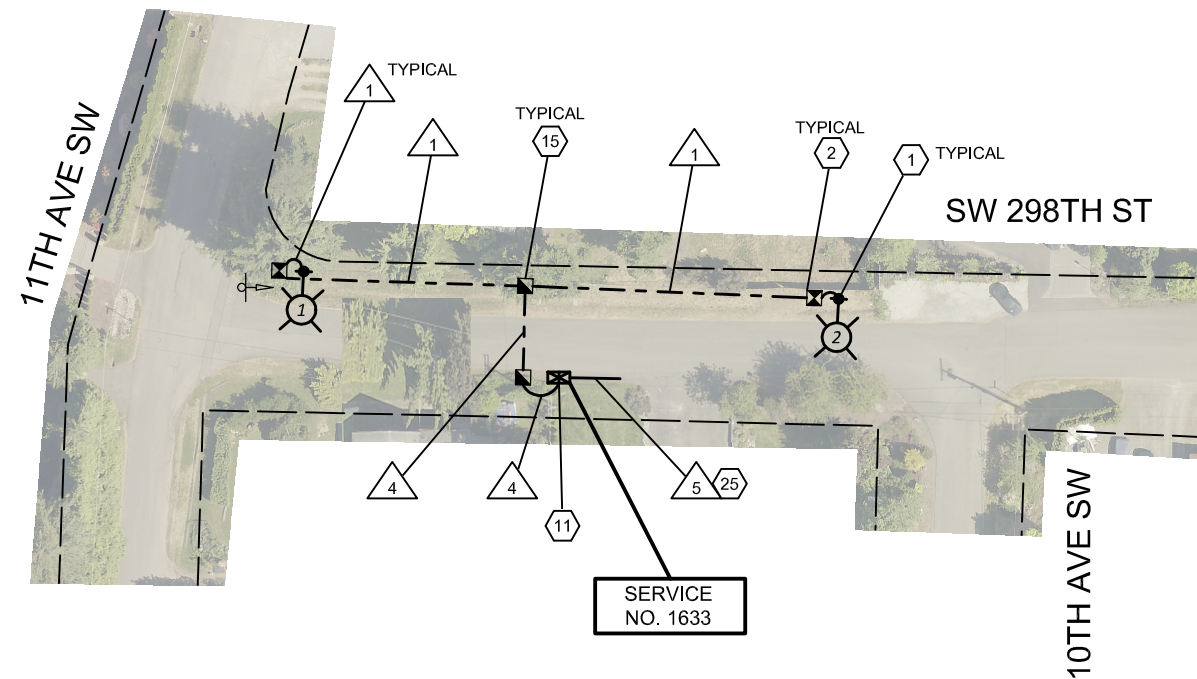
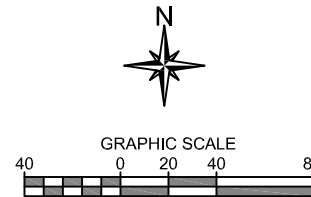

**SW 298TH ST - 11TH AVE SW  
TO 10TH AVE SW**

LUMINAIRE SCHEDULE			SERVICE NO. 1633		
PLAN NUMBER	ID NUMBER	SERVICE - CIRCUIT	TYPE - WATTS	MASTARM	MTG HEIGHT
1	1633-1-SL1-1	10/298 - 1	II - 50	8 FT	30 FT
2	1633-1-SL2-2	10/298 - 2	II - 50	8 FT	30 FT

WIRING SCHEDULE			
△ X RUN NO.	CONDUIT	WIRE	COMMENTS
1	2" PVC	2-#8 (ILLUM)	SHALL BE ALUMINUM
4	2" PVC	4-#8 (ILLUM)	SHALL BE ALUMINUM
	2" PVC	SPARE	WITH GROUND AND PULL TAPE
5	PER PSE (2" MINIMUM)	PER PSE (3-#6 MINIMUM)	PER PSE

**NOTES**

- JUNCTION BOXES FOR SW 298TH ST ARE INTENDED TO HAVE SPACING OF APPROXIMATELY 195 FEET FOR INSTALLATION OF ADDITIONAL LIGHT STANDARDS IN THE FUTURE. THE CONTRACTOR SHALL BEAR THIS IN MIND WHEN PLACING THE JUNCTION BOXES AND ATTEMPT TO ADHERE TO THE SPACING AND PLAN LOCATIONS AS MUCH AS IS PRACTICABLE. THE CONTRACTING AGENCY UNDERSTANDS THAT FIELD CONDITIONS MAY PRECLUDE THIS. ANY JUNCTION BOX SPACING GREATER THAN 250 FEET WILL NEED TO BE COORDINATED AND APPROVED BY THE ENGINEER, PRIOR TO INSTALLATION. IF FEWER JUNCTION BOXES ARE INSTALLED THAN SHOWN IN THE PLANS, THOSE BOXES SHALL BE DELIVERED TO THE KING COUNTY SIGNAL SHOP AT THE CONTRACTOR'S EXPENSE.

**CONSTRUCTION NOTES**

- INSTALL LIGHT STANDARD FOUNDATION, POLE, DAVIT ARM, AND LUMINAIRE IN APPROXIMATE LOCATION SHOWN (2 LOCATIONS THIS SHEET) AND IN ACCORDANCE WITH MANUFACTURER RECOMMENDATIONS, SPECIAL PROVISIONS, AND THE DETAILS ON SHEETS 60 AND 61.
- INSTALL TYPE 1 JUNCTION BOX (REFER TO STANDARD PLAN J-40.10 AND THE DETAILS ON SHEETS 65 AND 66) AT APPROXIMATE LOCATION SHOWN (2 BOXES THIS SHEET). SEE NOTES.
- INSTALL FOUNDATION AND SERVICE CABINET IN APPROXIMATE LOCATION SHOWN (DOORS FACING SW 298TH ST) AND IN ACCORDANCE WITH THE DETAILS ON SHEETS 67 AND 68.
- INSTALL TYPE 2 JUNCTION BOX (REFER TO STANDARD PLAN J-40.10 AND THE DETAILS ON SHEETS 65 AND 66) AT APPROXIMATE LOCATION SHOWN (2 BOXES THIS SHEET). SEE NOTES.
- COORDINATE WITH SERVING UTILITY FOR ELECTRICAL CONNECTION POINT. RUN SERVICE CONDUCTOR IN ACCORDANCE WITH POWER UTILITY AND CITY OF FEDERAL WAY PERMIT REQUIREMENTS. CONTRACTOR SHALL SUPPLY ANY CONDUIT AND FITTINGS, JUNCTION BOXES, AND HARDWARE REQUIRED BY THE SERVING UTILITY FOR SERVICE.

**GENERAL NOTES**

- MAINTAIN AND PROTECT EXISTING FEATURES (TREES/ SHRUBS/ VEGETATION, DITCHES, DRIVEWAYS, ETC.) WITHIN PROJECT SITE UNLESS OTHERWISE NOTED.
- UTILITIES ARE NOT SHOWN. IT IS THE CONTRACTOR'S RESPONSIBILITY TO AVOID AND PROTECT EXISTING UTILITIES AND RESOLVE CONFLICTS.
- ALL LIGHT STANDARDS AND JUNCTION BOXES SHALL BE INSTALLED WITHIN A CONCRETE PAD IN ACCORDANCE WITH THE DETAIL ON SHEET 63.
- ALL JUNCTION BOXES SHALL INCLUDE THE SYSTEM IDENTIFICATION LETTERS "LT".
- LIGHT STANDARDS SHALL BE PLACED SUCH THAT THERE IS A MINIMUM OF 6 FT FROM CENTER OF STANDARD TO EDGE LINE OR FACE OF CURB. THE CONTRACTOR SHALL NOT PLACE LIGHT STANDARDS IN FORMAL OR INFORMAL WALKING PATHS. THE CONTRACTOR SHALL NOT IMPEDE SIGHT DISTANCE, SIGN VISIBILITY, OR USPS ACCESS WITH LIGHT STANDARD PLACEMENT.
- THE LOCATIONS SHOWN OF POLES, JUNCTION BOXES, AND SERVICE CABINETS ARE APPROXIMATE AND SHOWN OVERSIZE. FIELD ADJUSTMENT MAY BE NECESSARY. SEE NOTES. ALL CONSTRUCTION AND ACTIVITIES SHALL BE LOCATED WITHIN CITY OF FEDERAL WAY PROPERTY. RIGHT-OF-WAY LINES SHOWN ARE APPROXIMATE.

**LEGEND**

- APPROXIMATE RIGHT-OF-WAY
- CONDUIT AND WIRING
- △ WIRE NOTE
- CONSTRUCTION NOTE
- ⊕ LIGHT STANDARD AND LUMINAIRE
- ⊠ TYPE 1 JUNCTION BOX
- ⊡ TYPE 2 JUNCTION BOX
- ⊞ SERVICE CABINET
- ⊕ EX. SIGN AND POST TO BE MAINTAINED

100% DESIGN



DRAFTED: D. MCINTOSH  
DESIGNED: K. DAVIS, P.E.  
REVIEWED: R. PEREZ, P.E.  
APPROVED: R. PEREZ, P.E.



DRAWING VERSION / REVISION LOG		
NO.	DATE	REVISION

**STREET LIGHT INFILL**  
**ILLUMINATION SYSTEM - GROUP J**  
**SW 298 ST - 11 AVE SW TO 10 AVE SW**

CITY PROJECT #:  
**26775**  
SHT. **58**  
OF **76**

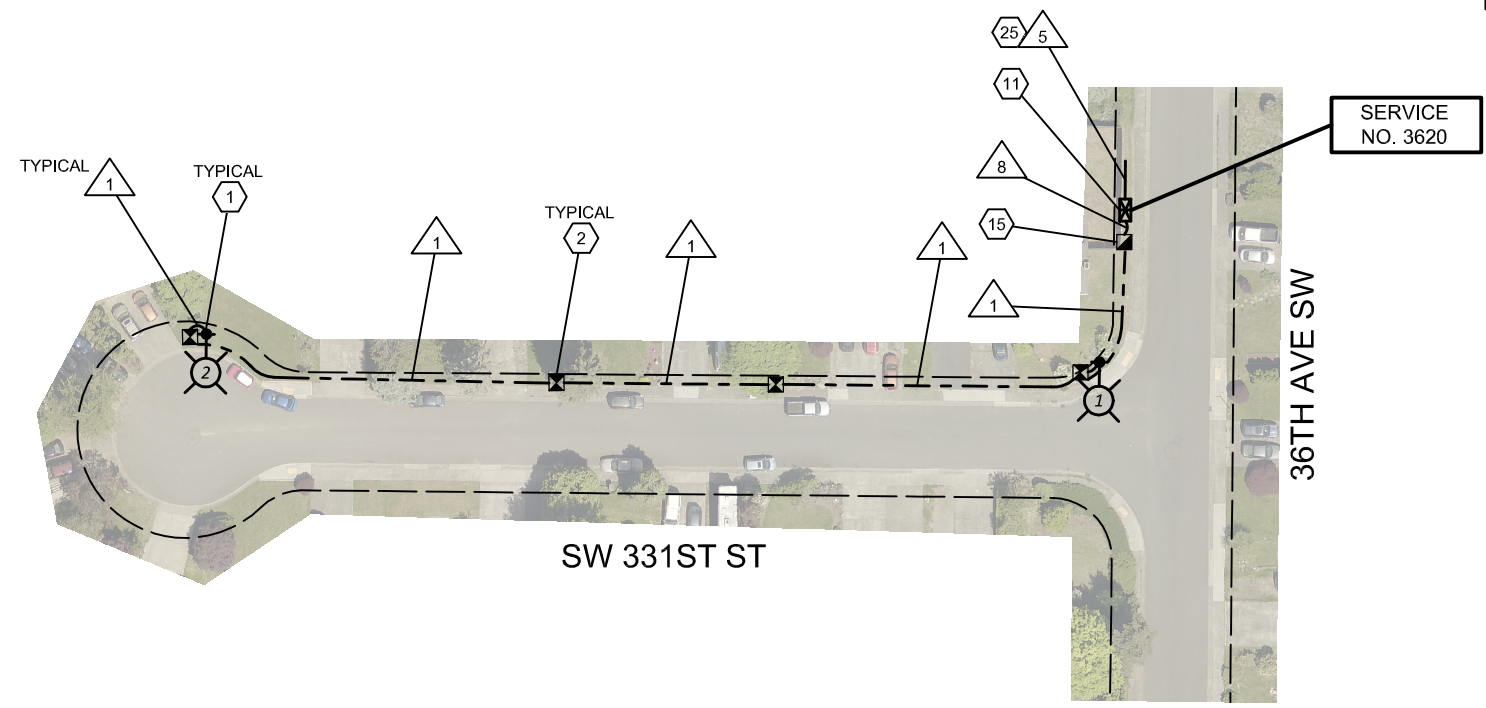
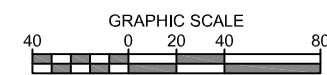

**S 331ST ST - END OF STREET  
TO 36TH AVE SW**

**CONSTRUCTION NOTES**

- ① INSTALL LIGHT STANDARD FOUNDATION, POLE, DAVIT ARM, AND LUMINAIRE IN APPROXIMATE LOCATION SHOWN (2 LOCATIONS THIS SHEET) AND IN ACCORDANCE WITH MANUFACTURER RECOMMENDATIONS, SPECIAL PROVISIONS, AND THE DETAILS ON SHEETS 60 AND 61.
- ② INSTALL TYPE 1 JUNCTION BOX (REFER TO STANDARD PLAN J-40.10 AND THE DETAILS ON SHEETS 65 AND 66) AT APPROXIMATE LOCATION SHOWN (4 BOXES THIS SHEET). SEE NOTES.
- ⑪ INSTALL FOUNDATION AND SERVICE CABINET IN APPROXIMATE LOCATION SHOWN (DOORS FACING 36TH AVE SW) AND IN ACCORDANCE WITH THE DETAILS ON SHEETS 67 AND 68.
- ⑮ INSTALL TYPE 2 JUNCTION BOX (REFER TO STANDARD PLAN J-40.10 AND THE DETAILS ON SHEETS 65 AND 66) AT APPROXIMATE LOCATION SHOWN (1 BOX THIS SHEET). SEE NOTES.
- ⑳ COORDINATE WITH SERVING UTILITY FOR ELECTRICAL CONNECTION POINT. RUN SERVICE CONDUCTOR IN ACCORDANCE WITH POWER UTILITY AND CITY OF FEDERAL WAY PERMIT REQUIREMENTS. CONTRACTOR SHALL SUPPLY ANY CONDUIT AND FITTINGS, JUNCTION BOXES, AND HARDWARE REQUIRED BY THE SERVING UTILITY FOR SERVICE.

**GENERAL NOTES**

- 1. MAINTAIN AND PROTECT EXISTING FEATURES (TREES/ SHRUBS/ VEGETATION, DITCHES, DRIVEWAYS, ETC.) WITHIN PROJECT SITE UNLESS OTHERWISE NOTED.
- 2. UTILITIES ARE NOT SHOWN. IT IS THE CONTRACTOR'S RESPONSIBILITY TO AVOID AND PROTECT EXISTING UTILITIES AND RESOLVE CONFLICTS.
- 3. ALL LIGHT STANDARDS AND JUNCTION BOXES SHALL BE INSTALLED WITHIN A CONCRETE PAD IN ACCORDANCE WITH THE DETAIL ON SHEET 63.
- 4. ALL JUNCTION BOXES SHALL INCLUDE THE SYSTEM IDENTIFICATION LETTERS "LT".
- 5. LIGHT STANDARDS SHALL BE PLACED SUCH THAT THERE IS A MINIMUM OF 6 FT FROM CENTER OF STANDARD TO EDGE LINE OR FACE OF CURB. THE CONTRACTOR SHALL NOT PLACE LIGHT STANDARDS IN FORMAL OR INFORMAL WALKING PATHS. THE CONTRACTOR SHALL NOT IMPEDE SIGHT DISTANCE, SIGN VISIBILITY, OR USPS ACCESS WITH LIGHT STANDARD PLACEMENT.
- 6. THE LOCATIONS SHOWN OF POLES, JUNCTION BOXES, AND SERVICE CABINETS ARE APPROXIMATE AND SHOWN OVERSIZE. FIELD ADJUSTMENT MAY BE NECESSARY. SEE NOTES. ALL CONSTRUCTION AND ACTIVITIES SHALL BE LOCATED WITHIN CITY OF FEDERAL WAY PROPERTY. RIGHT-OF-WAY LINES SHOWN ARE APPROXIMATE.

LUMINAIRE SCHEDULE			SERVICE NO. 3620		
PLAN NUMBER	ID NUMBER	SERVICE - CIRCUIT	TYPE - WATTS	MASTARM	MTG HEIGHT
1	3620-1-SL1-1	36/331 - 1	II - 50	8 FT	30 FT
2	3620-1-SL1-2	36/331 - 1	II - 50	8 FT	30 FT

WIRING SCHEDULE				
△ X	RUN NO.	CONDUIT	WIRE	COMMENTS
	1	2" PVC	2-#8 (ILLUM)	SHALL BE ALUMINUM
	5	PER PSE (2" MINIMUM)	PER PSE (3-#6 MINIMUM)	PER PSE
	8	2" PVC	2-#8 (ILLUM)	SHALL BE ALUMINUM
		2" PVC	SPARE	WITH GROUND AND PULL TAPE

**NOTES**

- 1. JUNCTION BOXES FOR SW 331ST ST ARE INTENDED TO HAVE SPACING OF APPROXIMATELY 195 FEET FOR INSTALLATION OF ADDITIONAL LIGHT STANDARDS IN THE FUTURE. THE CONTRACTOR SHALL BEAR THIS IN MIND WHEN PLACING THE JUNCTION BOXES AND ATTEMPT TO ADHERE TO THE SPACING AND PLAN LOCATIONS AS MUCH AS IS PRACTICABLE. THE CONTRACTING AGENCY UNDERSTANDS THAT FIELD CONDITIONS MAY PRECLUDE THIS. ANY JUNCTION BOX SPACING GREATER THAN 250 FEET WILL NEED TO BE COORDINATED AND APPROVED BY THE ENGINEER, PRIOR TO INSTALLATION. IF FEWER JUNCTION BOXES ARE INSTALLED THAN SHOWN IN THE PLANS, THOSE BOXES SHALL BE DELIVERED TO THE KING COUNTY SIGNAL SHOP AT THE CONTRACTOR'S EXPENSE.

**LEGEND**

- APPROXIMATE RIGHT-OF-WAY
- CONDUIT AND WIRING
- △ WIRE NOTE
- CONSTRUCTION NOTE
- ⊙ LIGHT STANDARD AND LUMINAIRE
- ⊠ TYPE 1 JUNCTION BOX
- ⊡ TYPE 2 JUNCTION BOX
- ⊞ SERVICE CABINET
- ⊕ EX. SIGN AND POST TO BE MAINTAINED

100% DESIGN

DRAFTED: D. MCINTOSH  
DESIGNED: K. DAVIS, P.E.  
REVIEWED: R. PEREZ, P.E.  
APPROVED: R. PEREZ, P.E.



DRAWING VERSION / REVISION LOG		
NO.	DATE	REVISION

**STREET LIGHT INFILL**

**ILLUMINATION SYSTEM - GROUP K**

**SW 331 ST - END OF STREET TO 36 AVE SW**

CITY PROJECT #: 26775  
SHT. 59  
OF 76

K:\ENGINEERING DIVISION\PROJECTS\ACTIVE\26775 - Streetlight Infill\03 PE\ACAD\331-36.dwg 12/12/2023 3:08 PM