

**SW DASH POINT RD - 53RD AVE SW
TO 48 AVE SW -- SHEET 4 OF 4**

LUMINAIRE SCHEDULE			SERVICE NO. 2612		
PLAN NUMBER	ID NUMBER	SERVICE - CIRCUIT	TYPE - WATTS	MASTARM	MTG HEIGHT
1	2612-1-SL2-1 (EX.)	509/47 - 2	EX.	EX.	EX.
2	2612-1-SL1-2 (EX.)	509/47 - 1	EX.	EX.	EX.
3	2612-1-SL1-3 (EX.)	509/47 - 1	EX.	EX.	EX.
6	2612-1-SL2-6 (EX.)	509/47 - 2	EX.	EX.	EX.

WIRING SCHEDULE			
△ X RUN NO.	CONDUIT	WIRE	COMMENTS
3	EX. 2" PVC	NEW 2-#8 (ILLUM), EX. 2-#8 (BEACONS)	NEW CONDUCTORS SHALL BE ALUMINUM

NOTES

- JUNCTION BOXES FOR SW DASH POINT RD SW ARE INTENDED TO HAVE SPACING OF APPROXIMATELY 175 FEET FOR INSTALLATION OF ADDITIONAL LIGHT STANDARDS IN THE FUTURE. THE CONTRACTOR SHALL BEAR THIS IN MIND WHEN PLACING THE JUNCTION BOXES AND ATTEMPT TO ADHERE TO THE SPACING AND PLAN LOCATIONS AS MUCH AS IS PRACTICABLE. THE CONTRACTING AGENCY UNDERSTANDS THAT FIELD CONDITIONS MAY PRECLUDE THIS. ANY JUNCTION BOX SPACING GREATER THAN 250 FEET WILL NEED TO BE COORDINATED AND APPROVED BY THE ENGINEER, PRIOR TO INSTALLATION. IF FEWER JUNCTION BOXES ARE INSTALLED THAN SHOWN IN THE PLANS, THOSE BOXES SHALL BE DELIVERED TO THE KING COUNTY SIGNAL SHOP AT THE CONTRACTOR'S EXPENSE.

CONSTRUCTION NOTES

- ④ SPLICE NEW CONDUCTOR TO EXISTING ILLUMINATION CONDUCTORS.
- ⑤ MAINTAIN AND PROTECT EXISTING ILLUMINATION SYSTEM.
- ⑦ EXISTING SERVICE CABINET TO BE USED FOR PROPOSED LIGHT STANDARDS FOR SW DASH POINT RD - 53 AVE SW TO 48 AVE SW
- ⑨ EXISTING PSE LUMINAIRE MOUNTED ON PSE POLE (2 LOCATIONS THIS SHEET).

GENERAL NOTES

- MAINTAIN AND PROTECT EXISTING FEATURES (TREES/ SHRUBS/ VEGETATION, DITCHES, DRIVEWAYS, ETC.) WITHIN PROJECT SITE UNLESS OTHERWISE NOTED.
- UTILITIES ARE NOT SHOWN. IT IS THE CONTRACTOR'S RESPONSIBILITY TO AVOID AND PROTECT EXISTING UTILITIES AND RESOLVE CONFLICTS.
- ALL LIGHT STANDARDS AND JUNCTION BOXES SHALL BE INSTALLED WITHIN A CONCRETE PAD IN ACCORDANCE WITH THE DETAIL ON SHEET 63.
- ALL JUNCTION BOXES SHALL INCLUDE THE SYSTEM IDENTIFICATION LETTERS "LT".
- LIGHT STANDARDS SHALL BE PLACED SUCH THAT THERE IS A MINIMUM OF 6 FT FROM CENTER OF STANDARD TO EDGE LINE OR FACE OF CURB. THE CONTRACTOR SHALL NOT PLACE LIGHT STANDARDS IN FORMAL OR INFORMAL WALKING PATHS. THE CONTRACTOR SHALL NOT IMPEDE SIGHT DISTANCE, SIGN VISIBILITY, OR USPS ACCESS WITH LIGHT STANDARD PLACEMENT.
- THE LOCATIONS SHOWN OF POLES, JUNCTION BOXES, AND SERVICE CABINETS ARE APPROXIMATE AND SHOWN OVERSIZE. FIELD ADJUSTMENT MAY BE NECESSARY. SEE NOTES. ALL CONSTRUCTION AND ACTIVITIES SHALL BE LOCATED WITHIN CITY OF FEDERAL WAY PROPERTY. RIGHT-OF-WAY LINES SHOWN ARE APPROXIMATE.

LEGEND

- APPROXIMATE RIGHT-OF-WAY
- - - EX. CONDUIT AND WIRING
- △ WIRE NOTE
- ⑥ CONSTRUCTION NOTE
- ⊕ EX. CITY-OWNED LIGHT STANDARD AND LUMINAIRE
- ⊕ EX. PSE LUMINAIRE AND POLE
- ⊠ EX. TYPE 1 JUNCTION BOX
- ⊠ EX. TYPE 2 JUNCTION BOX
- ⊠ EX. SERVICE CABINET
- ⊕ EX. SIGN AND POST TO BE MAINTAINED

100% DESIGN

CITY OF Federal Way
Centered on Opportunity
33325 8th Avenue South
Federal Way, WA 98003-6325
(253) 835-2700
www.cityoffederalway.com

811
Know what's below.
Call 811 before you dig.

DRAFTED: D. MCINTOSH
DESIGNED: K. DAVIS, P.E.
REVIEWED: R. PEREZ, P.E.
APPROVED: R. PEREZ, P.E.



DRAWING VERSION / REVISION LOG		
NO.	DATE	REVISION

STREET LIGHT INFILL
ILLUMINATION SYSTEM - GROUP A
SW DASH POINT RD - 53 AVE SW TO 48 AVE SW

CITY PROJECT #:
26775
SHT. 16
OF 76

K:\ENGINEERING DIVISION\PROJECTS\ACTIVE\26775 - Streetlight Infill\03 PE\ACAD\SR 509-48.dwg 12/12/2023 2:19 PM

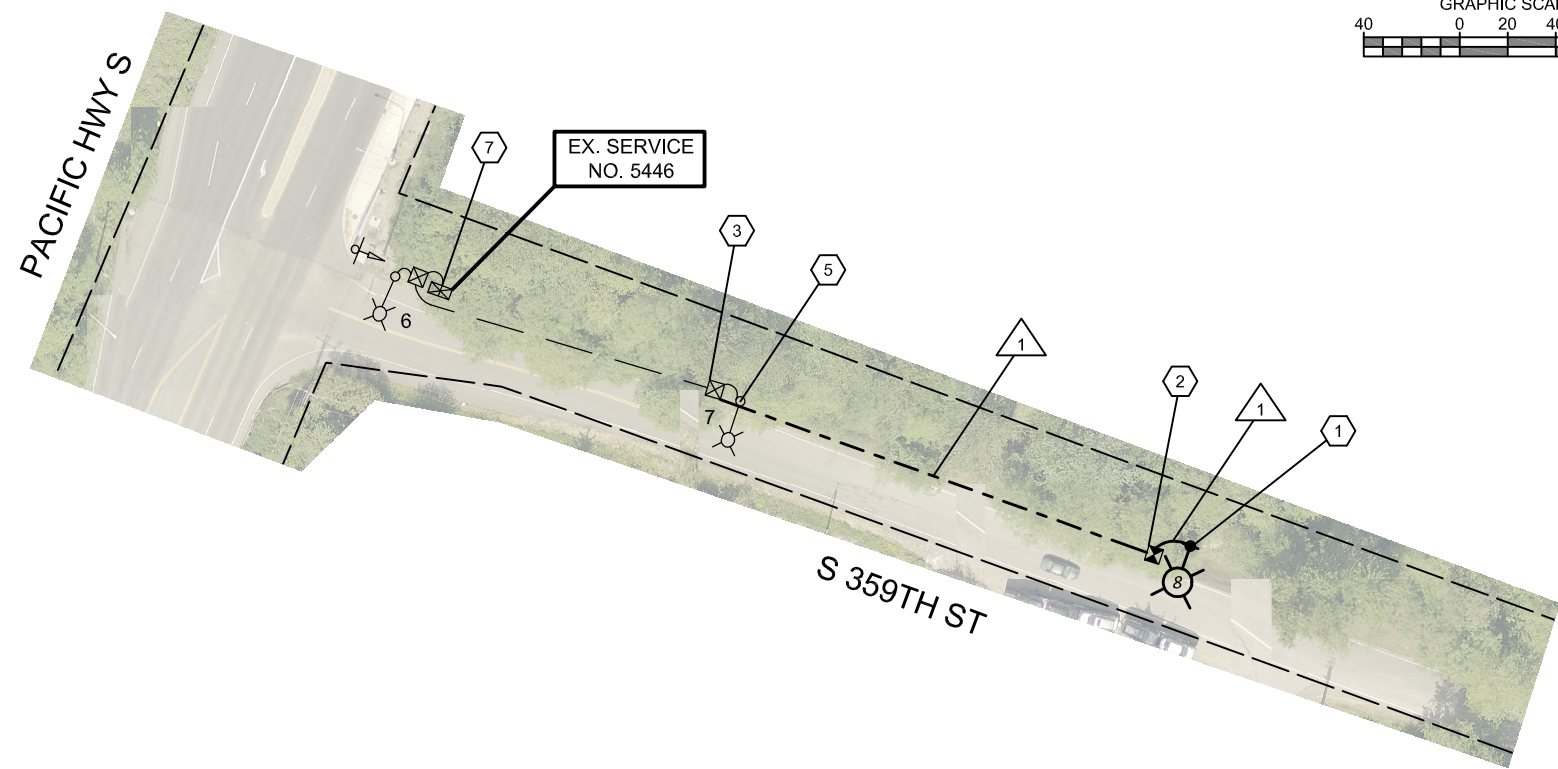

S 359TH ST AT PACIFIC HWY S

CONSTRUCTION NOTES

- ① INSTALL LIGHT STANDARD FOUNDATION, POLE, DAVIT ARM, AND LUMINAIRE IN APPROXIMATE LOCATION SHOWN (1 LOCATION THIS SHEET) AND IN ACCORDANCE WITH MANUFACTURER RECOMMENDATIONS, SPECIAL PROVISIONS, AND THE DETAILS ON SHEETS 60 AND 61.
- ② INSTALL TYPE 1 JUNCTION BOX (REFER TO STANDARD PLAN J-40.10 AND THE DETAILS ON SHEETS 65 AND 66) AT APPROXIMATE LOCATION SHOWN (1 BOX THIS SHEET). SEE NOTES.
- ③ INSTALL CONDUIT INTO EXISTING JUNCTION BOX. SPLICE NEW CONDUCTORS TO EXISTING ILLUMINATION CONDUCTORS.
- ⑤ MAINTAIN AND PROTECT EXISTING ILLUMINATION SYSTEM.
- ⑦ EXISTING SERVICE CABINET TO BE USED FOR PROPOSED LIGHT STANDARDS FOR S 359 ST AT PACIFIC HWY S.

GENERAL NOTES

- 1. MAINTAIN AND PROTECT EXISTING FEATURES (TREES/ SHRUBS/ VEGETATION, DITCHES, DRIVEWAYS, ETC.) WITHIN PROJECT SITE UNLESS OTHERWISE NOTED.
- 2. UTILITIES ARE NOT SHOWN. IT IS THE CONTRACTOR'S RESPONSIBILITY TO AVOID AND PROTECT EXISTING UTILITIES AND RESOLVE CONFLICTS.
- 3. ALL LIGHT STANDARDS AND JUNCTION BOXES SHALL BE INSTALLED WITHIN A CONCRETE PAD IN ACCORDANCE WITH THE DETAIL ON SHEET 63.
- 4. ALL JUNCTION BOXES SHALL INCLUDE THE SYSTEM IDENTIFICATION LETTERS "LT".
- 5. LIGHT STANDARDS SHALL BE PLACED SUCH THAT THERE IS A MINIMUM OF 6 FT FROM CENTER OF STANDARD TO EDGE LINE OR FACE OF CURB. THE CONTRACTOR SHALL NOT PLACE LIGHT STANDARDS IN FORMAL OR INFORMAL WALKING PATHS. THE CONTRACTOR SHALL NOT IMPEDE SIGHT DISTANCE, SIGN VISIBILITY, OR USPS ACCESS WITH LIGHT STANDARD PLACEMENT.
- 6. THE LOCATIONS SHOWN OF POLES, JUNCTION BOXES, AND SERVICE CABINETS ARE APPROXIMATE AND SHOWN OVERSIZE. FIELD ADJUSTMENT MAY BE NECESSARY. SEE NOTES. ALL CONSTRUCTION AND ACTIVITIES SHALL BE LOCATED WITHIN CITY OF FEDERAL WAY PROPERTY. RIGHT-OF-WAY LINES SHOWN ARE APPROXIMATE.

LUMINAIRE SCHEDULE			SERVICE NO. 5446		
PLAN NUMBER	ID NUMBER	SERVICE - CIRCUIT	TYPE - WATTS	MASTARM	MTG HEIGHT
6	5446-1-SL2-6 (EX.)	99/359 - 2	EX.	EX.	EX.
7	5446-1-SL2-7 (EX.)	99/359 - 2	EX.	EX.	EX.
8	5446-1-SL2-8	99/359 - 2	II - 60	12 FT	30 FT

WIRING SCHEDULE			
X RUN NO.	CONDUIT	WIRE	COMMENTS
1	2" PVC	2-#8 (ILLUM)	SHALL BE ALUMINUM

LEGEND	
---	APPROXIMATE RIGHT-OF-WAY
---	CONDUIT AND WIRING
- - -	EX. CONDUIT AND WIRING
△	WIRE NOTE
○	CONSTRUCTION NOTE
⊕	LIGHT STANDARD AND LUMINAIRE
⊕	EX. CITY-OWNED LIGHT STANDARD AND LUMINAIRE
⊠	TYPE 1 JUNCTION BOX
⊠	EX. TYPE 1 JUNCTION BOX
⊠	EX. SERVICE CABINET
⊕	EX. SIGN AND POST TO BE MAINTAINED

NOTES

- 1. JUNCTION BOXES FOR S 359TH ST ARE INTENDED TO HAVE SPACING OF APPROXIMATELY 190 FEET FOR INSTALLATION OF ADDITIONAL LIGHT STANDARDS IN THE FUTURE. THE CONTRACTOR SHALL BEAR THIS IN MIND WHEN PLACING THE JUNCTION BOXES AND ATTEMPT TO ADHERE TO THE SPACING AND PLAN LOCATIONS AS MUCH AS IS PRACTICABLE. THE CONTRACTING AGENCY UNDERSTANDS THAT FIELD CONDITIONS MAY PRECLUDE THIS. ANY JUNCTION BOX SPACING GREATER THAN 250 FEET WILL NEED TO BE COORDINATED AND APPROVED BY THE ENGINEER, PRIOR TO INSTALLATION. IF FEWER JUNCTION BOXES ARE INSTALLED THAN SHOWN IN THE PLANS, THOSE BOXES SHALL BE DELIVERED TO THE KING COUNTY SIGNAL SHOP AT THE CONTRACTOR'S EXPENSE.

100% DESIGN

CITY OF Federal Way
Centered on Opportunity
33325 8th Avenue South
Federal Way, WA 98003-6325
(253) 835-2700
www.cityoffederalway.com

811
Know what's below.
Call 811 before you dig.

DRAFTED: D. MCINTOSH
DESIGNED: K. DAVIS, P.E.
REVIEWED: R. PEREZ, P.E.
APPROVED: R. PEREZ, P.E.

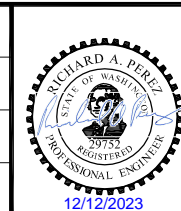

DRAWING VERSION / REVISION LOG		
NO.	DATE	REVISION

STREET LIGHT INFILL
ILLUMINATION SYSTEM - GROUP A
S 359 ST AT PACIFIC HWY S

CITY PROJECT #:	26775
SHT.	17
OF	76

CONSTRUCTION NOTES

- 1 INSTALL LIGHT STANDARD FOUNDATION, POLE, DAVIT ARM, AND LUMINAIRE IN APPROXIMATE LOCATION SHOWN (2 LOCATIONS THIS SHEET) AND IN ACCORDANCE WITH MANUFACTURER RECOMMENDATIONS, SPECIAL PROVISIONS, AND THE DETAIL ON SHEETS 60 AND 61.
- 2 INSTALL TYPE 1 JUNCTION BOX (REFER TO STANDARD PLAN J-40.10 AND THE DETAILS ON SHEETS 65 AND 66) AT APPROXIMATE LOCATION SHOWN (4 BOXES THIS SHEET). SEE NOTES.
- 3 INSTALL CONDUIT INTO EXISTING JUNCTION BOX. SPLICE NEW CONDUCTORS TO EXISTING ILLUMINATION CONDUCTORS.
- 5 MAINTAIN AND PROTECT EXISTING ILLUMINATION SYSTEM.
- 7 EXISTING SERVICE CABINET TO BE USED FOR PROPOSED LIGHT STANDARDS FOR S 359 ST AT 16 AVE S.
- 9 EXISTING PSE LUMINAIRE MOUNTED ON PSE POLE (1 LOCATION THIS SHEET).

GENERAL NOTES

- 1. MAINTAIN AND PROTECT EXISTING FEATURES (TREES/ SHRUBS/ VEGETATION, DITCHES, DRIVEWAYS, ETC.) WITHIN PROJECT SITE UNLESS OTHERWISE NOTED. UTILITIES ARE NOT SHOWN. IT IS THE CONTRACTOR'S RESPONSIBILITY TO AVOID AND PROTECT EXISTING UTILITIES AND RESOLVE CONFLICTS.
- 2. ALL LIGHT STANDARDS AND JUNCTION BOXES SHALL BE INSTALLED WITHIN A CONCRETE PAD IN ACCORDANCE WITH THE DETAIL ON SHEET 63.
- 3. ALL JUNCTION BOXES SHALL INCLUDE THE SYSTEM IDENTIFICATION LETTERS "LT".
- 4. LIGHT STANDARDS SHALL BE PLACED SUCH THAT THERE IS A MINIMUM OF 6 FT FROM CENTER OF STANDARD TO EDGE LINE OR FACE OF CURB. THE CONTRACTOR SHALL NOT PLACE LIGHT STANDARDS IN FORMAL OR INFORMAL WALKING PATHS. THE CONTRACTOR SHALL NOT IMPEDE SIGHT DISTANCE, SIGN VISIBILITY, OR USPS ACCESS WITH LIGHT STANDARD PLACEMENT.
- 5. THE LOCATIONS SHOWN OF POLES, JUNCTION BOXES, AND SERVICE CABINETS ARE APPROXIMATE AND SHOWN OVERSIZE. FIELD ADJUSTMENT MAY BE NECESSARY. SEE NOTES. ALL CONSTRUCTION AND ACTIVITIES SHALL BE LOCATED WITHIN CITY OF FEDERAL WAY PROPERTY. RIGHT-OF-WAY LINES SHOWN ARE APPROXIMATE.

LEGEND

- APPROXIMATE RIGHT-OF-WAY
- CONDUIT AND WIRING
- - - EX. CONDUIT AND WIRING
- △ WIRE NOTE
- CONSTRUCTION NOTE
- ⊕ LIGHT STANDARD AND LUMINAIRE
- ⊕ EX. CITY-OWNED LIGHT STANDARD AND LUMINAIRE
- ⊕ EX. PSE LUMINAIRE AND POLE
- ⊠ TYPE 1 JUNCTION BOX
- ⊠ EX. TYPE 1 JUNCTION BOX
- ⊠ EX. SERVICE CABINET
- ⊕ EX. SIGN AND POST TO BE MAINTAINED

LUMINAIRE SCHEDULE		SERVICE NO. 5750			
PLAN NUMBER	ID NUMBER	SERVICE - CIRCUIT	TYPE - WATTS	MASTARM	MTG HEIGHT
7	5750-1-SL3-7 (EX.)	16/TBHS - 3	EX.	EX.	EX.
8	5750-1-SL3-8 (EX.)	16/TBHS - 3	EX.	EX.	EX.
9	5750-1-SL2-9 (EX.)	16/TBHS - 2	EX.	EX.	EX.
10	5750-1-SL1-10 (EX.)	16/TBHS - 1	EX.	EX.	EX.
11	5750-1-SL2-11 (EX.)	16/TBHS - 2	EX.	EX.	EX.
17	5750-1-SL2-17 (EX.)	16/TBHS - 2	EX.	EX.	EX.
18	5750-1-SL2-18	16/TBHS - 2	II - 60	12 FT	30 FT
19	5750-1-SL2-19	16/TBHS - 2	II - 60	12 FT	30 FT

WIRING SCHEDULE				
△ X RUN NO.	CONDUIT	WIRE	COMMENTS	
1	2" PVC	2-#8 (ILLUM)	SHALL BE ALUMINUM	

NOTES

- 1. JUNCTION BOXES FOR S 359TH ST ARE INTENDED TO HAVE SPACING OF APPROXIMATELY 190 FEET FOR INSTALLATION OF ADDITIONAL LIGHT STANDARDS IN THE FUTURE. THE CONTRACTOR SHALL BEAR THIS IN MIND WHEN PLACING THE JUNCTION BOXES AND ATTEMPT TO ADHERE TO THE SPACING AND PLAN LOCATIONS AS MUCH AS IS PRACTICABLE. THE CONTRACTING AGENCY UNDERSTANDS THAT FIELD CONDITIONS MAY PRECLUDE THIS. ANY JUNCTION BOX SPACING GREATER THAN 250 FEET WILL NEED TO BE COORDINATED AND APPROVED BY THE ENGINEER, PRIOR TO INSTALLATION. IF FEWER JUNCTION BOXES ARE INSTALLED THAN SHOWN IN THE PLANS, THOSE BOXES SHALL BE DELIVERED TO THE KING COUNTY SIGNAL SHOP AT THE CONTRACTOR'S EXPENSE.



CITY OF Federal Way
Centered on Opportunity

33325 8th Avenue South
Federal Way, WA 98003-6325

(253) 835-2700
www.cityoffederalway.com



811
Know what's below.
Call 811 before you dig.

DRAFTED: D. MCINTOSH
DESIGNED: K. DAVIS, P.E.
REVIEWED: R. PEREZ, P.E.
APPROVED: R. PEREZ, P.E.



RICHARD A. PEREZ
STATE OF WASHINGTON
REGISTERED PROFESSIONAL ENGINEER
12/12/2023

DRAWING VERSION / REVISION LOG		
NO.	DATE	REVISION

100% DESIGN

STREET LIGHT INFILL

ILLUMINATION SYSTEM - GROUP A

S 359 ST AT 16 AVE S

CITY PROJECT #:
26775

SHT. **18**
OF **76**

K:\ENGINEERING DIVISION\PROJECTS\ACTIVE\26775 - Streetlight Infill\03 PE\ACAD\359-16.dwg 12/12/2023 2:22 PM

S 272ND ST
(CITY OF KENT)

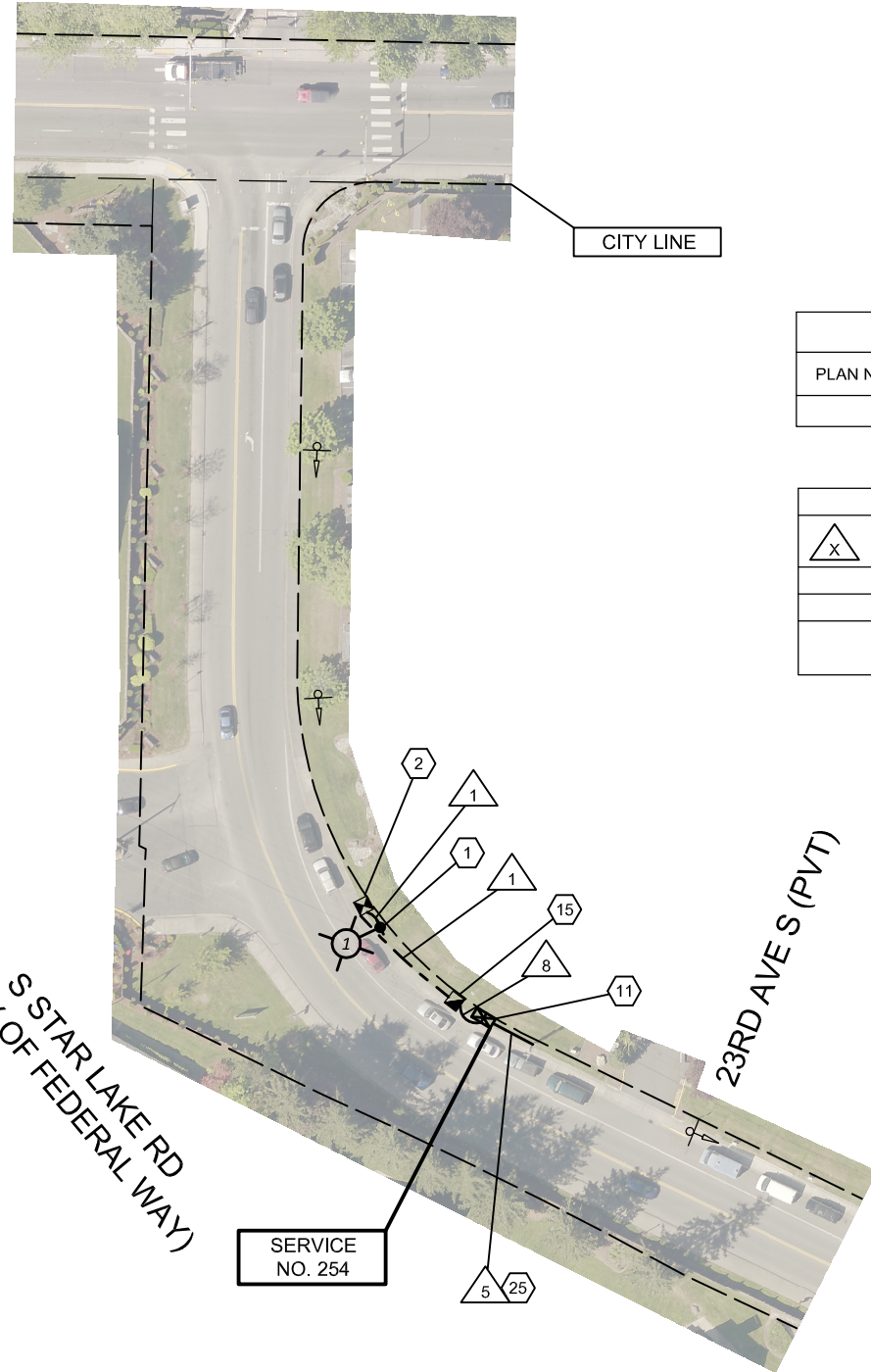
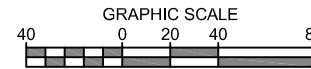

LUMINAIRE SCHEDULE			SERVICE NO. 254		
PLAN NUMBER	ID NUMBER	SERVICE - CIRCUIT	TYPE - WATTS	MASTARM	MTG HEIGHT
1	254-1-SL1-1	STAR/23 - 1	II - 60	12 FT	35 FT

WIRING SCHEDULE			
△ X RUN NO.	CONDUIT	WIRE	COMMENTS
1	2" PVC	2-#8 (ILLUM)	SHALL BE ALUMINUM
5	PER PSE (2" MINIMUM)	PER PSE (3-#6 MINIMUM)	PER PSE
8	2" PVC	2-#8 (ILLUM)	SHALL BE ALUMINUM
	2" PVC	SPARE	WITH GROUND AND PULL TAPE

S STAR LAKE RD AT
23RD AVE S (PVT)

CONSTRUCTION NOTES

- ① INSTALL LIGHT STANDARD FOUNDATION, POLE, DAVIT ARM, AND LUMINAIRE IN APPROXIMATE LOCATION SHOWN (1 LOCATION THIS SHEET) AND IN ACCORDANCE WITH MANUFACTURER RECOMMENDATIONS, SPECIAL PROVISIONS, AND THE DETAILS ON SHEETS 60 AND 61 .
- ② INSTALL TYPE 1 JUNCTION BOX (REFER TO STANDARD PLAN J-40.10 AND THE DETAILS ON SHEETS 65 AND 66) AT APPROXIMATE LOCATION SHOWN (1 BOX THIS SHEET).
- ⑪ INSTALL FOUNDATION AND SERVICE CABINET IN APPROXIMATE LOCATION SHOWN (DOORS FACING S STAR LAKE RD) AND IN ACCORDANCE WITH THE DETAILS ON THE SHEET 67 AND 68.
- ⑮ INSTALL TYPE 2 JUNCTION BOX (REFER TO STANDARD PLAN J-40.10 AND THE DETAILS ON SHEETS 65 AND 66) AT APPROXIMATE LOCATION SHOWN (1 BOX THIS SHEET).
- ⑫ COORDINATE WITH SERVING UTILITY FOR ELECTRICAL CONNECTION POINT. RUN SERVICE CONDUCTOR IN ACCORDANCE WITH POWER UTILITY AND CITY OF FEDERAL WAY PERMIT REQUIREMENTS. CONTRACTOR SHALL SUPPLY ANY CONDUIT AND FITTINGS, JUNCTION BOXES, AND HARDWARE REQUIRED BY THE SERVING UTILITY FOR SERVICE.

GENERAL NOTES

- 1. MAINTAIN AND PROTECT EXISTING FEATURES (TREES/ SHRUBS/ VEGETATION, DITCHES, DRIVEWAYS, ETC.) WITHIN PROJECT SITE UNLESS OTHERWISE NOTED.
- 2. UTILITIES ARE NOT SHOWN. IT IS THE CONTRACTOR'S RESPONSIBILITY TO AVOID AND PROTECT EXISTING UTILITIES AND RESOLVE CONFLICTS.
- 3. ALL LIGHT STANDARDS AND JUNCTION BOXES SHALL BE INSTALLED WITHIN A CONCRETE PAD IN ACCORDANCE WITH THE DETAIL ON SHEET 63.
- 4. ALL JUNCTION BOXES SHALL INCLUDE THE SYSTEM IDENTIFICATION LETTERS "LT".
- 5. LIGHT STANDARDS SHALL BE PLACED SUCH THAT THERE IS A MINIMUM OF 6 FT FROM CENTER OF STANDARD TO EDGE LINE OR FACE OF CURB. THE CONTRACTOR SHALL NOT PLACE LIGHT STANDARDS IN FORMAL OR INFORMAL WALKING PATHS. THE CONTRACTOR SHALL NOT IMPEDE SIGHT DISTANCE, SIGN VISIBILITY, OR USPS ACCESS WITH LIGHT STANDARD PLACEMENT.
- 6. THE LOCATIONS SHOWN OF POLES, JUNCTION BOXES, AND SERVICE CABINETS ARE APPROXIMATE AND SHOWN OVERSIZE. FIELD ADJUSTMENT MAY BE NECESSARY. SEE NOTES. ALL CONSTRUCTION AND ACTIVITIES SHALL BE LOCATED WITHIN CITY OF FEDERAL WAY PROPERTY. RIGHT-OF-WAY LINES SHOWN ARE APPROXIMATE.

LEGEND

- APPROXIMATE RIGHT-OF-WAY
- CONDUIT AND WIRING
- △ WIRE NOTE
- CONSTRUCTION NOTE
- ⊕ LIGHT STANDARD AND LUMINAIRE
- ⊠ TYPE 1 JUNCTION BOX
- ⊠ TYPE 2 JUNCTION BOX
- ⊠ SERVICE CABINET
- ⊕ EX. SIGN AND POST TO BE MAINTAINED

100% DESIGN



33325 8th Avenue South
Federal Way, WA 98003-6325
(253) 835-2700
www.cityoffederalway.com



DRAFTED: D. MCINTOSH
DESIGNED: K. DAVIS, P.E.
REVIEWED: R. PEREZ, P.E.
APPROVED: R. PEREZ, P.E.



DRAWING VERSION / REVISION LOG		
NO.	DATE	REVISION

STREET LIGHT INFILL
ILLUMINATION SYSTEM - GROUP A
STAR LAKE RD S AT 23 AVE S (PVT)

CITY PROJECT #:
26775
SHT. 19
OF 76

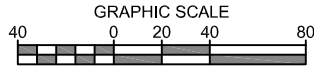

LUMINAIRE SCHEDULE			SERVICE NO. 3650		
PLAN NUMBER	ID NUMBER	SERVICE - CIRCUIT	TYPE - WATTS	MASTARM	MTG HEIGHT
1	3650-1-SL1-1	18/330 - 1	II - 60	8 FT	30 FT
2	3650-1-SL1-2	18/330 - 1	II - 60	8 FT	30 FT

WIRING SCHEDULE			
△ X RUN NO.	CONDUIT	WIRE	COMMENTS
1	2" PVC	2-#8 (ILLUM)	SHALL BE ALUMINUM

CONSTRUCTION NOTES

- ① INSTALL LIGHT STANDARD FOUNDATION, POLE, DAVIT ARM, AND LUMINAIRE IN APPROXIMATE LOCATION SHOWN (2 LOCATIONS THIS SHEET) AND IN ACCORDANCE WITH MANUFACTURER RECOMMENDATIONS, SPECIAL PROVISIONS, AND THE DETAILS ON SHEETS 60 AND 61.
- ② INSTALL TYPE 1 JUNCTION BOX (REFER TO STANDARD PLAN J-40.10 AND THE DETAILS ON SHEETS 65 AND 66) AT APPROXIMATE LOCATION SHOWN (7 BOXES THIS SHEET). SEE NOTES.
- ③ INSTALL CONDUIT INTO EXISTING JUNCTION BOX. SPLICE NEW CONDUCTORS TO EXISTING ILLUMINATION CONDUCTORS.
- ⑦ EXISTING SERVICE CABINET TO BE USED FOR PROPOSED LIGHT STANDARDS FOR S 330 ST - PACIFIC HWY S TO 18 PL S (PVT).
- ⑨ EXISTING PSE LUMINAIRE MOUNTED ON PSE POLE (4 LOCATIONS THIS SHEET).

GENERAL NOTES

- 1. MAINTAIN AND PROTECT EXISTING FEATURES (TREES/ SHRUBS/ VEGETATION, DITCHES, DRIVEWAYS, ETC.) WITHIN PROJECT SITE UNLESS OTHERWISE NOTED.
- 2. UTILITIES ARE NOT SHOWN. IT IS THE CONTRACTOR'S RESPONSIBILITY TO AVOID AND PROTECT EXISTING UTILITIES AND RESOLVE CONFLICTS.
- 3. ALL LIGHT STANDARDS AND JUNCTION BOXES SHALL BE INSTALLED WITHIN A CONCRETE PAD IN ACCORDANCE WITH THE DETAIL ON SHEET 63.
- 4. ALL JUNCTION BOXES SHALL INCLUDE THE SYSTEM IDENTIFICATION LETTERS "LT".
- 5. LIGHT STANDARDS SHALL BE PLACED SUCH THAT THERE IS A MINIMUM OF 6 FT FROM CENTER OF STANDARD TO EDGE LINE OR FACE OF CURB. THE CONTRACTOR SHALL NOT PLACE LIGHT STANDARDS IN FORMAL OR INFORMAL WALKING PATHS. THE CONTRACTOR SHALL NOT IMPEDE SIGHT DISTANCE, SIGN VISIBILITY, OR USPS ACCESS WITH LIGHT STANDARD PLACEMENT.
- 6. THE LOCATIONS SHOWN OF POLES, JUNCTION BOXES, AND SERVICE CABINETS ARE APPROXIMATE AND SHOWN OVERSIZE. FIELD ADJUSTMENT MAY BE NECESSARY. SEE NOTES. ALL CONSTRUCTION AND ACTIVITIES SHALL BE LOCATED WITHIN CITY OF FEDERAL WAY PROPERTY. RIGHT-OF-WAY LINES SHOWN ARE APPROXIMATE.

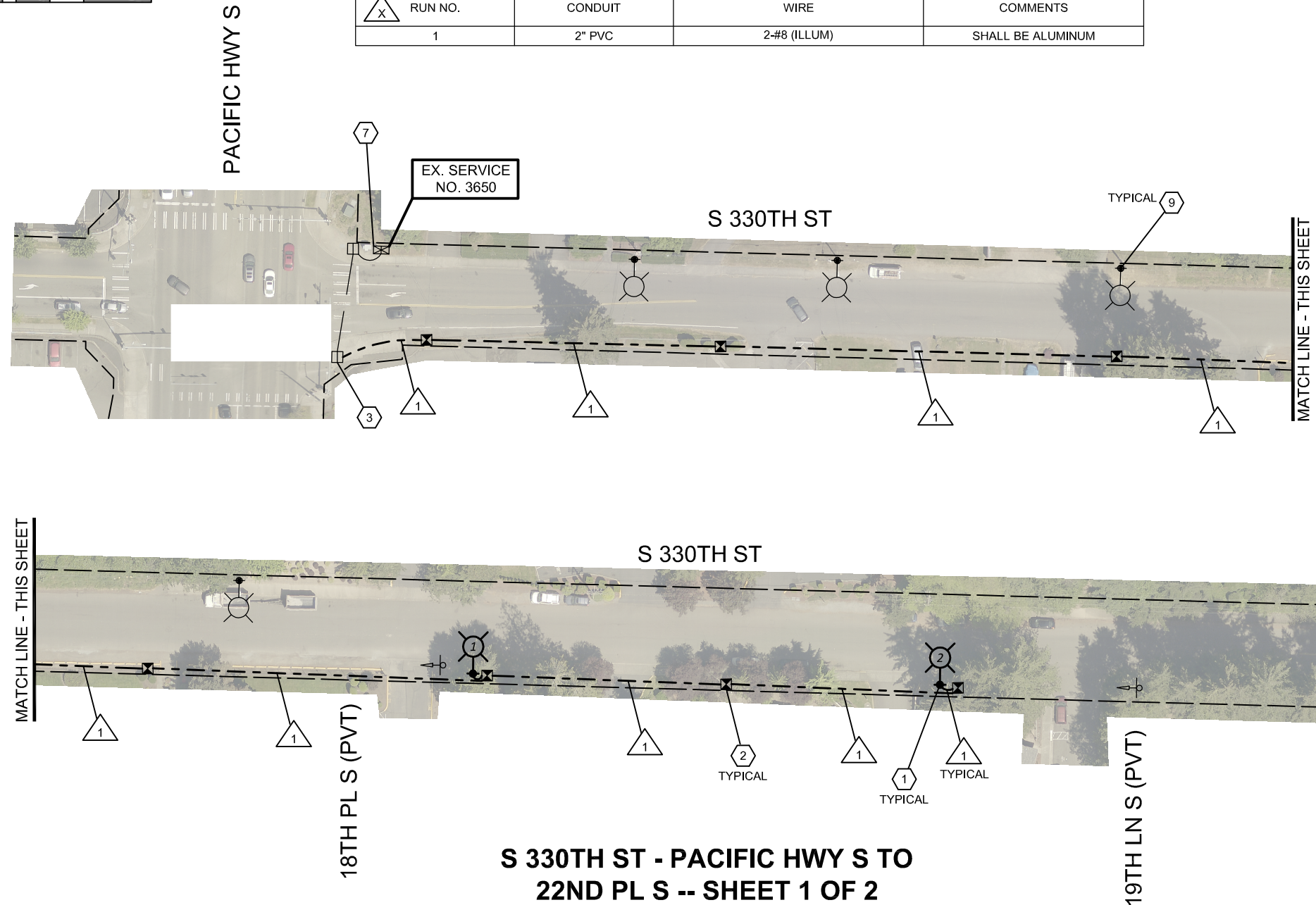

S 330TH ST - PACIFIC HWY S TO 22ND PL S -- SHEET 1 OF 2

NOTES

- 1. JUNCTION BOXES FOR S 330TH ST ARE INTENDED TO HAVE SPACING OF APPROXIMATELY 190 FEET FOR INSTALLATION OF ADDITIONAL LIGHT STANDARDS IN THE FUTURE. THE CONTRACTOR SHALL BEAR THIS IN MIND WHEN PLACING THE JUNCTION BOXES AND ATTEMPT TO ADHERE TO THE SPACING AND PLAN LOCATIONS AS MUCH AS IS PRACTICABLE. THE CONTRACTING AGENCY UNDERSTANDS THAT FIELD CONDITIONS MAY PRECLUDE THIS. ANY JUNCTION BOX SPACING GREATER THAN 250 FEET WILL NEED TO BE COORDINATED AND APPROVED BY THE ENGINEER, PRIOR TO INSTALLATION. IF FEWER JUNCTION BOXES ARE INSTALLED THAN SHOWN IN THE PLANS, THOSE BOXES SHALL BE DELIVERED TO THE KING COUNTY SIGNAL SHOP AT THE CONTRACTOR'S EXPENSE.

LEGEND

- APPROXIMATE RIGHT-OF-WAY
- CONDUIT AND WIRING
- - - EX. CONDUIT AND WIRING
- △ WIRE NOTE
- ⑥ CONSTRUCTION NOTE
- ⊙ LIGHT STANDARD AND LUMINAIRE
- ⊙ EX. PSE LUMINAIRE AND POLE
- ⊠ TYPE 1 JUNCTION BOX
- ⊠ EX. TYPE 8 JUNCTION BOX
- ⊠ EX. SERVICE CABINET
- ⊠ EX. SIGN AND POST TO BE MAINTAINED

100% DESIGN

CITY OF Federal Way
Centered on Opportunity
33325 8th Avenue South
Federal Way, WA 98003-6325
(253) 835-2700
www.cityoffederalway.com

811
Know what's below.
Call 811 before you dig.

DRAFTED: D. MCINTOSH
DESIGNED: K. DAVIS, P.E.
REVIEWED: R. PEREZ, P.E.
APPROVED: R. PEREZ, P.E.



DRAWING VERSION / REVISION LOG		
NO.	DATE	REVISION

STREET LIGHT INFILL
ILLUMINATION SYSTEM - GROUP A
S 330 ST - PACIFIC HWY S TO 22 PL S

CITY PROJECT #: 26775
SHT. 20
OF 76

K:\ENGINEERING DIVISION\PROJECTS\ACTIVE\26775 - Streetlight Infill\03 PE\ACAD\330-18 PL.dwg 12/12/2023 2:26 PM

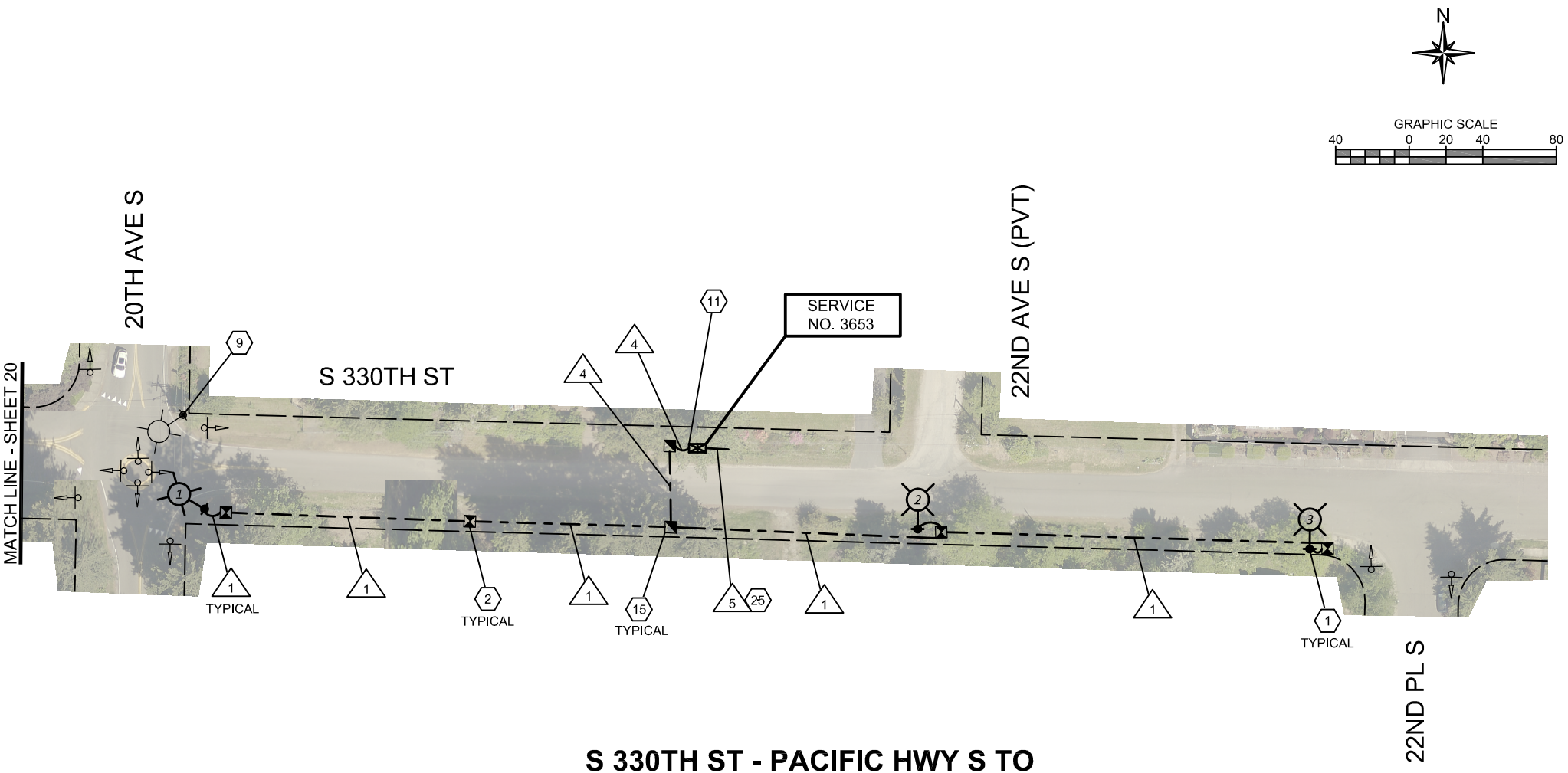

**S 330TH ST - PACIFIC HWY S TO
22ND PL S -- SHEET 2 OF 2**

LUMINAIRE SCHEDULE			SERVICE NO. 3653		
PLAN NUMBER	ID NUMBER	SERVICE - CIRCUIT	TYPE - WATTS	MASTARM	MTG HEIGHT
1	3653-1-SL1-1	22/330 - 1	II - 60	8 FT	30 FT
2	3653-1-SL2-2	22/330 - 2	II - 60	8 FT	30 FT
3	3653-1-SL2-3	22/330 - 2	II - 60	8 FT	30 FT

WIRING SCHEDULE			
△ X RUN NO.	CONDUIT	WIRE	COMMENTS
1	2" PVC	2-#8 (ILLUM)	SHALL BE ALUMINUM
5	PER PSE (2" MINIMUM)	PER PSE (3-#6 MINIMUM)	PER PSE
4	2" PVC	4-#8 (ILLUM)	SHALL BE ALUMINUM
	2" PVC	SPARE	WITH GROUND AND PULL TAPE

- CONSTRUCTION NOTES**
- ① INSTALL LIGHT STANDARD FOUNDATION, POLE, DAVIT ARM, AND LUMINAIRE IN APPROXIMATE LOCATION SHOWN (3 LOCATIONS THIS SHEET) AND IN ACCORDANCE WITH MANUFACTURER RECOMMENDATIONS, SPECIAL PROVISIONS, AND THE DETAILS ON SHEETS 60 AND 61.
 - ② INSTALL TYPE 1 JUNCTION BOX (REFER TO STANDARD PLAN J-40.10 AND THE DETAILS ON SHEETS 65 AND 66) AT APPROXIMATE LOCATION SHOWN (4 BOXES THIS SHEET). SEE NOTES.
 - ⑨ EXISTING PSE LUMINAIRE MOUNTED ON PSE POLE (1 LOCATION THIS SHEET).
 - ⑪ INSTALL FOUNDATION AND SERVICE CABINET IN APPROXIMATE LOCATION SHOWN (DOORS FACING S 330TH ST) AND IN ACCORDANCE WITH THE DETAILS ON SHEETS 67 AND 68.
 - ⑮ INSTALL TYPE 2 JUNCTION BOX (REFER TO STANDARD PLAN J-40.10 AND THE DETAILS ON SHEETS 65 AND 66) AT APPROXIMATE LOCATION SHOWN (2 BOXES THIS SHEET). SEE NOTES.
 - ⑳ COORDINATE WITH SERVING UTILITY FOR ELECTRICAL CONNECTION POINT. RUN SERVICE CONDUCTOR IN ACCORDANCE WITH POWER UTILITY AND CITY OF FEDERAL WAY PERMIT REQUIREMENTS. CONTRACTOR SHALL SUPPLY ANY CONDUIT AND FITTINGS, JUNCTION BOXES, AND HARDWARE REQUIRED BY THE SERVING UTILITY FOR SERVICE.

- GENERAL NOTES**
- MAINTAIN AND PROTECT EXISTING FEATURES (TREES/ SHRUBS/ VEGETATION, DITCHES, DRIVEWAYS, ETC.) WITHIN PROJECT SITE UNLESS OTHERWISE NOTED.
 - UTILITIES ARE NOT SHOWN. IT IS THE CONTRACTOR'S RESPONSIBILITY TO AVOID AND PROTECT EXISTING UTILITIES AND RESOLVE CONFLICTS.
 - ALL LIGHT STANDARDS AND JUNCTION BOXES SHALL BE INSTALLED WITHIN A CONCRETE PAD IN ACCORDANCE WITH THE DETAIL ON SHEET 63.
 - ALL JUNCTION BOXES SHALL INCLUDE THE SYSTEM IDENTIFICATION LETTERS "LT".
 - LIGHT STANDARDS SHALL BE PLACED SUCH THAT THERE IS A MINIMUM OF 6 FT FROM CENTER OF STANDARD TO EDGE LINE OR FACE OF CURB. THE CONTRACTOR SHALL NOT PLACE LIGHT STANDARDS IN FORMAL OR INFORMAL WALKING PATHS. THE CONTRACTOR SHALL NOT IMPEDE SIGHT DISTANCE, SIGN VISIBILITY, OR USPS ACCESS WITH LIGHT STANDARD PLACEMENT.
 - THE LOCATIONS SHOWN OF POLES, JUNCTION BOXES, AND SERVICE CABINETS ARE APPROXIMATE AND SHOWN OVERSIZE. FIELD ADJUSTMENT MAY BE NECESSARY. SEE NOTES. ALL CONSTRUCTION AND ACTIVITIES SHALL BE LOCATED WITHIN CITY OF FEDERAL WAY PROPERTY. RIGHT-OF-WAY LINES SHOWN ARE APPROXIMATE.

- LEGEND**
- APPROXIMATE RIGHT-OF-WAY
 - CONDUIT AND WIRING
 - △ WIRE NOTE
 - ⬡ CONSTRUCTION NOTE
 - ⊕ LIGHT STANDARD AND LUMINAIRE
 - ⊕ EX. PSE LUMINAIRE AND POLE
 - ⬡ TYPE 1 JUNCTION BOX
 - ⬡ TYPE 2 JUNCTION BOX
 - ⬡ SERVICE CABINET
 - ⊕ EX. SIGN AND POST TO BE MAINTAINED

- NOTES**
- JUNCTION BOXES FOR S 330TH ST ARE INTENDED TO HAVE SPACING OF APPROXIMATELY 190 FEET FOR INSTALLATION OF ADDITIONAL LIGHT STANDARDS IN THE FUTURE. THE CONTRACTOR SHALL BEAR THIS IN MIND WHEN PLACING THE JUNCTION BOXES AND ATTEMPT TO ADHERE TO THE SPACING AND PLAN LOCATIONS AS MUCH AS IS PRACTICABLE. THE CONTRACTING AGENCY UNDERSTANDS THAT FIELD CONDITIONS MAY PRECLUDE THIS. ANY JUNCTION BOX SPACING GREATER THAN 250 FEET WILL NEED TO BE COORDINATED AND APPROVED BY THE ENGINEER, PRIOR TO INSTALLATION. IF FEWER JUNCTION BOXES ARE INSTALLED THAN SHOWN IN THE PLANS, THOSE BOXES SHALL BE DELIVERED TO THE KING COUNTY SIGNAL SHOP AT THE CONTRACTOR'S EXPENSE.

100% DESIGN

DRAFTED: D. MCINTOSH
DESIGNED: K. DAVIS, P.E.
REVIEWED: R. PEREZ, P.E.
APPROVED: R. PEREZ, P.E.



DRAWING VERSION / REVISION LOG		
NO.	DATE	REVISION

STREET LIGHT INFILL

ILLUMINATION SYSTEM - GROUP A

S 330 ST - PACIFIC HWY S TO 22 PL S

CITY PROJECT #: 26775
SHT. 21
OF 76

K:\ENGINEERING DIVISION\PROJECTS\ACTV\26775 - Streetlight Infill\03 PE\ACAD\330-18 PL.dwg 12/12/2023 2:28 PM

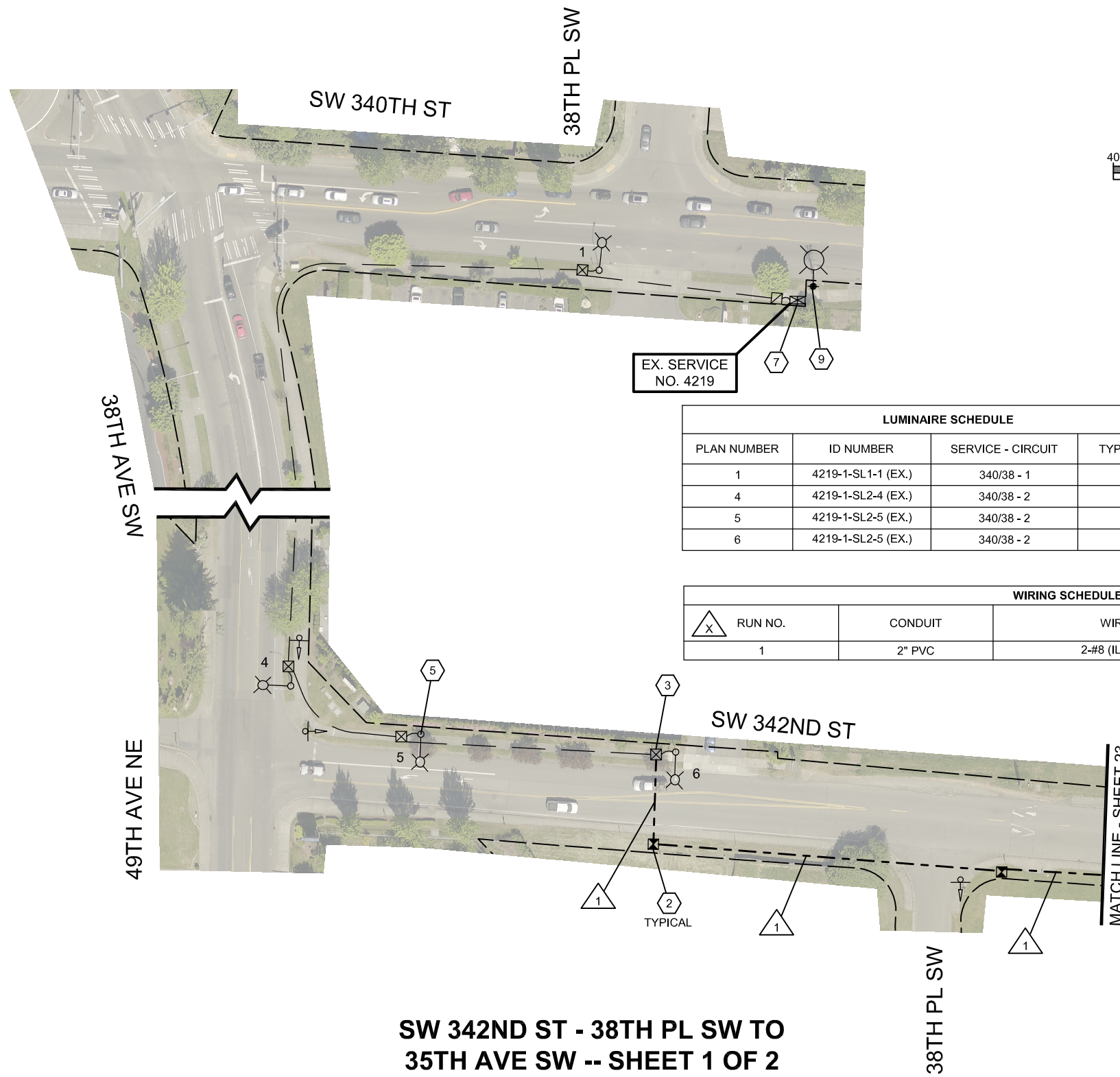

LUMINAIRE SCHEDULE			SERVICE NO. 4219		
PLAN NUMBER	ID NUMBER	SERVICE - CIRCUIT	TYPE - WATTS	MASTARM	MTG HEIGHT
1	4219-1-SL1-1 (EX.)	340/38 - 1	EX.	EX.	EX.
4	4219-1-SL2-4 (EX.)	340/38 - 2	EX.	EX.	EX.
5	4219-1-SL2-5 (EX.)	340/38 - 2	EX.	EX.	EX.
6	4219-1-SL2-5 (EX.)	340/38 - 2	EX.	EX.	EX.

WIRING SCHEDULE			
△ RUN NO.	CONDUIT	WIRE	COMMENTS
1	2" PVC	2-#8 (ILLUM)	SHALL BE ALUMINUM

CONSTRUCTION NOTES

- ② INSTALL TYPE 1 JUNCTION BOX (REFER TO STANDARD PLAN J-40.10 AND THE DETAILS ON SHEETS 65 AND 66) AT APPROXIMATE LOCATION SHOWN (2 BOXES THIS SHEET). SEE NOTES.
- ③ INSTALL CONDUIT INTO EXISTING JUNCTION BOX. SPLICE NEW CONDUCTORS TO EXISTING ILLUMINATION CONDUCTORS.
- ⑤ MAINTAIN AND PROTECT EXISTING ILLUMINATION SYSTEM.
- ⑦ EXISTING SERVICE CABINET TO BE USED FOR PROPOSED LIGHT STANDARDS FOR SW 342 ST - 38 AVE SW TO 35 AVE SW.
- ⑨ EXISTING PSE LUMINAIRE MOUNTED ON PSE POLE (1 LOCATION THIS SHEET).

GENERAL NOTES

- 1. MAINTAIN AND PROTECT EXISTING FEATURES (TREES/ SHRUBS/ VEGETATION, DITCHES, DRIVEWAYS, ETC.) WITHIN PROJECT SITE UNLESS OTHERWISE NOTED.
- 2. UTILITIES ARE NOT SHOWN. IT IS THE CONTRACTOR'S RESPONSIBILITY TO AVOID AND PROTECT EXISTING UTILITIES AND RESOLVE CONFLICTS.
- 3. ALL LIGHT STANDARDS AND JUNCTION BOXES SHALL BE INSTALLED WITHIN A CONCRETE PAD IN ACCORDANCE WITH THE DETAIL ON SHEET 63.
- 4. ALL JUNCTION BOXES SHALL INCLUDE THE SYSTEM IDENTIFICATION LETTERS "LT".
- 5. LIGHT STANDARDS SHALL BE PLACED SUCH THAT THERE IS A MINIMUM OF 6 FT FROM CENTER OF STANDARD TO EDGE LINE OR FACE OF CURB. THE CONTRACTOR SHALL NOT PLACE LIGHT STANDARDS IN FORMAL OR INFORMAL WALKING PATHS. THE CONTRACTOR SHALL NOT IMPEDE SIGHT DISTANCE, SIGN VISIBILITY, OR USPS ACCESS WITH LIGHT STANDARD PLACEMENT.
- 6. THE LOCATIONS SHOWN OF POLES, JUNCTION BOXES, AND SERVICE CABINETS ARE APPROXIMATE AND SHOWN OVERSIZE. FIELD ADJUSTMENT MAY BE NECESSARY. SEE NOTES. ALL CONSTRUCTION AND ACTIVITIES SHALL BE LOCATED WITHIN CITY OF FEDERAL WAY PROPERTY. RIGHT-OF-WAY LINES SHOWN ARE APPROXIMATE.

LEGEND

- APPROXIMATE RIGHT-OF-WAY
- CONDUIT AND WIRING
- - - EX. CONDUIT AND WIRING
- △ WIRE NOTE
- CONSTRUCTION NOTE
- ⊕ LIGHT STANDARD AND LUMINAIRE
- ⊕ EX. CITY-OWNED LIGHT STANDARD AND LUMINAIRE
- ⊕ EX. PSE LUMINAIRE AND POLE
- ⊠ TYPE 1 JUNCTION BOX
- ⊠ EX. TYPE 1 JUNCTION BOX
- ⊠ EX. TYPE 2 JUNCTION BOX
- ⊠ EX. SERVICE CABINET
- ⊕ EX. SIGN AND POST TO BE MAINTAINED

NOTES

- 1. JUNCTION BOXES FOR SW 342ND ST ARE INTENDED TO HAVE SPACING OF APPROXIMATELY 195 FEET FOR INSTALLATION OF ADDITIONAL LIGHT STANDARDS IN THE FUTURE. THE CONTRACTOR SHALL BEAR THIS IN MIND WHEN PLACING THE JUNCTION BOXES AND ATTEMPT TO ADHERE TO THE SPACING AND PLAN LOCATIONS AS MUCH AS IS PRACTICABLE. THE CONTRACTING AGENCY UNDERSTANDS THAT FIELD CONDITIONS MAY PRECLUDE THIS. ANY JUNCTION BOX SPACING GREATER THAN 250 FEET WILL NEED TO BE COORDINATED AND APPROVED BY THE ENGINEER, PRIOR TO INSTALLATION. IF FEWER JUNCTION BOXES ARE INSTALLED THAN SHOWN IN THE PLANS, THOSE BOXES SHALL BE DELIVERED TO THE KING COUNTY SIGNAL SHOP AT THE CONTRACTOR'S EXPENSE.

100% DESIGN

CITY OF Federal Way
Centered on Opportunity
33325 8th Avenue South
Federal Way, WA 98003-6325
(253) 835-2700
www.cityoffederalway.com

811
Know what's below.
Call 811 before you dig.

DRAFTED: D. MCINTOSH
DESIGNED: K. DAVIS, P.E.
REVIEWED: R. PEREZ, P.E.
APPROVED: R. PEREZ, P.E.



DRAWING VERSION / REVISION LOG		
NO.	DATE	REVISION

STREET LIGHT INFILL
ILLUMINATION SYSTEM - GROUP A
SW 342 ST - 38 AVE SW TO 35 AVE SW

CITY PROJECT #: 26775
SHT. 22
OF 76

K:\ENGINEERING DIVISION\PROJECTS\ACTIVE\26775 - Streetlight Infill\03 PE\ACAD\342-38.dwg 12/12/2023 2:30 PM

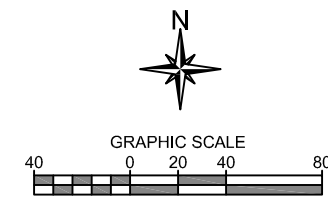

CONSTRUCTION NOTES

- ① INSTALL LIGHT STANDARD FOUNDATION, POLE, DAVIT ARM, AND LUMINAIRE IN APPROXIMATE LOCATION SHOWN (3 LOCATIONS THIS SHEET) AND IN ACCORDANCE WITH MANUFACTURER RECOMMENDATIONS, SPECIAL PROVISIONS, AND THE DETAILS ON SHEET 60 AND 61.
- ② INSTALL TYPE 1 JUNCTION BOX (REFER TO STANDARD PLAN J-40.10 AND THE DETAILS ON SHEETS 65 AND 66) AT APPROXIMATE LOCATION SHOWN (4 BOXES THIS SHEET). SEE NOTES.

GENERAL NOTES

1. MAINTAIN AND PROTECT EXISTING FEATURES (TREES/ SHRUBS/ VEGETATION, DITCHES, DRIVEWAYS, ETC.) WITHIN PROJECT SITE UNLESS OTHERWISE NOTED.
2. UTILITIES ARE NOT SHOWN. IT IS THE CONTRACTOR'S RESPONSIBILITY TO AVOID AND PROTECT EXISTING UTILITIES AND RESOLVE CONFLICTS.
3. ALL LIGHT STANDARDS AND JUNCTION BOXES SHALL BE INSTALLED WITHIN A CONCRETE PAD IN ACCORDANCE WITH THE DETAIL ON SHEET 63.
4. ALL JUNCTION BOXES SHALL INCLUDE THE SYSTEM IDENTIFICATION LETTERS "LT".
5. LIGHT STANDARDS SHALL BE PLACED SUCH THAT THERE IS A MINIMUM OF 6 FT FROM CENTER OF STANDARD TO EDGE LINE OR FACE OF CURB. THE CONTRACTOR SHALL NOT PLACE LIGHT STANDARDS IN FORMAL OR INFORMAL WALKING PATHS. THE CONTRACTOR SHALL NOT IMPEDE SIGHT DISTANCE, SIGN VISIBILITY, OR USPS ACCESS WITH LIGHT STANDARD PLACEMENT.
6. THE LOCATIONS SHOWN OF POLES, JUNCTION BOXES, AND SERVICE CABINETS ARE APPROXIMATE AND SHOWN OVERSIZE. FIELD ADJUSTMENT MAY BE NECESSARY. SEE NOTES. ALL CONSTRUCTION AND ACTIVITIES SHALL BE LOCATED WITHIN CITY OF FEDERAL WAY PROPERTY. RIGHT-OF-WAY LINES SHOWN ARE APPROXIMATE.

SW 342ND ST - 38TH PL SW TO 35TH AVE SW -- SHEET 2 OF 2

LUMINAIRE SCHEDULE			SERVICE NO. 4219		
PLAN NUMBER	ID NUMBER	SERVICE - CIRCUIT	TYPE - WATTS	MASTARM	MTG HEIGHT
7	4219-1-SL2-7	38/340 - 2	II - 50	8 FT	30 FT
8	4219-1-SL2-8	38/340 - 2	II - 50	8 FT	30 FT
9	4219-1-SL2-9	38/340 - 2	II - 50	8 FT	30 FT

WIRING SCHEDULE				
X	RUN NO.	CONDUIT	WIRE	COMMENTS
	1	2" PVC	2-#8 (ILLUM)	SHALL BE ALUMINUM

LEGEND

---	APPROXIMATE RIGHT-OF-WAY	⊠	TYPE 1 JUNCTION BOX
---	CONDUIT AND WIRING	⊕	EX. SIGN AND POST TO BE MAINTAINED
△	WIRE NOTE		
⬡	CONSTRUCTION NOTE		
⊕	LIGHT STANDARD AND LUMINAIRE		

NOTES

1. JUNCTION BOXES FOR SW 342ND ST ARE INTENDED TO HAVE SPACING OF APPROXIMATELY 195 FEET FOR INSTALLATION OF ADDITIONAL LIGHT STANDARDS IN THE FUTURE. THE CONTRACTOR SHALL BEAR THIS IN MIND WHEN PLACING THE JUNCTION BOXES AND ATTEMPT TO ADHERE TO THE SPACING AND PLAN LOCATIONS AS MUCH AS IS PRACTICABLE. THE CONTRACTING AGENCY UNDERSTANDS THAT FIELD CONDITIONS MAY PRECLUDE THIS. ANY JUNCTION BOX SPACING GREATER THAN 250 FEET WILL NEED TO BE COORDINATED AND APPROVED BY THE ENGINEER, PRIOR TO INSTALLATION. IF FEWER JUNCTION BOXES ARE INSTALLED THAN SHOWN IN THE PLANS, THOSE BOXES SHALL BE DELIVERED TO THE KING COUNTY SIGNAL SHOP AT THE CONTRACTOR'S EXPENSE.

100% DESIGN

DRAFTED: D. MCINTOSH
 DESIGNED: K. DAVIS, P.E.
 REVIEWED: R. PEREZ, P.E.
 APPROVED: R. PEREZ, P.E.



DRAWING VERSION / REVISION LOG		
NO.	DATE	REVISION

STREET LIGHT INFILL

ILLUMINATION SYSTEM - GROUP A

SW 342 ST - 38 AVE SE TO 35 AVE SW

CITY PROJECT #: 26775
 SHT. 23
 OF 76

K:\ENGINEERING DIVISION\PROJECTS\ACTIVE\26775 - Streetlight Infill\03 PE\ACAD\342-38.dwg 12/12/2023 2:30 PM

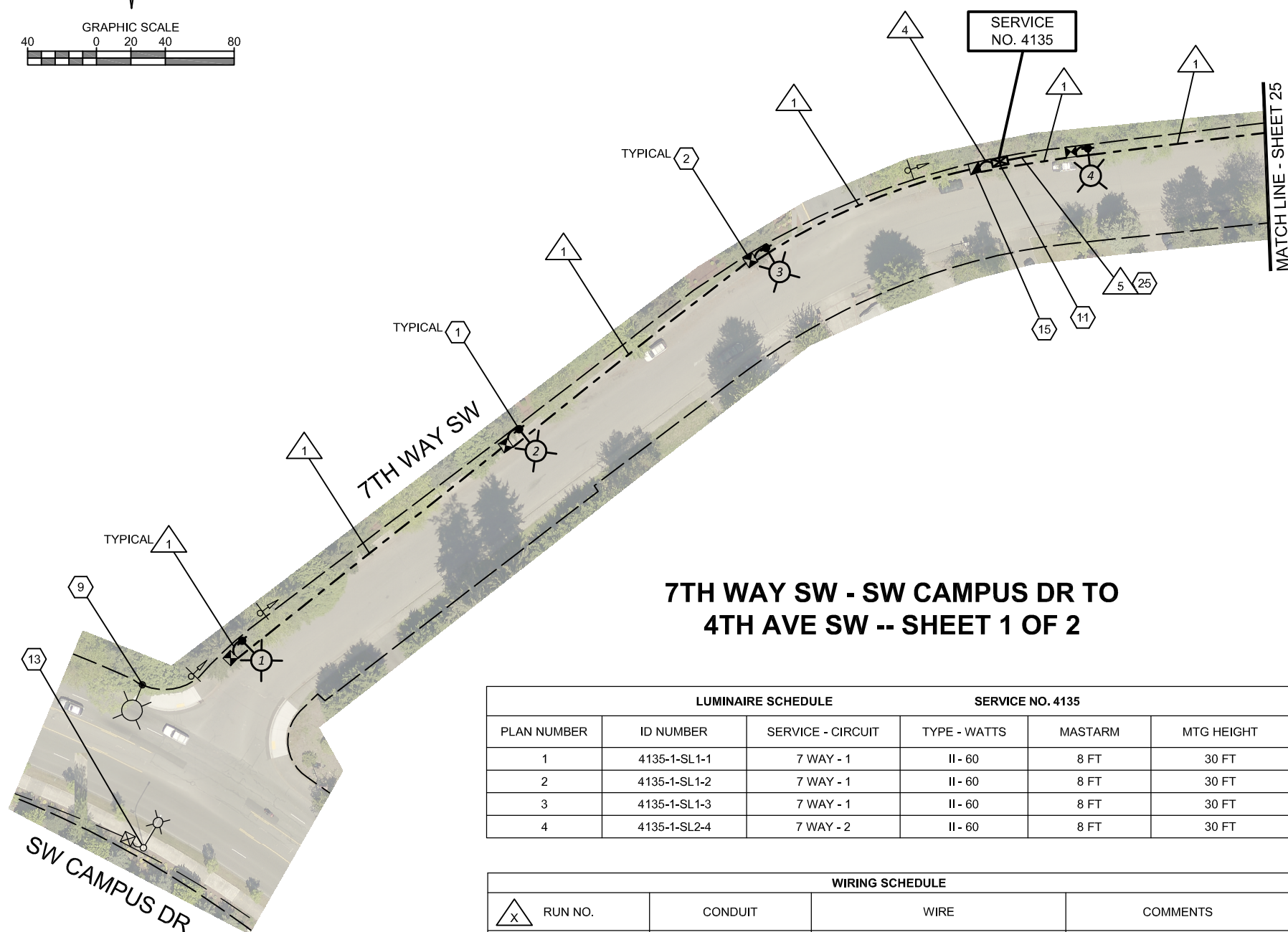
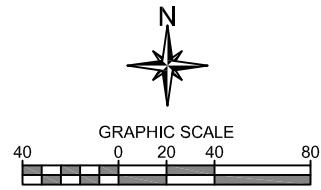

**7TH WAY SW - SW CAMPUS DR TO
4TH AVE SW -- SHEET 1 OF 2**

LUMINAIRE SCHEDULE			SERVICE NO. 4135		
PLAN NUMBER	ID NUMBER	SERVICE - CIRCUIT	TYPE - WATTS	MASTARM	MTG HEIGHT
1	4135-1-SL1-1	7 WAY - 1	II - 60	8 FT	30 FT
2	4135-1-SL1-2	7 WAY - 1	II - 60	8 FT	30 FT
3	4135-1-SL1-3	7 WAY - 1	II - 60	8 FT	30 FT
4	4135-1-SL2-4	7 WAY - 2	II - 60	8 FT	30 FT

WIRING SCHEDULE			
X RUN NO.	CONDUIT	WIRE	COMMENTS
1	2" PVC	2-#8 (ILLUM)	SHALL BE ALUMINUM
4	2" PVC	4-#8 (ILLUM)	SHALL BE ALUMINUM
	2" PVC	SPARE	WITH GROUND AND PULL TAPE
5	PER PSE (2" MINIMUM)	PER PSE (3-#6 MINIMUM)	PER PSE

CONSTRUCTION NOTES

- 1 INSTALL LIGHT STANDARD FOUNDATION, POLE, DAVIT ARM, AND LUMINAIRE IN APPROXIMATE LOCATION SHOWN (4 LOCATIONS THIS SHEET) AND IN ACCORDANCE WITH MANUFACTURER RECOMMENDATIONS, SPECIAL PROVISIONS, AND THE DETAILS ON SHEETS 60 AND 61.
- 2 INSTALL TYPE 1 JUNCTION BOX (REFER TO STANDARD PLAN J-40.10 AND THE DETAILS ON SHEETS 65 AND 66) AT APPROXIMATE LOCATION SHOWN (4 BOXES THIS SHEET). SEE NOTES.
- 9 EXISTING PSE LUMINAIRE MOUNTED ON PSE POLE (1 LOCATION THIS SHEET).
- 11 INSTALL FOUNDATION AND SERVICE CABINET IN APPROXIMATE LOCATION SHOWN (DOORS FACING 7TH WAY SW) AND IN ACCORDANCE WITH THE DETAILS ON SHEETS 67 AND 68.
- 13 EXISTING ILLUMINATION SYSTEM AT SW CAMPUS DR IS NOT A PART OF THE PROJECT. SHOWN FOR REFERENCE ONLY.
- 15 INSTALL TYPE 2 JUNCTION BOX (REFER TO STANDARD PLAN J-40.10 AND THE DETAILS ON SHEETS 65 AND 66) AT APPROXIMATE LOCATION SHOWN (1 BOX THIS SHEET). SEE NOTES.
- 25 COORDINATE WITH SERVING UTILITY FOR ELECTRICAL CONNECTION POINT. RUN SERVICE CONDUCTOR IN ACCORDANCE WITH POWER UTILITY AND CITY OF FEDERAL WAY PERMIT REQUIREMENTS. CONTRACTOR SHALL SUPPLY ANY CONDUIT AND FITTINGS, JUNCTION BOXES, AND HARDWARE REQUIRED BY THE SERVING UTILITY FOR SERVICE.

GENERAL NOTES

- 1. MAINTAIN AND PROTECT EXISTING FEATURES (TREES/ SHRUBS/ VEGETATION, DITCHES, DRIVEWAYS, ETC.) WITHIN PROJECT SITE UNLESS OTHERWISE NOTED.
- 2. UTILITIES ARE NOT SHOWN. IT IS THE CONTRACTOR'S RESPONSIBILITY TO AVOID AND PROTECT EXISTING UTILITIES AND RESOLVE CONFLICTS.
- 3. ALL LIGHT STANDARDS AND JUNCTION BOXES SHALL BE INSTALLED WITHIN A CONCRETE PAD IN ACCORDANCE WITH THE DETAIL ON SHEET 63.
- 4. ALL JUNCTION BOXES SHALL INCLUDE THE SYSTEM IDENTIFICATION LETTERS "LT".
- 5. LIGHT STANDARDS SHALL BE PLACED SUCH THAT THERE IS A MINIMUM OF 6 FT FROM CENTER OF STANDARD TO EDGE LINE OR FACE OF CURB. THE CONTRACTOR SHALL NOT PLACE LIGHT STANDARDS IN FORMAL OR INFORMAL WALKING PATHS. THE CONTRACTOR SHALL NOT IMPEDE SIGHT DISTANCE, SIGN VISIBILITY, OR USPS ACCESS WITH LIGHT STANDARD PLACEMENT.
- 6. THE LOCATIONS SHOWN OF POLES, JUNCTION BOXES, AND SERVICE CABINETS ARE APPROXIMATE AND SHOWN OVERSIZE. FIELD ADJUSTMENT MAY BE NECESSARY. SEE NOTES. ALL CONSTRUCTION AND ACTIVITIES SHALL BE LOCATED WITHIN CITY OF FEDERAL WAY PROPERTY. RIGHT-OF-WAY LINES SHOWN ARE APPROXIMATE.

LEGEND

- APPROXIMATE RIGHT-OF-WAY
- CONDUIT AND WIRING
- - - EX. CONDUIT AND WIRING
- △ WIRE NOTE
- CONSTRUCTION NOTE
- ⊕ LIGHT STANDARD AND LUMINAIRE
- ⊕ EX. CITY-OWNED LIGHT STANDARD AND LUMINAIRE
- ⊕ EX. PSE LUMINAIRE AND POLE
- ⊠ TYPE 1 JUNCTION BOX
- ⊠ TYPE 2 JUNCTION BOX
- ⊠ EX. TYPE 1 JUNCTION BOX
- ⊠ SERVICE CABINET
- ⊕ EX. SIGN AND POST TO BE MAINTAINED

NOTES

- 1. JUNCTION BOXES FOR 7TH WAY SW ARE INTENDED TO HAVE SPACING OF APPROXIMATELY 190 FEET FOR INSTALLATION OF ADDITIONAL LIGHT STANDARDS IN THE FUTURE. THE CONTRACTOR SHALL BEAR THIS IN MIND WHEN PLACING THE JUNCTION BOXES AND ATTEMPT TO ADHERE TO THE SPACING AND PLAN LOCATIONS AS MUCH AS IS PRACTICABLE. THE CONTRACTING AGENCY UNDERSTANDS THAT FIELD CONDITIONS MAY PRECLUDE THIS. ANY JUNCTION BOX SPACING GREATER THAN 250 FEET WILL NEED TO BE COORDINATED AND APPROVED BY THE ENGINEER, PRIOR TO INSTALLATION. IF FEWER JUNCTION BOXES ARE INSTALLED THAN SHOWN IN THE PLANS, THOSE BOXES SHALL BE DELIVERED TO THE KING COUNTY SIGNAL SHOP AT THE CONTRACTOR'S EXPENSE.

100% DESIGN

CITY OF Federal Way
Centered on Opportunity
33325 8th Avenue South
Federal Way, WA 98003-6325
(253) 835-2700
www.cityoffederalway.com

811
Know what's below.
Call 811 before you dig.

DRAFTED: D. MCINTOSH
DESIGNED: K. DAVIS, P.E.
REVIEWED: R. PEREZ, P.E.
APPROVED: R. PEREZ, P.E.



DRAWING VERSION / REVISION LOG		
NO.	DATE	REVISION

STREET LIGHT INFILL
ILLUMINATION SYSTEM - GROUP A
7 WAY SW - SW CAMPUS DR TO 4 AVE SW

CITY PROJECT #: 26775
SHT. 24
OF 76

LUMINAIRE SCHEDULE			SERVICE NO. 4135		
PLAN NUMBER	ID NUMBER	SERVICE - CIRCUIT	TYPE - WATTS	MASTARM	MTG HEIGHT
5	4135-1-SL2-5	7 WAY - 2	II - 60	8 FT	30 FT
6	4135-1-SL2-6	7 WAY - 2	II - 60	8 FT	30 FT
7	4135-1-SL2-7	7 WAY - 2	II - 60	8 FT	30 FT

WIRING SCHEDULE			
X RUN NO.	CONDUIT	WIRE	COMMENTS
1	2" PVC	2-#8 (ILLUM)	SHALL BE ALUMINUM

**7TH WAY SW - SW CAMPUS DR TO
4TH AVE SW -- SHEET 2 OF 2**

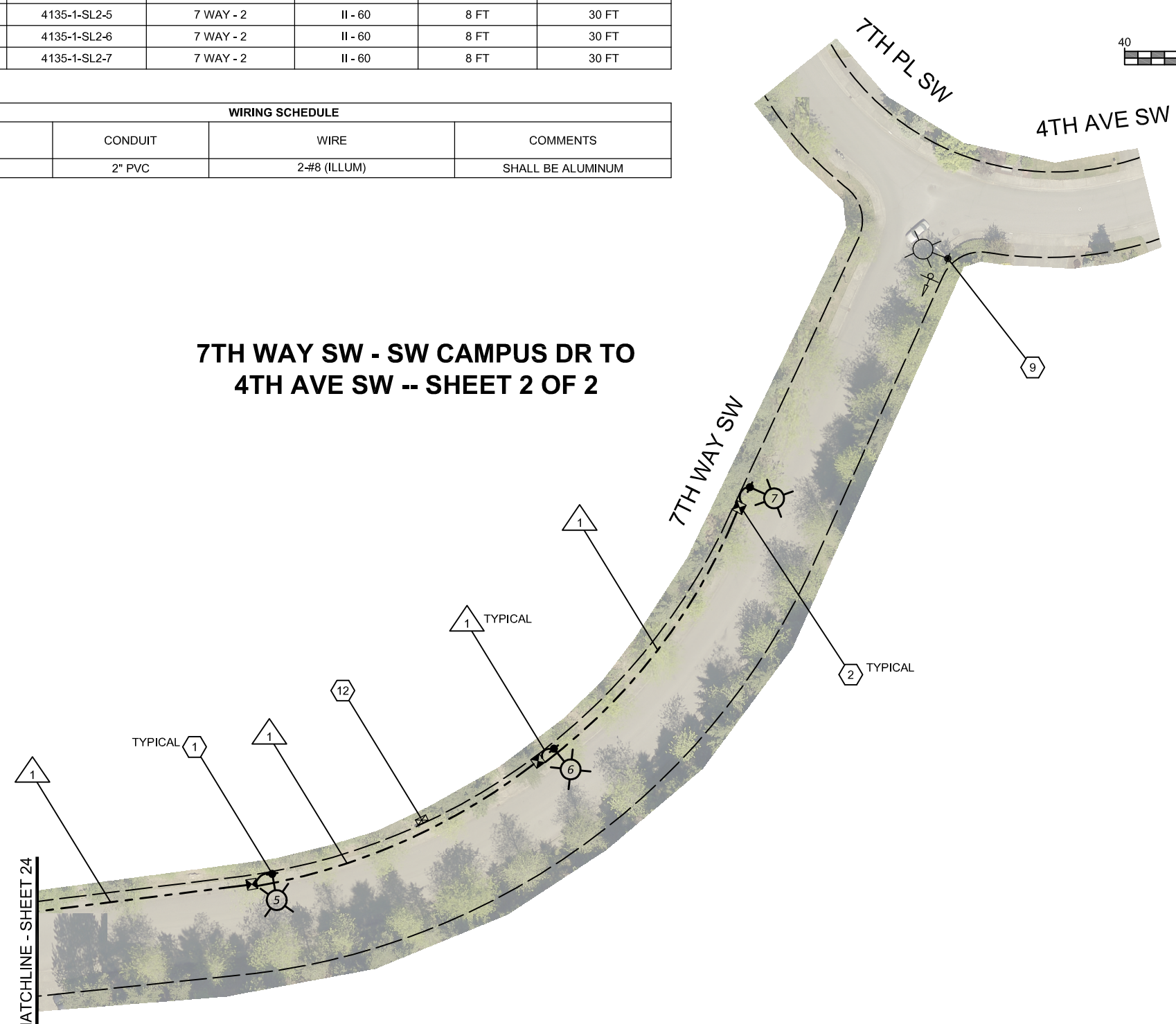

CONSTRUCTION NOTES

- 1 INSTALL LIGHT STANDARD FOUNDATION, POLE, DAVIT ARM, AND LUMINAIRE IN APPROXIMATE LOCATION SHOWN (3 LOCATIONS THIS SHEET) AND IN ACCORDANCE WITH MANUFACTURER RECOMMENDATIONS, SPECIAL PROVISIONS, AND THE DETAILS ON SHEETS 60 AND 61.
- 2 INSTALL TYPE 1 JUNCTION BOX (REFER TO STANDARD PLAN J-40.10 AND THE DETAILS ON SHEETS 65 AND 66) AT APPROXIMATE LOCATION SHOWN (3 BOXES THIS SHEET). SEE NOTES.
- 9 EXISTING PSE LUMINAIRE MOUNTED ON PSE POLE (1 LOCATION THIS SHEET).
- 12 EXISTING PRIVATE POWER METER.

GENERAL NOTES

- 1. MAINTAIN AND PROTECT EXISTING FEATURES (TREES/ SHRUBS/ VEGETATION, DITCHES, DRIVEWAYS, ETC.) WITHIN PROJECT SITE UNLESS OTHERWISE NOTED.
- 2. UTILITIES ARE NOT SHOWN. IT IS THE CONTRACTOR'S RESPONSIBILITY TO AVOID AND PROTECT EXISTING UTILITIES AND RESOLVE CONFLICTS.
- 3. ALL LIGHT STANDARDS AND JUNCTION BOXES SHALL BE INSTALLED WITHIN A CONCRETE PAD IN ACCORDANCE WITH THE DETAIL ON SHEET 63.
- 4. ALL JUNCTION BOXES SHALL INCLUDE THE SYSTEM IDENTIFICATION LETTERS "LT".
- 5. LIGHT STANDARDS SHALL BE PLACED SUCH THAT THERE IS A MINIMUM OF 6 FT FROM CENTER OF STANDARD TO EDGE LINE OR FACE OF CURB. THE CONTRACTOR SHALL NOT PLACE LIGHT STANDARDS IN FORMAL OR INFORMAL WALKING PATHS. THE CONTRACTOR SHALL NOT IMPEDE SIGHT DISTANCE, SIGN VISIBILITY, OR USPS ACCESS WITH LIGHT STANDARD PLACEMENT.
- 6. THE LOCATIONS SHOWN OF POLES, JUNCTION BOXES, AND SERVICE CABINETS ARE APPROXIMATE AND SHOWN OVERSIZE. FIELD ADJUSTMENT MAY BE NECESSARY. SEE NOTES. ALL CONSTRUCTION AND ACTIVITIES SHALL BE LOCATED WITHIN CITY OF FEDERAL WAY PROPERTY. RIGHT-OF-WAY LINES SHOWN ARE APPROXIMATE.

LEGEND

- APPROXIMATE RIGHT-OF-WAY
- CONDUIT AND WIRING
- △ WIRE NOTE
- CONSTRUCTION NOTE
- ⊕ LIGHT STANDARD AND LUMINAIRE
- ⊕ EX. PSE LUMINAIRE AND POLE
- ⊕ EX. METER BASE
- ⊕ TYPE 1 JUNCTION BOX
- ⊕ EX. SIGN AND POST TO BE MAINTAINED

NOTES

- 1. JUNCTION BOXES FOR 7TH WAY SW ARE INTENDED TO HAVE SPACING OF APPROXIMATELY 190 FEET FOR INSTALLATION OF ADDITIONAL LIGHT STANDARDS IN THE FUTURE. THE CONTRACTOR SHALL BEAR THIS IN MIND WHEN PLACING THE JUNCTION BOXES AND ATTEMPT TO ADHERE TO THE SPACING AND PLAN LOCATIONS AS MUCH AS IS PRACTICABLE. THE CONTRACTING AGENCY UNDERSTANDS THAT FIELD CONDITIONS MAY PRECLUDE THIS. ANY JUNCTION BOX SPACING GREATER THAN 250 FEET WILL NEED TO BE COORDINATED AND APPROVED BY THE ENGINEER, PRIOR TO INSTALLATION. IF FEWER JUNCTION BOXES ARE INSTALLED THAN SHOWN IN THE PLANS, THOSE BOXES SHALL BE DELIVERED TO THE KING COUNTY SIGNAL SHOP AT THE CONTRACTOR'S EXPENSE.

100% DESIGN

CITY OF Federal Way
Centered on Opportunity
33325 8th Avenue South
Federal Way, WA 98003-6325
(253) 835-2700
www.cityoffederalway.com

811
Know what's below.
Call 811 before you dig.

DRAFTED: D. MCINTOSH
DESIGNED: K. DAVIS, P.E.
REVIEWED: R. PEREZ, P.E.
APPROVED: R. PEREZ, P.E.



DRAWING VERSION / REVISION LOG		
NO.	DATE	REVISION

STREET LIGHT INFILL
ILLUMINATION SYSTEM - GROUP A
7 WAY SW - SW CAMPUS DR TO 4 AVE SW

CITY PROJECT #:	26775
SHT.	25
OF	76

K:\ENGINEERING DIVISION\PROJECTS\ACTIVE\26775 - Streetlight Infill\03 FEVACAD\7-CAMPUS.dwg 12/12/2023 2:33 PM

PACIFIC HWY S

S 373RD ST

CULVERT

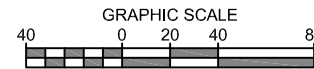

END OF GUARDRAIL

MATCH LINE - THIS SHEET

S 373RD ST

MATCH LINE - THIS SHEET

MATCH LINE - SHEET 27

CONSTRUCTION NOTES

- ① INSTALL LIGHT STANDARD FOUNDATION, POLE, DAVIT ARM, AND LUMINAIRE IN APPROXIMATE LOCATION SHOWN (2 LOCATIONS THIS SHEET) AND IN ACCORDANCE WITH MANUFACTURER RECOMMENDATIONS, SPECIAL PROVISIONS, AND THE DETAILS ON SHEETS 60 AND 61 .
- ② INSTALL TYPE 1 JUNCTION BOX (REFER TO STANDARD PLAN J-40.10 AND THE DETAILS ON SHEETS 65 AND 66) AT APPROXIMATE LOCATION SHOWN (5 BOXES THIS SHEET). SEE NOTES.
- ②④ INSTALL WIRELESS GATEWAY ON LIGHT STANDARD FOR LIGHTING CONTROL COMMUNICATIONS.

GENERAL NOTES

- 1. MAINTAIN AND PROTECT EXISTING FEATURES (TREES/ SHRUBS/ VEGETATION, DITCHES, DRIVEWAYS, ETC.) WITHIN PROJECT SITE UNLESS OTHERWISE NOTED.
- 2. UTILITIES ARE NOT SHOWN. IT IS THE CONTRACTOR'S RESPONSIBILITY TO AVOID AND PROTECT EXISTING UTILITIES AND RESOLVE CONFLICTS.
- 3. ALL LIGHT STANDARDS AND JUNCTION BOXES SHALL BE INSTALLED WITHIN A CONCRETE PAD IN ACCORDANCE WITH THE DETAIL ON SHEET 63.
- 4. ALL JUNCTION BOXES SHALL INCLUDE THE SYSTEM IDENTIFICATION LETTERS "LT".
- 5. LIGHT STANDARDS SHALL BE PLACED SUCH THAT THERE IS A MINIMUM OF 6 FT FROM CENTER OF STANDARD TO EDGE LINE OR FACE OF CURB. THE CONTRACTOR SHALL NOT PLACE LIGHT STANDARDS IN FORMAL OR INFORMAL WALKING PATHS. THE CONTRACTOR SHALL NOT IMPEDE SIGHT DISTANCE, SIGN VISIBILITY, OR USPS ACCESS WITH LIGHT STANDARD PLACEMENT.
- 6. THE LOCATIONS SHOWN OF POLES, JUNCTION BOXES, AND SERVICE CABINETS ARE APPROXIMATE AND SHOWN OVERSIZE. FIELD ADJUSTMENT MAY BE NECESSARY. ALL CONSTRUCTION AND ACTIVITIES SHALL BE LOCATED WITHIN CITY OF FEDERAL WAY PROPERTY. RIGHT-OF-WAY LINES SHOWN ARE APPROXIMATE.

S 373RD ST - EAST OF PACIFIC HWY S TO S 364TH WAY -- SHEET 1 OF 5

LUMINAIRE SCHEDULE			SERVICE NO. 6247		
PLAN NUMBER	ID NUMBER	SERVICE - CIRCUIT	TYPE - WATTS	MASTARM	MTG HEIGHT
1	6247-1-SL2-1	10/372 - 2	II - 60	12 FT	35 FT
2	6247-1-SL2-2	10/372 - 2	II - 60	12 FT	35 FT

WIRING SCHEDULE			
△ X RUN NO.	CONDUIT	WIRE	COMMENTS
1	2" PVC	2-#8 (ILLUM)	SHALL BE ALUMINUM

LEGEND

---	APPROXIMATE RIGHT-OF-WAY	⊠	TYPE 1 JUNCTION BOX
---	CONDUIT AND WIRING	⊕	EX. SIGN AND POST TO BE MAINTAINED
---	EX. CONDUIT AND WIRING	△	WIRE NOTE
○	CONSTRUCTION NOTE	⊙	LIGHT STANDARD AND LUMINAIRE

NOTES

- 1. JUNCTION BOXES FOR S 373RD ST ARE INTENDED TO HAVE SPACING OF APPROXIMATELY 175 FEET FOR INSTALLATION OF ADDITIONAL LIGHT STANDARDS IN THE FUTURE. THE CONTRACTOR SHALL BEAR THIS IN MIND WHEN PLACING THE JUNCTION BOXES AND ATTEMPT TO ADHERE TO THE SPACING AND PLAN LOCATIONS AS MUCH AS IS PRACTICABLE. THE CONTRACTING AGENCY UNDERSTANDS THAT FIELD CONDITIONS MAY PRECLUDE THIS. ANY JUNCTION BOX SPACING GREATER THAN 250 FEET WILL NEED TO BE COORDINATED AND APPROVED BY THE ENGINEER, PRIOR TO INSTALLATION. IF FEWER JUNCTION BOXES ARE INSTALLED THAN SHOWN IN THE PLANS, THOSE BOXES SHALL BE DELIVERED TO THE KING COUNTY SIGNAL SHOP AT THE CONTRACTOR'S EXPENSE.

100% DESIGN

CITY OF Federal Way
Centered on Opportunity

33325 8th Avenue South
Federal Way, WA 98003-6325

(253) 835-2700
www.cityoffederalway.com

811
Know what's below.
Call 811 before you dig.

DRAFTED: D. MCINTOSH
DESIGNED: K. DAVIS, P.E.
REVIEWED: R. PEREZ, P.E.
APPROVED: R. PEREZ, P.E.



DRAWING VERSION / REVISION LOG		
NO.	DATE	REVISION

STREET LIGHT INFILL

ILLUMINATION SYSTEM - GROUP A

S 373 ST - EAST OF PACIFIC HWY S TO S 364 WAY

CITY PROJECT #:
26775

SHT. **26**
OF **76**

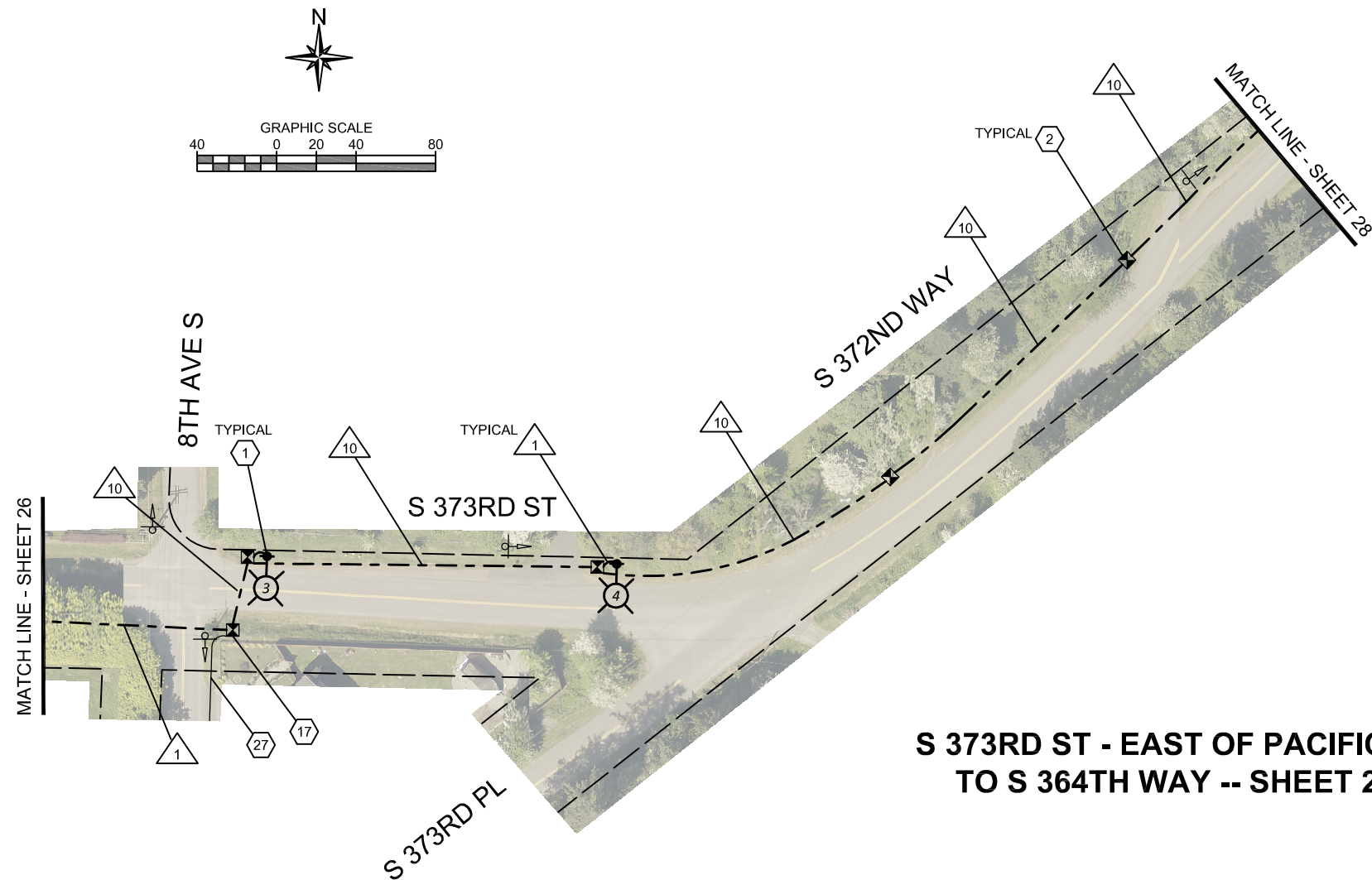

**S 373RD ST - EAST OF PACIFIC HWY S
TO S 364TH WAY -- SHEET 2 OF 5**

CONSTRUCTION NOTES

- ① INSTALL LIGHT STANDARD FOUNDATION, POLE, DAVIT ARM, AND LUMINAIRE IN APPROXIMATE LOCATION SHOWN (2 LOCATIONS THIS SHEET) AND IN ACCORDANCE WITH MANUFACTURER RECOMMENDATIONS, SPECIAL PROVISIONS, AND THE DETAILS ON SHEETS 60 AND 61.
- ② INSTALL TYPE 1 JUNCTION BOX (REFER TO STANDARD PLAN J-40.10 AND THE DETAILS ON SHEETS 65 AND 66) AT APPROXIMATE LOCATION SHOWN (5 BOXES THIS SHEET). SEE NOTES.
- ①⑦ COIL 20 FEET OF 2-#8 FOR FUTURE CONNECTION AS A PART OF GROUP B.
- ②⑦ FUTURE CONDUIT AND CONDUCTOR AS A PART OF GROUP B.

GENERAL NOTES

- 1. MAINTAIN AND PROTECT EXISTING FEATURES (TREES/ SHRUBS/ VEGETATION, DITCHES, DRIVEWAYS, ETC.) WITHIN PROJECT SITE UNLESS OTHERWISE NOTED.
- 2. UTILITIES ARE NOT SHOWN. IT IS THE CONTRACTOR'S RESPONSIBILITY TO AVOID AND PROTECT EXISTING UTILITIES AND RESOLVE CONFLICTS.
- 3. ALL LIGHT STANDARDS AND JUNCTION BOXES SHALL BE INSTALLED WITHIN A CONCRETE PAD IN ACCORDANCE WITH THE DETAIL ON SHEET 63.
- 4. ALL JUNCTION BOXES SHALL INCLUDE THE SYSTEM IDENTIFICATION LETTERS "LT".
- 5. LIGHT STANDARDS SHALL BE PLACED SUCH THAT THERE IS A MINIMUM OF 6 FT FROM CENTER OF STANDARD TO EDGE LINE OR FACE OF CURB. THE CONTRACTOR SHALL NOT PLACE LIGHT STANDARDS IN FORMAL OR INFORMAL WALKING PATHS. THE CONTRACTOR SHALL NOT IMPEDE SIGHT DISTANCE, SIGN VISIBILITY, OR USPS ACCESS WITH LIGHT STANDARD PLACEMENT.
- 6. THE LOCATIONS SHOWN OF POLES, JUNCTION BOXES, AND SERVICE CABINETS ARE APPROXIMATE AND SHOWN OVERSIZE. FIELD ADJUSTMENT MAY BE NECESSARY. SEE NOTES. ALL CONSTRUCTION AND ACTIVITIES SHALL BE LOCATED WITHIN CITY OF FEDERAL WAY PROPERTY. RIGHT-OF-WAY LINES SHOWN ARE APPROXIMATE.

LUMINAIRE SCHEDULE			SERVICE NO. 6247		
PLAN NUMBER	ID NUMBER	SERVICE - CIRCUIT	TYPE - WATTS	MASTARM	MTG HEIGHT
3	6247-1-SL2-3	10/372 - 2	II - 60	12 FT	35 FT
4	6247-1-SL2-4	10/372 - 2	II - 60	12 FT	35 FT

WIRING SCHEDULE				
△ X RUN NO.	CONDUIT	WIRE	COMMENTS	
1	2" PVC	2-#8 (ILLUM)	SHALL BE ALUMINUM	
10	2" PVC	4-#8 (ILLUM)	SHALL BE ALUMINUM	

NOTES

- 1. JUNCTION BOXES FOR S 373RD ST AND S 372ND WAY ARE INTENDED TO HAVE SPACING OF APPROXIMATELY 175 FEET FOR INSTALLATION OF ADDITIONAL LIGHT STANDARDS IN THE FUTURE. THE CONTRACTOR SHALL BEAR THIS IN MIND WHEN PLACING THE JUNCTION BOXES AND ATTEMPT TO ADHERE TO THE SPACING AND PLAN LOCATIONS AS MUCH AS IS PRACTICABLE. THE CONTRACTING AGENCY UNDERSTANDS THAT FIELD CONDITIONS MAY PRECLUDE THIS. ANY JUNCTION BOX SPACING GREATER THAN 250 FEET WILL NEED TO BE COORDINATED AND APPROVED BY THE ENGINEER, PRIOR TO INSTALLATION. IF FEWER JUNCTION BOXES ARE INSTALLED THAN SHOWN IN THE PLANS, THOSE BOXES SHALL BE DELIVERED TO THE KING COUNTY SIGNAL SHOP AT THE CONTRACTOR'S EXPENSE.

LEGEND

- APPROXIMATE RIGHT-OF-WAY
- CONDUIT AND WIRING
- - - EX. CONDUIT AND WIRING
- FUTURE CONDUIT (GROUP B)
- △ WIRE NOTE
- ① CONSTRUCTION NOTE
- ⊕ LIGHT STANDARD AND LUMINAIRE
- ⊠ TYPE 1 JUNCTION BOX
- ⊕ EX. SIGN AND POST TO BE MAINTAINED

100% DESIGN

33325 8th Avenue South
Federal Way, WA 98003-6325

(253) 835-2700
www.cityoffederalway.com

DRAFTED: D. MCINTOSH
DESIGNED: K. DAVIS, P.E.
REVIEWED: R. PEREZ, P.E.
APPROVED: R. PEREZ, P.E.

DRAWING VERSION / REVISION LOG		
NO.	DATE	REVISION

STREET LIGHT INFILL

ILLUMINATION SYSTEM - GROUP A

S 373 ST - EAST OF PACIFIC HWY S TO S 364 WAY

CITY PROJECT #: 26775
SHT. 27
OF 76

K:\ENGINEERING DIVISION\PROJECTS\ACTIVE\26775 - Streetlight Infill\03 PE\ACAD\0373-04.dwg 12/12/2023 2:36 PM

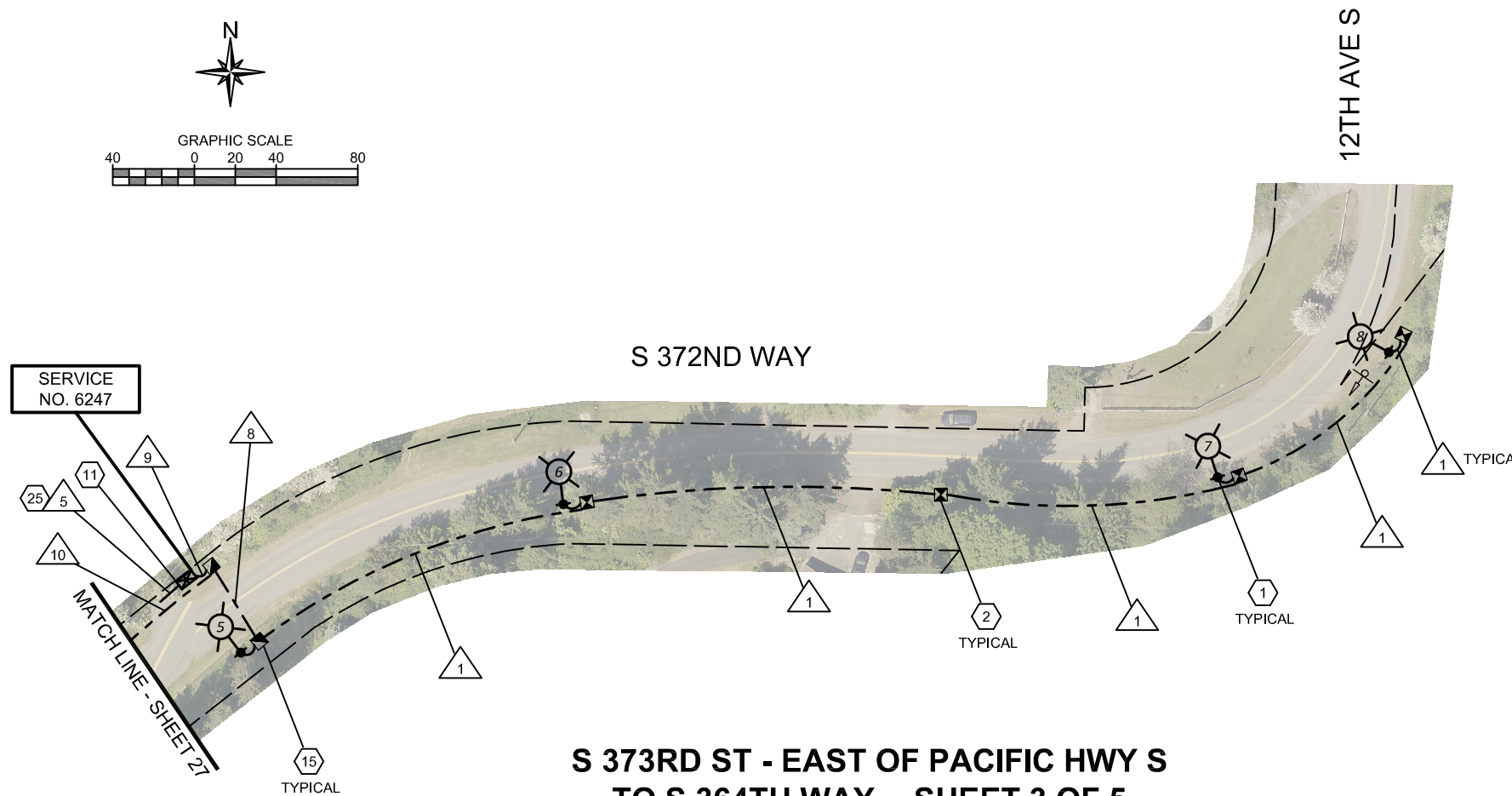
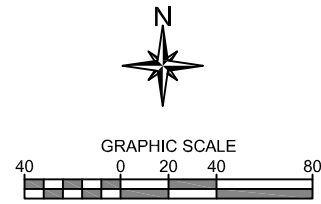

**S 373RD ST - EAST OF PACIFIC HWY S
TO S 364TH WAY -- SHEET 3 OF 5**

LUMINAIRE SCHEDULE			SERVICE NO. 6247		
PLAN NUMBER	ID NUMBER	SERVICE - CIRCUIT	TYPE - WATTS	MASTARM	MTG HEIGHT
5	6247-1-SL1-5	10/372 - 1	II - 60	12 FT	35 FT
6	6247-1-SL1-6	10/372 - 1	II - 60	12 FT	35 FT
7	6247-1-SL1-7	10/372 - 1	II - 60	12 FT	35 FT
8	6247-1-SL1-8	10/372 - 1	II - 60	12 FT	35 FT

WIRING SCHEDULE				
△ X RUN NO.	CONDUIT	WIRE	COMMENTS	
1	2" PVC	2-#8 (ILLUM)	SHALL BE ALUMINUM	
5	PER PSE (2" MINIMUM)	PER PSE (3-#6 MINIMUM)	PER PSE	
8	2" PVC	2-#8 (ILLUM)	SHALL BE ALUMINUM	
	2" PVC	SPARE	WITH GROUND AND PULL TAPE	
9	2" PVC	6-#8 (ILLUM)	SHALL BE ALUMINUM	
	2" PVC	SPARE	WITH GROUND AND PULL TAPE	
10	2" PVC	4-#8 (ILLUM)	SHALL BE ALUMINUM	

NOTES

- JUNCTION BOXES FOR S 372ND WAY AND 12TH AVE S ARE INTENDED TO HAVE SPACING OF APPROXIMATELY 175 FEET FOR INSTALLATION OF ADDITIONAL LIGHT STANDARDS IN THE FUTURE. THE CONTRACTOR SHALL BEAR THIS IN MIND WHEN PLACING THE JUNCTION BOXES AND ATTEMPT TO ADHERE TO THE SPACING AND PLAN LOCATIONS AS MUCH AS IS PRACTICABLE. THE CONTRACTING AGENCY UNDERSTANDS THAT FIELD CONDITIONS MAY PRECLUDE THIS. ANY JUNCTION BOX SPACING GREATER THAN 250 FEET WILL NEED TO BE COORDINATED AND APPROVED BY THE ENGINEER, PRIOR TO INSTALLATION. IF FEWER JUNCTION BOXES ARE INSTALLED THAN SHOWN IN THE PLANS, THOSE BOXES SHALL BE DELIVERED TO THE KING COUNTY SIGNAL SHOP AT THE CONTRACTOR'S EXPENSE.

CONSTRUCTION NOTES

- INSTALL LIGHT STANDARD FOUNDATION, POLE, DAVIT ARM, AND LUMINAIRE IN APPROXIMATE LOCATION SHOWN (4 LOCATIONS THIS SHEET) AND IN ACCORDANCE WITH MANUFACTURER RECOMMENDATIONS, SPECIAL PROVISIONS, AND THE DETAILS ON SHEETS 60 AND 61.
- INSTALL TYPE 1 JUNCTION BOX (REFER TO STANDARD PLAN J-40.10 AND THE DETAILS ON SHEETS 65 AND 66) AT APPROXIMATE LOCATION SHOWN (4 BOXES THIS SHEET). SEE NOTES.
- INSTALL FOUNDATION AND SERVICE CABINET IN APPROXIMATE LOCATION SHOWN (DOORS FACING S 372ND WAY) AND IN ACCORDANCE WITH THE DETAILS ON SHEETS 67 AND 68.
- INSTALL TYPE 2 JUNCTION BOX (REFER TO STANDARD PLAN J-40.10 AND THE DETAILS ON SHEETS 65 AND 66) AT APPROXIMATE LOCATION SHOWN (2 BOXES THIS SHEET). SEE NOTES.
- COORDINATE WITH SERVING UTILITY FOR ELECTRICAL CONNECTION POINT. RUN SERVICE CONDUCTOR IN ACCORDANCE WITH POWER UTILITY AND CITY OF FEDERAL WAY PERMIT REQUIREMENTS. CONTRACTOR SHALL SUPPLY ANY CONDUIT AND FITTINGS, JUNCTION BOXES, AND HARDWARE REQUIRED BY THE SERVING UTILITY FOR SERVICE.

GENERAL NOTES

- MAINTAIN AND PROTECT EXISTING FEATURES (TREES/ SHRUBS/ VEGETATION, DITCHES, DRIVEWAYS, ETC.) WITHIN PROJECT SITE UNLESS OTHERWISE NOTED.
- UTILITIES ARE NOT SHOWN. IT IS THE CONTRACTOR'S RESPONSIBILITY TO AVOID AND PROTECT EXISTING UTILITIES AND RESOLVE CONFLICTS.
- ALL LIGHT STANDARDS AND JUNCTION BOXES SHALL BE INSTALLED WITHIN A CONCRETE PAD IN ACCORDANCE WITH THE DETAIL ON SHEET 63.
- ALL JUNCTION BOXES SHALL INCLUDE THE SYSTEM IDENTIFICATION LETTERS "LT".
- LIGHT STANDARDS SHALL BE PLACED SUCH THAT THERE IS A MINIMUM OF 6 FT FROM CENTER OF STANDARD TO EDGE LINE OR FACE OF CURB. THE CONTRACTOR SHALL NOT PLACE LIGHT STANDARDS IN FORMAL OR INFORMAL WALKING PATHS. THE CONTRACTOR SHALL NOT IMPEDE SIGHT DISTANCE, SIGN VISIBILITY, OR USPS ACCESS WITH LIGHT STANDARD PLACEMENT.
- THE LOCATIONS SHOWN OF POLES, JUNCTION BOXES, AND SERVICE CABINETS ARE APPROXIMATE AND SHOWN OVERSIZE. FIELD ADJUSTMENT MAY BE NECESSARY. SEE NOTES. ALL CONSTRUCTION AND ACTIVITIES SHALL BE LOCATED WITHIN CITY OF FEDERAL WAY PROPERTY. RIGHT-OF-WAY LINES SHOWN ARE APPROXIMATE.

LEGEND

- APPROXIMATE RIGHT-OF-WAY
- CONDUIT AND WIRING
- △ WIRE NOTE
- CONSTRUCTION NOTE
- ⊕ LIGHT STANDARD AND LUMINAIRE
- ⊠ TYPE 1 JUNCTION BOX
- ⊠ TYPE 2 JUNCTION BOX
- ⊕ EX. SIGN AND POST TO BE MAINTAINED

100% DESIGN



DRAFTED: D. MCINTOSH
DESIGNED: K. DAVIS, P.E.
REVIEWED: R. PEREZ, P.E.
APPROVED: R. PEREZ, P.E.



DRAWING VERSION / REVISION LOG		
NO.	DATE	REVISION

STREET LIGHT INFILL
ILLUMINATION SYSTEM - GROUP A
S 373 ST - EAST OF PACIFIC HWY S TO S 364 WAY

CITY PROJECT #:
26775
SHT. **28**
OF **76**

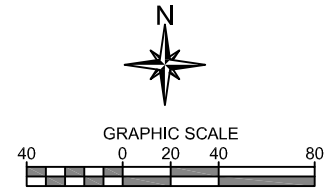

CONSTRUCTION NOTES

- ① INSTALL LIGHT STANDARD FOUNDATION, POLE, DAVIT ARM, AND LUMINAIRE IN APPROXIMATE LOCATION SHOWN (3 LOCATIONS THIS SHEET) AND IN ACCORDANCE WITH MANUFACTURER RECOMMENDATIONS, SPECIAL PROVISIONS, AND THE DETAILS ON SHEETS 60 AND 61.
- ② INSTALL TYPE 1 JUNCTION BOX (REFER TO STANDARD PLAN J-40.10 AND THE DETAILS ON SHEETS 65 AND 66) AT APPROXIMATE LOCATION SHOWN (6 BOXES THIS SHEET). SEE NOTES.
- ③ INSTALL CONDUIT INTO EXISTING JUNCTION BOX. SPLICE NEW CONDUCTORS TO EXISTING ILLUMINATION CONDUCTORS.
- ⑤ MAINTAIN AND PROTECT EXISTING ILLUMINATION SYSTEM.

GENERAL NOTES

- 1. MAINTAIN AND PROTECT EXISTING FEATURES (TREES/ SHRUBS/ VEGETATION, DITCHES, DRIVEWAYS, ETC.) WITHIN PROJECT SITE UNLESS OTHERWISE NOTED.
- 2. UTILITIES ARE NOT SHOWN. IT IS THE CONTRACTOR'S RESPONSIBILITY TO AVOID AND PROTECT EXISTING UTILITIES AND RESOLVE CONFLICTS.
- 3. ALL LIGHT STANDARDS AND JUNCTION BOXES SHALL BE INSTALLED WITHIN A CONCRETE PAD IN ACCORDANCE WITH THE DETAIL ON SHEET 63.
- 4. ALL JUNCTION BOXES SHALL INCLUDE THE SYSTEM IDENTIFICATION LETTERS "LT".
- 5. LIGHT STANDARDS SHALL BE PLACED SUCH THAT THERE IS A MINIMUM OF 6 FT FROM CENTER OF STANDARD TO EDGE LINE OR FACE OF CURB. THE CONTRACTOR SHALL NOT PLACE LIGHT STANDARDS IN FORMAL OR INFORMAL WALKING PATHS. THE CONTRACTOR SHALL NOT IMPEDE SIGHT DISTANCE, SIGN VISIBILITY, OR USPS ACCESS WITH LIGHT STANDARD PLACEMENT.
- 6. THE LOCATIONS SHOWN OF POLES, JUNCTION BOXES, AND SERVICE CABINETS ARE APPROXIMATE AND SHOWN OVERSIZE. FIELD ADJUSTMENT MAY BE NECESSARY. SEE NOTES. ALL CONSTRUCTION AND ACTIVITIES SHALL BE LOCATED WITHIN CITY OF FEDERAL WAY PROPERTY. RIGHT-OF-WAY LINES SHOWN ARE APPROXIMATE.

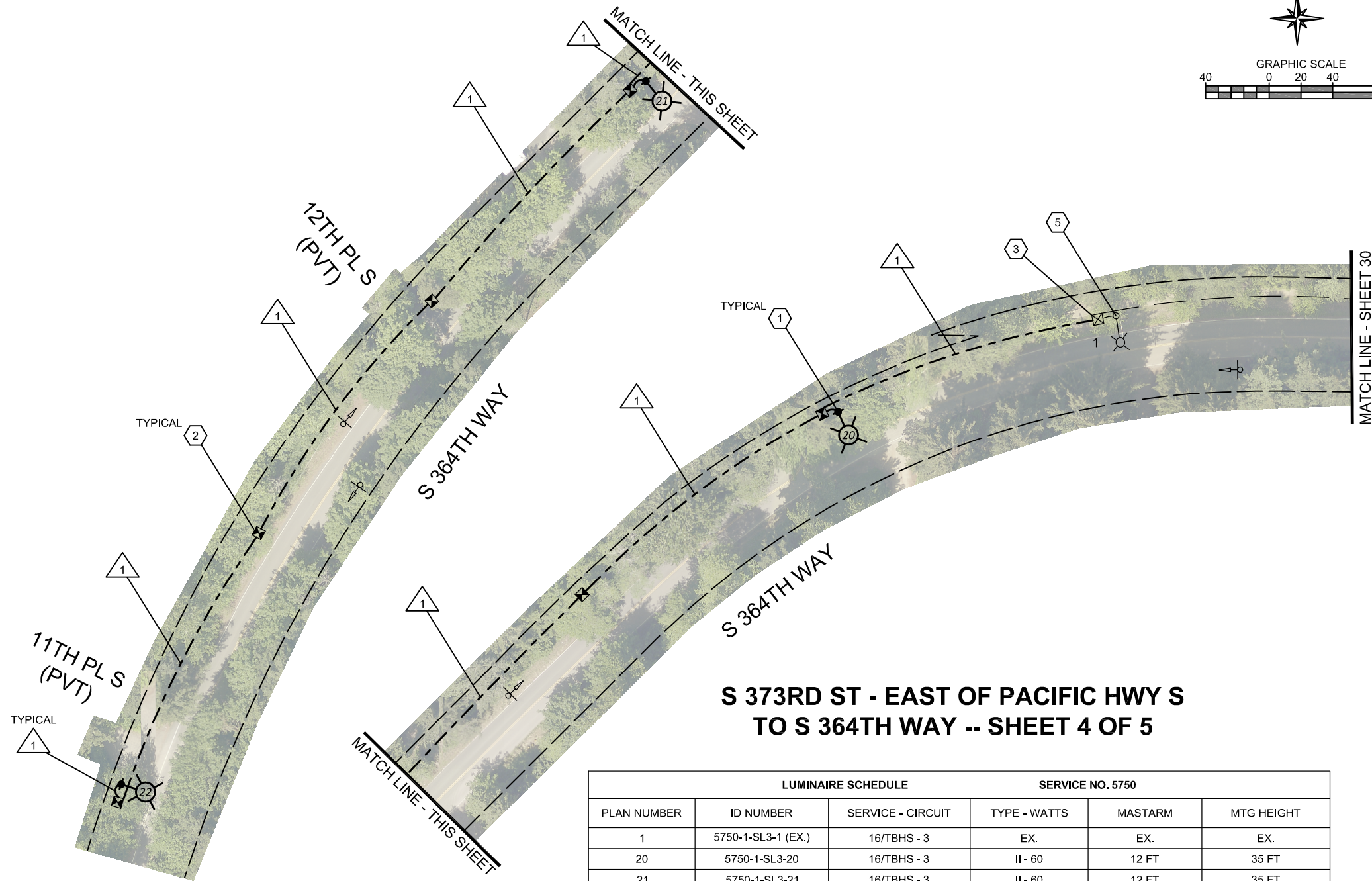

S 373RD ST - EAST OF PACIFIC HWY S TO S 364TH WAY -- SHEET 4 OF 5

LUMINAIRE SCHEDULE		SERVICE NO. 5750			
PLAN NUMBER	ID NUMBER	SERVICE - CIRCUIT	TYPE - WATTS	MASTARM	MTG HEIGHT
1	5750-1-SL3-1 (EX.)	16/TBHS - 3	EX.	EX.	EX.
20	5750-1-SL3-20	16/TBHS - 3	II - 60	12 FT	35 FT
21	5750-1-SL3-21	16/TBHS - 3	II - 60	12 FT	35 FT
22	5750-1-SL3-22	16/TBHS - 3	II - 60	12 FT	35 FT

WIRING SCHEDULE				
△ X	RUN NO.	CONDUIT	WIRE	COMMENTS
	1	2" PVC	2-#8 (ILLUM)	SHALL BE ALUMINUM

NOTES

- 1. JUNCTION BOXES FOR S 364TH WAY ARE INTENDED TO HAVE SPACING OF APPROXIMATELY 175 FEET FOR INSTALLATION OF ADDITIONAL LIGHT STANDARDS IN THE FUTURE. THE CONTRACTOR SHALL BEAR THIS IN MIND WHEN PLACING THE JUNCTION BOXES AND ATTEMPT TO ADHERE TO THE SPACING AND PLAN LOCATIONS AS MUCH AS IS PRACTICABLE. THE CONTRACTING AGENCY UNDERSTANDS THAT FIELD CONDITIONS MAY PRECLUDE THIS. ANY JUNCTION BOX SPACING GREATER THAN 250 FEET WILL NEED TO BE COORDINATED AND APPROVED BY THE ENGINEER, PRIOR TO INSTALLATION. IF FEWER JUNCTION BOXES ARE INSTALLED THAN SHOWN IN THE PLANS, THOSE BOXES SHALL BE DELIVERED TO THE KING COUNTY SIGNAL SHOP AT THE CONTRACTOR'S EXPENSE.

LEGEND

- APPROXIMATE RIGHT-OF-WAY
- CONDUIT AND WIRING
- - - EX. CONDUIT AND WIRING
- △ WIRE NOTE
- ① CONSTRUCTION NOTE
- ⊕ LIGHT STANDARD AND LUMINAIRE
- ⊕ EX. CITY-OWNED LIGHT STANDARD AND LUMINAIRE
- ⊠ TYPE 1 JUNCTION BOX
- ⊠ EX. TYPE 1 JUNCTION BOX
- ⊕ EX. SIGN AND POST TO BE MAINTAINED

100% DESIGN

CITY OF Federal Way
Centered on Opportunity
33325 8th Avenue South
Federal Way, WA 98003-6325
(253) 835-2700
www.cityoffederalway.com

811
Know what's below.
Call 811 before you dig.

DRAFTED: D. MCINTOSH
DESIGNED: K. DAVIS, P.E.
REVIEWED: R. PEREZ, P.E.
APPROVED: R. PEREZ, P.E.



DRAWING VERSION / REVISION LOG		
NO.	DATE	REVISION

STREET LIGHT INFILL
ILLUMINATION SYSTEM - GROUP A
S 373 ST - EAST OF PACIFIC HWY S TO S 364 WAY

CITY PROJECT #:
26775
SHT. **29**
OF **76**

LUMINAIRE SCHEDULE			SERVICE NO. 5750		
PLAN NUMBER	ID NUMBER	SERVICE - CIRCUIT	TYPE - WATTS	MASTARM	MTG HEIGHT
2	5750-1-SL3-2 (EX.)	16/TBHS - 3	EX.	EX.	EX.
3	5750-1-SL3-3 (EX.)	16/TBHS - 3	EX.	EX.	EX.
4	5750-1-SL3-4 (EX.)	16/TBHS - 3	EX.	EX.	EX.
5	5750-1-SL3-5 (EX.)	16/TBHS - 3	EX.	EX.	EX.
6	5750-1-SL3-6 (EX.)	16/TBHS - 3	EX.	EX.	EX.
7	5750-1-SL3-7 (EX.)	16/TBHS - 3	EX.	EX.	EX.
8	5750-1-SL3-8 (EX.)	16/TBHS - 3	EX.	EX.	EX.
9	5750-1-SL2-9 (EX.)	16/TBHS - 2	EX.	EX.	EX.
10	5750-1-SL1-10 (EX.)	16/TBHS - 1	EX.	EX.	EX.

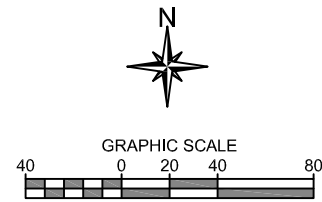

**S 373RD ST - EAST OF PACIFIC HWY S
TO S 364TH WAY -- SHEET 5 OF 5**

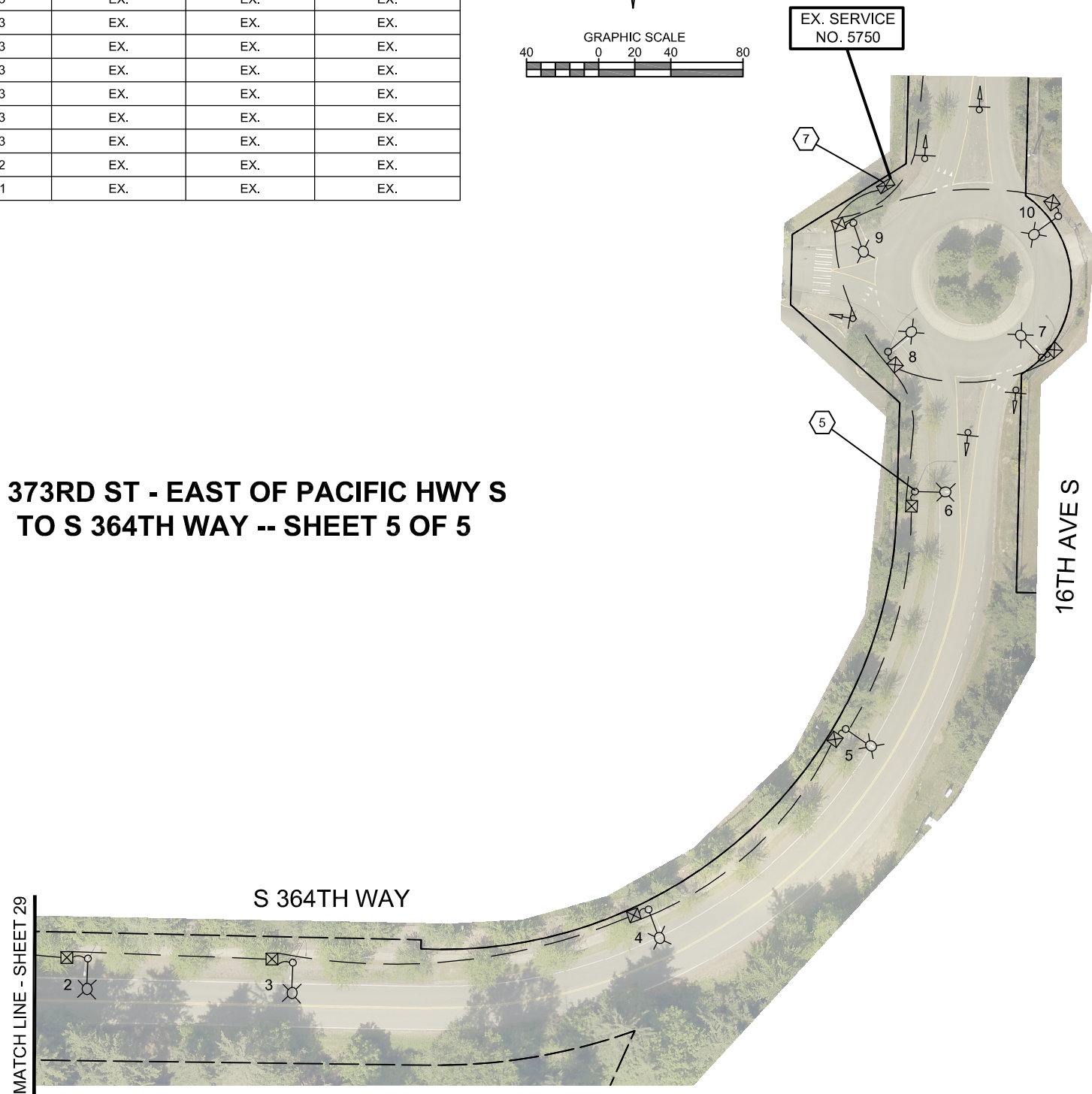

CONSTRUCTION NOTES

- 5 MAINTAIN AND PROTECT EXISTING ILLUMINATION SYSTEM.
- 7 EXISTING SERVICE CABINET TO BE USED FOR PROPOSED LIGHT STANDARDS FOR S 373 ST - EAST OF PACIFIC HWY S TO S 364 WAY.

GENERAL NOTES

1. MAINTAIN AND PROTECT EXISTING FEATURES (TREES/ SHRUBS/ VEGETATION, DITCHES, DRIVEWAYS, ETC.) WITHIN PROJECT SITE UNLESS OTHERWISE NOTED.
2. UTILITIES ARE NOT SHOWN. IT IS THE CONTRACTOR'S RESPONSIBILITY TO AVOID AND PROTECT EXISTING UTILITIES AND RESOLVE CONFLICTS.
3. ALL LIGHT STANDARDS AND JUNCTION BOXES SHALL BE INSTALLED WITHIN A CONCRETE PAD IN ACCORDANCE WITH THE DETAIL ON SHEET 63.
4. ALL JUNCTION BOXES SHALL INCLUDE THE SYSTEM IDENTIFICATION LETTERS "LT".
5. LIGHT STANDARDS SHALL BE PLACED SUCH THAT THERE IS A MINIMUM OF 6 FT FROM CENTER OF STANDARD TO EDGE LINE OR FACE OF CURB. THE CONTRACTOR SHALL NOT PLACE LIGHT STANDARDS IN FORMAL OR INFORMAL WALKING PATHS. THE CONTRACTOR SHALL NOT IMPEDE SIGHT DISTANCE, SIGN VISIBILITY, OR USPS ACCESS WITH LIGHT STANDARD PLACEMENT.
6. THE LOCATIONS SHOWN OF POLES, JUNCTION BOXES, AND SERVICE CABINETS ARE APPROXIMATE AND SHOWN OVERSIZE. FIELD ADJUSTMENT MAY BE NECESSARY. SEE NOTES. ALL CONSTRUCTION AND ACTIVITIES SHALL BE LOCATED WITHIN CITY OF FEDERAL WAY PROPERTY. RIGHT-OF-WAY LINES SHOWN ARE APPROXIMATE.

LEGEND

- - - - APPROXIMATE RIGHT-OF-WAY
- ☒ EX. TYPE 1 JUNCTION BOX
- - - EX. CONDUIT AND WIRING
- ☒ EX. SERVICE CABINET
- △ WIRE NOTE
- ⊕ EX. SIGN AND POST TO BE MAINTAINED
- CONSTRUCTION NOTE
- ⊕ EX. CITY-OWNED LIGHT STANDARD AND LUMINAIRE

100% DESIGN



DRAFTED: D. MCINTOSH
DESIGNED: K. DAVIS, P.E.
REVIEWED: R. PEREZ, P.E.
APPROVED: R. PEREZ, P.E.



DRAWING VERSION / REVISION LOG		
NO.	DATE	REVISION

STREET LIGHT INFILL

ILLUMINATION SYSTEM - GROUP S

S 373 ST - EAST OF PACIFIC HWY S TO S 364 WAY

CITY PROJECT #:
26775

SHT. **30**
OF **76**