

City of Federal Way Public Works Department 2021 PAVEMENT REPAIR PROJECT

June, 2021
RFB 21-006

DRAWING INDEX			
SHT #	DWG	DESCRIPTION	LOCATION
GENERAL			
01	COVER	COVER SHEET & INDEX	--
02	ABB	LEGEND AND ABBREVIATIONS	--
SCHEDULE A-21ST AVE SW			
03	A01	SITE PREPARATION/TEST PLAN	STA 5+00 TO STA 24+00
04	A02	SITE PREPARATION/TEST PLAN	STA 24+00 TO STA 33+00
05	A03	SITE PREPARATION/TEST PLAN	STA 63+00 TO STA 70+50
SCHEDULE B-21ST AVE SW			
06	B01	SITE PREPARATION/TEST PLAN	STA 71+30 TO STA 31+00
07	B02	SITE PREPARATION/TEST PLAN	STA 81+00 TO STA 31+00
08	B03	SITE PREPARATION/TEST PLAN	STA 91+00 TO STA 101+00
09	B04	SITE PREPARATION/TEST PLAN	STA 101+00 TO STA 111+00
10	B05	SITE PREPARATION/TEST PLAN	STA 111+00 TO STA 121+00
SCHEDULE C-SW(S) 320 AVE ST			
11	C01	SITE PREPARATION/TEST PLAN	STA 102+50 TO STA 112+00
12	C02	SITE PREPARATION/TEST PLAN	STA 112+00 TO STA 122+00
13	C03	SITE PREPARATION/TEST PLAN	STA 122+00 TO STA 132+00
14	C04	SITE PREPARATION/TEST PLAN	STA 132+00 TO STA 142+00
15	C05	SITE PREPARATION/TEST PLAN	STA 142+00 TO STA 152+00
16	C06	SITE PREPARATION/TEST PLAN	STA 152+00 TO STA 155+00
DETAILS			
17		PAVEMENT REPAIR DETAILS	--
18	TCP1	ONE-LANE, TWO-WAY TRAFFIC CONTROL WITH FLAGGERS	--
19	TCP2	PILOT CAR OPERATION	--
20	TCP3	SINGLE-LANE CLOSURE FOR MULTI-LANE ROADWAYS	--
21	TCP4	DOUBLE-LANE CLOSURE FOR MULTI-LANE ROADWAYS	--
22	TCP15	INTERSECTION LANE CLOSURE - FIVE LANE ROADWAY	--

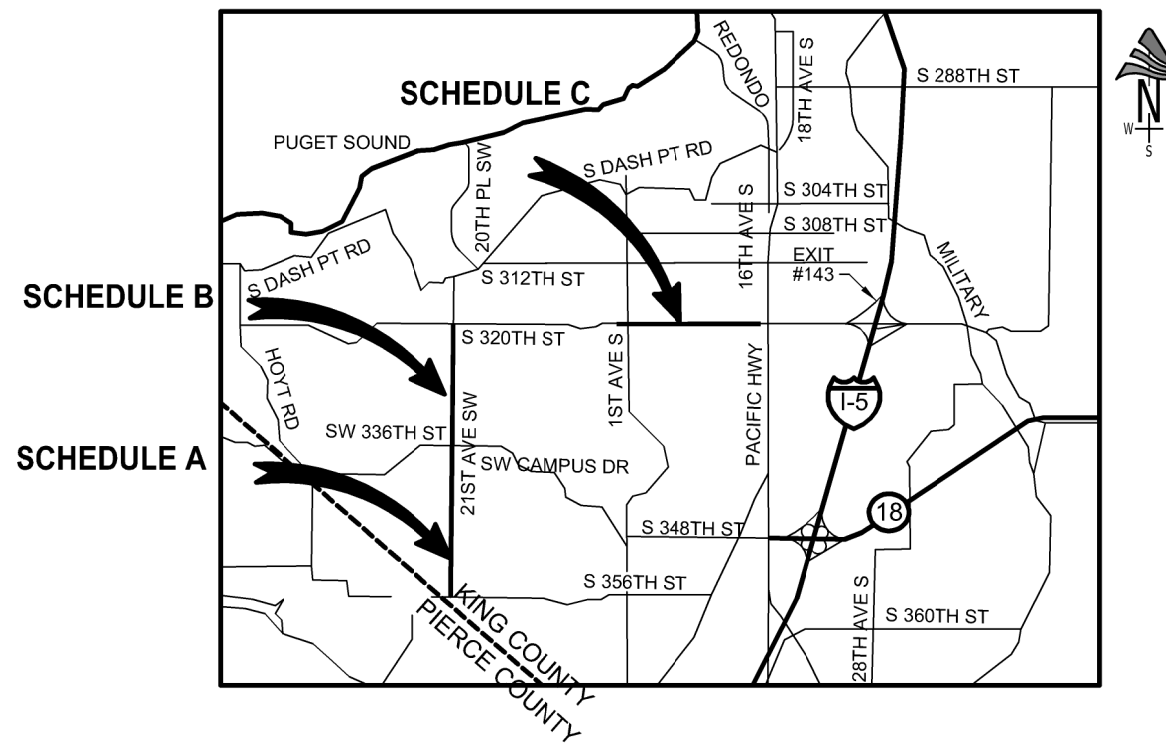

APPROVED FOR CONSTRUCTION

Desiree S. Winkler 6/30/21
 DESIREE S. WINKLER P.E. DATE
 DEPUTY PUBLIC WORKS DIRECTOR

K:\CAPITAL PROJECTS\Programmed\212 - 2021 PAVEMENT REPAIR\03 PE\CAD\CAD Files\212 - Schedule C.dwg, 6/28/2021



DRAFTED: J.HUYNH
 DESIGNED: J.HUYNH
 REVIEWED: S. HAMEL
 APPROVED: D.WINKLER



DRAWING VERSION / REVISION LOG		
NO.	DATE	REVISION

2021 PAVEMENT REPAIR
 COVER SHEET & INDEX

CITY PROJECT #:
11212

SHEET
COVER

01 OF 22

LEGEND

EXISTING (PER KPG)

MC	MONUMENT IN CASE	①	TELEPHONE MANHOLE	—————	PAINTED POWER
MON	SURFACE MONUMENT	②	TELEPHONE RISER	—————	RECORD POWER
▲	PK NAIL	③	TELEPHONE VAULT LID	—————	PAINTED TELEPHONE
NO	REBAR & CAP	④	TELEPHONE POLE	—————	RECORD TELEPHONE
●	SPOT SHOT (DESCRIBED)	⑤	TV MANHOLE	—————	PAINTED FIBER OPTIC
□	CATCH BASIN	⑥	TV RISER	—————	PAINTED TV
⊖	STORM DRAIN MANHOLE	⑦	TV VAULT LID	—————	PAINTED WATER
⊖	YARD DRAIN	⑧	FIBER OPTIC MANHOLE	—————	RECORD WATER
⊖	STORM DRAIN MANHOLE	⑨	FIBER OPTIC VAULT LID	—————	PAINTED GAS
⊖	DOWNSPOUT	⑩	FIBER OPTIC VAULT LID	—————	RECORD GAS
⊖	STORM DRAIN CLEAN-OUT	⑪	GAS VALVE	—————	OVERHEAD UTILITY LINE (GENERIC)
∨	CULVERT	⑫	GAS METER	—————	STORM
○	SEWER MANHOLE	⑬	GAS METER	—————	SEWER
⊖	SEWER CLEAN-OUT	⑭	WATER VALVE	—————	FENCE
⊖	POWER POLE	⑮	WATER VALVE	—————	SEWER
⊖	POWER POLE W/UNDERGROUND CONNECT	⑯	WATER METER	—————	EDGE (HEIGHT NOTED)
⊖	POWER POLE WITH LUMINAIRE	⑰	WATER VAULT LID	—————	BUILDING
⊖	PAR POLE W/LUMINAIRE & UNDER CONNECT	⑱	FIRE HYDRANT	—————	PAINTED STRIPE
⊖	POWER MANHOLE	Ⓡ	BLOW-OFF	—————	PAINTED SNIP STRIPE
⊖	POWER RISER	Ⓢ	FIRE DEPARTMENT CONNECT	—————	RAISED-BUTTON SOLID STRIPE
⊖	POWER VAULT LID	Ⓣ	POST INDICATOR VALVE	—————	RAISED-BUTTON SNIP STRIPE
⊖	POWER TRANSFORMER	Ⓤ	HOSE BIB	—————	EDGE OF PAVEMENT
⊖	POWER METER	Ⓥ	IRRIGATION CONTROL VALVE	—————	FLOWLINE
⊖	POWER OUTLET	Ⓦ	UTILITY MANHOLE (GENERIC/JUNK)	—————	CONTOUR
⊖	HIGH VOLTAGE PAR POLE W/UNDERO CONNECT	Ⓧ	UTILITY VAULT LID (GENERIC/JUNK)	—————	RIGHT OF WAY LINE
⊖	GUY ANCHOR	Ⓨ	UTILITY CLEAN-OUT (GENERIC/JUNK)	—————	CONCRETE
⊖	TRAFFIC SIGNAL	Ⓩ	UTILITY RISER (GENERIC/JUNK)	—————	GRAVEL
⊖	TRAFFIC SIGNAL WITH LUMINAIRE	ⓐ	STAND-PIPE (GENERIC/JUNK)	—————	GRASS
⊖	PEDESTRIAN SIGNAL	ⓑ	UTILITY ACCESS (GENERIC/JUNK)	—————	ROCKERY
⊖	JUNCTION BOX	ⓓ	BORE SITE (WITH FIELD DESG)	—————	BRICK
⊖	TRAFFIC CONTROL CABINET	ⓔ	MONITORING WELL	—————	METAL GRAVE
⊖	BACKUP POWER SUPPLY	ⓕ	BOULDER	—————	ASPHALT/CONCRETE
⊖	INTERCONNECT CABINET	ⓖ	SIGN	—————	CHAINLINK
⊖	ELECTRICAL SERVICE CABINET	ⓗ	MAILBOX (# OF BOXES)	—————	DRIVEWAY
⊖	TRAFFIC ATTENUATOR LOOP	ⓘ	SHRUB	—————	COLUMN
⊖	STREET LIGHT (LUMINAIRE)	ⓙ	SHRUB, DIAMETER	—————	YARD DRAIN
⊖	LOT LIGHT	ⓚ	SNAG, DIAMETER (# OF TRUNKS)	—————	STRUCTURE
⊖	YARD LIGHT	ⓛ	DEODOROUS TREE, DIA (# OF TRUNKS)	—————	FINISHED FLOOR
⊖	RAILROAD CROSSING ARM	ⓜ	CONIFEROUS TREE, DIA (# OF TRUNKS)	—————	
⊖	RAILROAD CROSSING SIGNAL				

PROPOSED

●	MONUMENT	—————	CONTOUR
⊖	STORMDRAIN MANHOLE	—————	DITCH FLOWLINE
⊖	CATCH BASIN	—————	EDGE OF PAVEMENT
⊖	AREA DRAIN	—————	CONCRETE CURB & GUTTER
⊖	STORMDRAIN CLEAN-OUT	—————	SAWCUT
∨	CULVERT	—————	LIMITS OF GRADING
⊖	SEWER MANHOLE	—————	STORMDRAIN
⊖	SIGN	—————	UNDERDRAIN
⊖	MAILBOX	—————	SANITARY SEWER
⊖	BOLLARD	—————	WATER
⊖	BORE / POT HOLE LOCATION	—————	IRRIGATION
⊖	SHRUB	—————	GAS
⊖	DEODOROUS TREE DIA (# OF TRUNKS)	—————	UNDERGROUND POWER
⊖	CONIFEROUS TREE DIA (# OF TRUNKS)	—————	TELECOMMUNICATION
⊖	BOULDER	—————	OVERHEAD UTILITY LINE
⊖	STREET LIGHT (LUMINAIRE)	—————	CITY FIBER
⊖	TRAFFIC SIGNAL, POLE & MAST ARM	—————	CUT LINE
⊖	TRAFFIC SIGNAL POLE & MAST ARM W/ LUMINAIRE ARM	—————	FILL LINE
⊖	PEDESTRIAN PUSH-BUTTON POLE	—————	FENCE - CHAINLINK
⊖	TRAFFIC / ILLUM J-BOX	—————	FENCE - WOOD
⊖	TRAFFIC CONTROL CABINET	—————	
⊖	BACKUP POWER SUPPLY	—————	
⊖	ELECTRICAL SERVICE CABINET	—————	
⊖	TRAFFIC SIGNAL	—————	
⊖	VEHICLE DETECTION	—————	
⊖	CITY FIBER OPTIC VAULT / J-BOX	—————	
⊖	FESTIVAL OUTLET	—————	
⊖	POWER POLE	—————	
⊖	POWER POLE GUY ANCHOR	—————	
⊖	POWER POLE W/ LUMINAIRE	—————	
⊖	POWER VAULT LID / J-BOX	—————	
⊖	POWER TRANSFORMER	—————	
⊖	POWER METER	—————	
⊖	TELECOMM VAULT / J-BOX	—————	
⊖	UTILITY PEDESTAL	—————	
⊖	GAS VALVE	—————	
⊖	GAS METER	—————	
⊖	WATER VALVE	—————	
⊖	WATER METER	—————	
⊖	WATER VAULT LID	—————	
⊖	FIRE HYDRANT	—————	
⊖	BLOW-OFF	—————	

ABBREVIATIONS

ABND	ABANDONED	MM	MONITORING WELL
AC	ASPHALT	NO	NORTHING/NORTH
AC	ASBESTOS CEMENT WATER PIPE	NOS	NOT TO SCALE
ACP	ASPHALT CONCRETE PAVEMENT	OC	ON CENTER
ADA	AMERICANS WITH DISABILITIES ACT	OD	OUTSIDE DIAMETER
AP	ANGLE POINT	OH	OVERHEAD UTILITIES
AVE	AVENUE	PC	POINT OF CURVATURE
BLDG	BUILDING	PCC	POINT OF CURVE ON CURVE
BMP	BEST MANAGEMENT PRACTICE	PE	POLYETHYLENE
BOW	BACK OF WALK	PG	PERFORMANCE GRADE
CB	CATCH BASIN	PIV	POINT OF INTERSECTION
CDF	CONTROLLED DENSITY FILL	PV	POST INDICATOR VALVE
CI	CAST IRON	PV1	POINT OF BEGINNING
CL	CENTERLINE	PV2	POINT OF BEGINNING
CL	CLASS	PV3	POINT OF CONNECTION
CO	CLEANOUT	POE	POINT OF ENDING
CONC	CONCRETE	POE	POINT OF REVERSE CURVATURE
CONT	CONTAINER	PT	POINT OF TANGENCY
DCVA	DOUBLE CHECK VALVE ASSEMBLY	PVC	POLYVINYL CHLORIDE
DI	DUCTILE IRON	PVI	POINT OF VERTICAL INTERSECTION
DIA #	DIAMETER	R	RADIUS
CFW	CITY OF FEDERAL WAY	RJ	RESTRAINED JOINT
CSBC	CRUSHED SURFACING BASE COURSE	RT	RIGHT
E	EASTING/EAST	S	SLOPESOUTH
EL	ELEVATION	SD	STORM DRAIN
ELEV	ELEVATION	SPP	STORM DRAIN PIPE
EOP	EDGE OF PAVEMENT	SEW	SEWER
EX	EXISTING	SHT	SHEET
EXIST	EXISTING	SSMH	SANITARY SEWER MANHOLE
FDC	FIRE DEPARTMENT CONNECTION	ST	STREET
FG	FINISHED GRADE	STA	STATION
FL	FLANGE	STD	STANDARD
FL	FLOWLINE	T	TANGENT LENGTH
FL	FLOWLINE	T1	TYPE 1 CATCH BASIN
HORIZ	HORIZONTAL	T2	TYPE 2 CATCH BASIN
HMA	HOT MIX ASPHALT	TOC	TOP OF CURB
ICV	IRRIATION CONTROL VALVE	TOG	TOP OF GRATE
ID	INSIDE DIAMETER	TYP	TYPICAL
IE	INVERT ELEVATION	VC	VERTICAL CURVE
L	LENGTH OF CURVE	VERT	VERTICAL
LT	LEFT	VLT	VERTICAL VAULT
LF	LINEAR FEET	W	WEST / WITH
LP	LOW POINT	WAT	WATER
MAX	MAXIMUM	WSDOT	WASHINGTON STATE DEPARTMENT OF TRANSPORTATION
MIN	MINIMUM		
MH	MANHOLE		
MIC	MONUMENT IN CASE		
MJ	MECHANICAL JOINT		

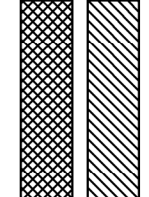

GRIND EXISTING PAVEMENT TO BE REMOVED AT STATION OR LOCATION INDICATED. 6 INCH DEPTH AND DISTANCE DIRECTED BY ENGINEER.

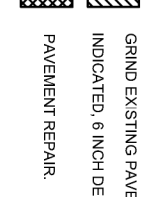

PAVEMENT REPAIR.

CITY OF
Federal Way
Centered on Opportunity
33325 8TH AVE S FEDERAL WAY, WA 98003
PHONE: (253) 835-2700
WWW.CITYOFFEDERALWAY.COM

DRAFTED: J.HUYNH
DESIGNED: J.HUYNH
REVIEWED: S. HAMEL
APPROVED: D.WINKLER

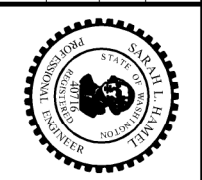

DRAWING VERSION / REVISION LOG		
NO.	DATE	REVISION

2021 PAVEMENT REPAIR

LEGEND AND ABBREVIATIONS

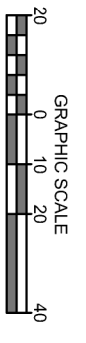
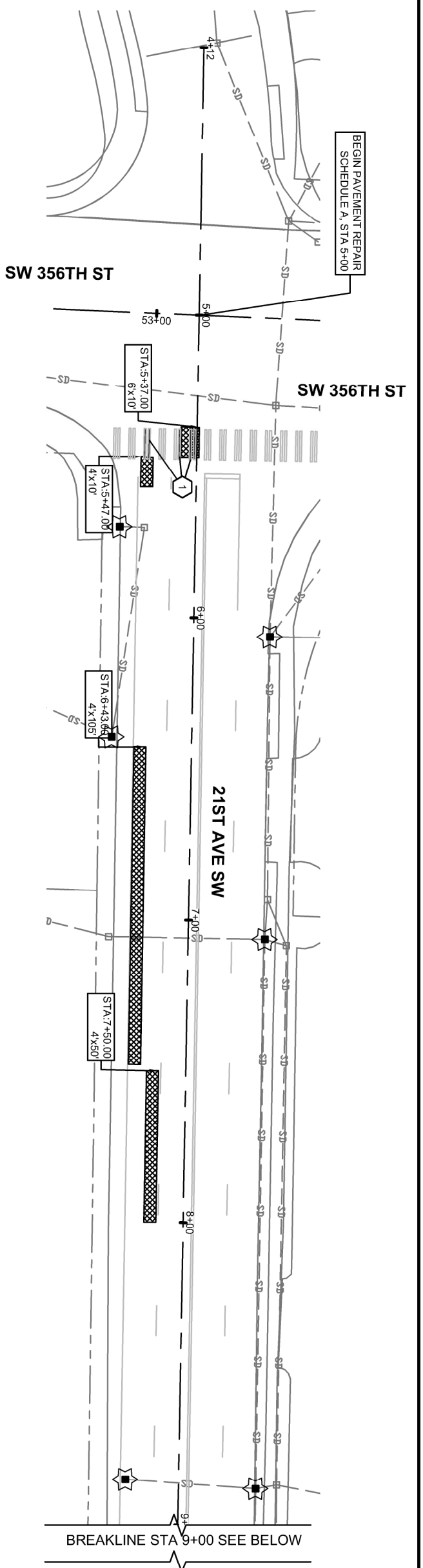

- CONSTRUCTION NOTES**
- 1 PLASTIC CROSSWALK LINE
 - 2 PLASTIC STOP LINE
 - 3 YIELD LINE SYMBOL

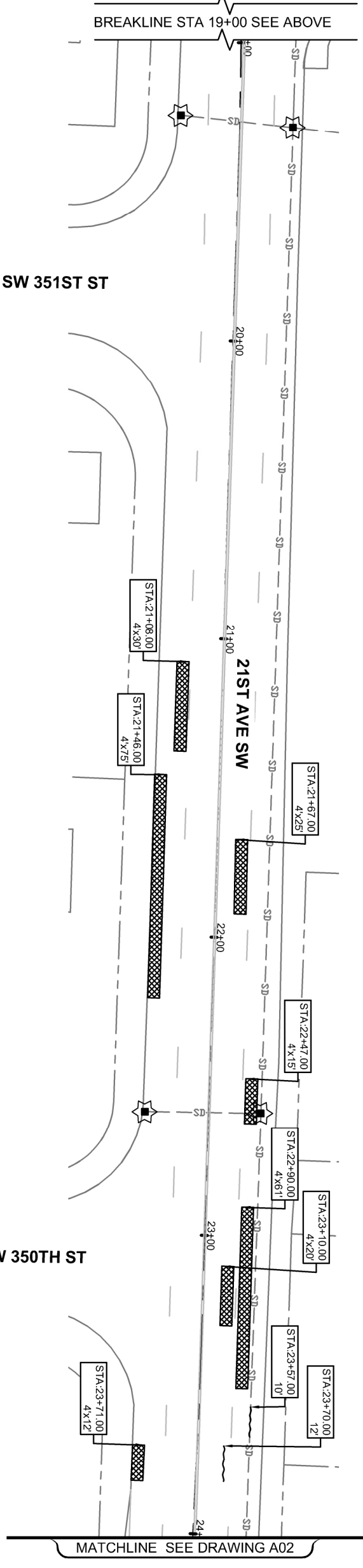

- LEGEND:**
- PAVEMENT REPAIR
 - CRACK SEALING
 - INLET PROTECTION INSERT

CITY OF Federal Way
 Centered on Opportunity
 33325 8TH AVE S FEDERAL WAY, WA 98003
 PHONE: (253) 856-2700
 WWW.CITYOFFEDERALWAY.COM

811
 Know what's below.
 Call before you dig.

DRAFTED: J.HUYNH
 DESIGNED: J.HUYNH
 REVIEWED: S.HAMEL
 APPROVED: D.WINKLER



DRAWING VERSION / REVISION LOG

NO.	DATE	REVISION

2021 PAVEMENT REPAIR
 SITE PREPARATION/TESS PLAN
 STA 5+00 TO STA 24+00

CITY PROJECT #: 11212
 SHEET: A01
 03 OF 22

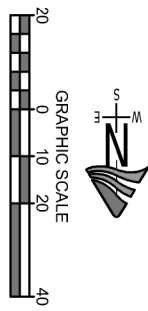
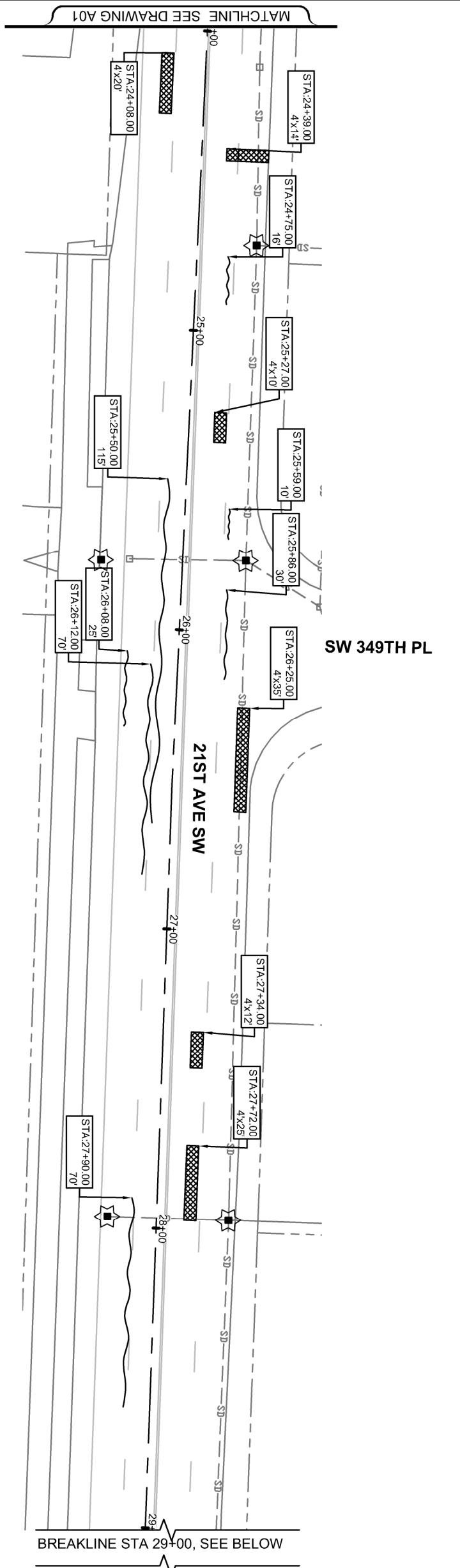

- CONSTRUCTION NOTES**
- 1 PLASTIC CROSSWALK LINE
 - 2 PLASTIC STOP LINE
 - 3 YIELD LINE SYMBOL

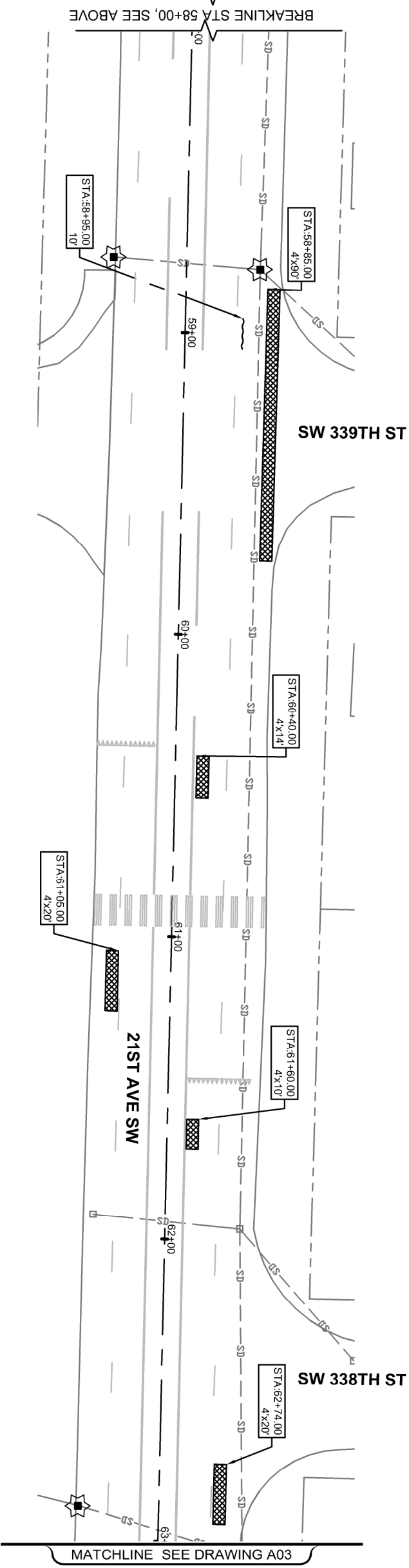

- LEGEND:**
- PAVEMENT REPAIR
 - CRACK SEALING
 - INLET PROTECTION INSERT

CITY OF Federal Way
 Centered on Opportunity
 33325 8TH AVE S FEDERAL WAY, WA 98003
 PHONE: (253) 856-2700
 WWW.CITYOFFEDERALWAY.COM



DRAFTED: JHUYNH
 DESIGNED: JHUYNH
 REVIEWED: S. HAMEL
 APPROVED: D. WINKLER



DRAWING VERSION / REVISION LOG

NO.	DATE	REVISION

2021 PAVEMENT REPAIR
 SITE PREPARATION/TESS PLAN
 STA 24+00 TO STA 63+00

CITY PROJECT #: 11212
 SHEET: A02
 04 OF 22

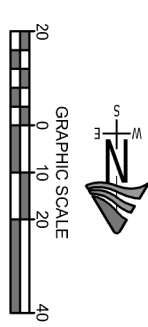
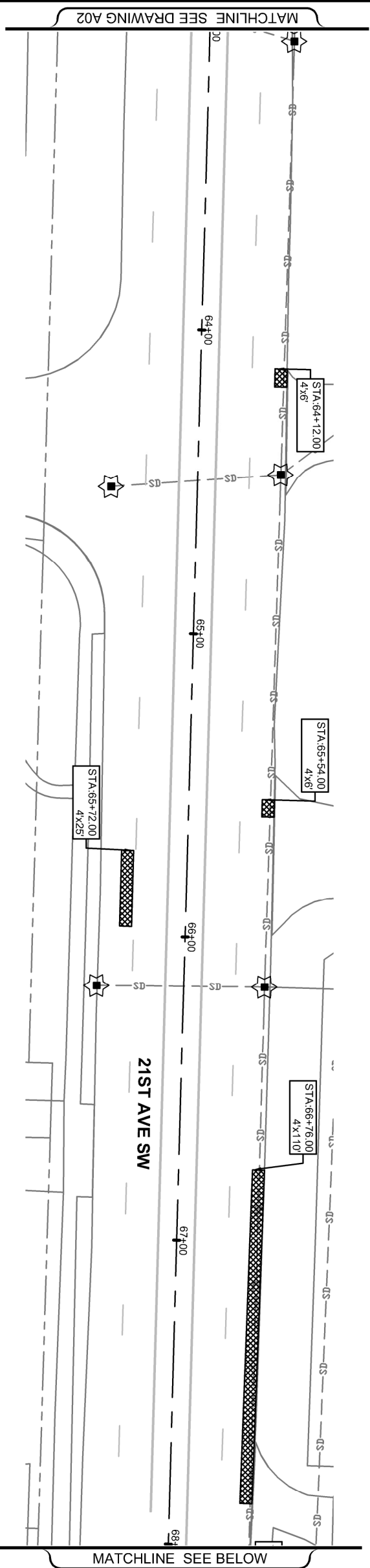

- CONSTRUCTION NOTES**
- 1 PLASTIC CROSSWALK LINE
 - 2 PLASTIC STOP LINE
 - 3 YIELD LINE SYMBOL

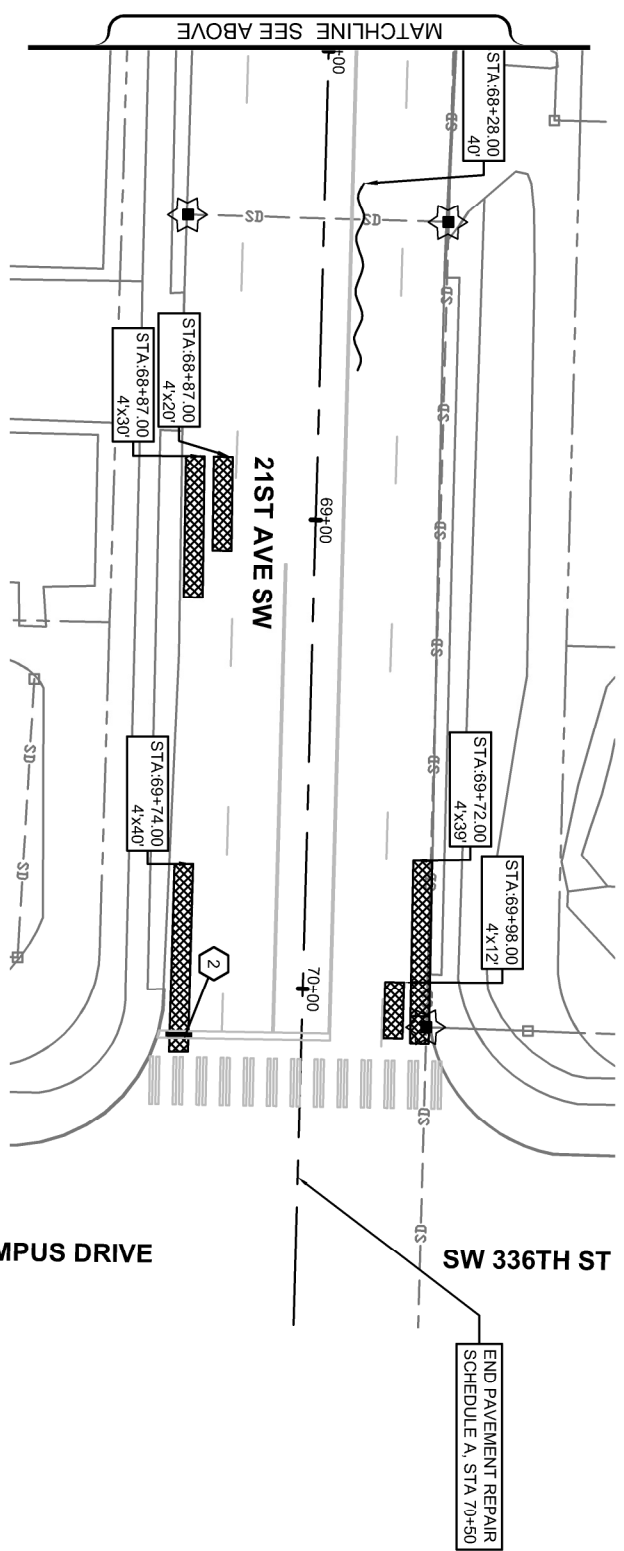

- LEGEND:**
- PAVEMENT REPAIR
 - CRACK SEALING
 - INLET PROTECTION INSERT

33325 8TH AVE S FEDERAL WAY, WA 98003
 PHONE: (253) 836-2700
 WWW.CITYOFFEDERALWAY.COM

DRAFTED: JHUYNH
 DESIGNED: JHUYNH
 REVIEWED: S. HAMEL
 APPROVED: D. WINKLER



DRAWING VERSION / REVISION LOG

NO.	DATE	REVISION

2021 PAVEMENT REPAIR

SITE PREPARATION/TESS PLAN

STA 63+00 TO STA 70+50

CITY PROJECT #: 11212
 SHEET: A03
 05 OF 22

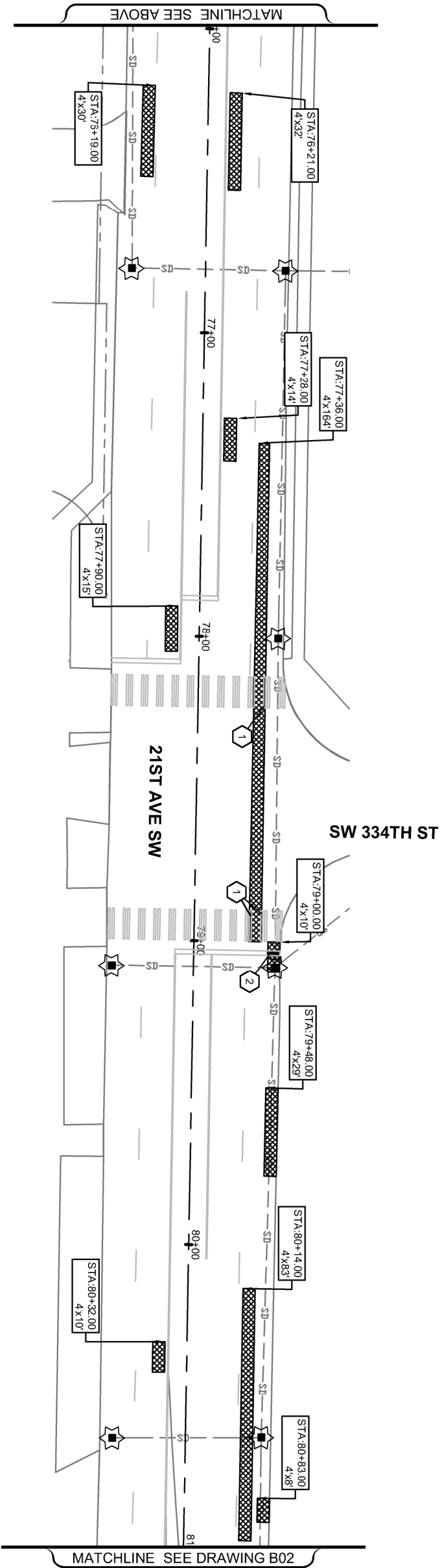
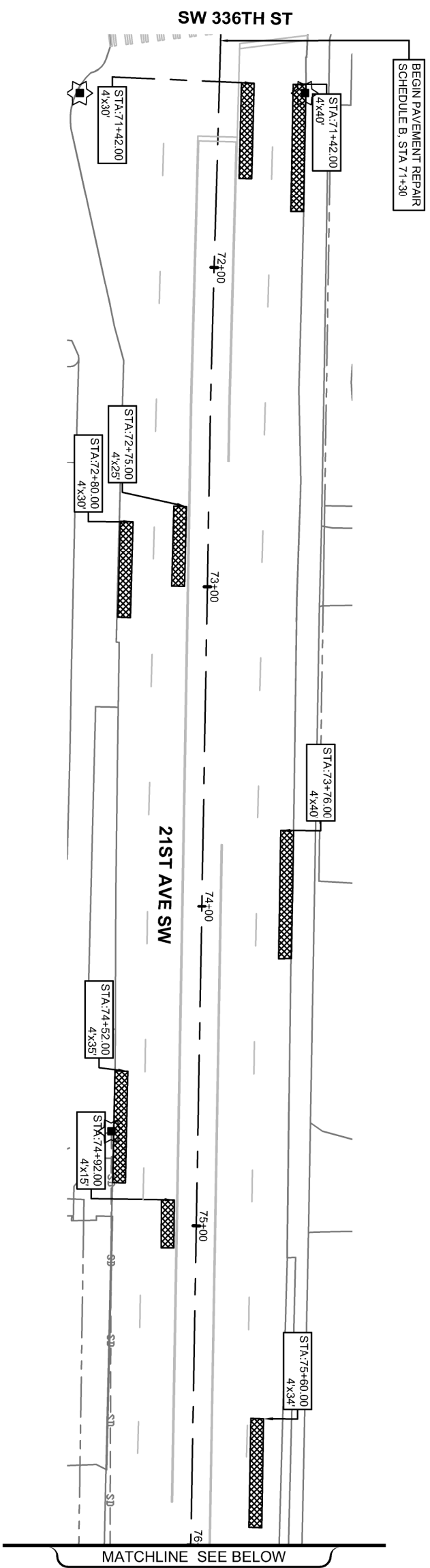

- CONSTRUCTION NOTES**
- 1 PLASTIC CROSSWALK LINE
 - 2 PLASTIC STOP LINE
 - 3 YIELD LINE SYMBOL

- LEGEND:**
- PAVEMENT REPAIR
 - CRACK SEALING
 - INLET PROTECTION INSERT



DRAFTED: JHUYNH
 DESIGNED: JHUYNH
 REVIEWED: S. HAMEL
 APPROVED: D.WINKLER



DRAWING VERSION / REVISION LOG

NO.	DATE	REVISION

2021 PAVEMENT REPAIR
 SITE PREPARATION/TESS PLAN
 STA 71+30 TO STA 81+00

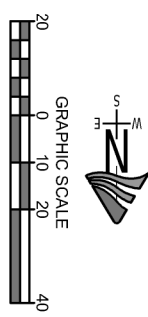
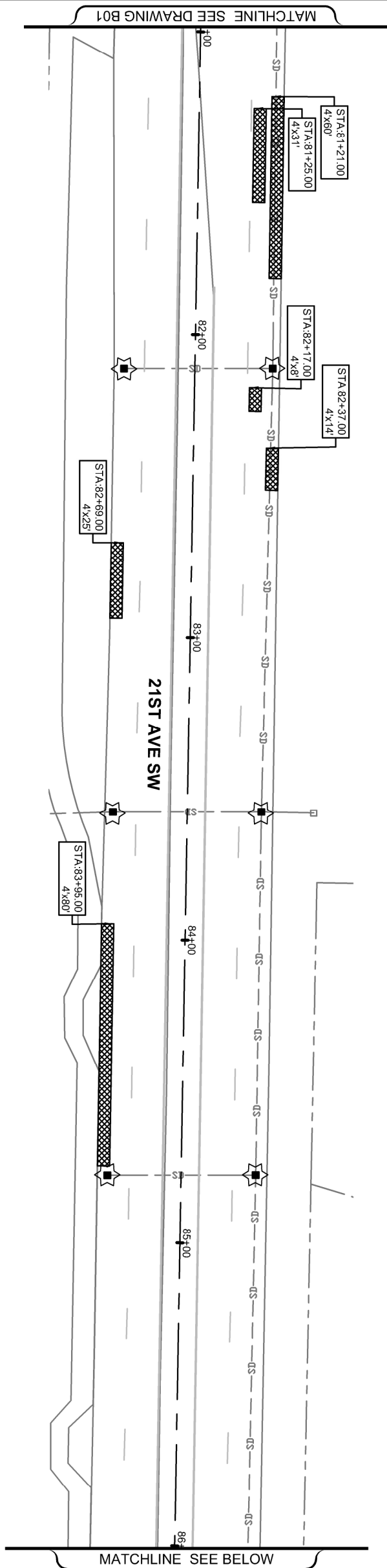

- CONSTRUCTION NOTES**
- 1 PLASTIC CROSSWALK LINE
 - 2 PLASTIC STOP LINE
 - 3 YIELD LINE SYMBOL

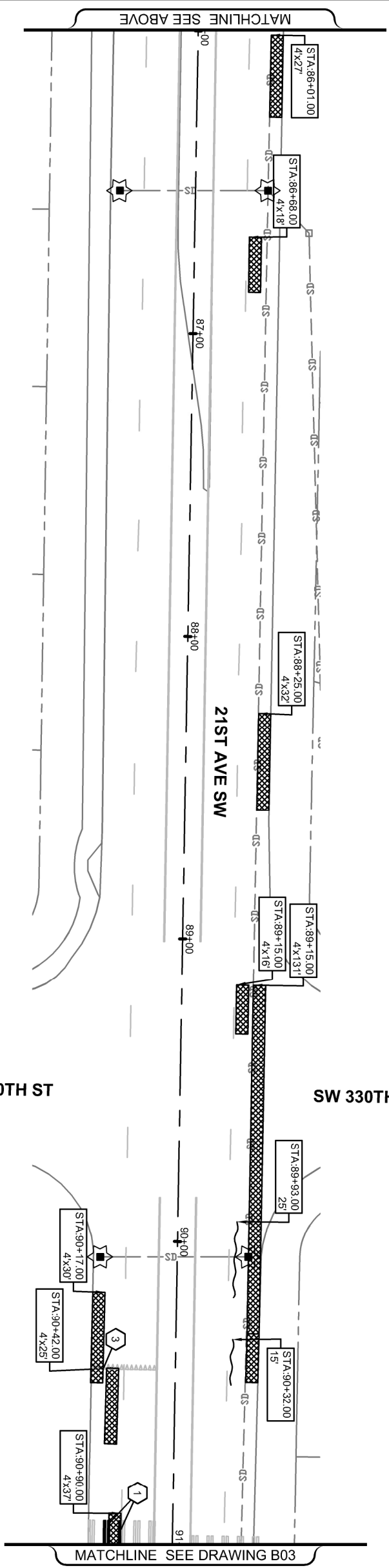

- LEGEND:**
- PAVEMENT REPAIR
 - CRACK SEALING
 - INLET PROTECTION INSERT

CITY OF Federal Way
Centered on Opportunity
33325 8TH AVE S FEDERAL WAY, WA 98003
PHONE: (253) 856-2700
WWW.CITYOFFEDERALWAY.COM

Know what's below.
Call before you dig.

DRAFTED: J.HUYNH
DESIGNED: J.HUYNH
REVIEWED: S.HAMEL
APPROVED: D.WINKLER



DRAWING VERSION / REVISION LOG

NO.	DATE	REVISION

2021 PAVEMENT REPAIR
SITE PREPARATION/TESS PLAN
STA 81+00 TO STA 91+00

CITY PROJECT #:	11212
SHEET	B02
07 OF 22	

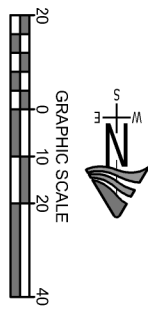
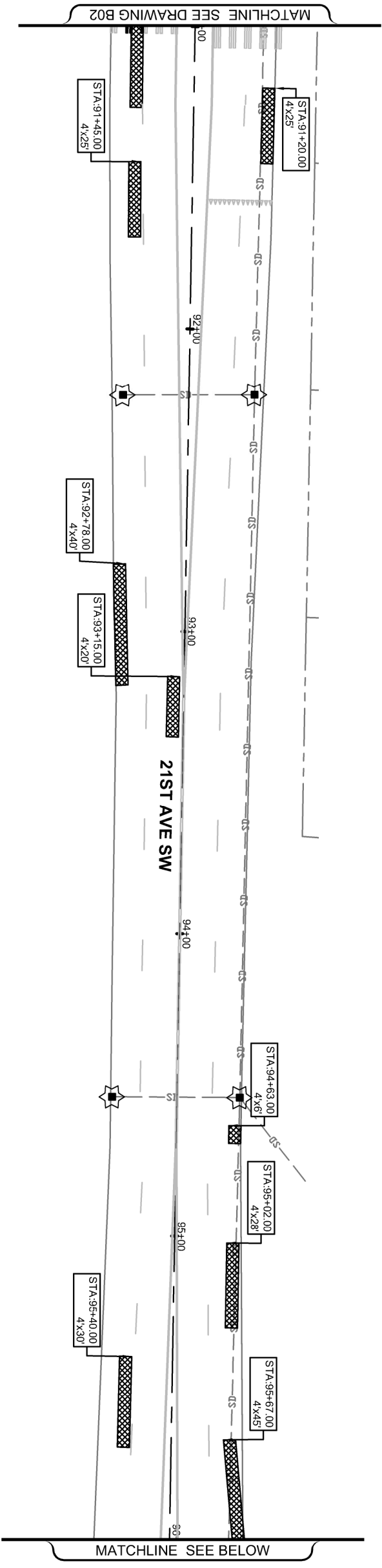

- CONSTRUCTION NOTES**
- 1 PLASTIC CROSSWALK LINE
 - 2 PLASTIC STOP LINE
 - 3 YIELD LINE SYMBOL

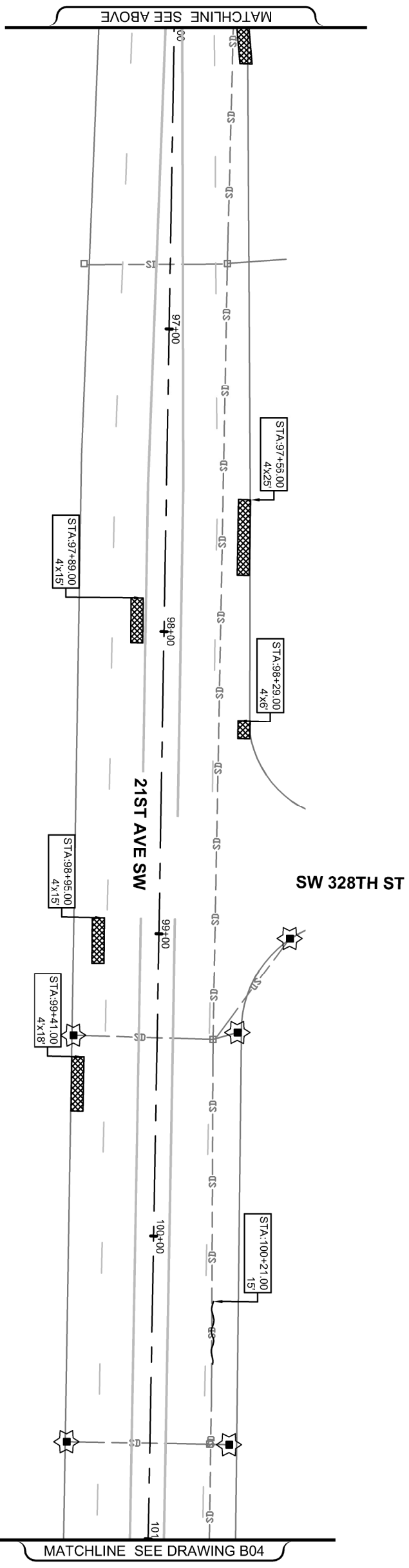

- LEGEND:**
- PAVEMENT REPAIR
 - CRACK SEALING
 - INLET PROTECTION INSERT

CITY OF
Federal Way
Centered on Opportunity
33325 8TH AVE S FEDERAL WAY, WA 98003
PHONE: (253) 836-2700
WWW.CITYOFFEDERALWAY.COM

Know what's below.
Call before you dig.

DRAFTED: JHUYNH
DESIGNED: JHUYNH
REVIEWED: S. HAMEL
APPROVED: D. WINKLER

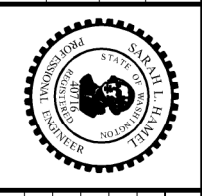

DRAWING VERSION / REVISION LOG

NO.	DATE	REVISION

2021 PAVEMENT REPAIR
SITE PREPARATION/TESS PLAN
STA 91+00 TO STA 101+00

CITY PROJECT #:
111212
SHEET
B03
08 OF 22

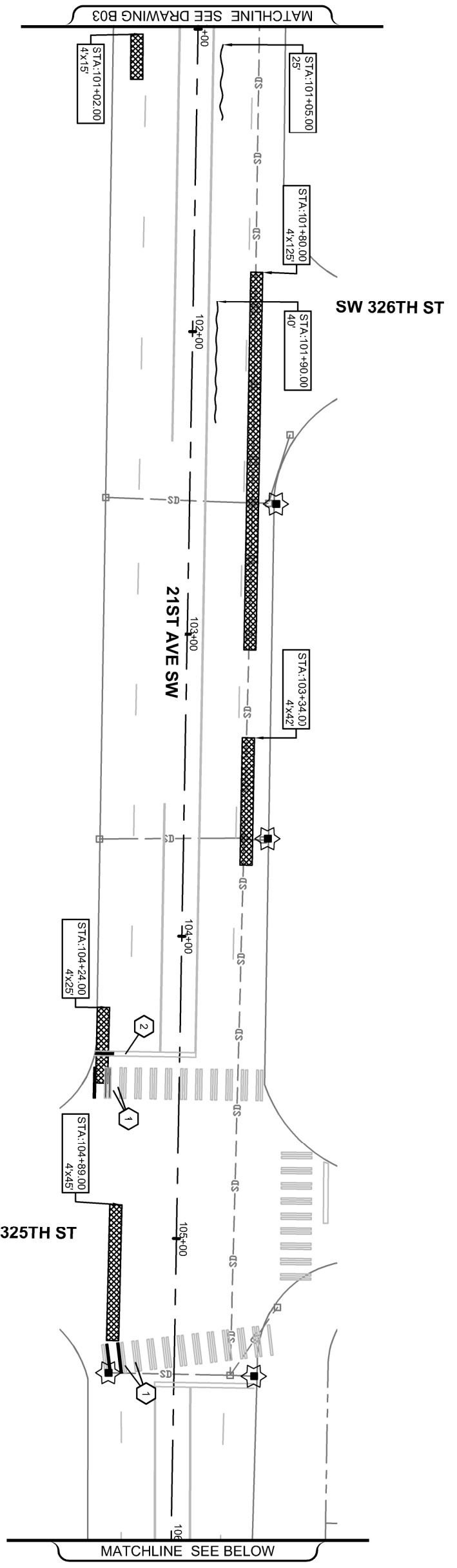

SW 326TH ST

21ST AVE SW

SW 325TH ST

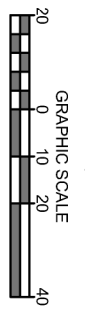

- CONSTRUCTION NOTES**
- 1 PLASTIC CROSSWALK LINE
 - 2 PLASTIC STOP LINE
 - 3 YIELD LINE SYMBOL

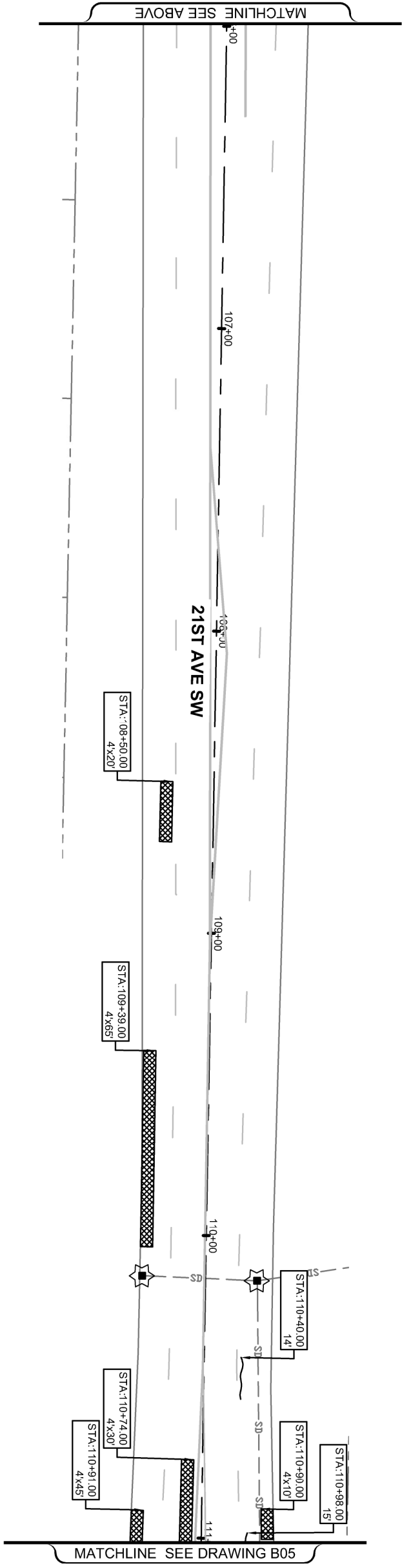

LEGEND:

- PAVEMENT REPAIR
- CRACK SEALING
- INLET PROTECTION INSERT

CITY OF Federal Way
Centered on Opportunity
33325 8TH AVES S FEDERAL WAY, WA 98003
PHONE: (253) 856-2700
WWW.CITYOFFEDERALWAY.COM



DRAFTED: J.HUYNH
DESIGNED: J.HUYNH
REVIEWED: S.HAMEL
APPROVED: D.WINKLER



DRAWING VERSION / REVISION LOG

NO.	DATE	REVISION

2021 PAVEMENT REPAIR
SITE PREPARATION/TESS PLAN
STA 101+00 TO STA 111+00

CITY PROJECT #: 11212
SHEET: B04
09 OF 22

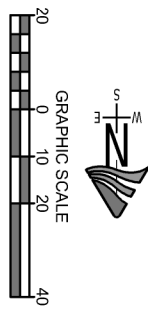
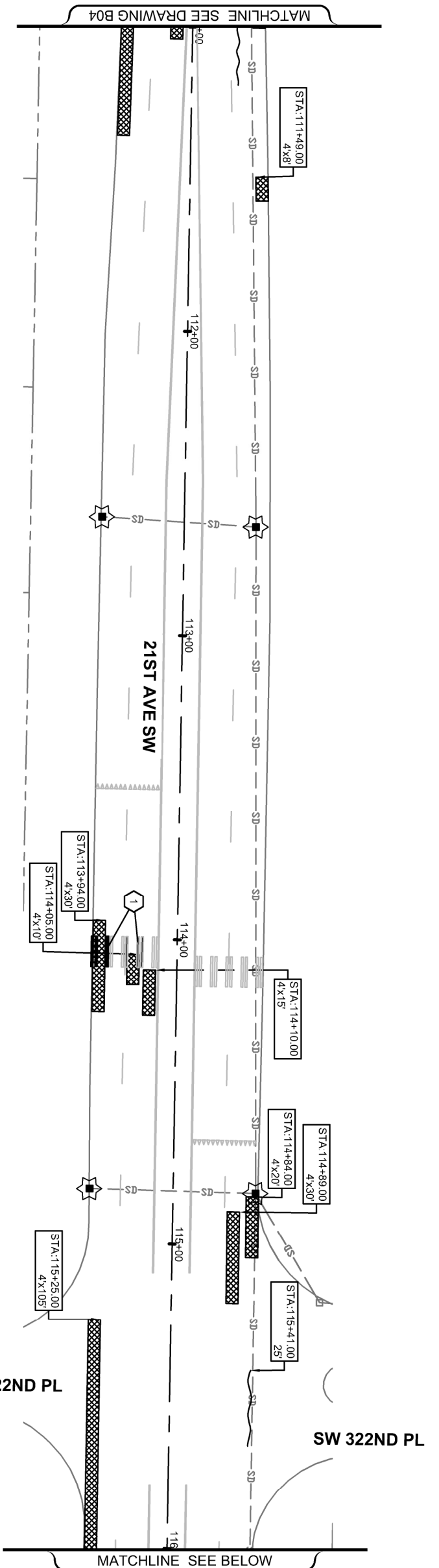

- CONSTRUCTION NOTES**
- 1 PLASTIC CROSSWALK LINE
 - 2 PLASTIC STOP LINE
 - 3 YIELD LINE SYMBOL

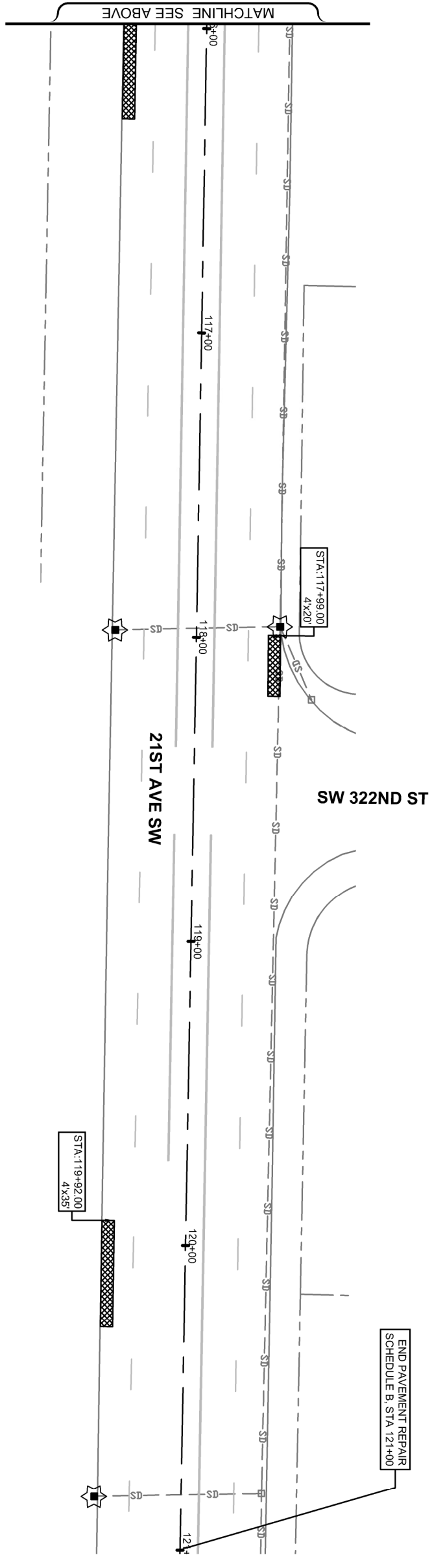

- LEGEND:**
- PAVEMENT REPAIR
 - CRACK SEALING
 - INLET PROTECTION INSERT

CITY OF Federal Way
 Centered on Opportunity
 33325 8TH AVE S FEDERAL WAY, WA 98003
 PHONE: (253) 836-2700
 WWW.CITYOFFEDERALWAY.COM



DRAFTED: J.HUYNH
 DESIGNED: J.HUYNH
 REVIEWED: S. HAMEL
 APPROVED: D.WINKLER

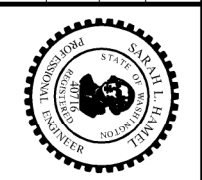

DRAWING VERSION / REVISION LOG

NO.	DATE	REVISION

2021 PAVEMENT REPAIR
 SITE PREPARATION/TESS PLAN
 STA 111+00 TO STA 121+00

CITY PROJECT #: 11212
 SHEET: B05
 10 OF 22

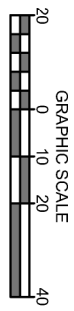
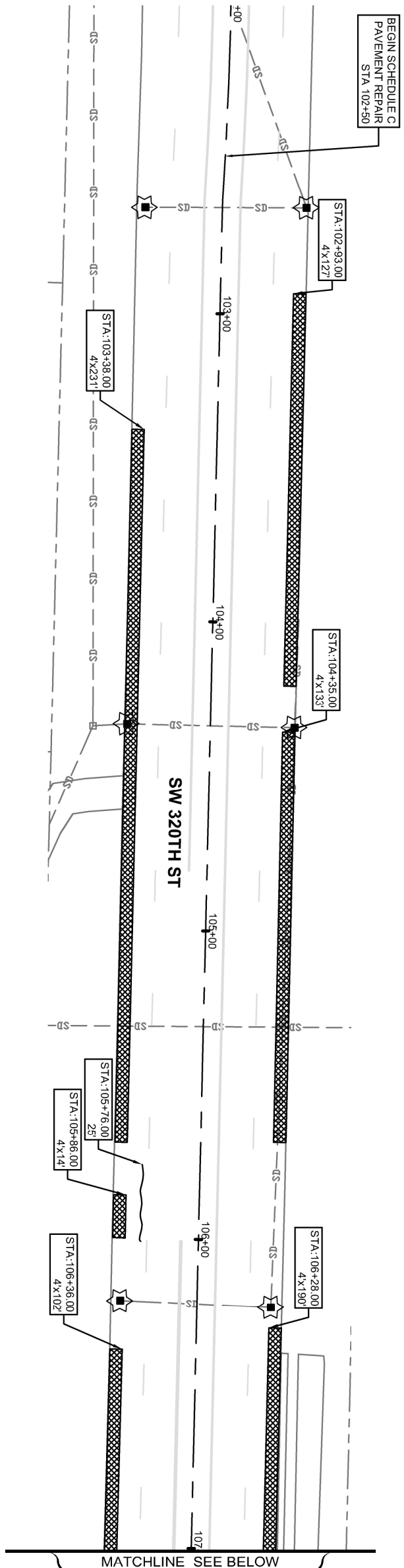

- CONSTRUCTION NOTES**
- 1 PLASTIC CROSSWALK LINE
 - 2 PLASTIC STOP LINE
 - 3 YIELD LINE SYMBOL

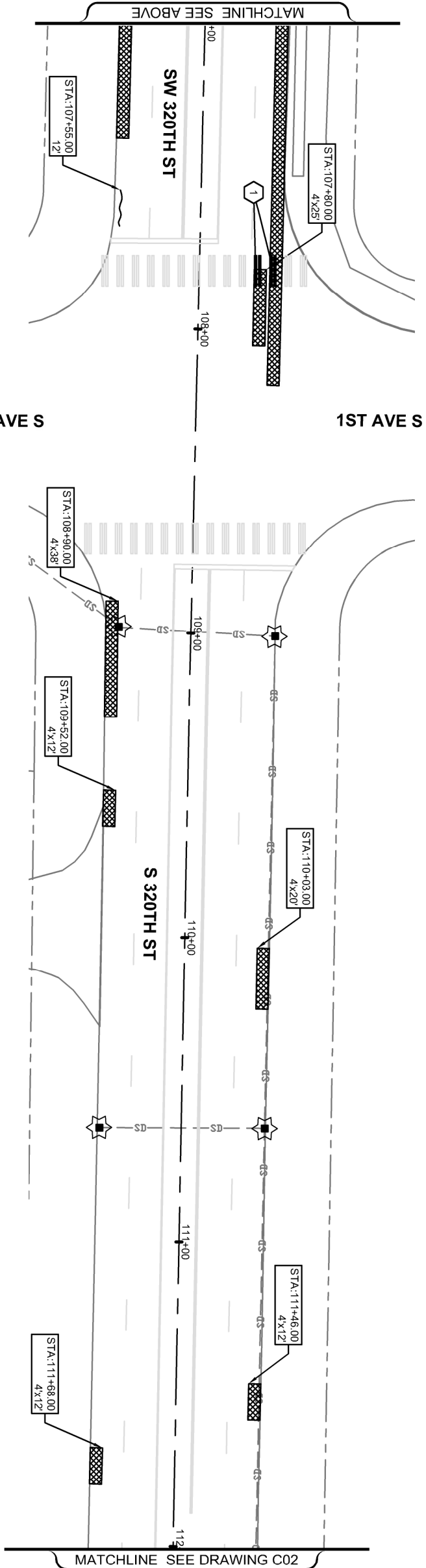

- LEGEND:**
- PAVEMENT REPAIR
 - CRACK SEALING
 - INLET PROTECTION INSERT

CITY OF Federal Way
Centered on Opportunity
33325 8TH AVE S FEDERAL WAY, WA 98003
PHONE: (253) 856-2700
WWW.CITYOFFEDERALWAY.COM

Know what's below.
Call before you dig.

DRAFTED: J.HUYNH
DESIGNED: J.HUYNH
REVIEWED: S.HAMEL
APPROVED: D.WINKLER



DRAWING VERSION / REVISION LOG

NO.	DATE	REVISION

2021 PAVEMENT REPAIR

SITE PREPARATION/TESC PLAN
STA 102+50 TO STA 112+00

CITY PROJECT #: 11212
SHEET: C01
11 OF 22

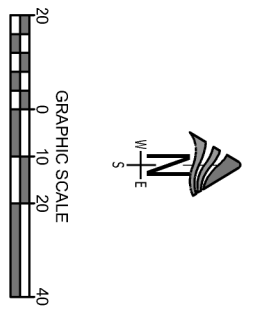
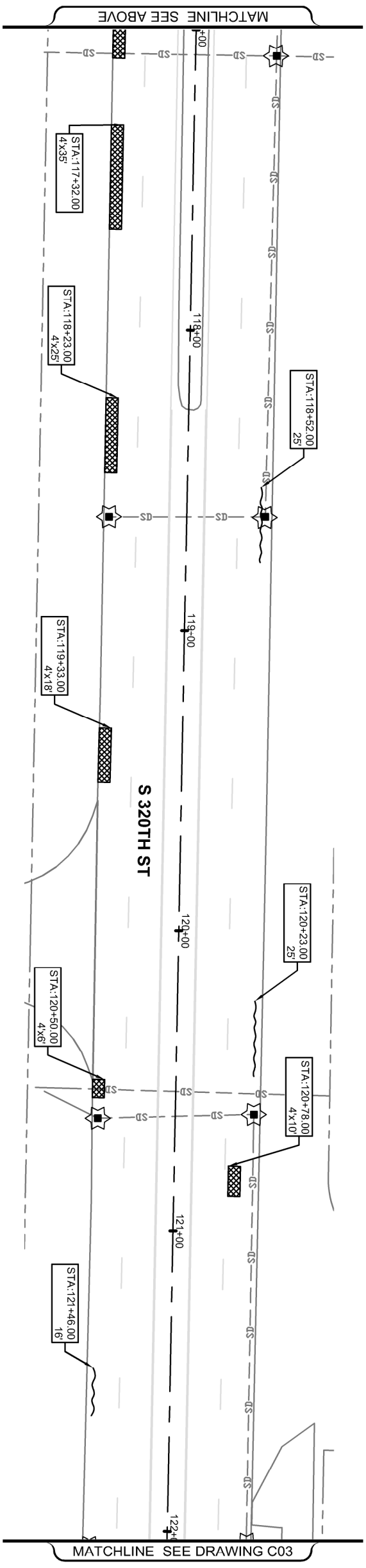
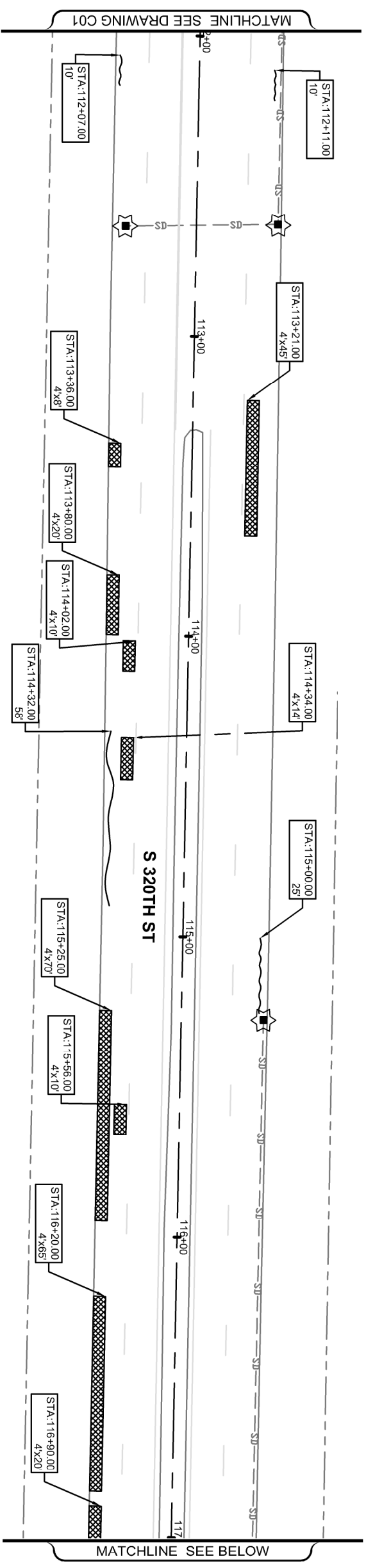

- CONSTRUCTION NOTES**
- 1 PLASTIC CROSSWALK LINE
 - 2 PLASTIC STOP LINE
 - 3 YIELD LINE SYMBOL

- LEGEND:**
- PAVEMENT REPAIR
 - CRACK SEALING
 - INLET PROTECTION INSERT

CITY OF
Federal Way
Centered on Opportunity
33325 8TH AVE S FEDERAL WAY, WA 98003
PHONE: (253) 836-2700
WWW.CITYOFFEDERALWAY.COM

Know what's below.
Call before you dig.

DRAFTED: JHUYNH
DESIGNED: JHUYNH
REVIEWED: S. HAMEL
APPROVED: D. WINKLER



DRAWING VERSION / REVISION LOG

NO.	DATE	REVISION

2021 PAVEMENT REPAIR

SITE PREPARATION/TESS PLAN

STA 112+00 TO STA 122+00

CITY PROJECT #: 11212
SHEET: C02
12 OF 22

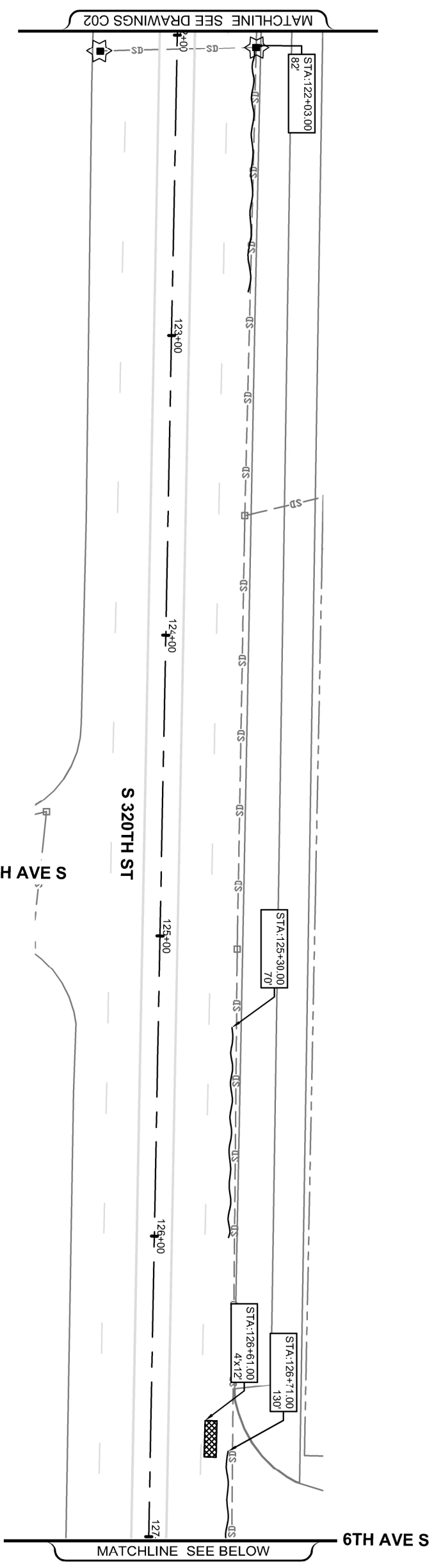

- CONSTRUCTION NOTES**
- 1 PLASTIC CROSSWALK LINE
 - 2 PLASTIC STOP LINE
 - 3 YIELD LINE SYMBOL

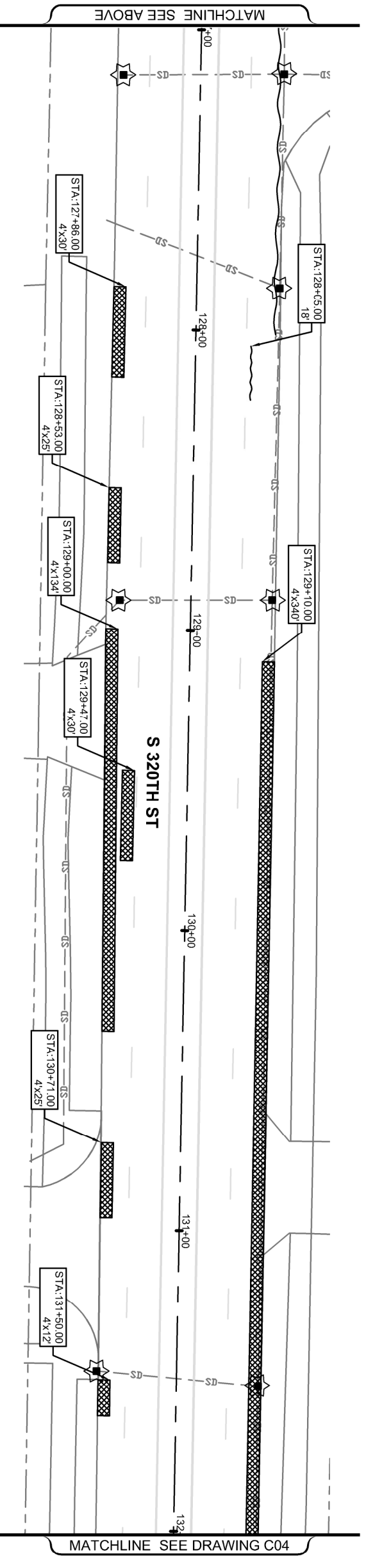

- LEGEND:**
- PAVEMENT REPAIR
 - CRACK SEALING
 - INLET PROTECTION INSERT

CITY OF
Federal Way
 Centered on Opportunity
 33325 8TH AVE S FEDERAL WAY, WA 98003
 PHONE: (253) 856-2700
 WWW.CITYOFFEDERALWAY.COM



DRAFTED: J.HUYNH
 DESIGNED: J.HUYNH
 REVIEWED: S.HAMEL
 APPROVED: D.WINKLER

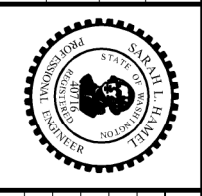

DRAWING VERSION / REVISION LOG

NO.	DATE	REVISION

2021 PAVEMENT REPAIR
 SITE PREPARATION/TESS PLAN
 STA 122+00 TO STA 132+00

CITY PROJECT #: 11212
 SHEET: C03
 13 OF 22

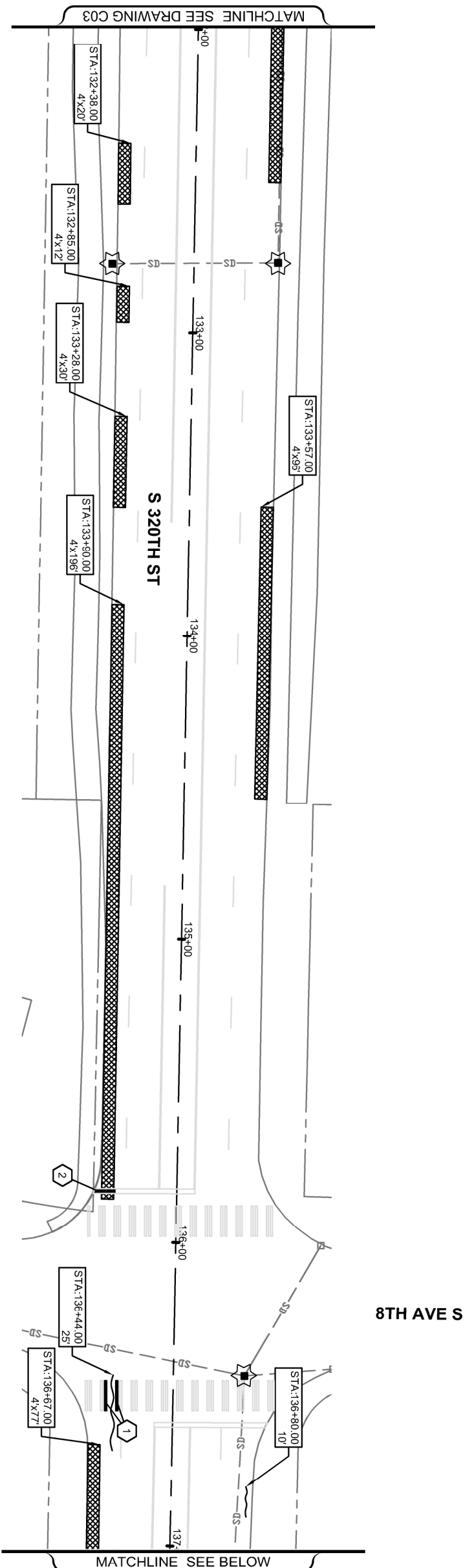

8TH AVE S

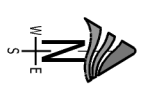
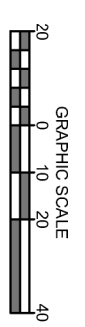

- CONSTRUCTION NOTES**
- 1 PLASTIC CROSSWALK LINE
 - 2 PLASTIC STOP LINE
 - 3 YIELD LINE SYMBOL

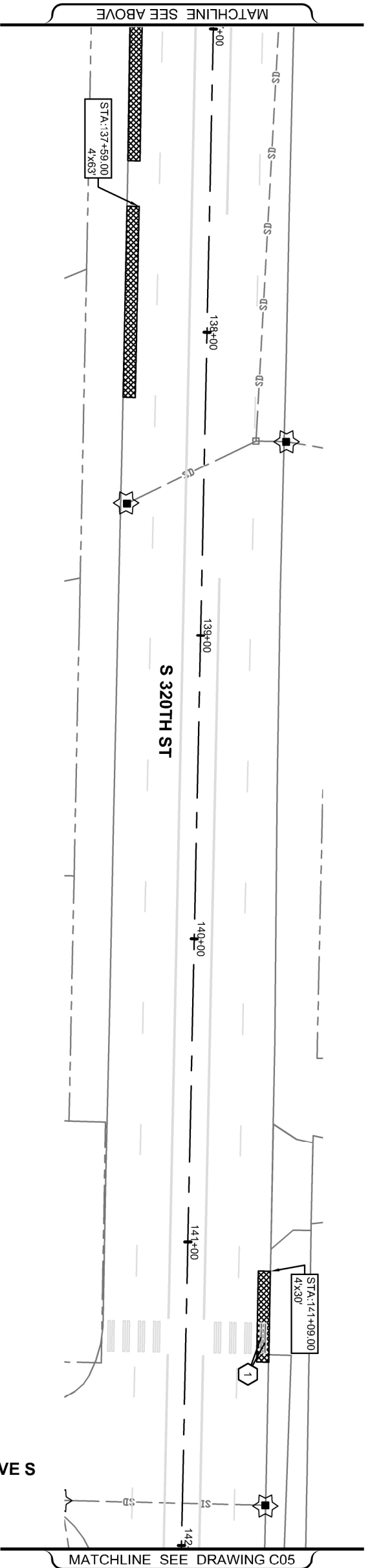

10TH AVE S

- LEGEND:**
- PAVEMENT REPAIR
 - CRACK SEALING
 - INLET PROTECTION INSERT

CITY OF Federal Way
Centered on Opportunity
33325 8TH AVE S FEDERAL WAY, WA 98003
PHONE: (253) 836-2700
WWW.CITYOFFEDERALWAY.COM

Know what's below.
Call before you dig.

DRAFTED: J.HUYNH
DESIGNED: J.HUYNH
REVIEWED: S.HAMEL
APPROVED: D.WINKLER

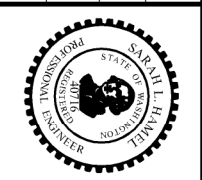

DRAWING VERSION / REVISION LOG

NO.	DATE	REVISION

2021 PAVEMENT REPAIR

SITE PREPARATION/TESS PLAN

STA 132+00 TO STA 142+00

CITY PROJECT #: 11212
SHEET: C04
14 OF 22

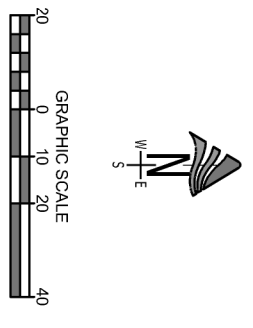
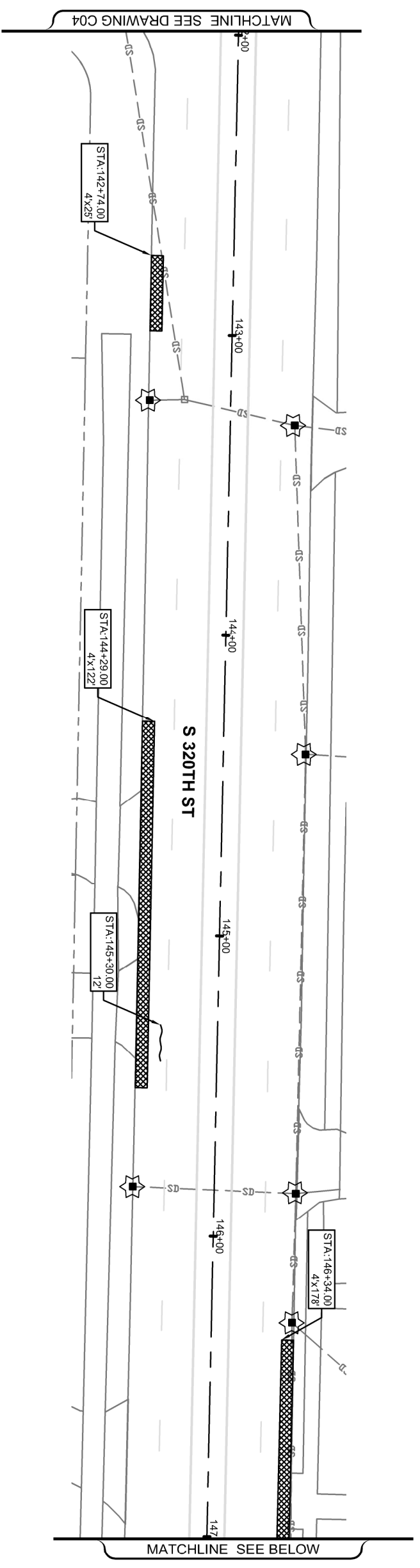

- CONSTRUCTION NOTES**
- 1 PLASTIC CROSSWALK LINE
 - 2 PLASTIC STOP LINE
 - 3 YIELD LINE SYMBOL

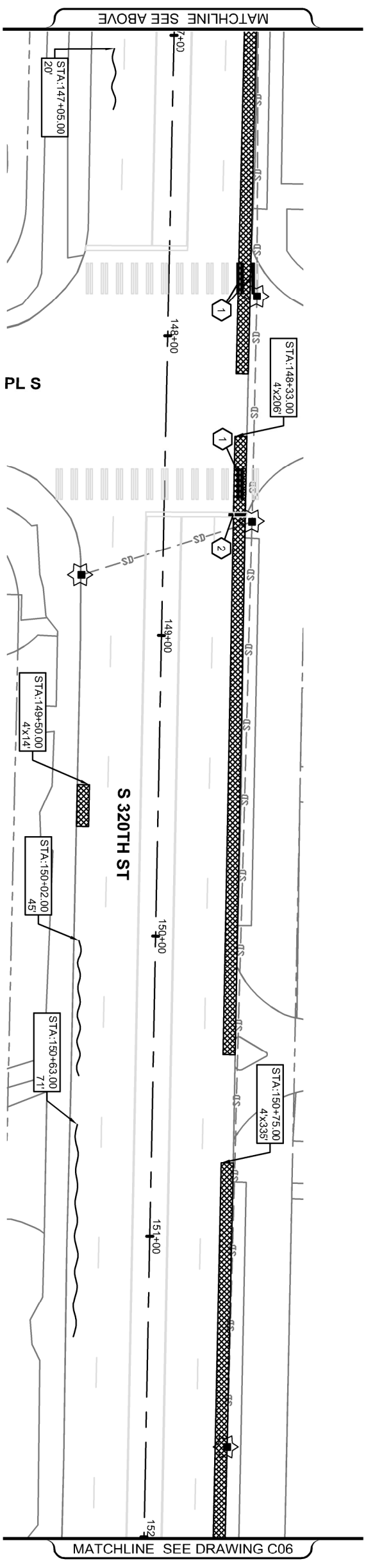

- LEGEND:**
- PAVEMENT REPAIR
 - CRACK SEALING
 - INLET PROTECTION INSERT



DRAFTED: J.HUYNH
 DESIGNED: J.HUYNH
 REVIEWED: S.HAMEL
 APPROVED: D.WINKLER

DRAWING VERSION / REVISION LOG

NO.	DATE	REVISION

2021 PAVEMENT REPAIR
 SITE PREPARATION/TESS PLAN
 STA 142+00 TO STA 152+00

CITY PROJECT #: 11212
 SHEET: C05
 15 OF 22

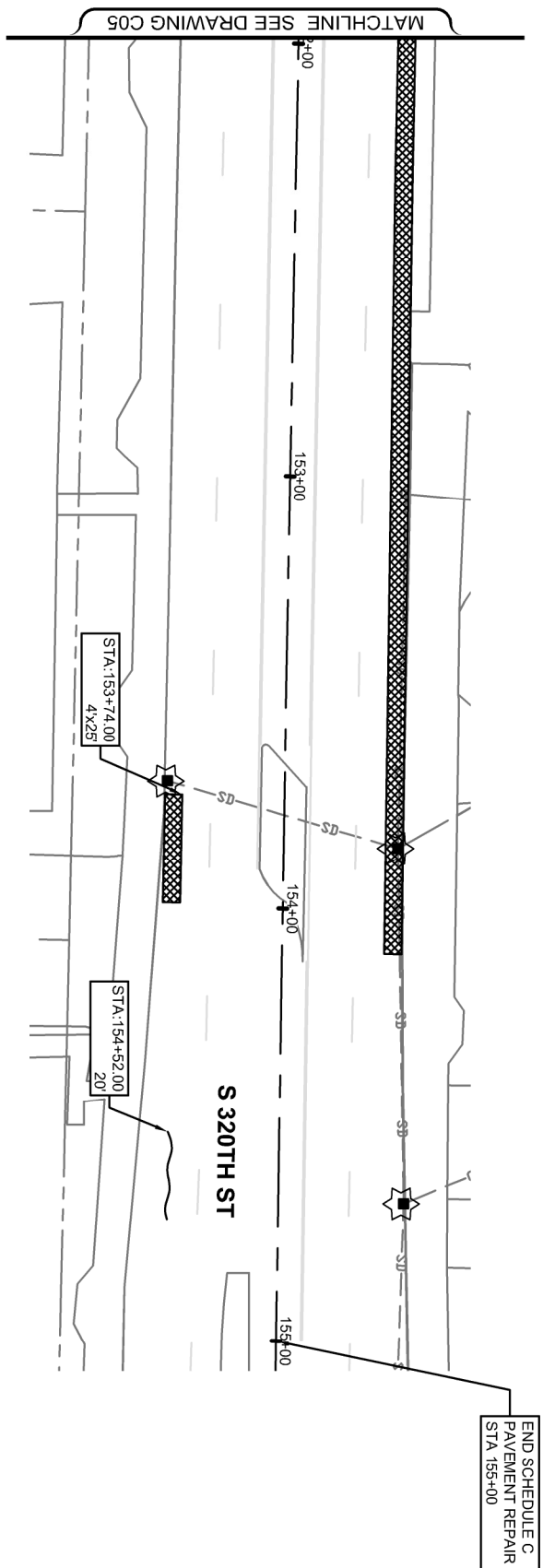

- CONSTRUCTION NOTES**
- 1 PLASTIC CROSSWALK LINE
 - 2 PLASTIC STOP LINE
 - 3 YIELD LINE SYMBOL

- LEGEND:**
- PAVEMENT REPAIR
 - CRACK SEALING
 - INLET PROTECTION INSERT



DRAFTED: J.HUYNH
 DESIGNED: J.HUYNH
 REVIEWED: S. HAMEL
 APPROVED: D.WINKLER



DRAWING VERSION / REVISION LOG

NO.	DATE	REVISION

2021 PAVEMENT REPAIR

SITE PREPARATION/TESS PLAN

STA 152+00 TO STA 155+00

CITY PROJECT #: 11212
 SHEET: C06
 16 OF 22

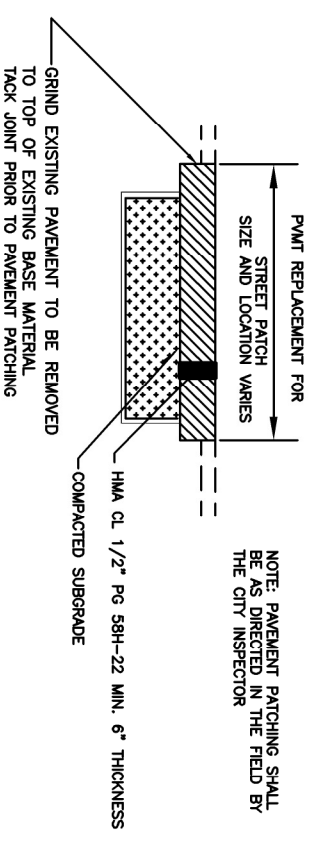
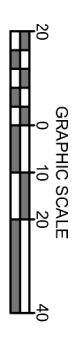

21ST AVE SW & SW/S 320TH ST PAVEMENT PATCHING DETAIL
NTS

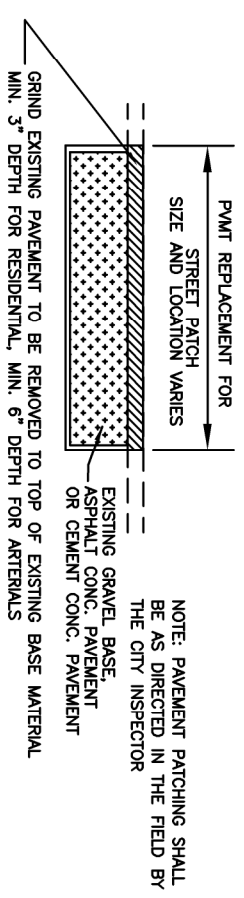

SIDE STREETS PAVEMENT PATCHING DETAILS



DRAFTED: J.HUYNH
DESIGNED: J.HUYNH
REVIEWED: S. HAMEL
APPROVED: D.WINKLER



DRAWING VERSION / REVISION LOG	
NO.	DATE / REVISION

2021 PAVEMENT REPAIR
PAVEMENT REPAIR DETAILS

CITY PROJECT #: 11212
SHEET: 17 OF 22
DETAILS

BUFFER DATA										
LONGITUDINAL BUFFER SPACE = B										
SPEED (MPH)	25	30	35	40	45	50	55	60	65	70
LENGTH (feet)	155	200	250	305	360	425	495	570	645	730
TRANSPORTABLE ATTENUATOR ROLL AHEAD DISTANCE = R										
HOST VEHICLE WEIGHT 9,900 TO 22,000 lbs.					HOST VEHICLE WEIGHT > 22,000 lbs.					
< 45 MPH	45-55 MPH	> 55 MPH	< 45 MPH	45-55 MPH	> 55 MPH	> 55 MPH	> 55 MPH	> 55 MPH	> 55 MPH	> 55 MPH
100'	123'	172'	74'	100'	150'	150'	150'	150'	150'	150'
PROTECTIVE VEHICLE (WORK VEHICLE) = R										
NO SPECIFIED DISTANCE REQUIRED										

SIGN SPACING = X (1)			
RURAL HIGHWAYS	60 / 65 MPH	800' ?	
RURAL ROADS	45 / 55 MPH	500' ?	
RURAL ROADS & URBAN ARTERIALS	35 / 40 MPH	350' ?	
RURAL ROADS, URBAN ARTERIALS, RESIDENTIAL & BUSINESS DISTRICTS	25 / 30 MPH	200' ? (2)	
URBAN STREETS	25 MPH OR LESS	100' ? (2)	

(1) ALL SPACING MAY BE ADJUSTED TO ACCOMMODATE INTERSECTIONS AND DRIVEWAYS.
(2) THIS SPACING MAY BE REDUCED IN URBAN AREAS TO FIT ROADWAY CONDITIONS.

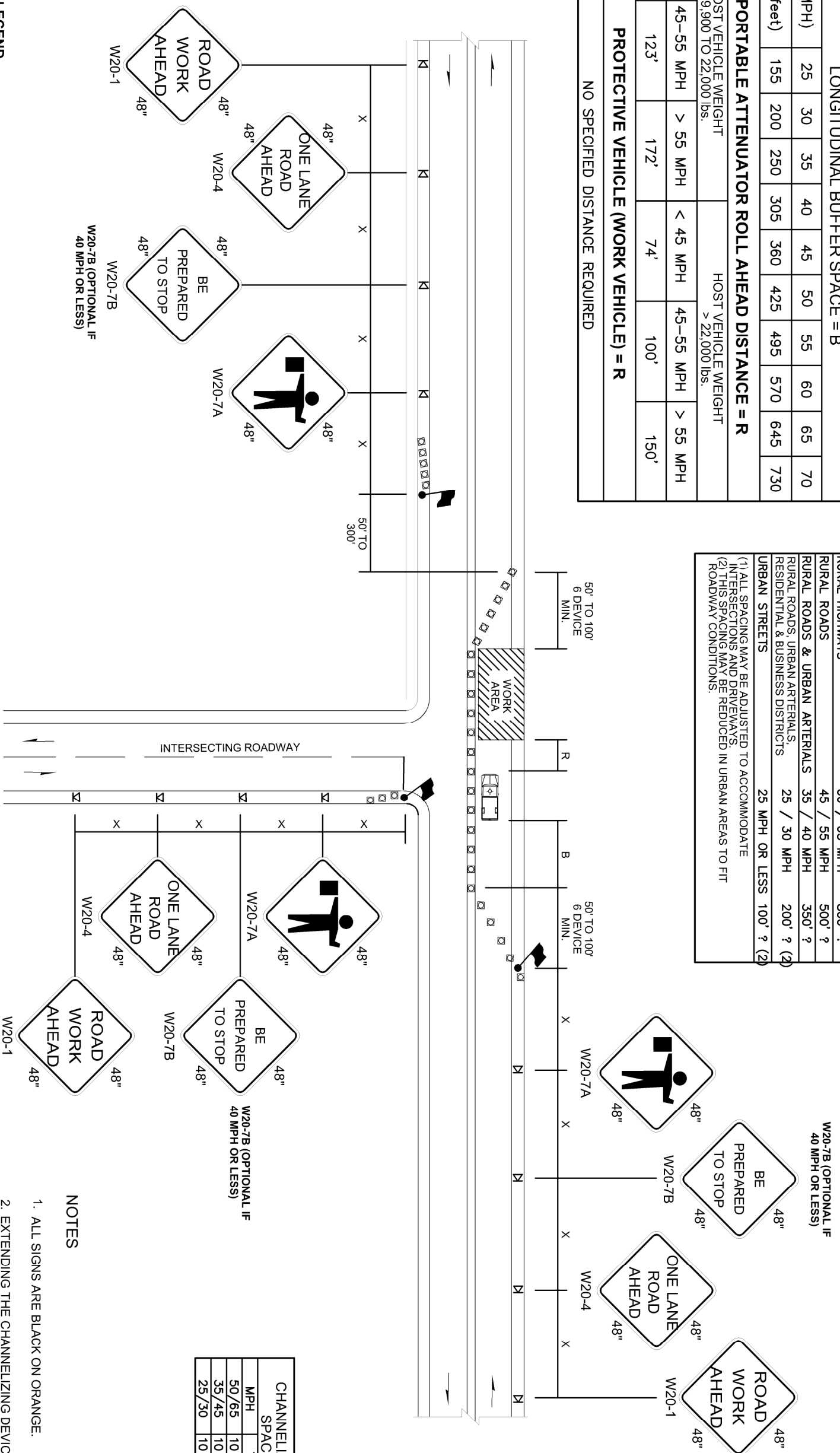

CHANNELIZATION DEVICE SPACING (FEET)			
MPH	TAPER	TANGENT	
50/65	10 TO 20	80	
35/45	10 TO 20	60	
25/30	10 TO 20	40	

NOTES

1. ALL SIGNS ARE BLACK ON ORANGE.
2. EXTENDING THE CHANNELIZING DEVICE TAPER ACROSS SHOULDER IS RECOMMENDED.
3. NIGHT WORK REQUIRES ADDITIONAL ROADWAY LIGHTING AT FLAGGING STATIONS. SEE THE **STANDARD SPECIFICATIONS** FOR ADDITIONAL DETAILS.
4. SEE **SPECIAL PROVISIONS** FOR WORK HOUR RESTRICTIONS.

- LEGEND**
- FLAGGING STATION
 - TEMPORARY SIGN LOCATION
 - CHANNELIZING DEVICES
 - PROTECTIVE VEHICLE



DRAFTED: J.HUVNH
DESIGNED: J.HUVNH
REVIEWED: S.HAMEL
APPROVED: D.WINKLER

DRAWING VERSION / REVISION LOG	
NO.	DATE / REVISION

2021 PAVEMENT REPAIR
ONE-LANE, TWO-WAY TRAFFIC CONTROL WITH FLAGGERS

MINIMUM TAPER LENGTH = L (feet)										
LANE WIDTH (feet)	Posted Speed (mph)									
	25	30	35	40	45	50	55	60	65	70
10	105	150	205	270	450	500	550	-	-	-
11	115	165	225	295	495	550	605	660	-	-
12	125	180	245	320	540	600	660	720	780	-

CHANNELIZATION DEVICE SPACING (feet)			
MPH	TAPER	TANGENT	
50/65	40	80	
35/45	30	60	
25/30	20	40	

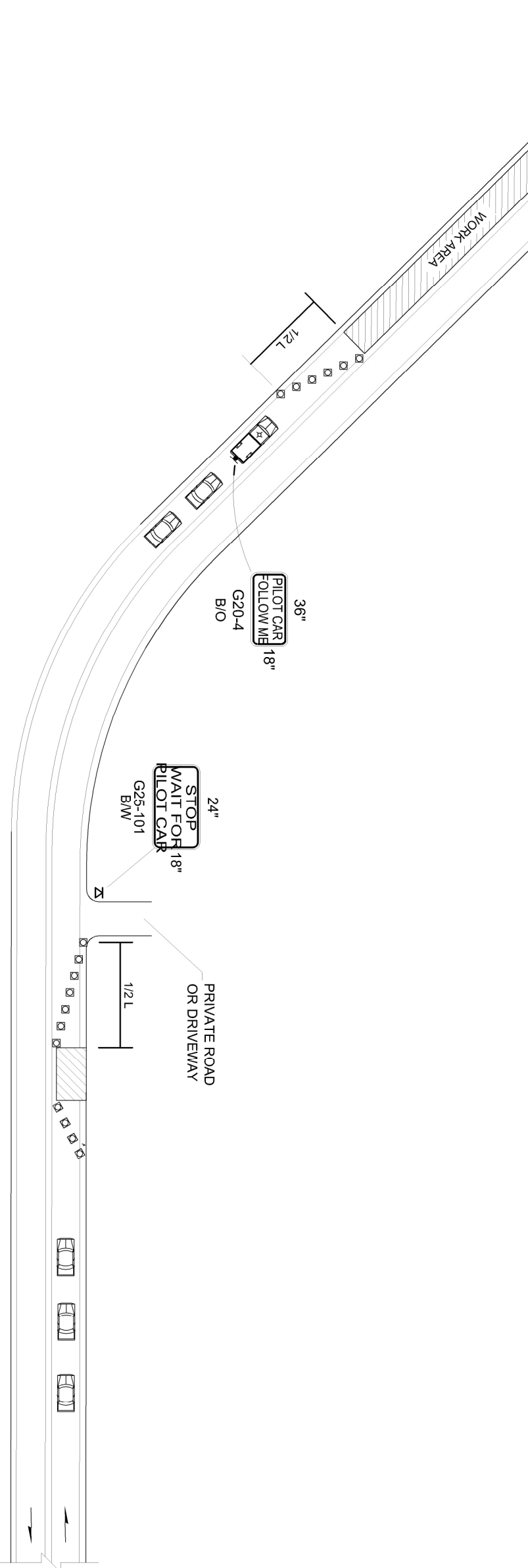

- LEGEND**
- FLAGGING STATION
 - TEMPORARY SIGN LOCATION
 - CHANNELIZING DEVICES
 - PILOT VEHICLE
 - MOTORIST VEHICLE

- NOTES**
1. REFER TO SHEET TC1 FOR ADDITIONAL SIGNING AND FLAGGING DETAILS NOT SHOWN.
 2. CHANNELIZING DEVICES ARE RECOMMENDED ALONG CENTERLINE TO SEPARATE TRAFFIC FROM WORK OPERATION. DEVICES ARE REQUIRED AT TAPERS TO SHIFT TRAFFIC MOVEMENT BETWEEN LANES AND TO PROTECT FLAGGING STATIONS.
 3. SIGN G25-101 IS RECOMMENDED FOR NON-STOP SIGN CONTROLLED APPROACHES SUCH AS PRIVATE ROADS AND DRIVEWAYS. THIS SIGN IS NOT REQUIRED TO BE ALUMINUM SUBSTRATE AND CAN BE MADE OF ALTERNATIVE MATERIALS.

CITY OF Federal Way
Centered on Opportunity
33325 8TH AVE S FEDERAL WAY, WA 98003
PHONE: (253) 836-2700
WWW.CITYOFFEDERALWAY.COM

Know what's below.
Call before you dig.

DRAFTED: J.HUYNH
DESIGNED: J.HUYNH
REVIEWED: S. HAMEL
APPROVED: D.WINKLER

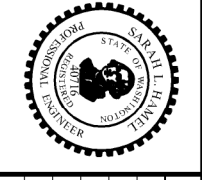

DRAWING VERSION / REVISION LOG		
NO.	DATE	REVISION

2021 PAVEMENT REPAIR

PILOT CAR OPERATION

MINIMUM LANE CLOSURE TAPER LENGTH = L (feet)												
LANE WIDTH (feet)	Posted Speed (mph)											
	25	30	35	40	45	50	55	60	65	70		
10	105	150	205	270	450	500	550	-	-	-	-	-
11	115	165	225	295	495	550	605	660	-	-	-	-
12	125	180	245	320	540	600	660	720	780	840	-	-

SIGN SPACING = X (1)			
FREeways & EXPRESSWAYS	55 / 70 MPH	1500' ?	
RURAL HIGHWAYS	60 / 65 MPH	800' ?	
RURAL ROADS	45 / 55 MPH	500' ?	
RURAL ROADS & URBAN ARTERIALS	35 / 40 MPH	350' ?	
RURAL ROADS & BUSINESS DISTRICTS	25 / 30 MPH	200' ? (2)	
URBAN STREETS	25 MPH OR LESS	100' ? (2)	

CHANNELIZATION DEVICE SPACING (feet)			
MPH	TAPER	TANGENT	
50/70	40	80	
35/45	30	60	
25/30	20	40	

BUFFER DATA										
LONGITUDINAL BUFFER SPACE = B										
SPEED (MPH)	25	30	35	40	45	50	55	60	65	70
LENGTH (feet)	155	200	250	305	360	425	495	570	645	730

MINIMUM SHOULDER TAPER LENGTH = L/3 (feet)												
SHOULDER WIDTH (feet)	Posted Speed (mph)											
	25	30	35	40	45	50	55	60	65	70		
8'	40	40	60	90	120	130	150	160	170	190		
10'	40	60	90	90	150	170	190	200	220	240		

USE A MINIMUM 3 DEVICES TAPER FOR SHOULDER LESS THEN 8'

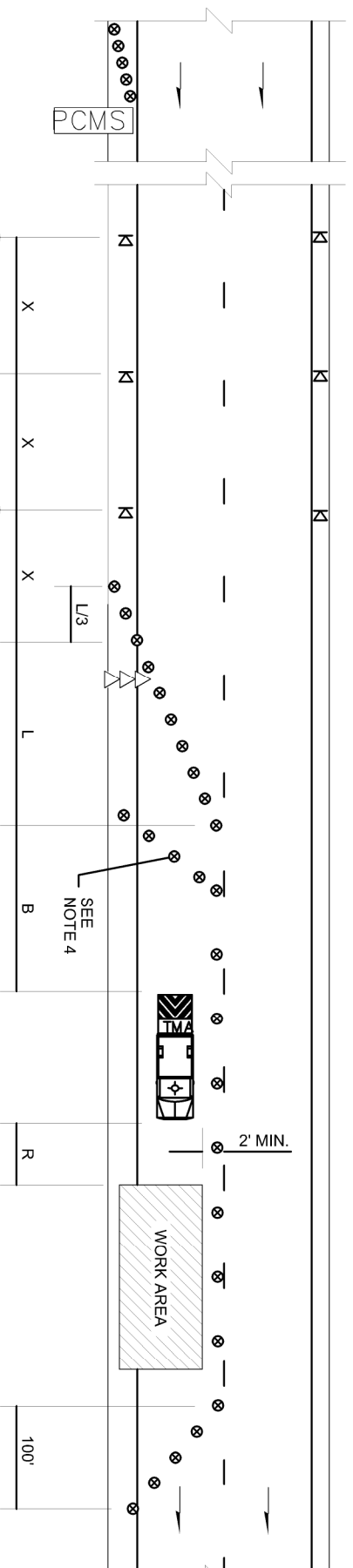

PCMS	
1	2
RIGHT LANE CLOSURE	1 MILE AHEAD
2.0 SEC	2.0 SEC

FIELD LOCATE 1 MILE IN ADVANCE OF LANE CLOSURE SIGNING.

- LEGEND**
- ⊠ TEMPORARY SIGN LOCATION
 - ⊙ TRAFFIC SAFETY DRUM
 - ⇨ SEQUENTIAL ARROW SIGN
 - ⇨ TRANSPORTABLE ATTENUATOR
 - PCMS PORTABLE CHANGEABLE MESSAGE SIGN

PCMS PORTABLE CHANGEABLE MESSAGE SIGN

NOTES

1. SEE SPECIAL PROVISIONS FOR WORK HOUR RESTRICTIONS.
2. EXTEND DEVICE TAPER AT L/3 ACROSS SHOULDER.
3. DEVICES SHALL NOT ENCRoACH INTO THE ADJACENT LANE.
4. USE TRANSVERSE DEVICES IN CLOSED LANE EVERY 1000' (FT) (RECOMMENDED).
5. DEVICE SPACING FOR THE DOWNSTREAM TAPER SHALL BE 20' (FT).
6. ALL SIGNS ARE BLACK ON ORANGE.

CITY OF Federal Way
Centered on Opportunity
33325 8TH AVENUE S FEDERAL WAY, WA 98003
PHONE: (253) 856-2700
WWW.CITYOFFEDERALWAY.COM

811
Know what's below.
Call before you dig.

DRAFTED: JHUYNH
DESIGNED: JHUYNH
REVIEWED: S. HAMEL
APPROVED: D. WINKLER



DRAWING VERSION / REVISION LOG		
NO.	DATE	REVISION

2021 PAVEMENT REPAIR

SINGLE-LANE CLOSURE FOR MULTI-LANE ROADWAYS

CITY PROJECT #: 11212
SHEET: TCP3
20 OF 22

MINIMUM LANE CLOSURE TAPER LENGTH = L (feet)										
LANE WIDTH (feet)	Posted Speed (mph)									
	25	30	35	40	45	50	55	60	65	70
10	105	150	205	270	450	500	550	-	-	-
11	115	165	225	295	495	550	605	660	-	-
12	125	180	245	320	540	600	660	720	780	840

SIGN SPACING = X (1)			
FREWAYS & EXPRESSWAYS	55 / 70 MPH	1500' ?	
RURAL HIGHWAYS	60 / 65 MPH	800' ?	
RURAL ROADS	45 / 55 MPH	500' ?	
RURAL ROADS & URBAN ARTERIALS	35 / 40 MPH	350' ?	
RURAL ROADS & URBAN ARTERIALS	25 / 30 MPH	200' ? (2)	
RESIDENTIAL & BUSINESS DISTRICTS			
URBAN STREETS	25 MPH OR LESS	100' ? (2)	

(1) ALL SPACING MAY BE ADJUSTED TO ACCOMMODATE INTERCHANGE RAMP AT-GRADE INTERSECTIONS AND DRIVEWAYS.
(2) THIS SPACING MAY BE REDUCED IN URBAN AREAS TO FIT ROADWAY CONDITIONS.

PCMS	1	2
2 LANES CLOSED AHEAD		WATCH FOR SLOW TRAFFIC
2.0 SEC		2.0 SEC

BUFFER DATA										
LONGITUDINAL BUFFER SPACE = B										
SPEED (MPH)	25	30	35	40	45	50	55	60	65	70
LENGTH (feet)	155	200	250	305	360	425	495	570	645	730

TRANSPORTABLE ATTENUATOR ROLL AHEAD DISTANCE = R					
HOST VEHICLE WEIGHT	HOST VEHICLE WEIGHT				
9,900 TO 22,000 lbs.	> 22,000 lbs.				
< 45 MPH	45-55 MPH	> 55 MPH	< 45 MPH	45-55 MPH	> 55 MPH
100'	123'	172'	74'	100'	150'

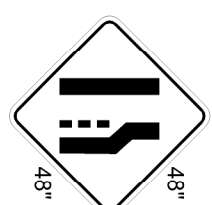

W4-2(L)

SEE NOTE 4

FIELD LOCATE 1 MILE IN ADVANCE OF LANE CLOSURE SIGNING.

CHANNELIZATION DEVICE SPACING (feet)			
MPH	TAPER	TANGENT	
50/70	40	80	
35/45	30	60	
25/30	20	40	

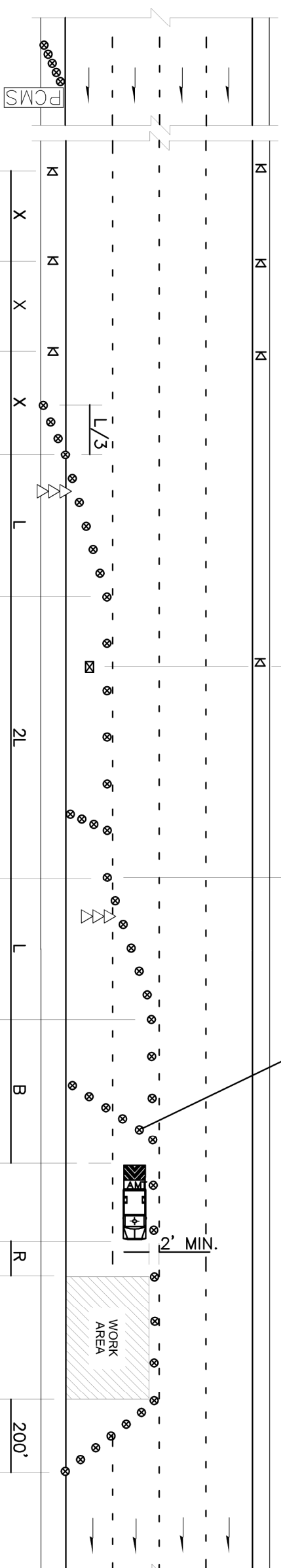

NOTES

1. SEE SPECIAL PROVISIONS FOR WORK HOUR RESTRICTIONS.
2. EXTEND DEVICE TAPER AT L/3 ACROSS SHOULDER.
3. DEVICES SHALL NOT ENCRUCH INTO THE ADJACENT LANES.
4. USE TRANSVERSE DEVICES IN CLOSED LANE EVERY 1000' (FT) (RECOMMENDED).
5. DEVICE SPACING FOR THE DOWNSTREAM TAPER SHALL BE 20' (FT).
6. ALL SIGNS ARE BLACK ON ORANGE.

- LEGEND**
- ⊙ TRAFFIC SAFETY DRUM
 - N TEMPORARY SIGN LOCATION
 - ⇨ SEQUENTIAL ARROW SIGN
 - ⇨⇨ TRANSPORTABLE ATTENUATOR
 - PCMS PORTABLE CHANGEABLE MESSAGE SIGN
 - ☒ TEMPORARY SIGN LOCATION (5' (FT) MOUNTING HEIGHT)

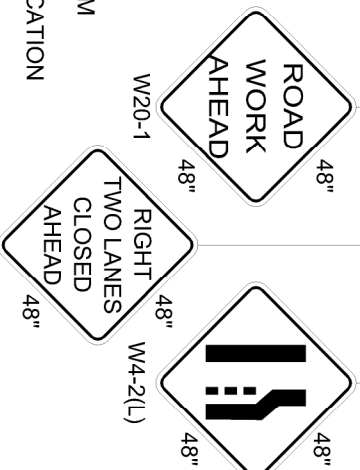

CITY OF Federal Way
Centered on Opportunity
33325 8TH AVE S FEDERAL WAY, WA 98003
PHONE: (253) 836-2700
WWW.CITYOFFEDERALWAY.COM

811
Know what's below.
Call before you dig.

DRAFTED: JHUYNH
DESIGNED: JHUYNH
REVIEWED: S. HAMEL
APPROVED: D. WINKLER

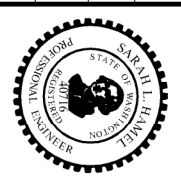

DRAWING VERSION / REVISION LOG	
NO.	DATE / REVISION

2021 PAVEMENT REPAIR

DOUBLE-LANE CLOSURE FOR MULT-LANE ROADWAYS

CITY PROJECT #: 11212
SHEET: TCP4
21 OF 22

CHANNELIZATION DEVICE SPACING (feet)			
MPH	TAPER	TANGENT	
50/70	40	80	
35/45	30	60	
25/30	20	40	

MINIMUM TAPER LENGTH = L (feet)												
LANE WIDTH (feet)	Posted Speed (mph)											
		25	30	35	40	45	50	55	60	65	70	
10	105	150	205	270	450	500	550	-	-	-		
11	115	165	225	295	495	550	605	660	-	-		
12	125	180	245	320	540	600	660	720	-	-		

BUFFER DATA													
LONGITUDINAL BUFFER SPACE = B													
SPEED (MPH)	25	30	35	40	45	50	55	60	65	70			
LENGTH (feet)	155	200	250	305	360	425	495	570	645	730			
TRANSPORTABLE ATTENUATOR ROLL AHEAD DISTANCE = R													
HOST VEHICLE WEIGHT 9,900 TO 22,000 lbs.						HOST VEHICLE WEIGHT > 22,000 lbs.							
< 45 MPH	45-55 MPH	> 55 MPH	< 45 MPH	45-55 MPH	> 55 MPH								
100'	123'	172'	74'	100'	150'								

PROTECTIVE VEHICLE (WORK VEHICLE) = R												
NO SPECIFIED DISTANCE REQUIRED												

SIGN SPACING = X (1)			
RURAL HIGHWAYS	60 / 65 MPH	800' ?	
RURAL ROADS	45 / 55 MPH	500' ?	
RURAL ROADS & URBAN ARTERIALS	35 / 40 MPH	350' ?	
RURAL ROADS & URBAN ARTERIALS	25 / 30 MPH	200' ? (2)	
RESIDENTIAL & BUSINESS DISTRICTS			
URBAN STREETS	25 MPH OR LESS	100' ? (2)	

(1) ALL SPACING MAY BE ADJUSTED TO ACCOMMODATE INTERCHANGE RAMP, AT-GRADE INTERSECTIONS AND DRIVEWAYS TO FIT
(2) THIS SPACING MAY BE REDUCED IN URBAN AREAS TO FIT ROADWAY CONDITIONS.

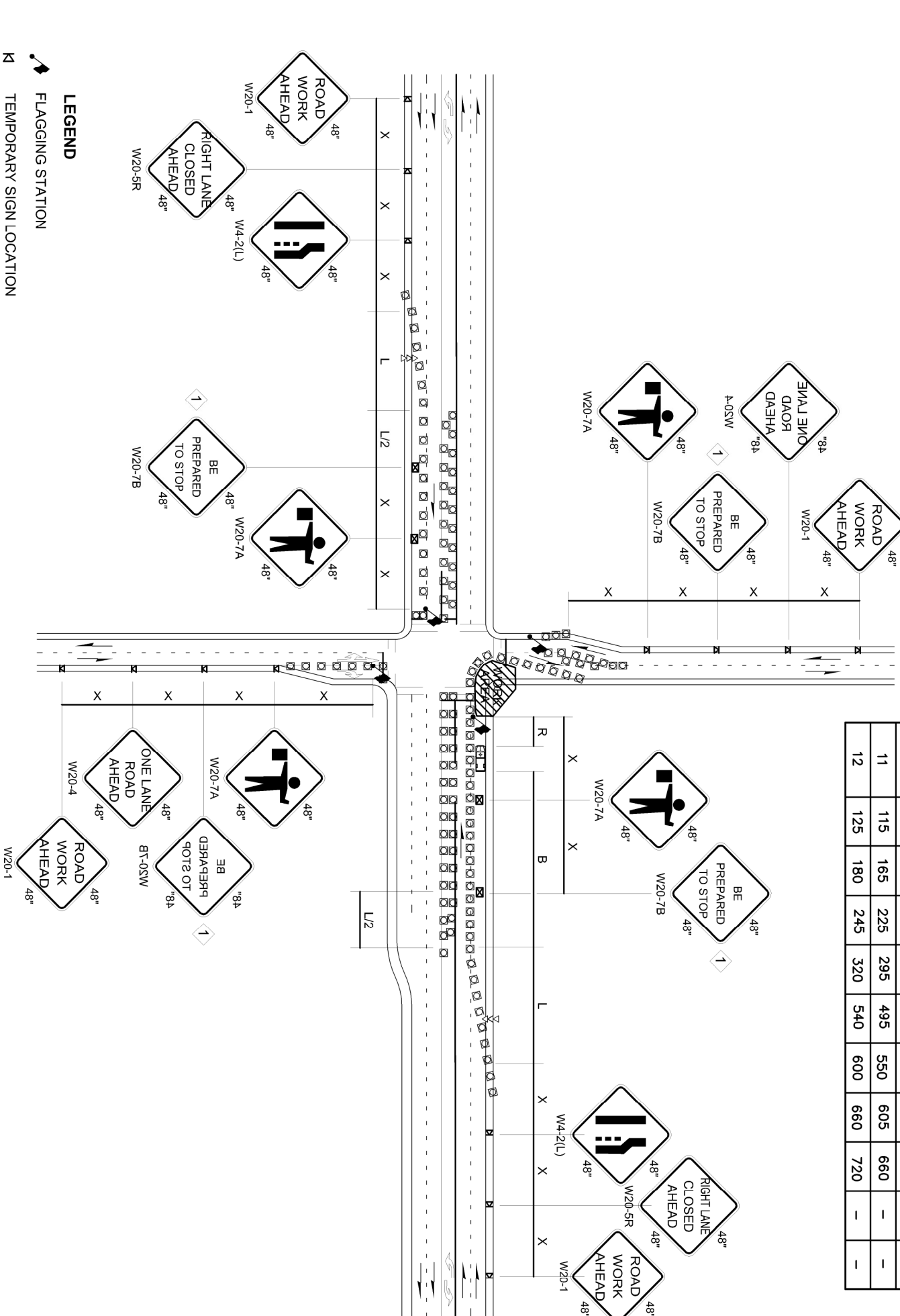

TC15
N.T.S.

INTERSECTION LANE CLOSURE - FIVE LANE ROADWAY

- NOTES
1. RECOMMEND EXTENDING DEVICE TAPER (L/3) ACROSS SHOULDER.
 2. IF A SIGNAL IS PRESENT, IT SHALL BE SET TO "RED FLASH MODE" OR TURNED OFF DURING FLAGGING OPERATIONS.
 3. MAINTAIN A MINIMUM OF ONE ACCESS POINT FOR EACH BUSINESS WITHIN WORK AREA LIMITS.
 4. ALL SIGNS ARE BLACK ON ORANGE.

- LEGEND
- FLAGGING STATION
 - TEMPORARY SIGN LOCATION
 - CHANNELIZING DEVICES
 - SEQUENTIAL ARROW SIGN
 - PROTECTIVE VEHICLE - RECOMMENDED
 - TEMPORARY SIGN LOCATION (5' MOUNTING HEIGHT)

CITY OF Federal Way
Centered on Opportunity
33325 8TH AVE S FEDERAL WAY, WA 98003
PHONE: (253) 836-2700
WWW.CITYOFFEDERALWAY.COM

811
Know what's below.
Call before you dig.

DRAFTED: JHUYNH
DESIGNED: JHUYNH
REVIEWED: S. HAMEL
APPROVED: D. WINKLER



DRAWING VERSION / REVISION LOG	
NO.	DATE / REVISION

2021 PAVEMENT REPAIR

INTERSECTION LANE CLOSURE - FIVE LANE ROADWAY

CITY PROJECT #: 11212
SHEET: TCP15
22 OF 22