

ADDENDUM NO. 1
LAKOTA MIDDLE SCHOOL
SW DASH POINT ROAD
SAFE ROUTES TO SCHOOL PROJECT
RFB# 21-003
PROJECT #204
FEDERAL AID #SRTS-9917(033)
November 29, 2021

ATTENTION ALL BIDDERS AND PLANHOLDERS: You are hereby notified that the Bid and Contract Documents are amended as follows:

A) CONTRACT DOCUMENTS

(1) Bid Checklist

Remove page RFB-06 through and replace with the attached page RFB-06. Removed Apprenticeship plan from checklist as there is no training requirement.

(2) Bid Proposal

Remove page RFB-8 through RFB-15 and replace with the attached page RFB-08 through RFB-15. Changed Bid Item No. A51 from BARRIER CURB to PEDESTRIAN CURB. There were two Bid Items No. A56. CEMENT CONC. SIDEWALK is now Bid Item A57. Bid Item Amount and Unit were switched on bid items in Schedule A and have been corrected.

(3) Special Provisions

Replace Section 8-20.3(5)A with the attached revised Special Provision allowing wires other than interconnect to be placed in interconnect conduit.

8-20.3(5)A General

(PROJECT-SPECIFIC SPECIAL PROVISION***)***

Section 8-20.3(5) is supplemented with the following:

All conduit trenches shall be straight and as narrow in width as is practical to provide a minimum of pavement disturbance.

When conduit risers are installed, they shall be attached to the pole every 4 feet and shall be equipped with weather heads.

Conduit for the service wires between the Puget Sound Energy pole and the service panel and all above ground conduit shall be hot-dip galvanized rigid steel.

All conduits shall be clearly labeled at each junction box, handhole, vault or other utility appurtenance. Labeling shall be permanent and shall consist of the owner/type name

and a unique conduit number or color. The owner name shall be approved by the Engineer prior to starting work. The recommended owner/type abbreviations are:

PSE – Puget Sound Energy

QWEST – Qwest

COMCAST(AT&T)/C – Cable

COMCAST(AT&T)/F – Fiber

SIC – City Signal Interconnect

City Spare – City spares

Cobra – COBRA luminaire system

Traffic signal interconnect shall be placed, wherever feasible, in the joint utility trench being constructed under this contract (if applicable). This work shall be coordinated with the other utilities to ensure a 2" minimum conduit is provided solely for the traffic signal interconnect (unless otherwise directed in the plans). Conduit size shall be verified with City Traffic Engineer prior to installation.

(4) Prevailing Wages and Benefit Code Key

Add the attached Benefit Code Key that was mistakenly omitted from the Bid package.

B) PLANS

Replace sheets 26-28 with the attached sheets 26-28. Typographical error in the Wire Notes changing 1-6 2CS(LOOP) to 1-2CS(LOOP).

Replace sheets 37-40 with the attached sheets 37-40. Added signature to all sheets and changed line type on sheet 38 (clouded).

C) BID OPENING

The bid opening date **has not** changed. All bidders are required to acknowledge receipt of this addendum on page RFB-12 of the Bid Form. Failure to do so may cause rejection of the bid.

CITY OF FEDERAL WAY



John Mulkey, P.E.

Senior Capital Engineer

(8) BIDDER'S CHECKLIST

The bidder's attention is especially called to the following forms, which must be executed in full as required. Failure to comply may result in rejection of any bid not so complying.

- Bid Proposal**: The Bid Proposal shall be completed and fully executed, including filling in the total bid amount.
- Bid Bond**: This form is to be executed by the bidder (and the surety company as appropriate, depending upon the option selected by the bidder).
- Subcontractor List**: The Subcontractor List shall be filled in by the bidder.
- Contractor Certification – Wage Law Compliance**: This form shall be filled in and fully executed by the bidder.
- Proposal for Incorporating Recycled Materials**: This form shall be filled in and executed by the bidder.
- UDBE Utilization Certification**: This form shall be filled in by the bidder.
- UDBE Written Confirmation**: Part A of this form shall be filled in by the bidder and Part B shall be signed by UDBE firm.

(9) CONTRACT CHECKLIST

The following documents are to be executed and delivered to the City after the Bid is awarded:

- Public Works Contract**: The successful bidder will fully execute and deliver to the City the Public Works Contract ("Contract") from these Bid Documents.
- Certificate of Insurance**: The successful bidder will provide a Certificate of Insurance evidencing the insurance requirement set forth in the Contract.
- Performance/Payment Bond**: The successful bidder will provide a fully executed Performance/Payment Bond as appropriate.
- Business License**: The successful bidder will provide a copy of a current Business License with the City of Federal Way.
- NPDES Transfer of Coverage Form**: The successful bidder will provide the filled-in Transfer of Coverage Form provided by the City.

NOTE: All entries shall be written in ink or typed. Unit prices for all items, all extensions, and total amount of bid shall be shown. Enter unit prices in numerical figures only, in dollars and cents to two (2) decimal places (including for whole dollar amounts). All figures must be clearly legible. Bids with illegible figures in the unit price column will be regarded as non-responsive. Where conflict occurs between the unit price and the total amount specified for any item, the unit price shall prevail, and totals shall be corrected to conform thereto. The Bidder shall complete this entire Bid Form or this bid may be considered non-responsive. The City may correct obvious mathematical errors. The City of Federal Way reserves the right to reject any and all bids, waive any informalities or minor irregularities in the bidding, and determine which bid or bidder meets the criteria set forth in the bid documents.

SCHEDULE A: ROADWAY IMPROVEMENTS						
<i>All unit prices shall include applicable sales tax (Roadway Improvements)</i>						
Item No.	Spec. Div.	Bid Item Description	Unit	Plan Qty	Unit Price	Amount
A01	1-04	MINOR CHANGE	FA	1	\$5,000.00	\$5,000.00
A02	1-05	ROADWAY SURVEYING	LS	1	\$	\$
A03	1-05	ADA FEATURES SURVEYING	LS	1	\$	\$
A04	1-05	AS-BUILT SURVEY AND RECORD DRAWINGS	LS	1	\$	\$
A05	1-07	SPCC PLAN	LS	1	\$	\$
A06	1-09	MOBILIZATION	LS	1	\$	\$
A07	1-10	TRAFFIC CONTROL SUPERVISOR	LS	1	\$	\$
A08	1-10	FLAGGERS	HR	1000	\$	\$
A09	1-10	OTHER TRAFFIC CONTROL LABOR	HR	1000	\$	\$
A10	1-10	CONSTRUCTION SIGNS CLASS A	SF	100	\$	\$
A11	1-10	SEQUENTIAL ARROW SIGN	HR	1280	\$	\$
A12	1-10	PORTABLE CHANGEABLE MESSAGE SIGN	HR	3840	\$	\$
A13	1-10	PROJECT TEMPORARY TRAFFIC CONTROL	LS	1	\$	\$
A14	2-01	CLEARING AND GRUBBING	LS	1	\$	\$
A15	2-01	ROADSIDE CLEANUP	FA	1	\$5,000.00	\$5,000.00
A16	2-02	REMOVAL OF STRUCTURES AND OBSTRUCTIONS	LS	1	\$	\$
A17	2-02	SAWCUTTING	LF	1575	\$	\$

CITY OF FEDERAL WAY

RFB-8
 CFW RFB VERSION 2020-JUN
 ADDENDUM 1

LAKOTA SRTS
PROJECT #204 / RFB #21-003

*** PLAN CENTER COPY *** Official bid documents, plan holder's list, and addenda (if applicable) are available on BXWA.com

A18	2-02	REMOVE DRAINAGE STRUCTURE	EA	6	\$	\$
A19	2-02	REMOVE STORM SEWER PIPE	LF	950	\$	\$
A20	2-03	ROADWAY EXCAVATION INCL. HAUL	CY	725	\$	\$
A21	2-03	GRAVEL BORROW INCL. HAUL	TN	725	\$	\$
A22	2-09	SHORING OR EXTRA EXCAVATION CLASS B	SF	4550	\$	\$
A23	2-09	STRUCTURE EXCAVATION CLASS B FOR RELOCATION OF UTILITIES	CY	210		
A24	4-04	CRUSHED SURFACING TOP COURSE	TN	140	\$	\$
A25	4-04	CRUSHED SURFACING BASE COURSE	TN	425	\$	\$
A26	5-04	HMA CL. 1/2 IN PG 58H-22	TN	550	\$	\$
A27	5-04	TEMPORARY PAVEMENT	TN	25	\$	\$
A28	7-04	HIGH DENSITY POLYETHYLENE (HDPE) PIPE 24 IN. DIAM.	LF	568	\$	\$
A29	7-04	DUCTILE IRON PIPE 24 IN. DIAM.	LF	235	\$	\$
A30	7-04	HIGH DENSITY POLYETHYLENE (HDPE) PIPE 12 IN. DIAM.	LF	6	\$	\$
A31	7-04	TESTING STORM SEWER PIPE	LF	809	\$	\$
A32	7-05	CATCH BASIN TYPE 1	EA	1	\$	\$
A33	7-05	CATCH BASIN TYPE 2 - 48 IN. DIAM.	EA	9	\$	\$
A34	7-05	ADJUST MANHOLE	EA	3	\$	\$
A35	7-05	INSTALL CONVERSION RISER AND ROUND SOLID COVER ON EXISTING TYPE 1 CB AND ADJUST TO GRADE	EA	1	\$	\$
A36	7-05	CONNECTION TO DRAINAGE STRUCTURE	EA	4	\$	\$
A37	8-01	ESC LEAD	DAY	110	\$	\$
A38	8-01	STORM WATER POLLUTION PREVENTION PLAN	LS	1	\$	\$
A39	8-01	EROSION CONTROL AND WATER POLLUTION PREVENTION	LS	1	\$	\$

CITY OF FEDERAL WAY

RFB-9

CFW RFB VERSION 2020-JUN
ADDENDUM 1

LAKOTA SRTS
PROJECT #204 / RFB #21-003

*** PLAN CENTER COPY *** Official bid documents, plan holder's list, and addenda (if applicable) are available on BXWA.com

A40	8-01	INLET PROTECTION	EA	22	\$	\$
A41	8-01	SILT FENCE	LF	850	\$	\$
A42	8-02	TOPSOIL TYPE A	CY	140	\$	\$
A43	8-02	SOD INSTALLATION	SY	470	\$	\$
A44	8-02	SEEDED LAWN INSTALLATION	SY	215	\$	\$
A45	8-02	BARK MULCH	CY	20	\$	\$
A46	8-02	ROOT BARRIER	LF	576	\$	\$
A47	8-02	PSIPE ACER X FREEMANII 'JEFFERSRED'/AUTUMN BLAZE MAPLE; 2.5" CAL., 12'-14' HT.	EA	24	\$	\$
A48	8-02	PROPERTY RESTORATION	FA	1	\$2,000.00	\$2,000.00
A49	8-03	CONTRACTOR DESIGNED AUTOMATIC IRRIGATION SYSTEM, COMPLETE	LS	1	\$	\$
A50	8-04	CEMENT CONC. CURB & GUTTER	LF	1180	\$	\$
A51	8-04	PEDESTRIAN CURB	LF	55	\$	\$
A52	8-04	EXTRUDED CURB, TYPE 6	LF	20	\$	\$
A53	8-07	PRECAST SLOPED MOUNTABLE CURB	LF	10	\$	\$
A54	8-07	PRECAST DUAL FACED SLOPED MOUNTABLE CURB	LF	195	\$	\$
A55	8-09	RAISED PAVEMENT MARKER, TYPE 2	HU ND	1.5	\$	\$
A56	8-09	RAISED PAVEMENT MARKER, TYPE 2B	EA	1	\$	\$
A57	8-14	CEMENT CONC SIDEWALK	SY	915	\$	\$
A58	8-14	CEMENT CONC CURB RAMP TYPE PARALLEL	EA	6	\$	\$
A59	8-14	CEMENT CONC CURB RAMP TYPE SINGLE DIRECTION	EA	3	\$	\$
A60	8-20	ILLUMINATION SYSTEM, COMPLETE	LS	1	\$	\$
A61	8-20	SCHOOL ZONE FLASHING BEACONS, COMPLETE	LS	1	\$	\$

CITY OF FEDERAL WAY

RFB-10

CFW RFB VERSION 2020-JUN
ADDENDUM 1

LAKOTA SRTS
PROJECT #204 / RFB #21-003

*** PLAN CENTER COPY *** Official bid documents, plan holder's list, and addenda (if applicable) are available on BXWA.com

A62	8-20	VARIABLE SPEED LIMIT SIGNS, COMPLETE	LS	1	\$	\$
A63	8-20	SIGNAL MODIFICATION, COMPLETE	LS	1	\$	\$
A64	8-20	VIDEO CAMERA DETECTORS, COMPLETE	LS	1	\$	\$
A65	8-21	PERMANENT SIGNING	LS	1	\$	\$
A66	8-22	PLASTIC LINE	LF	1880	\$	\$
A67	8-22	PROFILED PLASTIC LINE	LF	1815	\$	\$
A68	8-22	PROFILED PLASTIC WIDE LINE	LF	93	\$	\$
A69	8-22	PLASTIC CROSSWALK LINE	SF	320	\$	\$
A70	8-22	PLASTIC STOP LINE	LF	75	\$	\$
A71	8-22	PAINTED BICYCLE LANE SYMBOL	EA	4	\$	\$
A72	8-22	PLASTIC TRAFFIC ARROW	EA	5	\$	\$
A73	8-22	REMOVING PAVEMENT MARKINGS	LS	1S	\$	\$
A74	8-30	POTHOLING	FA	1	\$5,000.00	\$5,000.00
A75	8-31	RESOLUTION OF UTILITY CONFLICTS	FA	1	\$5,000.00	\$5,000.00
A76	8-32	PIT RUN SAND	CY	60	\$	\$
A77	8-32	PROVIDE AND INSTALL 2 IN. CONDUIT	LF	940	\$	\$
A78	8-32	JOINT TRENCH PROVIDE AND INSTALL WSDOT TYPE 1 JUNCTION BOX	EA	5	\$	\$
TOTAL – SCHEDULE A						\$

SCHEDULE B: LAKEHAVEN WATER IMPROVEMENTS

All unit prices shall NOT include applicable sales tax.

Sales tax should be applied to the subtotal for this bid schedule.

Item No.	Spec. Div.	Bid Item Description	Unit	Plan Qty	Unit Price	Amount
B01	1-07	PERMITS	LS	1	\$	\$

CITY OF FEDERAL WAY

RFB-11

CFW RFB VERSION 2020-JUN
ADDENDUM 1

**LAKOTA SRTS
PROJECT #204 / RFB #21-003**

B02	1-07	COVID 19 HEALTH AND SAFETY PLAN (CHSP)	LS	1	\$	\$
B03	1-07	COVID 19 ADDED MEASURES (WITHOUT OVERHEAD AND PROFIT)	EST	1	\$1,500.00	\$1,500.00
B04	2-01	SITE RESTORATION	LS	1	\$	\$
B05	2-01	REMOVAL OF STRUCTURES AND OBSTRUCTIONS	LS	1	\$	\$
B06	2-02	REMOVE WATER VALVE (8 IN., 12 IN.)	EA	3	\$	\$
B07	2-02	REMOVE AC WATER MAIN (8 IN., 12 IN.)	LF	1,070	\$	\$
B08	2-02	REMOVE DUCTILE IRON / CAST IRON WATER MAIN (8 IN.)	LF	10		
B09	2-02	REMOVE HYDRANT ASSEMBLY	EA	1	\$	\$
B10	2-09	TRENCH SAFETY SYSTEMS	LS	1	\$	\$
B11	2-09	SHORING OR EXTRA EXCAVATION CLASS B	SF	6,500	\$	\$
B12	5-04	TEMPORARY PAVEMENT	TN	20	\$	\$
B13	7-09	MINOR CHANGE FOR WATER IMPROVEMENTS	EST	1	\$14,000.00	\$14,000.00
B14	7-09	DUCTILE IRON PIPE FOR WATER MAIN, 8 IN. DIAM.	LF	35	\$	\$
B15	7-09	DUCTILE IRON PIPE FOR WATER MAIN, 12 IN. DIAM.	LF	1,050	\$	\$
B16	7-09	ADDITIONAL DUCTILE IRON FITTINGS	LB	225	\$	\$
B17	7-09	CONNECT TO EXISTING WATER MAIN, 8 IN. DIAM.	EA	2	\$	\$
B18	7-09	CONNECT TO EXISTING WATER MAIN, 12 IN. DIAM.	EA	2	\$	\$
B19	7-09	REMOVAL AND REPLACEMENT OF UNSUITABLE FOUNDATION MATERIAL	CY	10	\$	\$
B20	7-09	CRUSHED SURFACING TOP COURSE FOR TRENCH BACKFILL	CY	500	\$	\$
B21	710	CONSTRUCTION SEQUENCING	LS	1	\$	\$
B22	7-12	GATE VALVE, 8 IN.	EA	2	\$	\$
B23	7-12	GATE VALVE, 12 IN.	EA	5	\$	\$

CITY OF FEDERAL WAY

RFB-12

CFW RFB VERSION 2020-JUN
ADDENDUM 1

LAKOTA SRTS
PROJECT #204 / RFB #21-003

*** PLAN CENTER COPY *** Official bid documents, plan holder's list, and addenda (if applicable) are available on BXWA.com

B24	7-14	HYDRANT ASSEMBLY	EA	2	\$	\$
B25	7-15	SERVICE REPLACEMENT (METER, 1.5 IN.)	EA	1	\$	\$
B26	7-15	SERVICE REPLACEMENT (IRRIGATION, 2 IN.)	EA	1	\$	\$
B27	8-31	UTILITY POTHOLE	EA	13	\$	\$
B28	8-31	RESOLUTION OF UTILITY CONFLICTS	FA	1	\$5,000.00	\$5,000.00
SUBTOTAL – SCHEDULE B						\$
SALES TAX (10.1%)						\$
TOTAL – SCHEDULE B						\$

SCHEDULE C: PARK IMPROVEMENTS						
<i>All unit prices shall NOT include applicable sales tax. Sales tax should be applied to the subtotal for this bid schedule.</i>						
Item No.	Spec. Div.	Bid Item Description	Unit	Plan Qty	Unit Price	Amount
C01	1-04	UNEXPECTED SITE CHANGES	FA	1	\$5,000.00	\$5,000.00
C02	2-01	CONSTRUCTION SURVEYING	LS	1	\$	\$
C03	2-02	REMOVAL OF STRUCTURES AND OBSTRUCTIONS	LS	1	\$	\$
C04	2-02	REMOVE STORM SEWER PIPE	LF	58	\$	\$
C05	2-02	SAWCUTTING	LF	275	\$	\$
C06	4-04	CRUSHED SURFACING TOP COURSE	TN	55	\$	\$
C07	5-04	ROADWAY EXCAVATION INCL. HAUL	CY	30	\$	\$
C08	5-04	PLANING BITUMINOUS PAVEMENT	SY	1,750	\$	\$
C09	5-04	HMA CL. 1/2 IN PG 58H-22	TN	200	\$	\$
C10	7-04	HIGH DENSITY POLYETHYLENE (HDPE) PIPE 12 IN. DIAM.	LF	134	\$	\$
C11	7-04	TESTING STORM SEWER PIPE	LF	134	\$	\$

CITY OF FEDERAL WAY

RFB-13
CFW RFB VERSION 2020-JUN
ADDENDUM 1

LAKOTA SRTS
PROJECT #204 / RFB #21-003

*** PLAN CENTER COPY *** Official bid documents, plan holder's list, and addenda (if applicable) are available on BXWA.com

C12	7-04	CATCH BASIN TYPE 1	EA	3	\$	\$
C13	8-07	WHEEL STOP	EA	39	\$	\$
C14	8-22	PAINT LINE	LF	1,100	\$	\$
C15	8-22	PLASTIC ACCESS PARKING SPACE SYMBOL	EA	2	\$	\$
C16	8-30	BOLLARDS	EA	8	\$	\$
SUBTOTAL – SCHEDULE C						\$
SALES TAX (10.1%)						\$
TOTAL – SCHEDULE C						\$

SCHEDULE D: VERIZON RELOCATION						
<i>All unit prices shall include applicable sales tax (Roadway Improvements)</i>						
Item No.	Spec. Div.	Bid Item Description	Unit	Plan Qty	Unit Price	Amount
D01	1-04	MINOR CHANGES	FA	1	\$1,000.00	\$1,000.00
D02	8-32	INSTALL CONDUIT 2 IN.	LF	400	\$	\$
D03	8-32	RELOCATE VAULT	LS	1	\$	\$
D04	8-32	EXCAVATION FOR INTERCEPTING VERIZON CONDUIT	FA	1	\$2,000.00	\$2,000.00
TOTAL – SCHEDULE D						\$

BID SUMMARY	
ITEM	BID AMOUNT
SCHEDULE A: ROADWAY IMPROVEMENTS	\$
SCHEDULE B: LAKEHAVEN WATER IMPROVEMENTS	\$

CITY OF FEDERAL WAY

RFB-14
CFW RFB VERSION 2020-JUN
ADDENDUM 1

LAKOTA SRTS
PROJECT #204 / RFB #21-003

SCHEDULE C: PARK IMPROVEMENTS	\$
SCHEDULE D: VERIZON RELOCATION	\$
TOTAL BID AMOUNT <i>(including Washington State sales tax, all other government taxes, assessments and charges)</i>	\$

The documents incorporated by reference, as if fully set forth, are the Advertisement for Bids, the Instructions to Bidders and Checklists, the Contractor's Bid Proposal (including all forms and supplemental information listed on the Bidders Checklist), the Contract Documents (including Project Plans, Specifications, and all Appendices, Amendments, and Supplemental Reports & Information), the Contract Provisions (including all forms and supplemental information listed on the Contract Checklist), the version of the Washington State Standard Specifications for Road, Bridge, and Municipal Construction identified herein, and any other documents provided to bidders and/or referenced in or referred to by the Contract Documents.

Pursuant to and in compliance with the Advertisement for Bids for the Project, and other documents relating thereto, the undersigned has carefully examined all of the bid and contract documents, considered conditions which may affect the delivery, supply and maintenance for the Project, and hereby proposes to furnish all labor, materials and perform all work as required in strict accordance with the contract documents, for the referenced bid amount, inclusive of Washington State sales tax and all other government taxes, assessments and charges as required by law.

NON-COLLUSION AFFIDAVIT

By signing this proposal, the undersigned acknowledges that the person(s), firm, association, or corporation has (have) not, either directly or indirectly, entered into any agreement, participated in any collusion, or otherwise taken any action in restraint of free competitive bidding in connection with this project.

To report rigging activities, call 1-800-424-9071. The U.S. Department of Transportation (USDOT) operates the toll-free hotline Monday through Friday, 8:00 a.m. to 5:00 p.m., Eastern Time. Anyone with knowledge of possible bid rigging, bidder collusion, or other fraudulent activities should use the hotline to report such activities. The hotline is part of USDOT's continuing effort to identify and investigate highway construction contract fraud and abuse and is operated under the direction of the USDOT Inspector General. All information will be treated confidentially and caller anonymity will be respected.

CONFLICTS OF INTEREST, GRATUITIES, & NON-COMPETITIVE PRACTICES

By signing this proposal, the undersigned agrees as follows:

- (1) That it has no direct or indirect pecuniary or proprietary interest, that it shall not acquire any interest which conflicts in any manner or degree with the work, services, equipment or materials required to be performed and/or provided under this contract and that it shall not employ any person or agent having any such interests. In the event that the Contractor or its agents, employees or representatives hereafter acquires such a conflict of interest, it shall immediately disclose such interest to the City and take action immediately to eliminate the conflict or to withdraw from this contract, as the City may require; and
- (2) That no person or selling agency except bona fide employees or designated agents or representatives of the Contractor have been employed or retained to solicit or secure this contract with an agreement or understanding that a commission, percentage, brokerage, or contingent fee would be paid; and

That no gratuities in the form of entertainment, gifts or otherwise, were offered or given by the Contractor or any of its agents, employees or representatives, to any official, member or employee of the City or other governmental agency with a view toward securing this contract or securing favorable

Benefit Code Key – Effective 9/1/2021 thru 3/2/2022

Overtime Codes

Overtime calculations are based on the hourly rate actually paid to the worker. On public works projects, the hourly rate must be not less than the prevailing rate of wage minus the hourly rate of the cost of fringe benefits actually provided for the worker.

1. ALL HOURS WORKED IN EXCESS OF EIGHT (8) HOURS PER DAY OR FORTY (40) HOURS PER WEEK SHALL BE PAID AT ONE AND ONE-HALF TIMES THE HOURLY RATE OF WAGE.
 - B. All hours worked on Saturdays shall be paid at one and one-half times the hourly rate of wage. All hours worked on Sundays and holidays shall be paid at double the hourly rate of wage.
 - C. The first two (2) hours after eight (8) regular hours Monday through Friday and the first ten (10) hours on Saturday shall be paid at one and one-half times the hourly rate of wage. All other overtime hours and all hours worked on Sundays and holidays shall be paid at double the hourly rate of wage.
 - D. The first two (2) hours before or after a five-eight (8) hour workweek day or a four-ten (10) hour workweek day and the first eight (8) hours worked the next day after either workweek shall be paid at one and one-half times the hourly rate of wage. All additional hours worked and all worked on Sundays and holidays shall be paid at double the hourly rate of wage.
 - E. The first two (2) hours after eight (8) regular hours Monday through Friday and the first eight (8) hours on Saturday shall be paid at one and one-half times the hourly rate of wage. All other hours worked Monday through Saturday, and all hours worked on Sundays and holidays shall be paid at double the hourly rate of wage.
 - F. The first two (2) hours after eight (8) regular hours Monday through Friday and the first ten (10) hours on Saturday shall be paid at one and one-half times the hourly rate of wage. All other overtime hours worked, except Labor Day, shall be paid at double the hourly rate of wage. All hours worked on Labor Day shall be paid at three times the hourly rate of wage.
 - G. The first ten (10) hours worked on Saturdays and the first ten (10) hours worked on a fifth calendar weekday in a four-ten hour schedule, shall be paid at one and one-half times the hourly rate of wage. All hours worked in excess of ten (10) hours per day Monday through Saturday and all hours worked on Sundays and holidays shall be paid at double the hourly rate of wage.
 - H. All hours worked on Saturdays (except makeup days if work is lost due to inclement weather conditions or equipment breakdown) shall be paid at one and one-half times the hourly rate of wage. All hours worked Monday through Saturday over twelve (12) hours and all hours worked on Sundays and holidays shall be paid at double the hourly rate of wage.
 - I. All hours worked on Sundays and holidays shall also be paid at double the hourly rate of wage.
 - J. The first two (2) hours after eight (8) regular hours Monday through Friday and the first ten (10) hours on Saturday shall be paid at one and one-half times the hourly rate of wage. All hours worked over ten (10) hours Monday through Saturday, Sundays and holidays shall be paid at double the hourly rate of wage.
 - K. All hours worked on Saturdays and Sundays shall be paid at one and one-half times the hourly rate of wage. All hours worked on holidays shall be paid at double the hourly rate of wage.
 - M. All hours worked on Saturdays (except makeup days if work is lost due to inclement weather conditions) shall be paid at one and one-half times the hourly rate of wage. All hours worked on Sundays and holidays shall be paid at double the hourly rate of wage.
 - N. All hours worked on Saturdays (except makeup days) shall be paid at one and one-half times the hourly rate of wage. All hours worked on Sundays and holidays shall be paid at double the hourly rate of wage.

Overtime Codes Continued

1. O. The first ten (10) hours worked on Saturday shall be paid at one and one-half times the hourly rate of wage. All hours worked on Sundays, holidays and after twelve (12) hours, Monday through Friday and after ten (10) hours on Saturday shall be paid at double the hourly rate of wage.
- P. All hours worked on Saturdays (except makeup days if circumstances warrant) and Sundays shall be paid at one and one-half times the hourly rate of wage. All hours worked on holidays shall be paid at double the hourly rate of wage.
- Q. The first two (2) hours after eight (8) regular hours Monday through Friday and up to ten (10) hours worked on Saturdays shall be paid at one and one-half times the hourly rate of wage. All hours worked in excess of ten (10) hours per day Monday through Saturday and all hours worked on Sundays and holidays (except Christmas day) shall be paid at double the hourly rate of wage. All hours worked on Christmas day shall be paid at two and one-half times the hourly rate of wage.
- R. All hours worked on Sundays and holidays shall be paid at two times the hourly rate of wage.
- U. All hours worked on Saturdays shall be paid at one and one-half times the hourly rate of wage. All hours worked on Sundays and holidays (except Labor Day) shall be paid at two times the hourly rate of wage. All hours worked on Labor Day shall be paid at three times the hourly rate of wage.
- V. All hours worked on Sundays and holidays (except Thanksgiving Day and Christmas day) shall be paid at one and one-half times the hourly rate of wage. All hours worked on Thanksgiving Day and Christmas day shall be paid at double the hourly rate of wage.
- W. All hours worked on Saturdays and Sundays (except make-up days due to conditions beyond the control of the employer)) shall be paid at one and one-half times the hourly rate of wage. All hours worked on holidays shall be paid at double the hourly rate of wage.
- X. The first four (4) hours after eight (8) regular hours Monday through Friday and the first twelve (12) hours on Saturday shall be paid at one and one-half times the hourly rate of wage. All hours worked over twelve (12) hours Monday through Saturday, Sundays and holidays shall be paid at double the hourly rate of wage. When holiday falls on Saturday or Sunday, the day before Saturday, Friday, and the day after Sunday, Monday, shall be considered the holiday and all work performed shall be paid at double the hourly rate of wage.
- Y. All hours worked outside the hours of 5:00 am and 5:00 pm (or such other hours as may be agreed upon by any employer and the employee) and all hours worked in excess of eight (8) hours per day (10 hours per day for a 4 x 10 workweek) and on Saturdays and holidays (except labor day) shall be paid at one and one-half times the hourly rate of wage. (except for employees who are absent from work without prior approval on a scheduled workday during the workweek shall be paid at the straight-time rate until they have worked 8 hours in a day (10 in a 4 x 10 workweek) or 40 hours during that workweek.) All hours worked Monday through Saturday over twelve (12) hours and all hours worked on Sundays and Labor Day shall be paid at double the hourly rate of wage.
- Z. All hours worked on Saturdays and Sundays shall be paid at one and one-half times the hourly rate of wage. All hours worked on holidays shall be paid the straight time rate of pay in addition to holiday pay.

Overtime Codes Continued

2. ALL HOURS WORKED IN EXCESS OF EIGHT (8) HOURS PER DAY OR FORTY (40) HOURS PER WEEK SHALL BE PAID AT ONE AND ONE-HALF TIMES THE HOURLY RATE OF WAGE.

- B. All hours worked on holidays shall be paid at one and one-half times the hourly rate of wage.
- F. The first eight (8) hours worked on holidays shall be paid at the straight hourly rate of wage in addition to the holiday pay. All hours worked in excess of eight (8) hours on holidays shall be paid at double the hourly rate of wage.
- M. This code appears to be missing. All hours worked on Saturdays, Sundays and holidays shall be paid at double the hourly rate of wage.
- O. All hours worked on Sundays and holidays shall be paid at one and one-half times the hourly rate of wage.
- R. All hours worked on Sundays and holidays and all hours worked over sixty (60) in one week shall be paid at double the hourly rate of wage.
- U. All hours worked on Saturdays shall be paid at one and one-half times the hourly rate of wage. All hours worked over 12 hours in a day or on Sundays and holidays shall be paid at double the hourly rate of wage.

3. ALL HOURS WORKED IN EXCESS OF EIGHT (8) HOURS PER DAY OR FORTY (40) HOURS PER WEEK SHALL BE PAID AT ONE AND ONE-HALF TIMES THE HOURLY RATE OF WAGE.

- F. All hours worked on Saturday shall be paid at one and one-half times the hourly rate of wage. All hours worked on Sunday shall be paid at two times the hourly rate of wage. All hours worked on paid holidays shall be paid at two and one-half times the hourly rate of wage including holiday pay.
- H. All work performed on Sundays between March 16th and October 14th and all Holidays shall be compensated for at two (2) times the regular rate of pay. Work performed on Sundays between October 15th and March 15th shall be compensated at one and one half (1-1/2) times the regular rate of pay.
- J. All hours worked between the hours of 10:00 pm and 5:00 am, Monday through Friday, and all hours worked on Saturdays shall be paid at a one and one-half times the hourly rate of wage. All hours worked on Sundays and holidays shall be paid at double the hourly rate of wage.
- K. Work performed in excess of eight (8) hours of straight time per day, or ten (10) hours of straight time per day when four ten (10) hour shifts are established, or forty (40) hours of straight time per week, Monday through Friday, or outside the normal 5 am to 6pm shift, and all work on Saturdays shall be paid at one and one-half times the hourly rate of wage. All work performed after 6:00 pm Saturday to 5:00 am Monday and Holidays, and all hours worked in excess of twelve (12) hours in a single shift shall be paid at double the hourly rate of wage.

After an employee has worked eight (8) hours at an applicable overtime rate, all additional hours shall be at the applicable overtime rate until such time as the employee has had a break of eight (8) hours or more. When an employee returns to work without at least eight (8) hours time off since their previous shift, all such time shall be a continuation of shift and paid at the applicable overtime rate until he/she shall have the eight (8) hours rest period.

4. ALL HOURS WORKED IN EXCESS OF EIGHT (8) HOURS PER DAY OR FORTY (40) HOURS PER WEEK SHALL BE PAID AT ONE AND ONE-HALF TIMES THE HOURLY RATE OF WAGE.

- A. All hours worked in excess of eight (8) hours per day or forty (40) hours per week shall be paid at double the hourly rate of wage. All hours worked on Saturdays, Sundays and holidays shall be paid at double the hourly rate of wage.

Overtime Codes Continued

4. C. On Monday through Friday, the first four (4) hours of overtime after eight (8) hours of straight time work shall be paid at one and one half (1-1/2) times the straight time rate of pay, unless a four (4) day ten (10) hour workweek has been established. On a four (4) day ten (10) hour workweek scheduled Monday through Thursday, or Tuesday through Friday, the first two (2) hours of overtime after ten (10) hours of straight time work shall be paid at one and one half (1-1/2) times the straight time rate of pay. On Saturday, the first twelve (12) hours of work shall be paid at one and one half (1-1/2) times the straight time rate of pay, except that if the job is down on Monday through Friday due to weather conditions or other conditions outside the control of the employer, the first ten (10) hours on Saturday may be worked at the straight time rate of pay. All hours worked over twelve (12) hours in a day and all hours worked on Sunday and Holidays shall be paid at two (2) times the straight time rate of pay.

D. All hours worked in excess of eight (8) hours per day or forty (40) hours per week shall be paid at double the hourly rate of wage. All hours worked on Saturday, Sundays and holidays shall be paid at double the hourly rate of pay. Rates include all members of the assigned crew.

EXCEPTION:

On all multipole structures and steel transmission lines, switching stations, regulating, capacitor stations, generating plants, industrial plants, associated installations and substations, except those substations whose primary function is to feed a distribution system, will be paid overtime under the following rates:

The first two (2) hours after eight (8) regular hours Monday through Friday of overtime on a regular workday, shall be paid at one and one-half times the hourly rate of wage. All hours in excess of ten (10) hours will be at two (2) times the hourly rate of wage. The first eight (8) hours worked on Saturday will be paid at one and one-half (1-1/2) times the hourly rate of wage. All hours worked in excess of eight (8) hours on Saturday, and all hours worked on Sundays and holidays will be at the double the hourly rate of wage.

All overtime eligible hours performed on the above described work that is energized, shall be paid at the double the hourly rate of wage.

E. The first two (2) hours after eight (8) regular hours Monday through Friday and the first eight (8) hours on Saturday shall be paid at one and one-half times the hourly rate of wage. All other hours worked Monday through Saturday, and all hours worked on Sundays and holidays shall be paid at double the hourly rate of wage.

On a four-day, ten-hour weekly schedule, either Monday thru Thursday or Tuesday thru Friday schedule, all hours worked after ten shall be paid at double the hourly rate of wage. The Monday or Friday not utilized in the normal four-day, ten hour work week, and Saturday shall be paid at one and one half (1½) times the regular shift rate for the first eight (8) hours. All other hours worked Monday through Saturday, and all hours worked on Sundays and holidays shall be paid at double the hourly rate of wage.

G. All hours worked on Saturdays shall be paid at one and one-half times the hourly rate of wage. All hours worked Monday through Saturday over twelve (12) hours and all hours worked on Sundays and holidays shall be paid at double the hourly rate of wage.

I. The First eight (8) hours worked on Saturdays shall be paid at one and one-half times the hourly rate of wage. All hours worked in excess of eight (8) per day on Saturdays shall be paid at double the hourly rate of wage. All hours worked on Sundays and holidays shall be paid at double the hourly rate of wage.

Overtime Codes Continued

4. J. The first eight (8) hours worked on a Saturday shall be paid at one and one-half times the hourly rate of wage. All hours worked in excess of eight (8) hours on a Saturday shall be paid at double the hourly rate of wage. All hours worked over twelve (12) in a day, and all hours worked on Sundays and Holidays shall be paid at double the hourly rate of wage.
- K. All hours worked on a Saturday shall be paid at one and one-half times the hourly rate of wage, so long as Saturday is the sixth consecutive day worked. All hours worked over twelve (12) in a day Monday through Saturday, and all hours worked on Sundays and Holidays shall be paid at double the hourly rate of wage.
- L. The first twelve (12) hours worked on a Saturday shall be paid at one and one-half times the hourly rate of wage. All hours worked on a Saturday in excess of twelve (12) hours shall be paid at double the hourly rate of pay. All hours worked over twelve (12) in a day Monday through Friday, and all hours worked on Sundays shall be paid at double the hourly rate of wage. All hours worked on a holiday shall be paid at one and one-half times the hourly rate of wage, except that all hours worked on Labor Day shall be paid at double the hourly rate of pay.
- U. The first four (4) hours after eight (8) regular hours Monday through Friday and the first twelve (12) hours on Saturday shall be paid at one and one-half times the hourly rate of wage. (Except on makeup days if work is lost due to inclement weather, then the first eight (8) hours on Saturday may be paid the regular rate.) All hours worked over twelve (12) hours Monday through Saturday, and all hours worked on Sundays and holidays shall be paid at double the hourly rate of wage.
- V. Work performed in excess of ten (10) hours of straight time per day when four ten (10) hour shifts are established or outside the normal shift (5 am to 6pm), and all work on Saturdays, except for make-up days shall be paid at time and one-half (1 ½) the straight time rate.

In the event the job is down due to weather conditions, then Saturday may, be worked as a voluntary make-up day at the straight time rate. However, Saturday shall not be utilized as a make-up day when a holiday falls on Friday. All work performed on Sundays and holidays and work in excess of twelve (12) hours per day shall be paid at double (2x) the straight time rate of pay.

After an employee has worked eight (8) hours at an applicable overtime rate, all additional hours shall be at the applicable overtime rate until such time as the employee has had a break of eight (8) hours.

When an employee returns to work without a break of eight (8) hours since their previous shift, all such time shall be a continuation of shift and paid at the applicable overtime rate until such time as the employee has had a break of eight (8) hours.

- W. All hours worked on Saturdays (except makeup days if work is lost due to inclement weather conditions) shall be paid at one and one-half times the hourly rate of wage. All hours worked on Sundays and holidays shall be paid at double the hourly rate of wage.

When an employee returns to work without at least eight (8) hours time off since their previous shift, all such time shall be a continuation of shift and paid at the applicable overtime rate until such time as the employee has had a break of eight (8) hours.

Overtime Codes Continued

4. X. All hours worked on Saturdays shall be paid at one and one-half times the hourly rate of wage. All hours worked on Sundays and holidays shall be paid at double the hourly rate of wage. Work performed outside the normal shift of 6 am to 6pm shall be paid at one and one-half the straight time rate, (except for special shifts or three shift operations). All work performed on Sundays and holidays shall be paid at double the hourly rate of wage. Shifts may be established when considered necessary by the Employer.

The Employer may establish shifts consisting of eight (8) or ten (10) hours of work (subject to WAC 296-127-022), that shall constitute a normal forty (40) hour work week. The Employer can change from a 5-eight to a 4-ten hour schedule or back to the other. All hours of work on these shifts shall be paid for at the straight time hourly rate. Work performed in excess of eight hours (or ten hours per day (subject to WAC 296-127-022) shall be paid at one and one-half the straight time rate.

When due to conditions beyond the control of the Employer, or when contract specifications require that work can only be performed outside the regular day shift, then by mutual agreement a special shift may be worked at the straight time rate, eight (8) hours work for eight (8) hours pay. The starting time shall be arranged to fit such conditions of work.

When an employee returns to work without at a break of eight (8) hours since their previous shift, all such time shall be a continuation of shift and paid at the applicable overtime rate until such time as the employee has had a break of eight (8) hours.

- Y. Work performed in excess of eight (8) hours of straight time per day, or ten (10) hours of straight time per day when four ten (10) hour shifts are established, or forty (40) hours of straight time per week, Monday through Friday, or outside the normal shift, and all work on Saturdays shall be paid at time and one-half the straight time rate. All work performed after 6:00 pm Saturday to 6:00 am Monday and holidays shall be paid at double the straight time rate of pay.

Any shift starting between the hours of 6:00 pm and midnight shall receive an additional one dollar (\$1.00) per hour for all hours worked that shift.

After an employee has worked eight (8) hours at an applicable overtime rate, all additional hours shall be at the applicable overtime rate until such time as the employee has had a break of eight (8) hours or more.

- Z. All hours worked between the hours of 6:00 pm and 6:00 am, Monday through Saturday, shall be paid at a premium rate of 20% over the hourly rate of wage. Work performed on Sundays may be paid at double time. All hours worked on holidays shall be paid at double the hourly rate of wage.

11. ALL HOURS WORKED IN EXCESS OF EIGHT (8) HOURS PER DAY OR FORTY (40) HOURS PER WEEK SHALL BE PAID AT ONE AND ONE-HALF TIMES THE HOURLY RATE OF WAGE.

- B After an employee has worked eight (8) hours, all additional hours worked shall be paid at the applicable overtime rate until such time as the employee has had a break of eight (8) hours or more.

- C The first two (2) hours after eight (8) regular hours Monday through Friday and the first eight (8) hours on Saturday shall be paid at one and one-half times the hourly rate of wage. All other overtime hours worked, except Labor Day, and all hours on Sunday shall be paid at double the hourly rate of wage. All hours worked on Labor Day shall be paid at three times the hourly rate of wage. All non-overtime and non-holiday hours worked between 4:00 pm and 5:00 am, Monday through Friday, shall be paid at a premium rate of 15% over the hourly rate of wage.

Benefit Code Key – Effective 9/1/2021 thru 3/2/2022

- D. All hours worked on Saturdays and holidays shall be paid at one and one-half times the hourly rate of wage. All hours worked on Sundays shall be paid at double the hourly rate of wage.

After an employee has worked eight (8) hours, all additional hours worked shall be paid at the applicable overtime rate until such time as the employee has had a break of eight (8) hours or more.

- E. The first two (2) hours after eight (8) regular hours Monday through Friday, the first ten (10) hours on Saturday, and the first ten (10) hours worked on Holidays shall be paid at one and one-half times the hourly rate of wage. All hours worked over ten (10) hours Monday through Saturday, and Sundays shall be paid at double the hourly rate of wage.

After an employee has worked eight (8) hours, all additional hours worked shall be paid at the applicable overtime rate until such time as the employee has had a break of eight (8) hours or more.

Holiday Codes

5. A. Holidays: New Year's Day, Memorial Day, Independence Day, Labor Day, Thanksgiving Day, Friday after Thanksgiving Day, and Christmas Day (7).
- B. Holidays: New Year's Day, Memorial Day, Independence Day, Labor Day, Thanksgiving Day, Friday after Thanksgiving Day, the day before Christmas, and Christmas Day (8).
- C. Holidays: New Year's Day, Presidents' Day, Memorial Day, Independence Day, Labor Day, Thanksgiving Day, the Friday after Thanksgiving Day, And Christmas Day (8).
- D. Holidays: New Year's Day, Memorial Day, Independence Day, Labor Day, Thanksgiving Day, the Friday and Saturday after Thanksgiving Day, And Christmas Day (8).
- H. Holidays: New Year's Day, Memorial Day, Independence Day, Thanksgiving Day, the Day after Thanksgiving Day, And Christmas (6).
- I. Holidays: New Year's Day, Memorial Day, Independence Day, Labor Day, Thanksgiving Day, and Christmas Day (6).
- J. Holidays: New Year's Day, Memorial Day, Independence Day, Thanksgiving Day, Friday after Thanksgiving Day, Christmas Eve Day, And Christmas Day (7).
- K. Holidays: New Year's Day, Presidents' Day, Memorial Day, Independence Day, Labor Day, Thanksgiving Day, Friday After Thanksgiving Day, The Day Before Christmas, And Christmas Day (9).
- L. Holidays: New Year's Day, Martin Luther King Jr. Day, Memorial Day, Independence Day, Labor Day, Thanksgiving Day, Friday after Thanksgiving Day, And Christmas Day (8).
- N. Holidays: New Year's Day, Presidents' Day, Memorial Day, Independence Day, Labor Day, Veterans' Day, Thanksgiving Day, The Friday After Thanksgiving Day, And Christmas Day (9).
- P. Holidays: New Year's Day, Memorial Day, Independence Day, Labor Day, Thanksgiving Day, Friday And Saturday After Thanksgiving Day, The Day Before Christmas, And Christmas Day (9). If A Holiday Falls On Sunday, The Following Monday Shall Be Considered As A Holiday.
- Q. Paid Holidays: New Year's Day, Memorial Day, Independence Day, Labor Day, Thanksgiving Day, and Christmas Day (6).

Holiday Codes Continued

- R. Paid Holidays: New Year's Day, Memorial Day, Independence Day, Labor Day, Thanksgiving Day, Day After Thanksgiving Day, One-Half Day Before Christmas Day, And Christmas Day. (7 1/2).
 - S. Paid Holidays: New Year's Day, Presidents' Day, Memorial Day, Independence Day, Labor Day, Thanksgiving Day, And Christmas Day (7).
 - Z. Holidays: New Year's Day, Memorial Day, Independence Day, Labor Day, Veterans Day, Thanksgiving Day, the Friday after Thanksgiving Day, And Christmas Day (8).
- 6.
- G. Paid Holidays: New Year's Day, Martin Luther King Jr. Day, Presidents' Day, Memorial Day, Independence Day, Labor Day, Veterans' Day, Thanksgiving Day, the Friday after Thanksgiving Day, Christmas Day, and Christmas Eve Day (11).
 - H. Paid Holidays: New Year's Day, New Year's Eve Day, Memorial Day, Independence Day, Labor Day, Thanksgiving Day, Friday After Thanksgiving Day, Christmas Day, The Day After Christmas, And A Floating Holiday (10).
 - T. Paid Holidays: New Year's Day, Presidents' Day, Memorial Day, Independence Day, Labor Day, Thanksgiving Day, The Friday After Thanksgiving Day, The Last Working Day Before Christmas Day, And Christmas Day (9).
 - Z. Holidays: New Year's Day, Memorial Day, Independence Day, Labor Day, Thanksgiving Day, Friday after Thanksgiving Day, And Christmas Day (7). If a holiday falls on Saturday, the preceding Friday shall be considered as the holiday. If a holiday falls on Sunday, the following Monday shall be considered as the holiday.
- 7.
- A. Holidays: New Year's Day, Memorial Day, Independence Day, Labor Day, Thanksgiving Day, the Friday and Saturday after Thanksgiving Day, And Christmas Day (8). Any Holiday Which Falls On A Sunday Shall Be Observed As A Holiday On The Following Monday. If any of the listed holidays falls on a Saturday, the preceding Friday shall be a regular work day.
 - B. Holidays: New Year's Day, Memorial Day, Independence Day, Labor Day, Thanksgiving Day, the Friday and Saturday after Thanksgiving Day, And Christmas Day (8). Any holiday which falls on a Sunday shall be observed as a holiday on the following Monday. Any holiday which falls on a Saturday shall be observed as a holiday on the preceding Friday.
 - C. Holidays: New Year's Day, Martin Luther King Jr. Day, Memorial Day, Independence Day, Labor Day, Thanksgiving Day, the Friday after Thanksgiving Day, And Christmas Day (8). Any holiday which falls on a Sunday shall be observed as a holiday on the following Monday. Any holiday which falls on a Saturday shall be observed as a holiday on the preceding Friday.
 - D. Paid Holidays: New Year's Day, Memorial Day, Independence Day, Labor Day, Veteran's Day, Thanksgiving Day, the Friday after Thanksgiving Day, And Christmas Day (8). Unpaid Holidays: President's Day. Any paid holiday which falls on a Sunday shall be observed as a holiday on the following Monday. Any paid holiday which falls on a Saturday shall be observed as a holiday on the preceding Friday.
 - E. Holidays: New Year's Day, Memorial Day, Independence Day, Labor Day, Thanksgiving Day, the Friday after Thanksgiving Day, And Christmas Day (7). Any holiday which falls on a Sunday shall be observed as a holiday on the following Monday. Any holiday which falls on a Saturday shall be observed as a holiday on the preceding Friday.

Holiday Codes Continued

7. F. Holidays: New Year's Day, Memorial Day, Independence Day, Labor Day, Thanksgiving Day, the Friday after Thanksgiving Day, the last working day before Christmas day and Christmas day (8). Any holiday which falls on a Sunday shall be observed as a holiday on the following Monday. Any holiday which falls on a Saturday shall be observed as a holiday on the preceding Friday.
- G. Holidays: New Year's Day, Memorial Day, Independence Day, Labor Day, Thanksgiving Day, and Christmas Day (6). Any holiday which falls on a Sunday shall be observed as a holiday on the following Monday.
- H. Holidays: New Year's Day, Martin Luther King Jr. Day, Independence Day, Memorial Day, Labor Day, Thanksgiving Day, the Friday after Thanksgiving Day, the Last Working Day before Christmas Day and Christmas Day (9). Any holiday which falls on a Sunday shall be observed as a holiday on the following Monday. Any holiday which falls on a Saturday shall be observed as a holiday on the preceding Friday.
- I. Holidays: New Year's Day, President's Day, Independence Day, Memorial Day, Labor Day, Thanksgiving Day, The Friday After Thanksgiving Day, The Day Before Christmas Day And Christmas Day (9). Any holiday which falls on a Sunday shall be observed as a holiday on the following Monday. Any holiday which falls on a Saturday shall be observed as a holiday on the preceding Friday.
- J. Holidays: New Year's Day, Independence Day, Memorial Day, Labor Day, Thanksgiving Day and Christmas Day (6). Any holiday which falls on a Sunday shall be observed as a holiday on the following Monday. Any holiday which falls on a Saturday shall be observed as a holiday on the preceding Friday.
- K. Holidays: New Year's Day, Memorial Day, Independence Day, Thanksgiving Day, the Friday and Saturday after Thanksgiving Day, And Christmas Day (8). Any holiday which falls on a Sunday shall be observed as a holiday on the following Monday. Any holiday which falls on a Saturday shall be observed as a holiday on the preceding Friday.
- L. Holidays: New Year's Day, Memorial Day, Labor Day, Independence Day, Thanksgiving Day, the Last Work Day before Christmas Day, And Christmas Day (7). Any holiday which falls on a Sunday shall be observed as a holiday on the following Monday. Any holiday which falls on a Saturday shall be observed as a holiday on the preceding Friday.
- N. Holidays: New Year's Day, Memorial Day, Independence Day, Labor Day, Thanksgiving Day, the Friday after Thanksgiving Day, And Christmas Day (7). Any holiday which falls on a Sunday shall be observed as a holiday on the following Monday. When Christmas falls on a Saturday, the preceding Friday shall be observed as a holiday.
- P. Holidays: New Year's Day, Memorial Day, Independence Day, Labor Day, Thanksgiving Day, Friday after Thanksgiving Day, And Christmas Day (7). Any holiday which falls on a Sunday shall be observed as a holiday on the following Monday.
- Q. Holidays: New Year's Day, Memorial Day, Independence Day, Labor Day, Thanksgiving Day, the Friday after Thanksgiving Day, the Last Working Day before Christmas Day and Christmas Day (8). Any holiday which falls on a Sunday shall be observed as a holiday on the following Monday. If any of the listed holidays falls on a Saturday, the preceding Friday shall be a regular work day.
- S. Paid Holidays: New Year's Day, Memorial Day, Independence Day, Labor Day, Thanksgiving Day, Friday after Thanksgiving Day, Christmas Day, the Day after Christmas, and A Floating Holiday (9). If any of the listed holidays falls on a Sunday, the day observed by the Nation shall be considered a holiday and compensated accordingly.
- V. Holidays: New Year's Day, President's Birthday, Memorial Day, Independence Day, Labor Day, Thanksgiving Day, the Friday after Thanksgiving Day, Christmas Day, the day before or after Christmas, and the day before or after New Year's Day. If any of the above listed holidays falls on a Sunday, the day observed by the Nation shall be considered a holiday and compensated accordingly.

Holiday Codes Continued

7. W. Holidays: New Year's Day, Day After New Year's, Memorial Day, Independence Day, Labor Day, Thanksgiving Day, the Friday after Thanksgiving Day, Christmas Eve Day, Christmas Day, the day after Christmas, the day before New Year's Day, and a Floating Holiday.
- X. Holidays: New Year's Day, Day before or after New Year's Day, Presidents' Day, Memorial Day, Independence Day, Labor Day, Thanksgiving Day, the Friday after Thanksgiving Day, Christmas Day, and the day before or after Christmas day. If a holiday falls on a Saturday or on a Friday that is the normal day off, then the holiday will be taken on the last normal workday. If the holiday falls on a Monday that is the normal day off or on a Sunday, then the holiday will be taken on the next normal workday.
- Y. Holidays: New Year's Day, Presidents' Day, Memorial Day, Independence Day, Labor Day, Thanksgiving Day, the Friday after Thanksgiving Day, and Christmas Day. (8) If the holiday falls on a Sunday, then the day observed by the federal government shall be considered a holiday and compensated accordingly.
- G. New Year's Day, Washington's Birthday, Memorial Day, Independence Day, Labor Day, Thanksgiving Day, The Friday After Thanksgiving Day, the last scheduled workday before Christmas, and Christmas Day (9). If any of the listed holidays falls on a Sunday, the day observed by the Nation shall be considered a holiday and compensated accordingly.
- H. Holidays: New Year's Day, Martin Luther King Jr. Day, Independence Day, Memorial Day, Labor Day, Thanksgiving Day, the Friday after Thanksgiving Day, the Last Working Day before Christmas Day and Christmas Day (9). Any holiday which falls on a Sunday shall be observed as a holiday on the following Monday. Any holiday which falls on a Saturday shall be observed as a holiday on the preceding Friday.
- I. Holidays: New Year's Day, President's Day, Independence Day, Memorial Day, Labor Day, Thanksgiving Day, The Friday After Thanksgiving Day, The Day Before Christmas Day And Christmas Day (9). Any holiday which falls on a Sunday shall be observed as a holiday on the following Monday. Any holiday which falls on a Saturday shall be observed as a holiday on the preceding Friday.
- J. Holidays: New Year's Day, Independence Day, Memorial Day, Labor Day, Thanksgiving Day and Christmas Day (6). Any holiday which falls on a Sunday shall be observed as a holiday on the following Monday. Any holiday which falls on a Saturday shall be observed as a holiday on the preceding Friday.
- K. Holidays: New Year's Day, Memorial Day, Independence Day, Thanksgiving Day, the Friday and Saturday after Thanksgiving Day, And Christmas Day (8). Any holiday which falls on a Sunday shall be observed as a holiday on the following Monday. Any holiday which falls on a Saturday shall be observed as a holiday on the preceding Friday.
- L. Holidays: New Year's Day, Memorial Day, Labor Day, Independence Day, Thanksgiving Day, the Last Work Day before Christmas Day, And Christmas Day (7). Any holiday which falls on a Sunday shall be observed as a holiday on the following Monday. Any holiday which falls on a Saturday shall be observed as a holiday on the preceding Friday.
- N. Holidays: New Year's Day, Memorial Day, Independence Day, Labor Day, Thanksgiving Day, the Friday after Thanksgiving Day, And Christmas Day (7). Any holiday which falls on a Sunday shall be observed as a holiday on the following Monday. When Christmas falls on a Saturday, the preceding Friday shall be observed as a holiday.
- P. Holidays: New Year's Day, Memorial Day, Independence Day, Labor Day, Thanksgiving Day, Friday after Thanksgiving Day, And Christmas Day (7). Any holiday which falls on a Sunday shall be observed as a holiday on the following Monday.

Holiday Codes Continued

7. Q. Holidays: New Year's Day, Memorial Day, Independence Day, Labor Day, Thanksgiving Day, the Friday after Thanksgiving Day, the Last Working Day before Christmas Day and Christmas Day (8). Any holiday which falls on a Sunday shall be observed as a holiday on the following Monday. If any of the listed holidays falls on a Saturday, the preceding Friday shall be a regular work day.
- S. Paid Holidays: New Year's Day, Memorial Day, Independence Day, Labor Day, Thanksgiving Day, Friday after Thanksgiving Day, Christmas Day, the Day after Christmas, and A Floating Holiday (9). If any of the listed holidays falls on a Sunday, the day observed by the Nation shall be considered a holiday and compensated accordingly.
- V. Holidays: New Year's Day, President's Birthday, Memorial Day, Independence Day, Labor Day, Thanksgiving Day, the Friday after Thanksgiving Day, Christmas Day, the day before or after Christmas, and the day before or after New Year's Day. If any of the above listed holidays falls on a Sunday, the day observed by the Nation shall be considered a holiday and compensated accordingly.
- W. Holidays: New Year's Day, Day After New Year's, Memorial Day, Independence Day, Labor Day, Thanksgiving Day, the Friday after Thanksgiving Day, Christmas Eve Day, Christmas Day, the day after Christmas, the day before New Year's Day, and a Floating Holiday.
- X. Holidays: New Year's Day, Day before or after New Year's Day, Presidents' Day, Memorial Day, Independence Day, Labor Day, Thanksgiving Day, the Friday after Thanksgiving Day, Christmas Day, and the day before or after Christmas day. If a holiday falls on a Saturday or on a Friday that is the normal day off, then the holiday will be taken on the last normal workday. If the holiday falls on a Monday that is the normal day off or on a Sunday, then the holiday will be taken on the next normal workday.
- Y. Holidays: New Year's Day, Presidents' Day, Memorial Day, Independence Day, Labor Day, Thanksgiving Day, the Friday after Thanksgiving Day, and Christmas Day. (8) If the holiday falls on a Sunday, then the day observed by the federal government shall be considered a holiday and compensated accordingly.
15. G. New Year's Day, Washington's Birthday, Memorial Day, Independence Day, Labor Day, Thanksgiving Day, The Friday After Thanksgiving Day, the last scheduled workday before Christmas, and Christmas Day (9). If any of the listed holidays falls on a Sunday, the day observed by the Nation shall be considered a holiday and compensated accordingly.
- H. Holidays: New Year's Day, Memorial Day, Independence Day, Labor Day, Thanksgiving Day, Friday after Thanksgiving Day, Christmas Eve Day, and Christmas Day (8). When the following holidays fall on a Saturday (New Year's Day, Independence Day, and Christmas Day) the preceding Friday will be considered as the holiday; should they fall on a Sunday, the following Monday shall be considered as the holiday.
- I. Holidays: New Year's Day, President's Day, Memorial Day, Labor Day, Thanksgiving Day, the Friday after Thanksgiving Day, Christmas Day, the last regular workday before Christmas (8). Any holiday which falls on a Sunday shall be observed as a holiday on the following Monday.

Benefit Code Key – Effective 9/1/2021 thru 3/2/2022

Note Codes

8. D. Workers working with supplied air on hazmat projects receive an additional \$1.00 per hour.
- L. Workers on hazmat projects receive additional hourly premiums as follows -Level A: \$0.75, Level B: \$0.50, And Level C: \$0.25.
- M. Workers on hazmat projects receive additional hourly premiums as follows: Levels A & B: \$1.00, Levels C & D: \$0.50.
- N. Workers on hazmat projects receive additional hourly premiums as follows -Level A: \$1.00, Level B: \$0.75, Level C: \$0.50, And Level D: \$0.25.
- S. Effective August 31, 2012 – A Traffic Control Supervisor shall be present on the project whenever flagging or spotting or other traffic control labor is being utilized. Flaggers and Spotters shall be posted where shown on approved Traffic Control Plans or where directed by the Engineer. All flaggers and spotters shall possess a current flagging card issued by the State of Washington, Oregon, Montana, or Idaho. This classification is only effective on or after August 31, 2012.
- T. Effective August 31, 2012 – A Traffic Control Laborer performs the setup, maintenance and removal of all temporary traffic control devices and construction signs necessary to control vehicular, bicycle, and pedestrian traffic during construction operations. Flaggers and Spotters shall be posted where shown on approved Traffic Control Plans or where directed by the Engineer. All flaggers and spotters shall possess a current flagging card issued by the State of Washington, Oregon, Montana, or Idaho. This classification is only effective on or after August 31, 2012.
- U. Workers on hazmat projects receive additional hourly premiums as follows – Class A Suit: \$2.00, Class B Suit: \$1.50, And Class C Suit: \$1.00. Workers performing underground work receive an additional \$0.40 per hour for any and all work performed underground, including operating, servicing and repairing of equipment. The premium for underground work shall be paid for the entire shift worked. Workers who work suspended by a rope or cable receive an additional \$0.50 per hour. The premium for work suspended shall be paid for the entire shift worked. Workers who do “pioneer” work (break open a cut, build road, etc.) more than one hundred fifty (150) feet above grade elevation receive an additional \$0.50 per hour.
- V. In addition to the hourly wage and fringe benefits, the following depth and enclosure premiums shall be paid. The premiums are to be calculated for the maximum depth and distance into an enclosure that a diver reaches in a day. The premiums are to be paid one time for the day and are not used in calculating overtime pay.
- Depth premiums apply to depths of fifty feet or more. Over 50' to 100' - \$2.00 per foot for each foot over 50 feet. Over 101' to 150' - \$3.00 per foot for each foot over 101 feet. Over 151' to 220' - \$4.00 per foot for each foot over 220 feet. Over 221' - \$5.00 per foot for each foot over 221 feet.
- Enclosure premiums apply when divers enter enclosures (such as pipes or tunnels) where there is no vertical ascent and is measured by the distance travelled from the entrance. 25' to 300' - \$1.00 per foot from entrance. 300' to 600' - \$1.50 per foot beginning at 300'. Over 600' - \$2.00 per foot beginning at 600'.
- W. Meter Installers work on single phase 120/240V self-contained residential meters. The Lineman/Groundmen rates would apply to meters not fitting this description.

Note Codes Continued

8. X. Workers on hazmat projects receive additional hourly premiums as follows - Class A Suit: \$2.00, Class B Suit: \$1.50, Class C Suit: \$1.00, and Class D Suit: \$0.50. Special Shift Premium: Basic hourly rate plus \$2.00 per hour.

When due to conditions beyond the control of the Employer or when an owner (not acting as the contractor), a government agency or the contract specifications requires that work can only be performed outside the normal 5 am to 6pm shift, then the special shift premium will be applied to the basic hourly rate. When an employee works on a special shift, they shall be paid a special shift premium for each hour worked unless they are in OT or Double-time status. (For example, the special shift premium does not waive the overtime requirements for work performed on Saturday or Sunday.)

Tide Work: When employees are called out between the hours of 6:00 p.m. and 6:00 a.m. to work on tide work (work located in the tide plane) all time worked shall be at one and one-half times the hourly rate of pay.

Swinging Stage/Boatswains Chair: Employees working on a swinging state or boatswains chair or under conditions that require them to be tied off to allow their hands to be free shall receive seventy-five cents (\$0.75) per hour above the classification rate.

- Z. Workers working with supplied air on hazmat projects receive an additional \$1.00 per hour.

Special Shift Premium: Basic hourly rate plus \$2.00 per hour. When due to conditions beyond the control of the Employer or when an owner (not acting as a contractor), a government agency or the contract specifications require that more than (4) hours of a special shift can only be performed outside the normal 6 am to 6pm shift, then the special shift premium will be applied to the basic straight time for the entire shift. When an employee works on a special shift, they will be paid a special shift premium for each hour worked unless they are in overtime or double-time status. (For example, the special shift premium does not waive the overtime requirements for work performed on Saturday or Sunday.)

9. A. Workers working with supplied air on hazmat projects receive an additional \$1.00 per hour.

Special Shift Premium: Basic hourly rate plus \$2.00 per hour. When due to conditions beyond the control of the Employer or when an owner (not acting as the contractor), a government agency or the contract specifications require that more than four (4) hours of a special shift can only be performed outside the normal 6 am to 6pm shift, then the special shift premium will be applied to the basic straight time for the entire shift. When an employee works on a special shift, they shall be paid a special shift premium for each hour worked unless they are in overtime or double-time status. (For example, the special shift premium does not waive the overtime requirements for work performed on Saturday or Sunday.)

Certified Crane Operator Premium: Crane operators requiring certifications shall be paid \$0.50 per hour above their classification rate.

Boom Pay Premium: All cranes including tower shall be paid as follows based on boom length:

(A) – 130' to 199' – \$0.50 per hour over their classification rate.

(B) – 200' to 299' – \$0.80 per hour over their classification rate.

(C) – 300' and over – \$1.00 per hour over their classification rate.

Note Codes Continued

9. B. The highest pressure registered on the gauge for an accumulated time of more than fifteen (15) minutes during the shift shall be used in determining the scale paid.

Tide Work: When employees are called out between the hours of 6:00 p.m. and 6:00 a.m. to work on tide work (work located in the tide plane) all time worked shall be at one and one-half times the hourly rate of pay. Swinging Stage/Boatswains Chair: Employees working on a swinging stage or boatswains chair or under conditions that require them to be tied off to allow their hands to be free shall receive seventy-five cents (\$0.75) per hour above the classification rate.

- C. Tide Work: When employees are called out between the hours of 6:00 p.m. and 6:00 a.m. to work on tide work (work located in the tide plane) all time worked shall be at one and one-half times the hourly rate of pay. Swinging Stage/Boatswains Chair: Employees working on a swinging stage or boatswains chair or under conditions that require them to be tied off to allow their hands to be free shall receive seventy-five cents (\$0.75) per hour above the classification rate.

Effective August 31, 2012 – A Traffic Control Supervisor shall be present on the project whenever flagging or spotting or other traffic control labor is being utilized. A Traffic Control Laborer performs the setup, maintenance and removal of all temporary traffic control devices and construction signs necessary to control vehicular, bicycle, and pedestrian traffic during construction operations. Flaggers and Spotters shall be posted where shown on approved Traffic Control Plans or where directed by the Engineer. All flaggers and spotters shall possess a current flagging card issued by the State of Washington, Oregon, Montana, or Idaho. These classifications are only effective on or after August 31, 2012.

- D. Industrial Painter wages are required for painting within industrial facilities such as treatment plants, pipelines, towers, dams, bridges, power generation facilities and manufacturing facilities such as chemical plants, etc., or anywhere abrasive blasting is necessary to prepare surfaces, or hazardous materials encapsulation is required.
- E. Heavy Construction includes construction, repair, alteration or additions to the production, fabrication or manufacturing portions of industrial or manufacturing plants, hydroelectric or nuclear power plants and atomic reactor construction. Workers on hazmat projects receive additional hourly premiums as follows -Level A: \$1.00, Level B: \$0.75, Level C: \$0.50, And Level D: \$0.25.
- F. Industrial Painter wages are required for painting within industrial facilities such as treatment plants, pipelines, towers, dams, power generation facilities and manufacturing facilities such as chemical plants, etc., or anywhere abrasive blasting is necessary to prepare surfaces, or hazardous materials encapsulation is required.

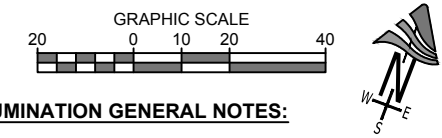

ILLUMINATION GENERAL NOTES:

1. ALL WORK SHALL BE IN ACCORDANCE WITH THE WSDOT / APWA STANDARD PLANS, STANDARD SPECIFICATIONS, THE LATEST AMENDMENTS TO STANDARD SPECIFICATIONS, SPECIAL PROVISIONS, THESE PLANS, NEC, PSE AND CITY GUIDELINES AND STANDARDS.
2. THE LOCATION OF ALL CONDUIT, JUNCTION BOXES, AND LUMINAIRES SHOWN ON THIS PLAN ARE FOR GRAPHIC REPRESENTATION ONLY AND FINAL LOCATIONS SHALL BE DETERMINED BY THE ENGINEER IN THE FIELD. ALL EQUIPMENT AND CONSTRUCTION ACTIVITIES SHALL BE LOCATED WITHIN THE CITY OF FEDERAL WAY RIGHT-OF-WAY.
3. ALL NEW FOUNDATION LOCATIONS SHALL BE APPROVED BY THE ENGINEER PRIOR TO EXCAVATION.
4. ALL NEW JUNCTION BOXES INSTALLED IN SIDEWALKS SHALL HAVE SKID RESISTANT LIDS. AFTER INSTALLATION AND FINAL INSPECTION, LIDS FOR JUNCTION BOXES TYPE 1 AND 2 SHALL BE SPOT WELDED AT TWO SEPARATE LOCATIONS.
5. NUMBER OF CONDUIT BENDS BETWEEN PULL POINTS SHALL NOT BE MORE THAN THE EQUIVALENT OF FOUR QUARTER BENDS (360 DEGREES TOTAL). IF NUMBER OF BENDS EXCEEDS LISTED REQUIREMENTS, THE CONTRACTOR SHALL INSTALL ADDITIONAL JUNCTION BOXES, AS DIRECTED BY THE ENGINEER.
6. COORDINATE ALL SIGNAL & ILLUMINATION WORK WITH KING COUNTY MAINTENANCE REPRESENTATIVE: MARK PARRETT AT (206)396-3763.
7. ALL NEW PVC CONDUITS CONTAINING CONDUCTORS SHALL CONTAIN GROUND WIRE SIZED TO MATCH THE LARGEST CONDUCTOR (MIN #8 AWG OR AS NOTED OTHERWISE IN THE WIRE NOTES). SPARE / EMPTY CONDUIT SHALL CONTAIN DETECTABLE PULL TAPE AND SHALL BE MARKED AS "CITY OF FEDERAL WAY" CONDUIT.
8. ALL CONDUIT SHALL BE RIGID PVC SCH 40, EXCEPT UNDER ROADWAYS AND FOR POWER FEEDER USED RIGID PVC SCH 80 CONDUIT.

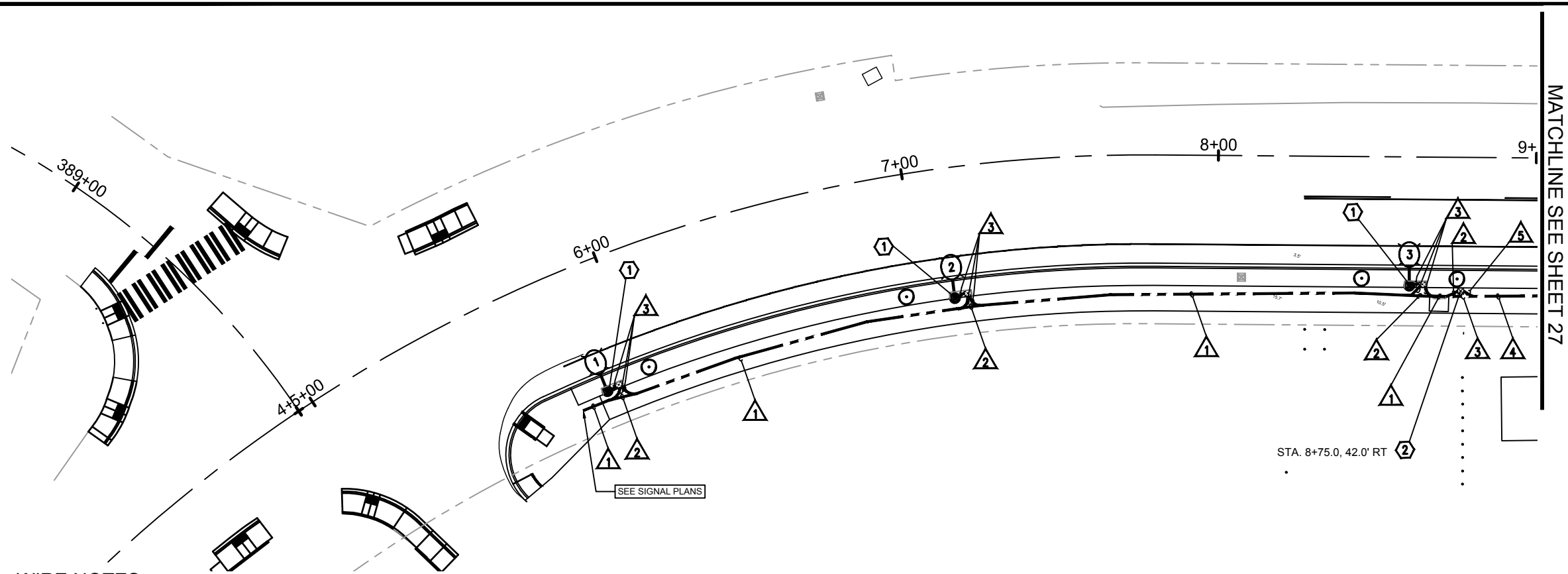

WIRE NOTES

#	RACEWAY/ CONDUIT SIZE	CONDUCTORS	COMMENTS
1	2"	2-#8 (ILL)	
2	2"	1- 6 PAIR(INT), 1-2CS (LOOP),1 FIBER	JOINT TRENCH
3	2"	1- 6 PAIR(INT), 1-2CS (LOOP),1 FIBER	JOINT TRENCH
4	2"	2-#8 (ILL)	
5	2"	1- 6 PAIR(INT),1 FIBER	JOINT TRENCH
6	2"	2-#8 (ILL)	
7	2"	1- 2CS(LOOP)	
8	2"	1- 6 PAIR(INT),1 FIBER	JOINT TRENCH
9	2"	1- 2CS(LOOP)	
10	2"	1- 2CS(LOOP)	
11	2"	1- 6 PAIR(INT),1 FIBER	JOINT TRENCH
12	2"	1- 6 PAIR(INT),1 FIBER	JOINT TRENCH
13	2"	1- 6 PAIR(INT),1 FIBER	JOINT TRENCH
14	2"	1- 6 PAIR(INT),1 FIBER	JOINT TRENCH
15	2"	1- 6 PAIR(INT),1 FIBER	JOINT TRENCH
16	2"	1- 6 PAIR(INT),1 FIBER	JOINT TRENCH
17	2"	1- 6 PAIR(INT),1 FIBER	JOINT TRENCH
18	2"	1- 6 PAIR(INT),1 FIBER	JOINT TRENCH
19	2"	1- 6 PAIR(INT),1 FIBER	JOINT TRENCH
20	2"	1- 6 PAIR(INT),1 FIBER	JOINT TRENCH
21	2"	1- 6 PAIR(INT),1 FIBER	JOINT TRENCH
22	2"	1- 6 PAIR(INT),1 FIBER	JOINT TRENCH
23	2"	1- 6 PAIR(INT),1 FIBER	JOINT TRENCH
24	2"	1- 6 PAIR(INT),1 FIBER	JOINT TRENCH
25	2"	1- 6 PAIR(INT),1 FIBER	JOINT TRENCH
26	2"	1- 6 PAIR(INT),1 FIBER	JOINT TRENCH
27	2"	1- 6 PAIR(INT),1 FIBER	JOINT TRENCH
28	2"	1- 6 PAIR(INT),1 FIBER	JOINT TRENCH
29	2"	1- 6 PAIR(INT),1 FIBER	JOINT TRENCH
30	2"	1- 6 PAIR(INT),1 FIBER	JOINT TRENCH
31	2"	1- 6 PAIR(INT),1 FIBER	JOINT TRENCH
32	2"	1- 6 PAIR(INT),1 FIBER	JOINT TRENCH
33	2"	1- 6 PAIR(INT),1 FIBER	JOINT TRENCH
34	2"	1- 6 PAIR(INT),1 FIBER	JOINT TRENCH
35	2"	1- 6 PAIR(INT),1 FIBER	JOINT TRENCH
36	2"	1- 6 PAIR(INT),1 FIBER	JOINT TRENCH
37	2"	1- 6 PAIR(INT),1 FIBER	JOINT TRENCH
38	2"	1- 6 PAIR(INT),1 FIBER	JOINT TRENCH
39	2"	1- 6 PAIR(INT),1 FIBER	JOINT TRENCH
40	2"	1- 6 PAIR(INT),1 FIBER	JOINT TRENCH
41	2"	1- 6 PAIR(INT),1 FIBER	JOINT TRENCH
42	2"	1- 6 PAIR(INT),1 FIBER	JOINT TRENCH
43	2"	1- 6 PAIR(INT),1 FIBER	JOINT TRENCH
44	2"	1- 6 PAIR(INT),1 FIBER	JOINT TRENCH
45	2"	1- 6 PAIR(INT),1 FIBER	JOINT TRENCH
46	2"	1- 6 PAIR(INT),1 FIBER	JOINT TRENCH
47	2"	1- 6 PAIR(INT),1 FIBER	JOINT TRENCH
48	2"	1- 6 PAIR(INT),1 FIBER	JOINT TRENCH
49	2"	1- 6 PAIR(INT),1 FIBER	JOINT TRENCH
50	2"	1- 6 PAIR(INT),1 FIBER	JOINT TRENCH
51	2"	1- 6 PAIR(INT),1 FIBER	JOINT TRENCH
52	2"	1- 6 PAIR(INT),1 FIBER	JOINT TRENCH
53	2"	1- 6 PAIR(INT),1 FIBER	JOINT TRENCH
54	2"	1- 6 PAIR(INT),1 FIBER	JOINT TRENCH
55	2"	1- 6 PAIR(INT),1 FIBER	JOINT TRENCH
56	2"	1- 6 PAIR(INT),1 FIBER	JOINT TRENCH
57	2"	1- 6 PAIR(INT),1 FIBER	JOINT TRENCH
58	2"	1- 6 PAIR(INT),1 FIBER	JOINT TRENCH
59	2"	1- 6 PAIR(INT),1 FIBER	JOINT TRENCH
60	2"	1- 6 PAIR(INT),1 FIBER	JOINT TRENCH
61	2"	1- 6 PAIR(INT),1 FIBER	JOINT TRENCH
62	2"	1- 6 PAIR(INT),1 FIBER	JOINT TRENCH
63	2"	1- 6 PAIR(INT),1 FIBER	JOINT TRENCH
64	2"	1- 6 PAIR(INT),1 FIBER	JOINT TRENCH
65	2"	1- 6 PAIR(INT),1 FIBER	JOINT TRENCH
66	2"	1- 6 PAIR(INT),1 FIBER	JOINT TRENCH
67	2"	1- 6 PAIR(INT),1 FIBER	JOINT TRENCH
68	2"	1- 6 PAIR(INT),1 FIBER	JOINT TRENCH
69	2"	1- 6 PAIR(INT),1 FIBER	JOINT TRENCH
70	2"	1- 6 PAIR(INT),1 FIBER	JOINT TRENCH
71	2"	1- 6 PAIR(INT),1 FIBER	JOINT TRENCH
72	2"	1- 6 PAIR(INT),1 FIBER	JOINT TRENCH
73	2"	1- 6 PAIR(INT),1 FIBER	JOINT TRENCH
74	2"	1- 6 PAIR(INT),1 FIBER	JOINT TRENCH
75	2"	1- 6 PAIR(INT),1 FIBER	JOINT TRENCH
76	2"	1- 6 PAIR(INT),1 FIBER	JOINT TRENCH
77	2"	1- 6 PAIR(INT),1 FIBER	JOINT TRENCH
78	2"	1- 6 PAIR(INT),1 FIBER	JOINT TRENCH
79	2"	1- 6 PAIR(INT),1 FIBER	JOINT TRENCH
80	2"	1- 6 PAIR(INT),1 FIBER	JOINT TRENCH
81	2"	1- 6 PAIR(INT),1 FIBER	JOINT TRENCH
82	2"	1- 6 PAIR(INT),1 FIBER	JOINT TRENCH
83	2"	1- 6 PAIR(INT),1 FIBER	JOINT TRENCH
84	2"	1- 6 PAIR(INT),1 FIBER	JOINT TRENCH
85	2"	1- 6 PAIR(INT),1 FIBER	JOINT TRENCH
86	2"	1- 6 PAIR(INT),1 FIBER	JOINT TRENCH
87	2"	1- 6 PAIR(INT),1 FIBER	JOINT TRENCH
88	2"	1- 6 PAIR(INT),1 FIBER	JOINT TRENCH
89	2"	1- 6 PAIR(INT),1 FIBER	JOINT TRENCH
90	2"	1- 6 PAIR(INT),1 FIBER	JOINT TRENCH
91	2"	1- 6 PAIR(INT),1 FIBER	JOINT TRENCH
92	2"	1- 6 PAIR(INT),1 FIBER	JOINT TRENCH
93	2"	1- 6 PAIR(INT),1 FIBER	JOINT TRENCH
94	2"	1- 6 PAIR(INT),1 FIBER	JOINT TRENCH
95	2"	1- 6 PAIR(INT),1 FIBER	JOINT TRENCH
96	2"	1- 6 PAIR(INT),1 FIBER	JOINT TRENCH
97	2"	1- 6 PAIR(INT),1 FIBER	JOINT TRENCH
98	2"	1- 6 PAIR(INT),1 FIBER	JOINT TRENCH
99	2"	1- 6 PAIR(INT),1 FIBER	JOINT TRENCH
100	2"	1- 6 PAIR(INT),1 FIBER	JOINT TRENCH

LUMINAIRE SCHEDULE

LUMINAIRE #	STATION	OFFSET	LUMINAIRE TYPE	LUMINAIRE ARM	MOUNTING HEIGHT	BASE	CIRCUIT # (SERVICE #)	CITY LUMINAIRE POLE #	COMMENTS
1	5+86.0	40.5' RT	COBRA 150W, 90 LED, 530mA (M-III, B3-U0-G3) 240V	6'	35'	FIXED	1 (1650)	1650 1-1-1	
2	7+10.0	40.5' RT	COBRA 150W, 90 LED, 530mA (M-III, B3-U0-G3) 240V	6'	35'	FIXED	1 (1650)	1650 1-1-2	
3	8+59.0	40.5' RT	COBRA 150W, 90 LED, 530mA (M-III, B3-U0-G3) 240V	6'	35'	FIXED	1 (1650)	1650 1-1-3	

SIGNALS/ILLUMINATION LEGEND

- TYPE 1 JUNCTION BOX
- TYPE 2 JUNCTION BOX
- TYPE 8 JUNCTION BOX
- CONDUIT
- SIGNAL POLE WITH LED COBRA HEAD LUMINAIRE
- STREET LIGHT ASSEMBLY
- VEHICLE SIGNAL HEAD (THROUGH)
- VEHICLE SIGNAL HEAD (TURN)
- EMERGENCY VEHICLE PRE-EMPTION
- SIGNAL POLE
- TYPE PS POLE WITH PPB
- SIGNAL CONTROLLER CABINET
- ELECTRICAL SERVICE CABINET
- SIGN ON MAST ARM
- UNINTERRUPTIBLE POWER SUPPLY (UPS)
- WIRE NOTE
- TEMPORARY VIDEO DETECTION CAMERA
- LUMINAIRE NUMBER
- PULL BOX
- TYPE 1 SIGNAL POLE W/ PPB
- SIGNAL POLE NUMBER

ILLUMINATION CONSTRUCTION NOTES

- ① CONSTRUCT FOUNDATION AND FURNISH AND INSTALL ROADWAY LUMINAIRE POLE, LUMINAIRE ARM, LUMINAIRE, AND ALL ASSOCIATED EQUIPMENT, CONDUIT, AND WIRING PER LUMINAIRE SCHEDULE PER CITY OF FEDERAL WAY STANDARD DWGS 3-39, 3-39A, 3-39B, AND 3-40. COMPLETE WIRING PER WIRE NOTES.
- ② INSTALL 1- TYPE 1 JUNCTION BOX PER WSDOT STD. PLAN J-40.10-04 FOR INTERCONNECT CONDUIT PULL BOX.

85 % DESIGN

DRAFTED: S.ALIZAI
 DESIGNED: J.MULKEY
 REVIEWED: R.PEREZ
 APPROVED: D.WINKLER

DRAWING VERSION / REVISION LOG

NO.	DATE	REVISION
B	11/17/21	ADDENDUM 1

LAKOTA M.S. SRTS PROJECT

ILLUMINATION PLAN
STA 4+35 TO STA 9+00

CITY PROJECT #: 204
SHT. 26 OF 54

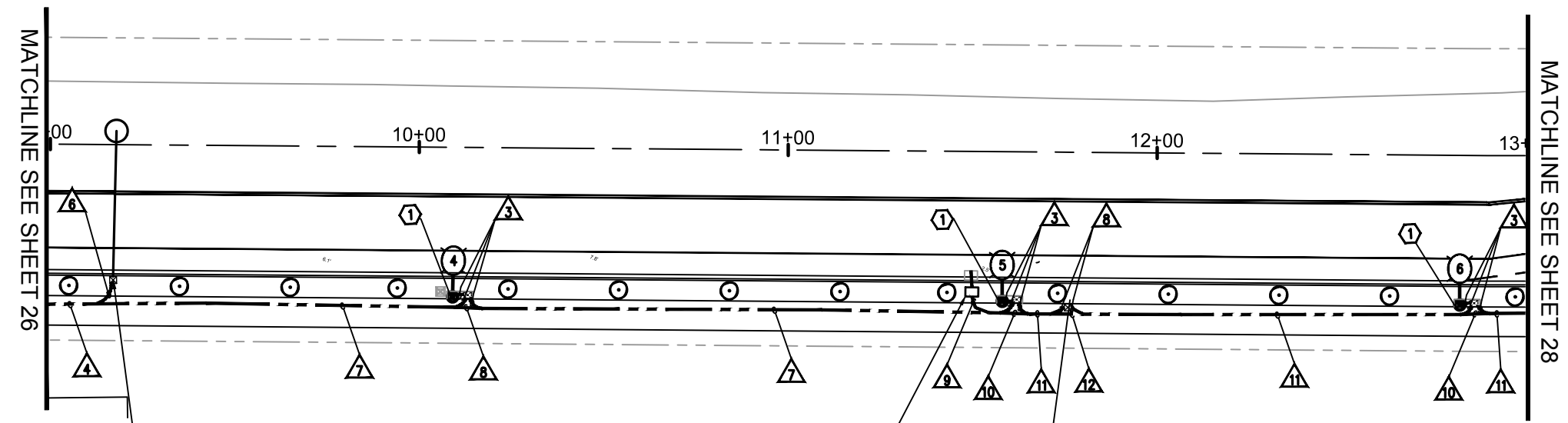
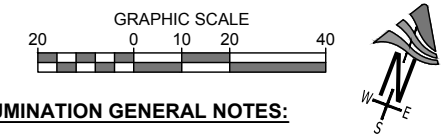

INSTALL 1 TYPE 1 JUNCTION BOX PER WSDOT STD. PLAN J-40.10-04 AND PULL 1-2CS CABLE THROUGH NEW 2" CONDUIT. INSTALL ADVANCED LOOP AT STA. 9+16.5 IN WESTBOUND LANE PER CFW STD. DETAIL 3-44. STA. 9+16.0, 36.7' RT.

RELOCATE EXISTING VERIZON VAULT AT APPROX STA 11+50 TO 39.0' RT (CENTERED IN LANDSCAPE STRIP) AND EXTEND CONDUIT INTO NEW VAULT LOCATION. COORDINATE WITH VERIZON FOR PULL LOCATIONS.

STA. 11+75.0, 42.0'T

SIGNALS/ILLUMINATION LEGEND

- TYPE 1 JUNCTION BOX
- TYPE 2 JUNCTION BOX
- TYPE 8 JUNCTION BOX
- CONDUIT
- SIGNAL POLE WITH LED COBRA HEAD LUMINAIRE
- STREET LIGHT ASSEMBLY
- VEHICLE SIGNAL HEAD (THROUGH)
- VEHICLE SIGNAL HEAD (TURN)
- EMERGENCY VEHICLE PRE-EMPTION
- SIGNAL POLE
- TYPE PS POLE WITH PPB
- SIGNAL CONTROLLER CABINET
- ELECTRICAL SERVICE CABINET
- SIGN ON MAST ARM
- UNINTERRUPTIBLE POWER SUPPLY (UPS)
- WIRE NOTE
- TEMPORARY VIDEO DETECTION CAMERA
- LUMINAIRE NUMBER
- PULL BOX
- TYPE I SIGNAL POLE W/ PPB
- SIGNAL POLE NUMBER

- ILLUMINATION GENERAL NOTES:**
- ALL WORK SHALL BE IN ACCORDANCE WITH THE WSDOT / APWA STANDARD PLANS, STANDARD SPECIFICATIONS, THE LATEST AMENDMENTS TO STANDARD SPECIFICATIONS, SPECIAL PROVISIONS, THESE PLANS, NEC, PSE AND CITY GUIDELINES AND STANDARDS.
 - THE LOCATION OF ALL CONDUIT, JUNCTION BOXES, AND LUMINAIRES SHOWN ON THIS PLAN ARE FOR GRAPHIC REPRESENTATION ONLY AND FINAL LOCATIONS SHALL BE DETERMINED BY THE ENGINEER IN THE FIELD. ALL EQUIPMENT AND CONSTRUCTION ACTIVITIES SHALL BE LOCATED WITHIN THE CITY OF FEDERAL WAY RIGHT-OF-WAY.
 - ALL NEW FOUNDATION LOCATIONS SHALL BE APPROVED BY THE ENGINEER PRIOR TO EXCAVATION.
 - ALL NEW JUNCTION BOXES INSTALLED IN SIDEWALKS SHALL HAVE SKID RESISTANT LIDS. AFTER INSTALLATION AND FINAL INSPECTION, LIDS FOR JUNCTION BOXES TYPE 1 AND 2 SHALL BE SPOT WELDED AT TWO SEPARATE LOCATIONS.
 - NUMBER OF CONDUIT BENDS BETWEEN PULL POINTS SHALL NOT BE MORE THAN THE EQUIVALENT OF FOUR QUARTER BENDS (360 DEGREES TOTAL). IF NUMBER OF BENDS EXCEEDS LISTED REQUIREMENTS, THE CONTRACTOR SHALL INSTALL ADDITIONAL JUNCTION BOXES, AS DIRECTED BY THE ENGINEER.
 - COORDINATE ALL SIGNAL & ILLUMINATION WORK WITH KING COUNTY MAINTENANCE REPRESENTATIVE: MARK PARRETT AT (206)396-3763.
 - ALL NEW PVC CONDUITS CONTAINING CONDUCTORS SHALL CONTAIN GROUND WIRE SIZED TO MATCH THE LARGEST CONDUCTOR (MIN #8 AWG OR AS NOTED OTHERWISE IN THE WIRE NOTES). SPARE / EMPTY CONDUIT SHALL CONTAIN DETECTABLE PULL TAPE AND SHALL BE MARKED AS "CITY OF FEDERAL WAY" CONDUIT.
 - ALL CONDUIT SHALL BE RIGID PVC SCH 40, EXCEPT UNDER ROADWAYS AND FOR POWER FEEDER USED RIGID PVC SCH 80 CONDUIT.

WIRE NOTES

RACEWAY/ CONDUIT SIZE	CONDUCTORS	COMMENTS
1 2"	2-#8 (ILL)	
2 2"	1- 6 PAIR(INT), 1-2CS (LOOP),1 FIBER	JOINT TRENCH
3 2"	1- 6 PAIR(INT), 1-2CS (LOOP),1 FIBER	JOINT TRENCH
4 2"	2-#8 (ILL)	
5 2"	1- 6 PAIR(INT),1 FIBER	JOINT TRENCH
6 2"	1- 2CS(LOOP)	
7 2"	1- 2CS(LOOP)	
8 2"	1- 6 PAIR(INT),1 FIBER	JOINT TRENCH
9 2"	1- 6 PAIR(INT),1 FIBER	JOINT TRENCH
10 2"	1- VERIZON FIBER	JOINT TRENCH
11 2"	1- 6 PAIR(INT),1 FIBER	JOINT TRENCH
12 2"	1- 6 PAIR(INT),1 FIBER	JOINT TRENCH
1 2"	2-#8 (ILL)	
2 2"	1- VERIZON FIBER	JOINT TRENCH
3 2"	2-#8 (ILL)	
4 2"	1- VERIZON FIBER	JOINT TRENCH
5 2"	2-#8 (ILL)	
6 2"	1- VERIZON FIBER	JOINT TRENCH
7 2"	2-#8 (ILL)	
8 2"	1- VERIZON FIBER	JOINT TRENCH
9 2"	2-#8 (ILL)	
10 2"	1- VERIZON FIBER	JOINT TRENCH
11 2"	2-#8 (ILL)	
12 2"	1- VERIZON FIBER	JOINT TRENCH
1 2"	1- VERIZON FIBER	JOINT TRENCH

- ILLUMINATION CONSTRUCTION NOTES**
- CONSTRUCT FOUNDATION AND FURNISH AND INSTALL ROADWAY LUMINAIRE POLE, LUMINAIRE ARM, LUMINAIRE, AND ALL ASSOCIATED EQUIPMENT, CONDUIT, AND WIRING PER LUMINAIRE SCHEDULE PER CITY OF FEDERAL WAY STANDARD DWGS 3-39, 3-39A, 3-39B, AND 3-40. COMPLETE WIRING PER WIRE NOTES.
 - INSTALL 1- TYPE 1 JUNCTION BOX PER WSDOT STD. PLAN J-40.10-04 FOR INTERCONNECT CONDUIT PULL BOX.

LUMINAIRE SCHEDULE

LUMINAIRE #	STATION	OFFSET	LUMINAIRE TYPE	LUMINAIRE ARM	MOUNTING HEIGHT	BASE	CIRCUIT # (SERVICE #)	CITY LUMINAIRE POLE #	COMMENTS
4	10+08.0	40.5' RT	COBRA 150W, 90 LED, 530mA (M-III, B3-U0-G3) 240V	6'	35'	FIXED	1 (1650)	1650 1-1-3	
5	11+57.0	40.5' RT	COBRA 150W, 90 LED, 530mA (M-III, B3-U0-G3) 240V	6'	35'	FIXED	1 (1650)	1650 1-1-5	
6	12+81.0	40.5' RT	COBRA 150w, 90led, 530mA (M-III, B3-U0-G 3)	6'-0"	35'-0"	FIXED	1(1650)	1650 1-1-6	

85 % DESIGN

DRAFTED: S.ALIZAI
 DESIGNED: J.MULKEY
 REVIEWED: R.PEREZ
 APPROVED: D.WINKLER

DRAWING VERSION / REVISION LOG

NO.	DATE	REVISION
B	11/17/21	ADDENDUM 1

LAKOTA M.S. SRTS PROJECT

ILLUMINATION PLAN
STA 9+00 TO STA 13+00

CITY PROJECT #: 204
SHT. 27 OF 54

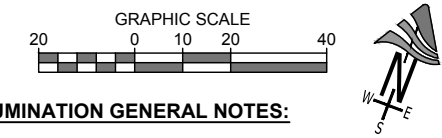

ILLUMINATION GENERAL NOTES:

- ALL WORK SHALL BE IN ACCORDANCE WITH THE WSDOT / APWA STANDARD PLANS, STANDARD SPECIFICATIONS, THE LATEST AMENDMENTS TO STANDARD SPECIFICATIONS, SPECIAL PROVISIONS, THESE PLANS, NEC, PSE AND CITY GUIDELINES AND STANDARDS.
- THE LOCATION OF ALL CONDUIT, JUNCTION BOXES, AND LUMINAIRES SHOWN ON THIS PLAN ARE FOR GRAPHIC REPRESENTATION ONLY AND FINAL LOCATIONS SHALL BE DETERMINED BY THE ENGINEER IN THE FIELD. ALL EQUIPMENT AND CONSTRUCTION ACTIVITIES SHALL BE LOCATED WITHIN THE CITY OF FEDERAL WAY RIGHT-OF-WAY.
- ALL NEW FOUNDATION LOCATIONS SHALL BE APPROVED BY THE ENGINEER PRIOR TO EXCAVATION.
- ALL NEW JUNCTION BOXES INSTALLED IN SIDEWALKS SHALL HAVE SKID RESISTANT LIDS. AFTER INSTALLATION AND FINAL INSPECTION, LIDS FOR JUNCTION BOXES TYPE 1 AND 2 SHALL BE SPOT WELDED AT TWO SEPARATE LOCATIONS.
- NUMBER OF CONDUIT BENDS BETWEEN PULL POINTS SHALL NOT BE MORE THAN THE EQUIVALENT OF FOUR QUARTER BENDS (360 DEGREES TOTAL). IF NUMBER OF BENDS EXCEEDS LISTED REQUIREMENTS, THE CONTRACTOR SHALL INSTALL ADDITIONAL JUNCTION BOXES, AS DIRECTED BY THE ENGINEER.
- COORDINATE ALL SIGNAL & ILLUMINATION WORK WITH KING COUNTY MAINTENANCE REPRESENTATIVE: MARK PARRETT AT (206)396-3763.
- ALL NEW PVC CONDUITS CONTAINING CONDUCTORS SHALL CONTAIN GROUND WIRE SIZED TO MATCH THE LARGEST CONDUCTOR (MIN #8 AWG OR AS NOTED OTHERWISE IN THE WIRE NOTES). SPARE / EMPTY CONDUIT SHALL CONTAIN DETECTABLE PULL TAPE AND SHALL BE MARKED AS "CITY OF FEDERAL WAY" CONDUIT.
- ALL CONDUIT SHALL BE RIGID PVC SCH 40, EXCEPT UNDER ROADWAYS AND FOR POWER FEEDER USED RIGID PVC SCH 80 CONDUIT.

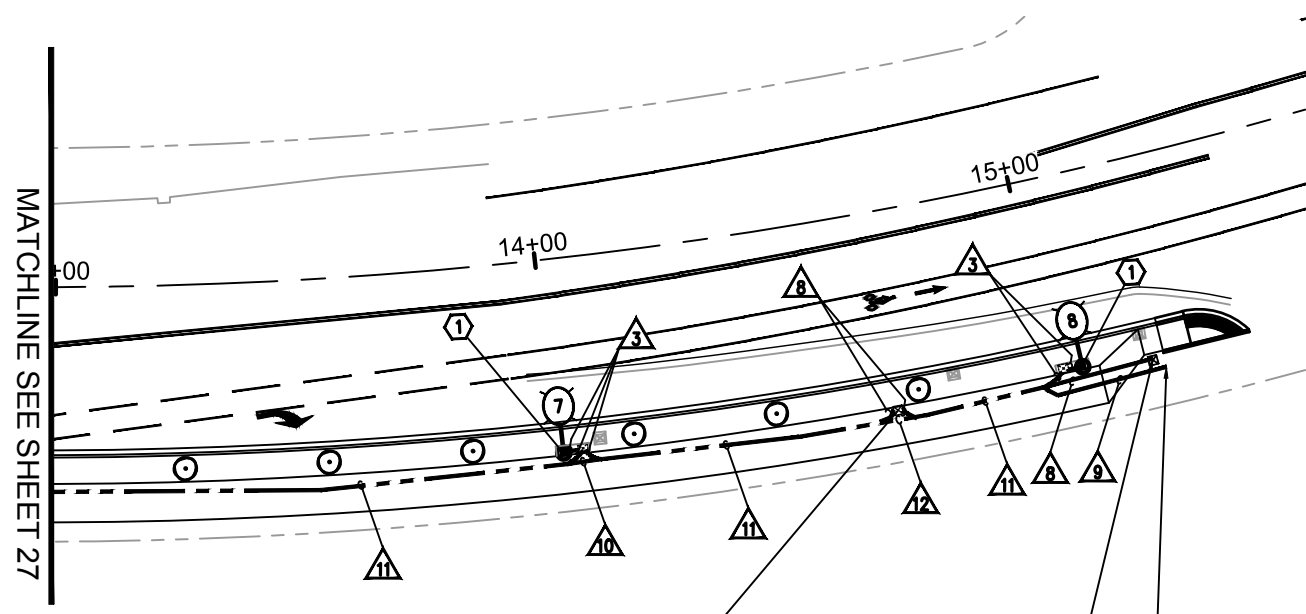

STA. 14+75.0, 42.0'T

INTERCEPT EXISTING CONDUIT FOR INTERCONNECT AND OVERSET TYPE 1 JUNCTION BOX PER WSDOT STD. PLAN J-40.10-04. PULL EXISTING 6- PAIR INTERCONNECT CABLE OUT AND RETRAIN THROUGH NEW CONDUIT BACK TO 21ST AVE SW SIGNAL CONTROLLER CABINET. KING COUNTY TO LAND INTERCONNECT. STA. 15+19.5 42.5' RT

INTERCEPT EXISTING VERIZON CONDUIT PULL EXISTING FIBER OUT AND RETRAIN THROUGH NEW CONDUIT BACK RELOCATED VAULT STA. 11+50 RT

SIGNALS/ILLUMINATION LEGEND

- TYPE 1 JUNCTION BOX
- TYPE 2 JUNCTION BOX
- TYPE 8 JUNCTION BOX
- CONDUIT
- SIGNAL POLE WITH LED COBRA HEAD LUMINAIRE
- STREET LIGHT ASSEMBLY
- VEHICLE SIGNAL HEAD (THROUGH)
- VEHICLE SIGNAL HEAD (TURN)
- EMERGENCY VEHICLE PRE-EMPTION
- SIGNAL POLE
- TYPE PS POLE WITH PPB
- SIGNAL CONTROLLER CABINET
- ELECTRICAL SERVICE CABINET
- SIGN ON MAST ARM
- UNINTERRUPTIBLE POWER SUPPLY (UPS)
- WIRE NOTE
- TEMPORARY VIDEO DETECTION CAMERA
- LUMINAIRE NUMBER
- PULL BOX
- TYPE I SIGNAL POLE W/ PPB
- SIGNAL POLE NUMBER

WIRE NOTES

#	RACEWAY/ CONDUIT SIZE	CONDUCTORS	COMMENTS
1	2"	2-#8 (ILL)	
2	2"	1- 6 PAIR(INT), 1-2CS (LOOP),1 FIBER	JOINT TRENCH
3	2"	1- 6 PAIR(INT), 1-2CS (LOOP),1 FIBER	JOINT TRENCH
4	2"	2-#8 (ILL)	
5	2"	1- 6 PAIR(INT),1 FIBER	JOINT TRENCH
6	2"	1- 2CS(LOOP)	
7	2"	1- 6 PAIR(INT),1 FIBER	JOINT TRENCH
8	2"	1- 6 PAIR(INT),1 FIBER	JOINT TRENCH
9	2"	1- VERIZON FIBER	JOINT TRENCH
10	2"	1- 6 PAIR(INT),1 FIBER	JOINT TRENCH
11	2"	1- VERIZON FIBER	JOINT TRENCH
12	2"	1- 6 PAIR(INT),1 FIBER	JOINT TRENCH

LUMINAIRE SCHEDULE

LUMINAIRE #	STATION	OFFSET	LUMINAIRE TYPE	LUMINAIRE ARM	MOUNTING HEIGHT	BASE	CIRCUIT # (SERVICE #)	CITY LUMINAIRE POLE #	COMMENTS
7	14+00.3	40.5' RT	COBRA 150W, 90 LED, 530mA (M-III, B3-U0-G3) 240V	6'	35'	FIXED	1 (1650)	1650 1-1-7	
8	15+05.4	40.5' RT	COBRA 150W, 90 LED, 530mA (M-III, B3-U0-G3) 240V	6'	35'	FIXED	1 (1650)	1650 1-1-8	

ILLUMINATION CONSTRUCTION NOTES

- CONSTRUCT FOUNDATION AND FURNISH AND INSTALL ROADWAY LUMINAIRE POLE, LUMINAIRE ARM, LUMINAIRE, AND ALL ASSOCIATED EQUIPMENT, CONDUIT, AND WIRING PER LUMINAIRE SCHEDULE PER CITY OF FEDERAL WAY STANDARD DWGS 3-39, 3-39A, 3-39B, AND 3-40. COMPLETE WIRING PER WIRE NOTES.
- INSTALL 1- TYPE 1 JUNCTION BOX PER WSDOT STD. PLAN J-40.10-04 FOR INTERCONNECT CONDUIT PULL BOX.

85 % DESIGN

DRAFTED: S.ALIZAI
 DESIGNED: J.MULKEY
 REVIEWED: R. PEREZ
 APPROVED: D.WINKLER

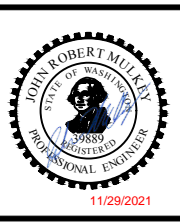

DRAWING VERSION / REVISION LOG

NO.	DATE	REVISION
B	11/17/21	ADDENDUM 1

LAKOTA M.S. SRTS PROJECT

ILLUMINATION PLAN
 STA 13+00 TO STA 15+30

CITY PROJECT #:
204

SHT. 28
OF 54

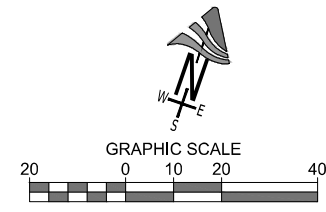

PAVEMENT MARKING GENERAL NOTES

- 1) ALL WORK SHALL BE IN ACCORDANCE WITH MANUAL ON UNIFORM TRAFFIC CONTROL DEVICES (MUTCD), WSDOT STANDARDS AND SPECIFICATIONS, AND CITY OF FEDERAL WAY (COFW) STANDARD DRAWINGS AND SPECIFICATIONS.
- 2) ALL EXISTING PAVEMENT MARKINGS THAT CONFLICT WITH THE PROPOSED PAVEMENT MARKINGS, OR AS DIRECTED BY THE ENGINEER, SHALL BE REMOVED. EXISTING PAVEMENT MARKINGS TO REMAIN THAT ARE DAMAGED OR OTHERWISE ALTERED BY CONSTRUCTION ACTIVITIES SHALL BE REPLACED AS DIRECTED BY THE ENGINEER.
- 3) ALL PAVEMENT MARKINGS SHALL BE IN ACCORDANCE WITH COFW STANDARD DRAWINGS 3-17 THRU 3-21 UNLESS OTHERWISE NOTED.
- 4) STATIONING FOR ALL PAVEMENT MARKING SYMBOLS AND LETTERING IS MEASURED TO THE CENTER OF THE SYMBOL. ALL SYMBOLS AND LETTERING SHALL BE PERPENDICULAR TO THE ADJACENT LANE STRIPING AND CENTERED WITHIN THE LANE UNLESS OTHERWISE NOTED.
- 5) A COPY OF THE APPROVED PLANS MUST BE ON THE JOB SITE WHENEVER CONSTRUCTION IS IN PROGRESS.
- 6) ALL PERMITS REQUIRED FOR WORK WITHIN THE PUBLIC RIGHT-OF-WAY MUST BE OBTAINED PRIOR TO THE START OF CONSTRUCTION.

CONSTRUCTION NOTES

- 1 4" PROFILED PLASTIC DOUBLE YELLOW CENTERLINE (TYPE D WITH BI-DIRECTIONAL TYPE 2 RPMS) PER COFW STANDARD DWG NO. 3-17.
- 2 18" WHITE PLASTIC STOP LINE (TYPE A) PER COFW STANDARD DWG. NO. 3-21 AND WSDOT STANDARD PLAN M-24.60.
- 3 WHITE PLASTIC (TYPE A) CROSSWALK PER COFW STANDARD DWG. NO. 3-21.
- 4 WHITE PLASTIC BIKE LANE SYMBOL PER WSDOT STANDARD PLAN M-9.50.
- 5 8" WHITE PROFILED PLASTIC WIDE LINE (TYPE D WITH MONO-DIRECTIONAL TYPE 2 RPMS) PER COFW STANDARD DWG. NO. 3-18.
- 6 4" YELLOW PROFILED PLASTIC NO PASS LINE (TYPE D WITH MONO-DIRECTIONAL AND BI-DIRECTIONAL TYPE 2 RPMS) PER COFW STANDARD DWG. NO. 3-18.

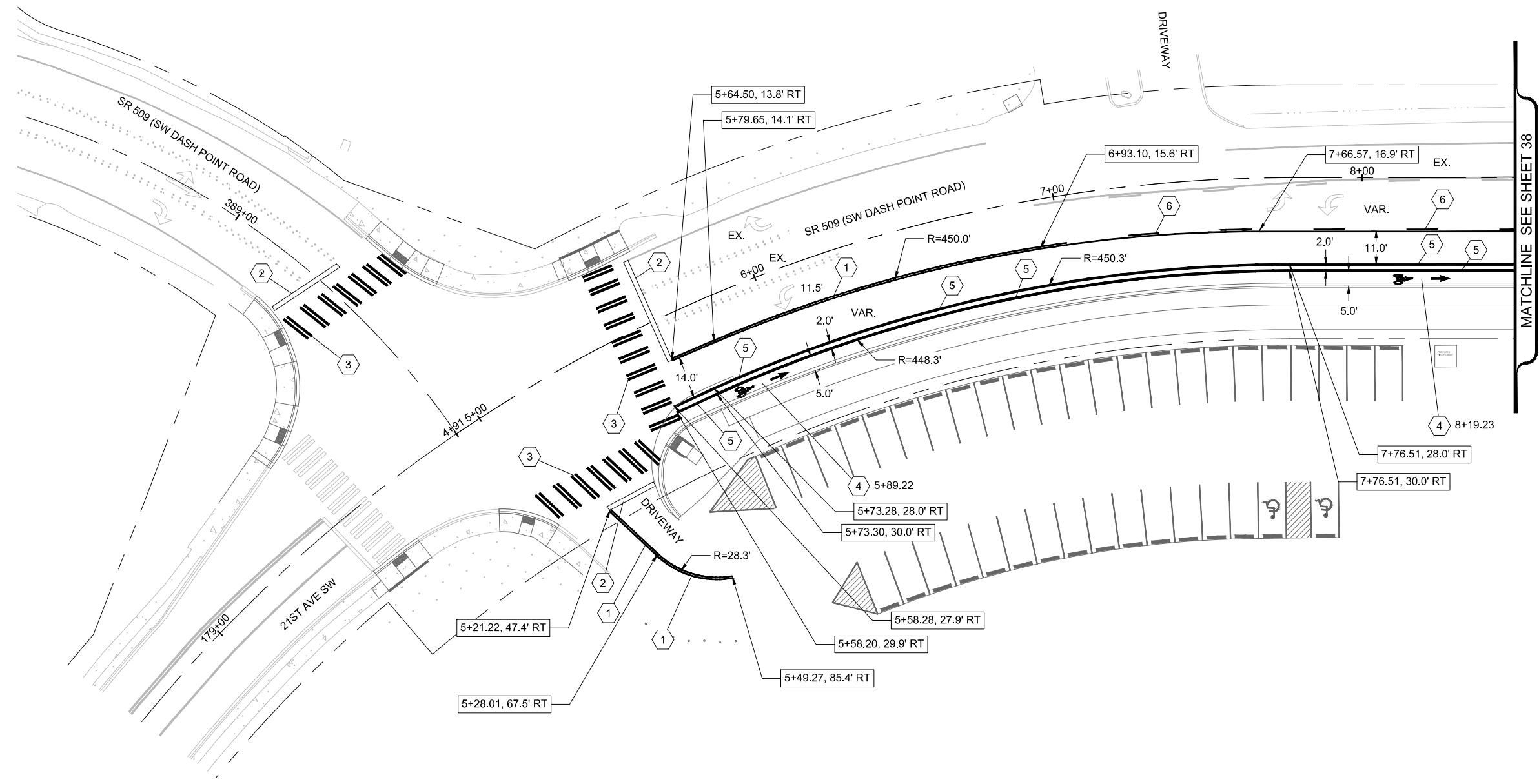

MATCHLINE SEE SHEET 38



12131 113TH AVENUE NE, SUITE 203 (TEL) 425 821-3665
KIRKLAND, WASHINGTON 98034 (FAX) 425 825-8434

CITY OF Federal Way
Centered on Opportunity
33325 8TH AVE S FEDERAL WAY, WA 98003
PHONE: (253) 835-2700
WWW.CITYOFFEDERALWAY.COM



DRAFTED: T.NGUYEN
DESIGNED: T.NGUYEN
REVIEWED: C.CAVALLO
APPROVED: D.WINKLER



DRAWING VERSION / REVISION LOG		
NO.	DATE	REVISION

LAKOTA M.S. SRTS PROJECT
PAVEMENT MARKINGS PLAN
STA 4+91 TO STA 8+50

100%
CITY PROJECT #:
204
SHT. 37
OF 57

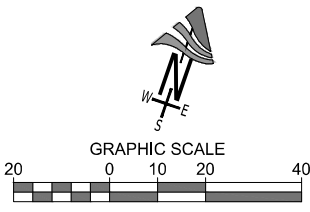

NOTES
 1) SEE SHEET 37 FOR PAVEMENT MARKING GENERAL NOTES.

- CONSTRUCTION NOTES**
- 1 4" PROFILED PLASTIC DOUBLE YELLOW CENTERLINE (TYPE D WITH BI-DIRECTIONAL TYPE 2 RPMS) PER COFW STANDARD DWG. NO. 3-17.
 - 4 WHITE PLASTIC BIKE LANE SYMBOL PER WSDOT STANDARD PLAN M-9.50.
 - 5 8" WHITE PROFILED PLASTIC WIDE LINE (TYPE D WITH MONO-DIRECTIONAL TYPE 2 RPMS) PER COFW STANDARD DWG. NO. 3-18.
 - 6 4" YELLOW PROFILED PLASTIC NO PASS LINE (TYPE D WITH MONO-DIRECTIONAL AND BI-DIRECTIONAL TYPE 2 RPMS) PER COFW STANDARD DWG. NO. 3-18.
 - 7 4" WHITE PROFILED PLASTIC DOTTED EXTENSION LINE (TYPE D) PER WSDOT STANDARD PLAN M-20.10.
 - 8 WHITE PLASTIC TYPE 2SR (RIGHT) TRAFFIC ARROW PER COFW STANDARD DWG. NO. 3-21 AND WSDOT STANDARD PLAN M-24.40.
 - 12 8" WHITE PLASTIC DIAGONAL CROSSHATCH MARKING PER WSDOT STANDARD PLAN M-24.60.

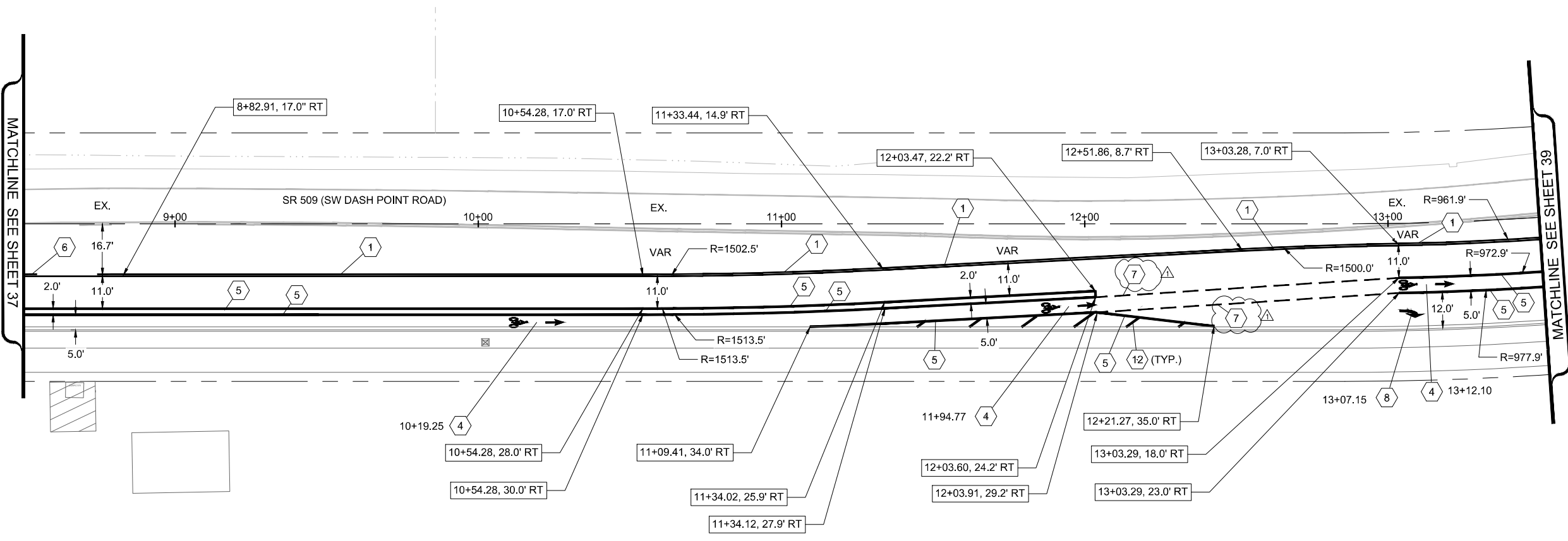

12131 113TH AVENUE NE, SUITE 203 (TEL) 425 821-3665
 KIRKLAND, WASHINGTON 98034 (FAX) 425 825-8434

CITY OF Federal Way
 Centered on Opportunity
 33325 8TH AVE S FEDERAL WAY, WA 98003
 PHONE: (253) 835-2700
 WWW.CITYOFFEDERALWAY.COM



DRAFTED: T.NGUYEN
 DESIGNED: T.NGUYEN
 REVIEWED: C.CAVALLO
 APPROVED: D.WINKLER



DRAWING VERSION / REVISION LOG		
NO.	DATE	REVISION
Δ	11/18/21	EXTENSION LINE

LAKOTA M.S. SRTS PROJECT

PAVEMENT MARKINGS PLAN
 STA 8+50 TO STA 13+50

100%
 CITY PROJECT #:
 204
 SHT. 38
 OF 57

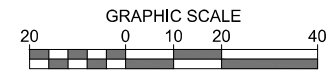

NOTES

1) SEE SHEET 37 FOR PAVEMENT MARKING GENERAL NOTES.

(X) CONSTRUCTION NOTES

- (1) 4" PROFILED PLASTIC DOUBLE YELLOW CENTERLINE (TYPE D WITH BI-DIRECTIONAL TYPE 2 RPMS) PER COFW STANDARD DWG NO. 3-17.
- (2) 18" WHITE PLASTIC STOP LINE (TYPE A) PER COFW STANDARD DWG. NO. 3-21 AND WSDOT STANDARD PLAN M-24.60.
- (4) WHITE PLASTIC BIKE LANE SYMBOL PER WSDOT STANDARD PLAN M-9.50.
- (5) 8" WHITE PROFILED PLASTIC WIDE LINE (TYPE D WITH MONO-DIRECTIONAL TYPE 2 RPMS) PER COFW STANDARD DWG. NO. 3-18.
- (6) 4" YELLOW PROFILED PLASTIC NO PASS LINE (TYPE D WITH MONO-DIRECTIONAL AND BI-DIRECTIONAL TYPE 2 RPMS) PER COFW STANDARD DWG. NO. 3-18.
- (7) 4" WHITE PROFILED PLASTIC DOTTED EXTENSION LINE (TYPE D) PER WSDOT STANDARD PLAN M-20.10.
- (8) WHITE PLASTIC TYPE 2SR (RIGHT) TRAFFIC ARROW PER COFW STANDARD DWG NO. 3-21 AND WSDOT STANDARD PLAN M-24.40.
- (9) YELLOW TYPE C BLOCK TRAFFIC CURB PER COFW STANDARD DWG NO. 3-4.
- (10) 4" WHITE PROFILED PLASTIC EDGE LINE PER COFW STANDARD DWG NO. 3-17.
- (11) WHITE PLASTIC TYPE 2SL (LEFT) TRAFFIC ARROW PER COFW STANDARD DWG NO. 3-21 AND WSDOT STANDARD PLAN M-24.40.

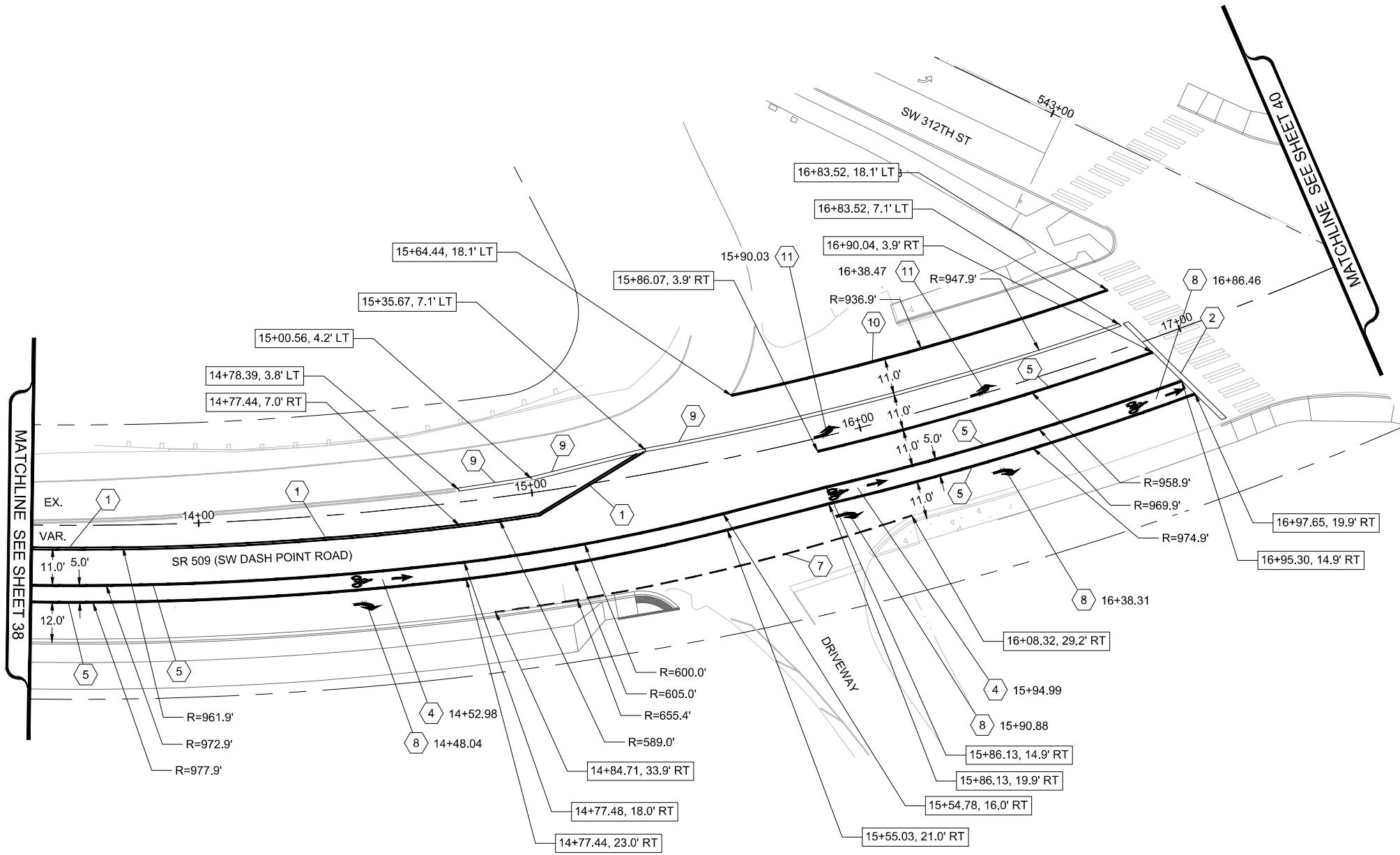

12131 113TH AVENUE NE, SUITE 203 (TEL) 425 821-3665
KIRKLAND, WASHINGTON 98034 (FAX) 425 825-8434

CITY OF Federal Way
Centered on Opportunity
33325 8TH AVE S FEDERAL WAY, WA 98003
PHONE: (253) 835-2700
WWW.CITYOFFEDERALWAY.COM



DRAFTED: T.NGUYEN
DESIGNED: T.NGUYEN
REVIEWED: C.CAVALLO
APPROVED: D.WINKLER



DRAWING VERSION / REVISION LOG		
NO.	DATE	REVISION

LAKOTA M.S. SRTS PROJECT
PAVEMENT MARKINGS PLAN
STA 13+50 TO STA 17+50

100%
CITY PROJECT #:
204
SHT. **39**
OF **57**

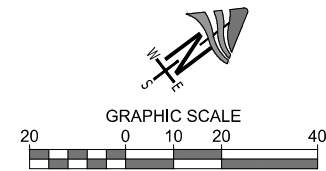

NOTES

1) SEE SHEET 37 FOR PAVEMENT MARKING GENERAL NOTES.

(X) CONSTRUCTION NOTES

- (1) 4" PROFILED PLASTIC DOUBLE YELLOW CENTERLINE (TYPE D WITH BI-DIRECTIONAL TYPE 2 RPMS) PER COFW STANDARD DWG NO. 3-17.
- (3) WHITE PLASTIC (TYPE A) CROSSWALK PER COFW STANDARD DWG. NO. 3-21.
- (4) WHITE PLASTIC BIKE LANE SYMBOL PER WSDOT STANDARD PLAN M-9.50.
- (5) 8" WHITE PROFILED PLASTIC WIDE LINE (TYPE D WITH MONO-DIRECTIONAL TYPE 2 RPMS) PER COFW STANDARD DWG. NO. 3-18.
- (10) 4" WHITE PROFILED PLASTIC EDGE LINE PER COFW STANDARD DWG NO. 3-17.
- (12) 8" WHITE PLASTIC DIAGONAL CROSSHATCH MARKING PER WSDOT STANDARD PLAN M-24.60.
- (13) MODIFIED 8" WHITE PROFILED PLASTIC (TYPE D) DOTTED EXTENSION LINE (TYPE D) PER WSDOT STANDARD PLAN M-20.10.

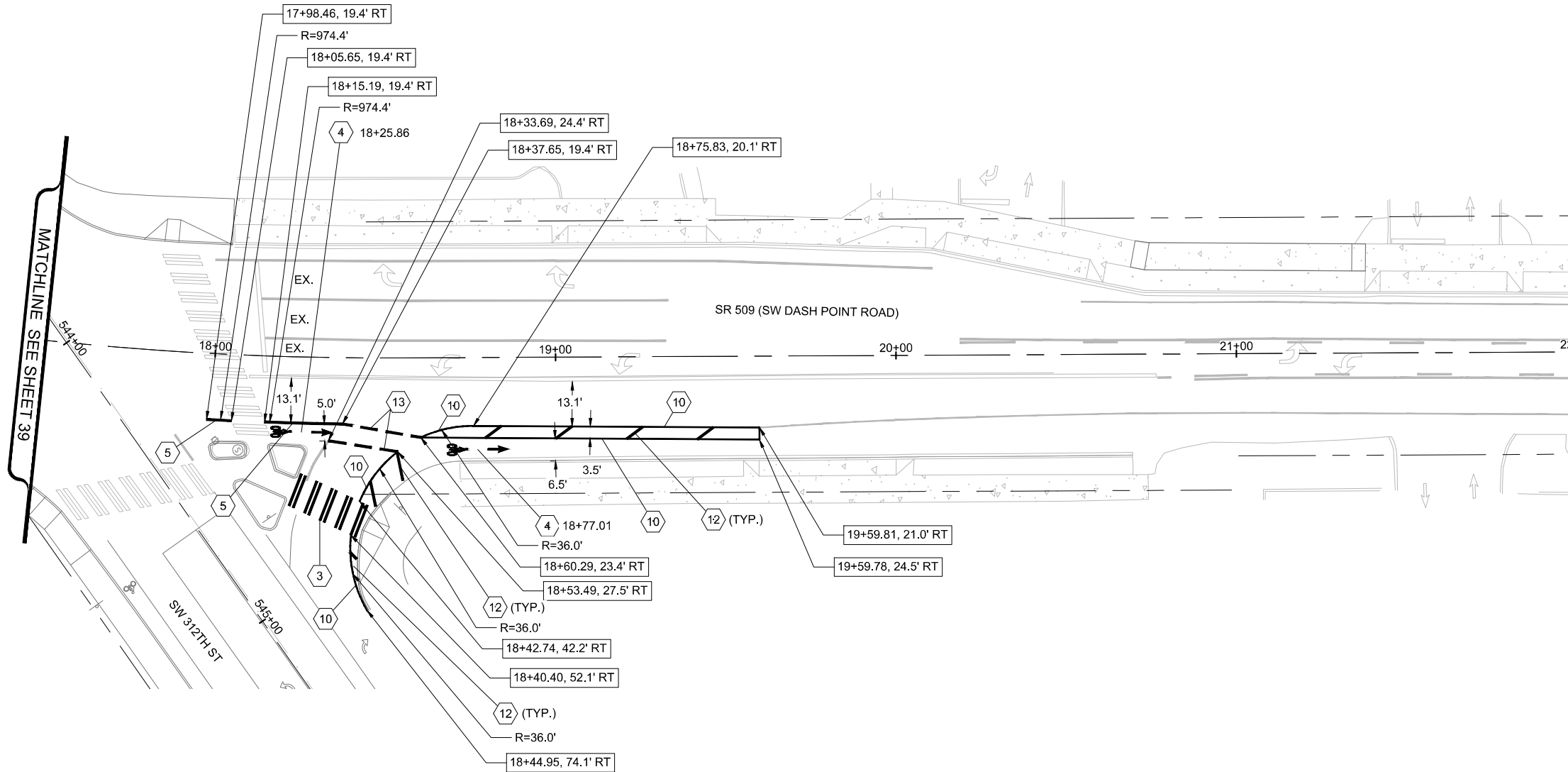

12131 113TH AVENUE NE, SUITE 203 (TEL) 425 821-3665
KIRKLAND, WASHINGTON 98034 (FAX) 425 825-8434

CITY OF Federal Way
Centered on Opportunity
33325 8TH AVE S FEDERAL WAY, WA 98003
PHONE: (253) 835-2700
WWW.CITYOFFEDERALWAY.COM



DRAFTED: T.NGUYEN
DESIGNED: T.NGUYEN
REVIEWED: C.CAVALLO
APPROVED: D.WINKLER



DRAWING VERSION / REVISION LOG

NO.	DATE	REVISION

LAKOTA M.S. SRTS PROJECT

PAVEMENT MARKINGS PLAN
STA 17+50 TO STA 22+00

100%

CITY PROJECT #:
204

SHT. 40
OF 57