

**GENERAL NOTES**

- ALL MAST ARM MOUNTED VEHICLE HEADS SHALL BE 12" AND USE MOUNTING TYPE M WITH THE ELEVATOR PLUMBIZER LOCATED BETWEEN THE RED AND THE YELLOW SECTIONS, AND SHALL HAVE 5" BACKPLATES, TUNNEL VISORS AND SQUARE DOORS. VEHICLE HEADS ON SIGNAL POLES SHALL BE THE SAME, EXCEPT TYPE K MOUNTED.
- ALL PEDESTRIAN HEADS ON TYPE III SIGNAL POLES SHALL BE NEON GRID TYPE AND SHALL HAVE Z-GRATE VISORS. ALL SHALL USE MOUNTING TYPE E. PEDESTRIAN HEADS ON TYPE PS SIGNAL POLES SHALL BE THE SAME, EXCEPT TYPE C MOUNTED.
- PEDESTRIAN PUSH BUTTON SIGNS SHALL BE R10-4001 OR R10-4002 AS APPROPRIATE PER FEDERAL WAY STANDARD DETAIL.
- SEE WSDOT SIGN FABRICATION MANUAL AND LUMINAIRE SCHEDULE SHEET FOR SIGN DETAILS.
- ALL PVC CONDUIT SHALL CONTAIN A GROUND WIRE.
- CONDUIT SHALL BE SCHEDULE 40PVC UNLESS OTHERWISE NOTED. CONDUIT UNDER ROADWAY SHALL BE SCHEDULE 80 PVC.
- CONSTRUCTION NOTES SHOWN ON SHEET 32.
- CONTRACTOR TO PERFORM BORING TO CONFIRM LATERAL SOIL PRESSURE AT EACH MAST ARM LOCATION. THE EXISTING TOPOGRAPHIC AND PHYSICAL FEATURES SHOWN ON THESE PLANS ARE BASED ON A COMBINATION OF:
  - AS-BUILTS AND FIELD SURVEY DATA FROM THE CITY OF FEDERAL WAY
  - FRANCHISE UTILITY COMPANY RECORDS
  - FIELD RECONNAISSANCE BY ENTRANCO

THIS WAS THE INFORMATION AVAILABLE AT THE TIME OF PLAN PREPARATION. ACTUAL CONDITIONS MAY BE DIFFERENT. THE CONTRACTOR MAY ENCOUNTER VARIATIONS BETWEEN ACTUAL CONDITIONS AND THOSE SHOWN. THESE VARIATIONS WILL NOT BE THE BASIS FOR A CLAIM OR EXTRA COMPENSATION.

THE LOCATIONS OF EXISTING UNDERGROUND UTILITIES ARE SHOWN IN AN APPROXIMATE WAY ONLY AND HAVE NOT BEEN INDEPENDENTLY VERIFIED BY THE OWNER OR ENTRANCO. THE CONTRACTOR SHALL DETERMINE THE EXACT LOCATION OF ALL EXISTING UTILITIES BEFORE COMMENCING WORK, AND AGREES TO BE FULLY RESPONSIBLE FOR ANY AND ALL DAMAGES WHICH MIGHT BE OCCASIONED BY THE CONTRACTOR'S FAILURE TO EXACTLY LOCATE AND PRESERVE ANY AND ALL UNDERGROUND UTILITIES.

MATCHLINE SEE RIGHT THIS SHEET

MATCHLINE SEE LEFT THIS SHEET

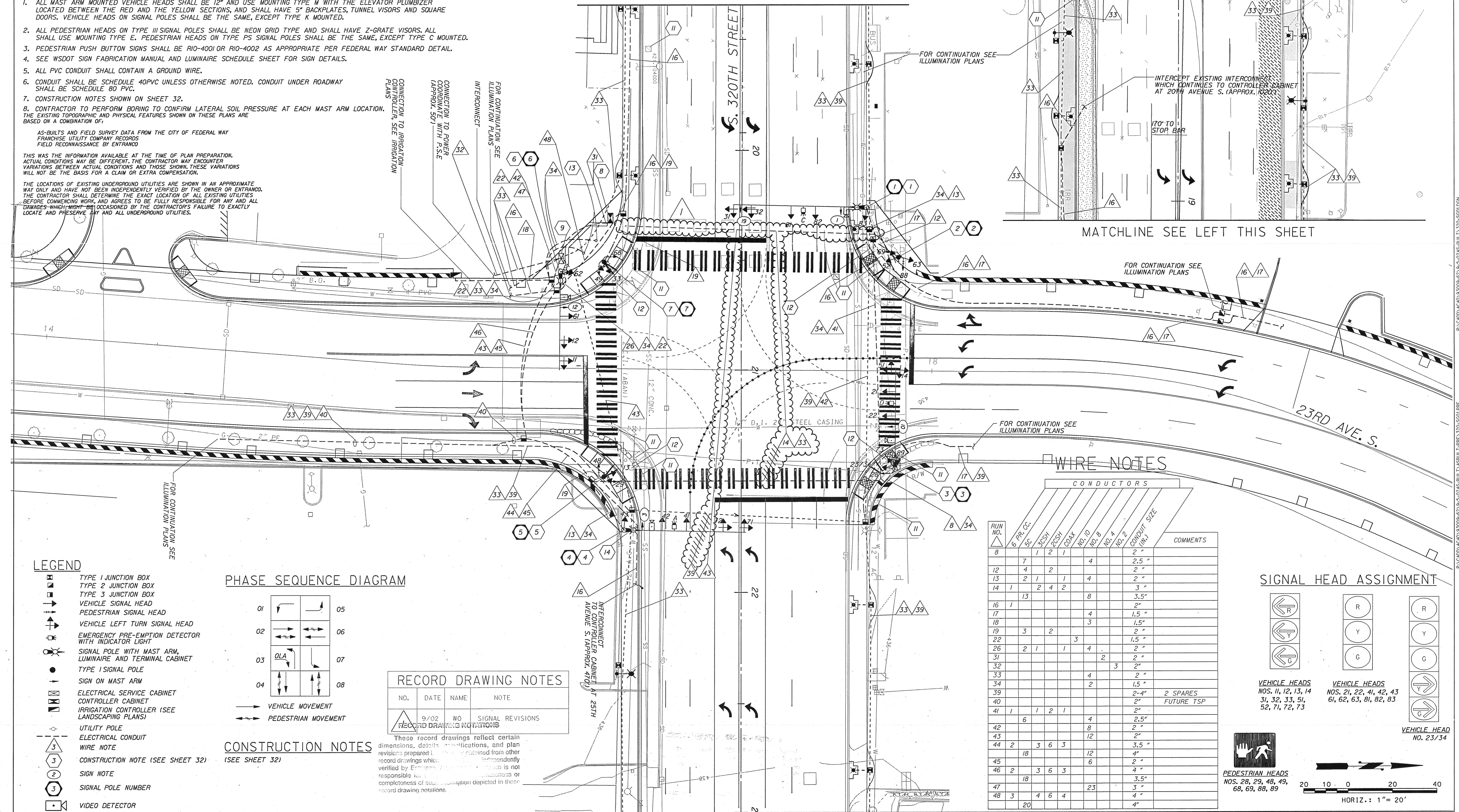

**LEGEND**

- TYPE 1 JUNCTION BOX
- TYPE 2 JUNCTION BOX
- TYPE 3 JUNCTION BOX
- VEHICLE SIGNAL HEAD
- PEDESTRIAN SIGNAL HEAD
- VEHICLE LEFT TURN SIGNAL HEAD
- EMERGENCY PRE-EMPTION DETECTOR WITH INDICATOR LIGHT
- SIGNAL POLE WITH MAST ARM, LUMINAIRE AND TERMINAL CABINET
- TYPE I SIGNAL POLE
- SIGN ON MAST ARM
- ELECTRICAL SERVICE CABINET
- CONTROLLER CABINET
- IRRIGATION CONTROLLER (SEE LANDSCAPING PLANS)
- UTILITY POLE
- ELECTRICAL CONDUIT
- WIRE NOTE
- CONSTRUCTION NOTE (SEE SHEET 32)
- SIGN NOTE
- SIGNAL POLE NUMBER
- VIDEO DETECTOR

**PHASE SEQUENCE DIAGRAM**

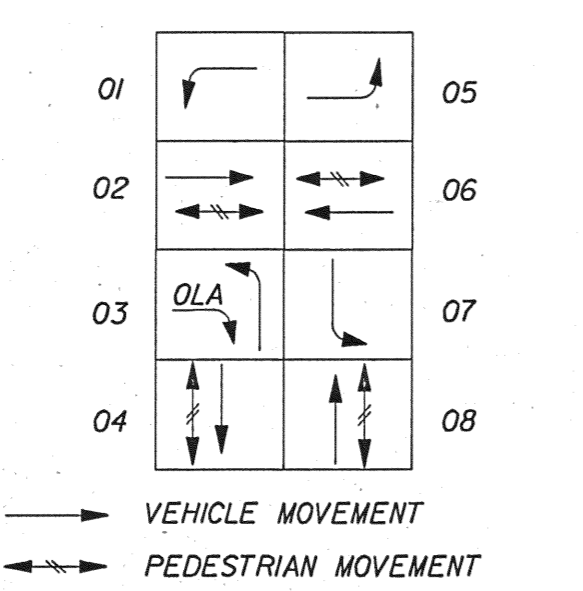

**RECORD DRAWING NOTES**

NO.	DATE	NAME	NOTE
1	9/02	WO	SIGNAL REVISIONS
RECORD DRAWING NOTATIONS			

These record drawings reflect certain dimensions, descriptions, specifications, and plan revisions prepared by Entranco. Entranco is not responsible for the accuracy, completeness or completeness of such information depicted in these record drawing notations.

**CONSTRUCTION NOTES**

(SEE SHEET 32)

CONDUCTORS	CONDUIT SIZE	COMMENTS
8	2"	
12	2.5"	
13	2"	
14	3"	
16	3.5"	
17	1.5"	
18	2"	
19	1.5"	
22	2"	
26	2"	
31	2"	
32	3"	
33	2"	
34	1.5"	
39	2-4"	2 SPARES
40	2"	FUTURE TSP
41	2"	
42	2.5"	
43	2"	
44	3.5"	
45	4"	
46	4"	
47	3.5"	
48	4"	
20	4"	

**SIGNAL HEAD ASSIGNMENT**

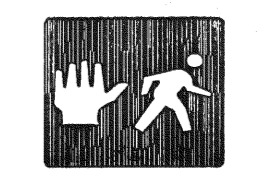
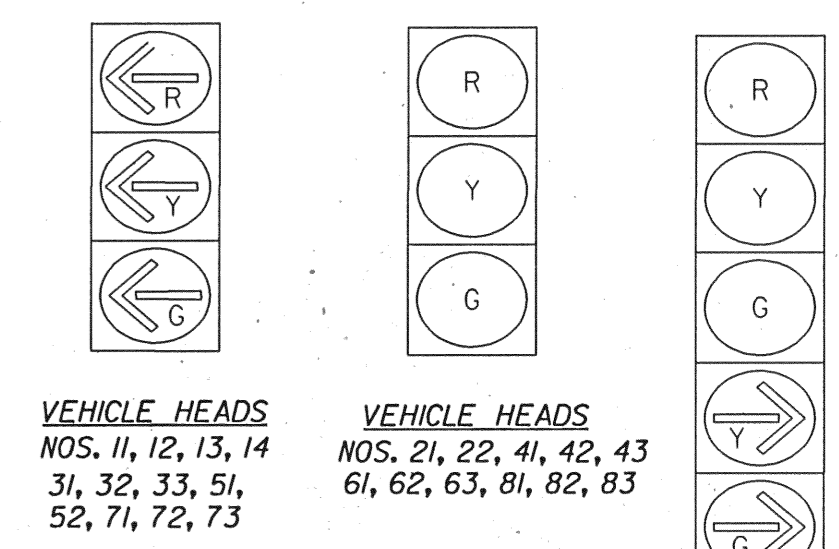

PEDESTRIAN HEADS NOS. 28, 29, 48, 49, 68, 69, 88, 89

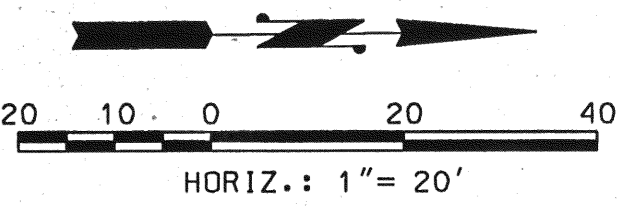

No.	Date	By	Ckd.	Appr.	Revision

Approved By: \_\_\_\_\_  
 Drawn By: RMC Date: 3/9/01  
 Designed By: DVP Date: 3/9/01  
 Checked By: K00 Date: 3/9/01  
 Approved By: ECD Date: 3/19/01



Scale: SCALE  
 Horiz. 1"=20'  
 Vert. 1"=10'  
 Job No. 96027-20

CITY OF FEDERAL WAY  
 S. 320TH STREET  
 SIGNAL PLANS

Sheet 36  
 of 72

23RD AVE S

RECORD DRAWING